

646.40 DURABLE 100 mm WHITE LINE
 (ALL LINES WILL INCLUDE EDGE LINE BREAKS AND RADIUS FOR TOWN HIGHWAYS)
 MIDDLEBURY:
 STA. I+820.0 - STA. 2+100.0 LT & RT
 STA. I+983.0 - STA. 2+090.0 LANE LINE 3.6 m LT
 STA. I+991.0 - STA. 2+010.0 3.6 m RT
 STA. I+991.0 (ALONG VT 125 EDGE OF ISLAND)
 STA. 2+090.0 - STA. 2+100.0 DOTTED LINE 3.6 m LT
 STA. 2+050.0 - STA. 2+090.0 DASHED LINE 3.6 m RT

646.60 TEMPORARY 100 mm WHITE LINE
 (ALL LINES WILL INCLUDE EDGE LINE BREAKS AND RADIUS FOR TOWN HIGHWAYS)
 MIDDLEBURY:
 STA. I+820.0 - STA. 2+100.0 LT & RT
 STA. I+983.0 - STA. 2+090.0 LANE LINE 3.6 m LT
 STA. I+991.0 - STA. 2+010.0 3.6 m RT
 STA. I+991.0 (ALONG VT 125 EDGE OF ISLAND)
 STA. 2+090.0 - STA. 2+100.0 DOTTED LINE 3.6 m LT
 STA. 2+050.0 - STA. 2+090.0 DASHED LINE 3.6 m RT

646.41 DURABLE 100 mm YELLOW LINE
 (ALL LINES WILL INCLUDE C/L BREAKS FOR TOWN HIGHWAYS) S=SOLID, D=DASHED
 MIDDLEBURY:
 STA. I+820.0 - STA. I+828.0 LT & RT
 STA. I+828.0 - STA. I+893.0 DOUBLE SOLID LT & RT, (EDGE OF MEDIAN)
 STA. I+893.0 - STA. I+963.0 LT & RT, (RAISED ISLAND)
 STA. I+982.712 DOUBLE SOLID RT, VT-ROUTE 125
 STA. I+991.0 - STA. 2+100.0 SOLID LINE LT & RT
 STA. I+994.0 - STA. 2+010.0 (LT EDGE OF RAMP VT 125)

646.61 TEMPORARY 100 mm YELLOW LINE
 (ALL LINES WILL INCLUDE C/L BREAKS FOR TOWN HIGHWAYS) S=SOLID, D=DASHED
 MIDDLEBURY:
 STA. I+820.0 - STA. I+828.0 LT & RT
 STA. I+828.0 - STA. I+893.0 DOUBLE SOLID LT & RT, (EDGE OF MEDIAN)
 STA. I+893.0 - STA. I+963.0 LT & RT, (RAISED ISLAND)
 STA. I+982.712 DOUBLE SOLID RT, VT-ROUTE 125
 STA. I+991.0 - STA. 2+100.0 SOLID LINE LT & RT
 STA. I+994.0 - STA. 2+010.0 (LT EDGE OF RAMP VT 125)

646.46 DURABLE 600 mm STOP BAR
 MIDDLEBURY:
 STA. I+987.712 RT, VT. ROUTE 125

646.66 TEMPORARY 600 mm STOP BAR
 MIDDLEBURY:
 STA. I+987.712 RT, VT. ROUTE 125

646.50 DURABLE LETTER OR SYMBOL
 MIDDLEBURY:
 STA. I+987.712 RT, VT. ROUTE 125, "S,T,O,P" (4 EA)
 STA. I+991.0 TO I+993.4 LT, ARROW (1EA)
 STA. 2+015.2 TO 2+017.6 LT, "O,N,L,Y" (4 EA)
 STA. 2+039.3 TO 2+041.7 LT, ARROW (1EA)
 STA. 2+063.5 TO 2+065.9 LT, "O,N,L,Y" (4 EA)
 STA. 2+087.6 TO 2+090.0 LT, ARROW (1EA)
 2+092 ONLY 4 EA

646.70 TEMPORARY LETTER OR SYMBOL
 MIDDLEBURY:
 STA. I+987.712 RT, VT. ROUTE 125, "S,T,O,P" (4 EA)
 STA. I+991.0 TO I+993.4 LT, ARROW (1EA)
 STA. 2+039.3 TO 2+041.7 LT, ARROW (1EA)
 STA. 2+087.6 TO 2+090.0 LT, ARROW (1EA)

646.42 DURABLE 200 mm WHITE LINE
 MIDDLEBURY:
 STA. I+991.0 - STA. I+994.0 RT (GORE LINE)
 STA. 2+010.0 - STA. 2+050.0 RT (GORE LINE)

646.62 TEMPORARY 200 mm WHITE LINE
 MIDDLEBURY:
 STA. I+991.0 - STA. I+994.0 RT (GORE LINE)
 STA. 2+010.0 - STA. 2+050.0 RT (GORE LINE)

646.43 DURABLE 200 mm YELLOW LINE
 MIDDLEBURY:
 STA. I+828.0 - STA. I+893.0 RT (DIAGONALS MEDIAN) (150 m)

646.63 TEMPORARY 200 mm YELLOW LINE
 MIDDLEBURY:
 STA. I+828.0 - STA. I+893.0 RT (DIAGONALS MEDIAN) (150 m)

CORE #	POSITION	MM STA.	PLAN STA.	CORE DEPTH(mm)	PCC UNDER
1	NB LANE	1,185	I+907	50	NO
2	NB LANE	1,200	I+931	150	NO
3	SB LANE	1,200	I+931	75	NO

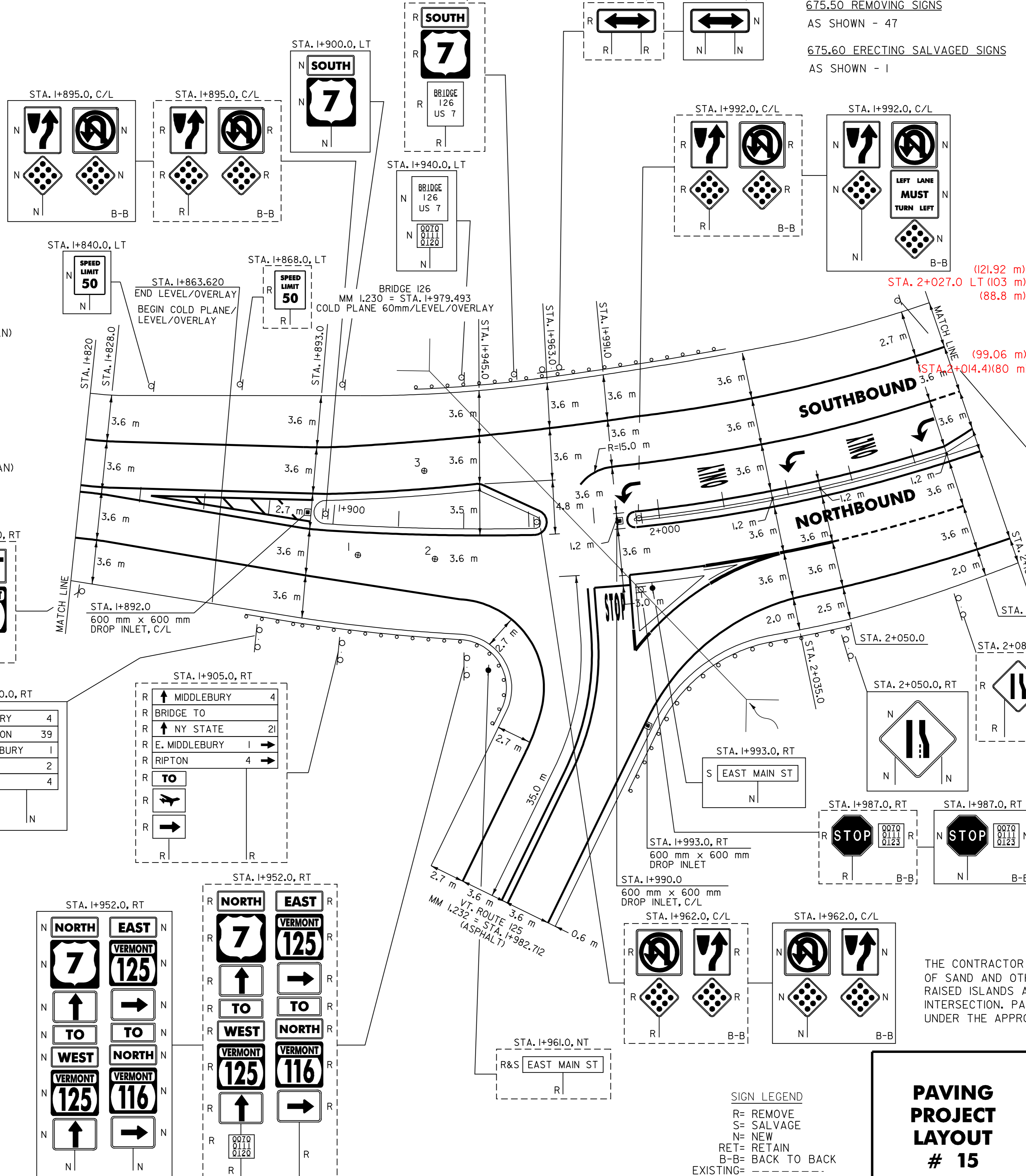

675.50 REMOVING SIGNS
 AS SHOWN - 47

675.60 ERECTING SALVAGED SIGNS
 AS SHOWN - 1

646.81 PAINTED CURB
 MIDDLEBURY:
 STA. I+893 - STA. I+902 LT AND RT
 STA. I+936 - STA. I+964 LT AND RT
 STA. I+991 - STA. 2+000 LT AND RT
 STA. 2+081 - STA. 2+099 LT AND RT

604.412 REHABILITATION OF DI, CB, OR MH, CLASS I
 STA. I+892.0 C/L
 STA. I+990.0 C/L
 STA. I+993.0 RT

621.80 REMOVAL & DISP. OF GUARDRAIL
 MIDDLEBURY:
 (121.92 m) STA. I+877.0 - STA. I+947.0 RT (-95-m)
 (103 m) STA. I+924.0 - STA. 2+037.0 LT (-113-m)
 (88.8 m) STA. I+990.0 - STA. 2+050.0 RT (-128-m)

621.20 STEEL BEAM GUARDRAIL
 MIDDLEBURY:
 (99.06 m) STA. I+888.4 - STA. I+947.0 RT (-72.2-m)
 (80 m) STA. I+934.4 - STA. 2+025.6 LT (-91.2-m)
 (64.77 m) STA. I+993.0 - STA. 2+038.6 RT (-102.6-m)

621.505 MANUFACTURED TERMINAL SECTION (FLARED)
 MIDDLEBURY:
 STA. I+877.0 - STA. I+888.4 RT
 STA. I+923.0 - STA. I+934.4 LT
 STA. I+947.0 RT (VT. ROUTE 125)
 STA. I+993.0 RT (VT. ROUTE 125)
 STA. 2+025.6 - STA. 2+037.0 LT
 STA. 2+038.6 - STA. 2+050.0 RT
 STA. 2+014.4 - STA. 2+025.8 LT

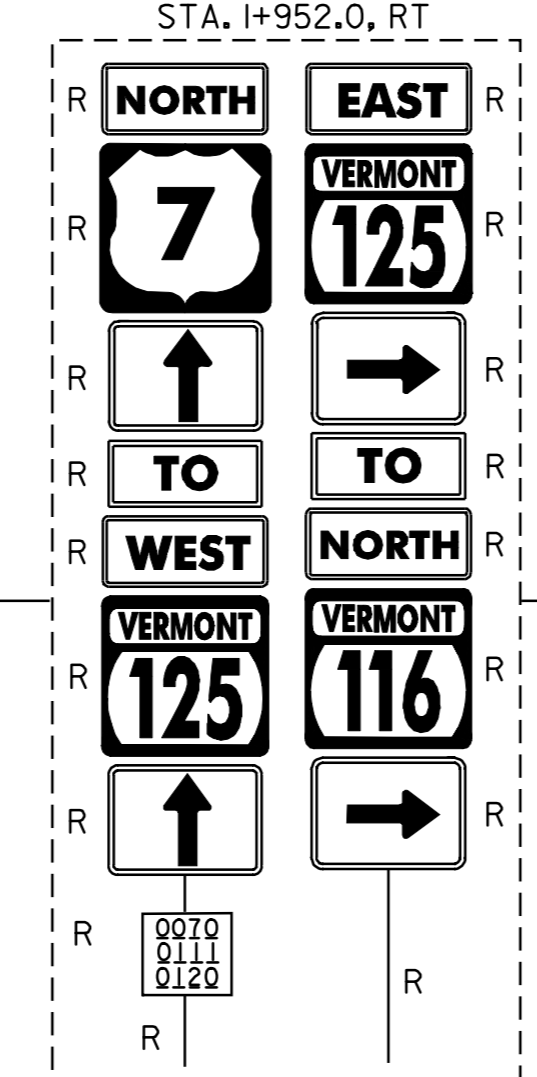
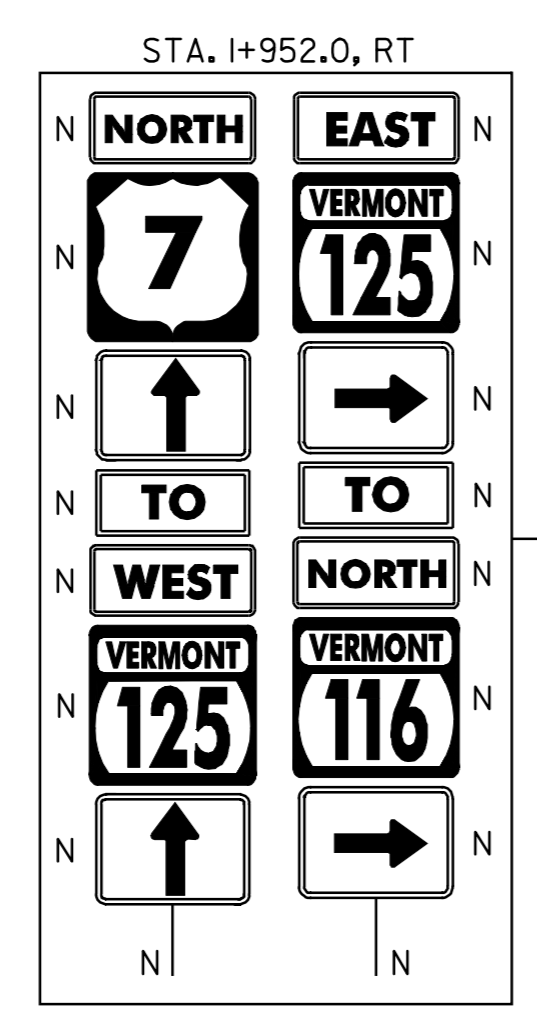
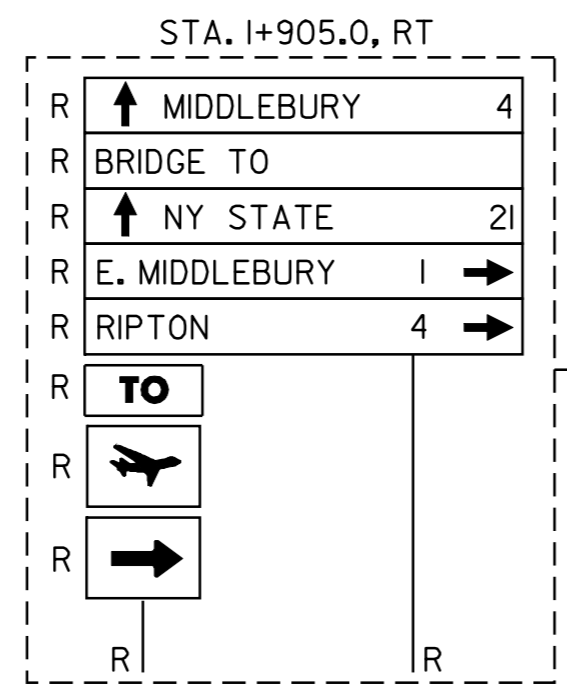
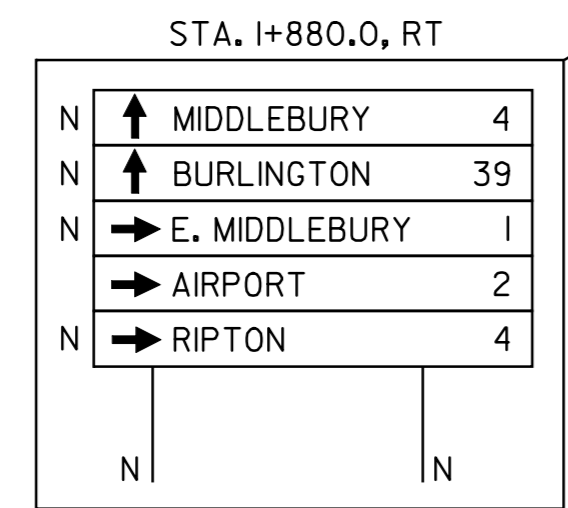
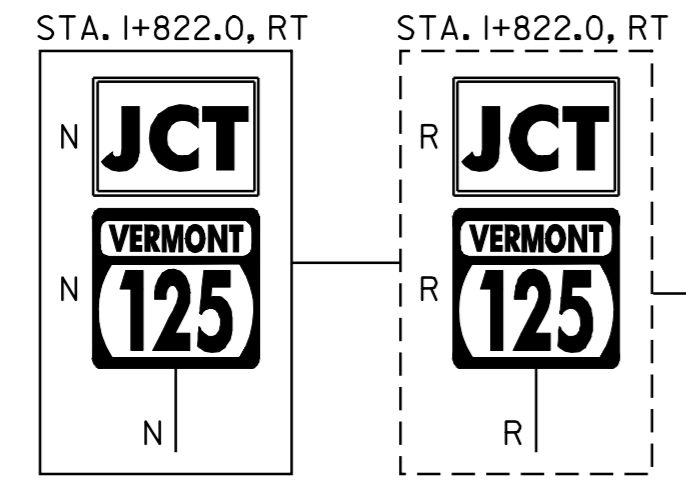

SIGN LEGEND
 R= REMOVE
 S= SALVAGE
 N= NEW
 RET= RETAIN
 B-B= BACK TO BACK
 EXISTING= _____
 NEW= _____

PAVING PROJECT LAYOUT # 15

SURVEYED BY N/A DATE N/A
 DRAWN BY C.A.K. DATE 2/02
 SQUAD LEADER D.E.G.
 DESIGN FILE NO. PAVE/01b018/pb018.dgn
 IPARM pb018p15.i DATE 10-JUL-2006 13:
 FILE PL0110
 PROJ. NAME SALISBURY - MIDDLEBURY
 PROJ. NO. NH_231113
 SHEET 24 OF 67 SHEETS _____

THE CONTRACTOR SHALL REMOVE THE ACCUMULATION OF SAND AND OTHER DEBRIS ADJACENT TO THE CURBED, RAISED ISLANDS AT THE US ROUTE 7/VT ROUTE 125 INTERSECTION. PAYMENT FOR THIS WORK SHALL BE MADE UNDER THE APPROPRIATE RENTAL ITEM(S).