

646.40 DURABLE 100 mm WHITE LINE
(ALL LINES WILL INCLUDE EDGE LINE BREAKS AND RADIUS FOR TOWN HIGHWAYS)
SALISBURY:
STA. 3+980.0 - STA. 4+520.0 LT & RT

646.60 TEMPORARY 100 mm WHITE LINE
(ALL LINES WILL INCLUDE EDGE LINE BREAKS AND RADIUS FOR TOWN HIGHWAYS)
SALISBURY:
STA. 3+980.0 - STA. 4+520.0 LT & RT

646.41 DURABLE 100 mm YELLOW LINE
(ALL LINES WILL INCLUDE C/L BREAKS FOR TOWN HIGHWAYS) S=SOLID, D=DASHED
SALISBURY:
STA. 3+980.0 - STA. 4+168.2 LT D RT
STA. 4+168.2 - STA. 4+520.0 S S
STA. 4+240.621 DOUBLE SOLID RT, T-3

646.61 TEMPORARY 100 mm YELLOW LINE
(ALL LINES WILL INCLUDE C/L BREAKS FOR TOWN HIGHWAYS) S=SOLID, D=DASHED
SALISBURY:
STA. 3+980.0 - STA. 4+168.2 LT D RT
STA. 4+168.2 - STA. 4+520.0 S S
STA. 4+240.621 DOUBLE SOLID RT, T-3

646.46 DURABLE 600 mm STOP BAR
SALISBURY:
STA. 4+240.621 RT, T-3

646.66 TEMPORARY 600 mm STOP BAR
SALISBURY:
STA. 4+240.621 RT, T-3

646.50 DURABLE LETTER OR SYMBOL
SALISBURY:
STA. 4+240.621 RT, T-3, "S,T,O,P" (4 EA)

646.70 TEMPORARY LETTER OR SYMBOL
SALISBURY:
STA. 4+240.621 RT, T-3, "S,T,O,P" (4 EA)

675.50 REMOVING SIGNS
AS SHOWN - 39

621.20 STEEL BEAM GUARDRAIL
SALISBURY:
STA. 4+184.2 - STA. 4+226.0 RT (57.0 m) (60.96 m)
STA. 4+194.4 - STA. 4+373.0 LT (178.6 m) (186.69 m)
381.1

621.505 MANUFACTURED TERMINAL SECTION
SALISBURY:
STA. 4+226.0 RT (ON T-3)

621.505 MANUFACTURED TERMINAL SECTION (FLARED)
SALISBURY:
STA. 4+172.8 - STA. 4+184.2 RT
STA. 4+183.0 - STA. 4+194.4 LT
~~STA. 4+373.0 - STA. 4+384.4 LT~~
~~STA. 4+381.1 - STA. 4+392.5 LT~~

621.80 REMOVAL AND DISPOSAL OF GUARDRAIL
SALISBURY:
STA. 4+175.0 - STA. 4+226.0 RT (81.4 m)
STA. 4+183.0 - STA. 4+383.0 LT (200.0 m)

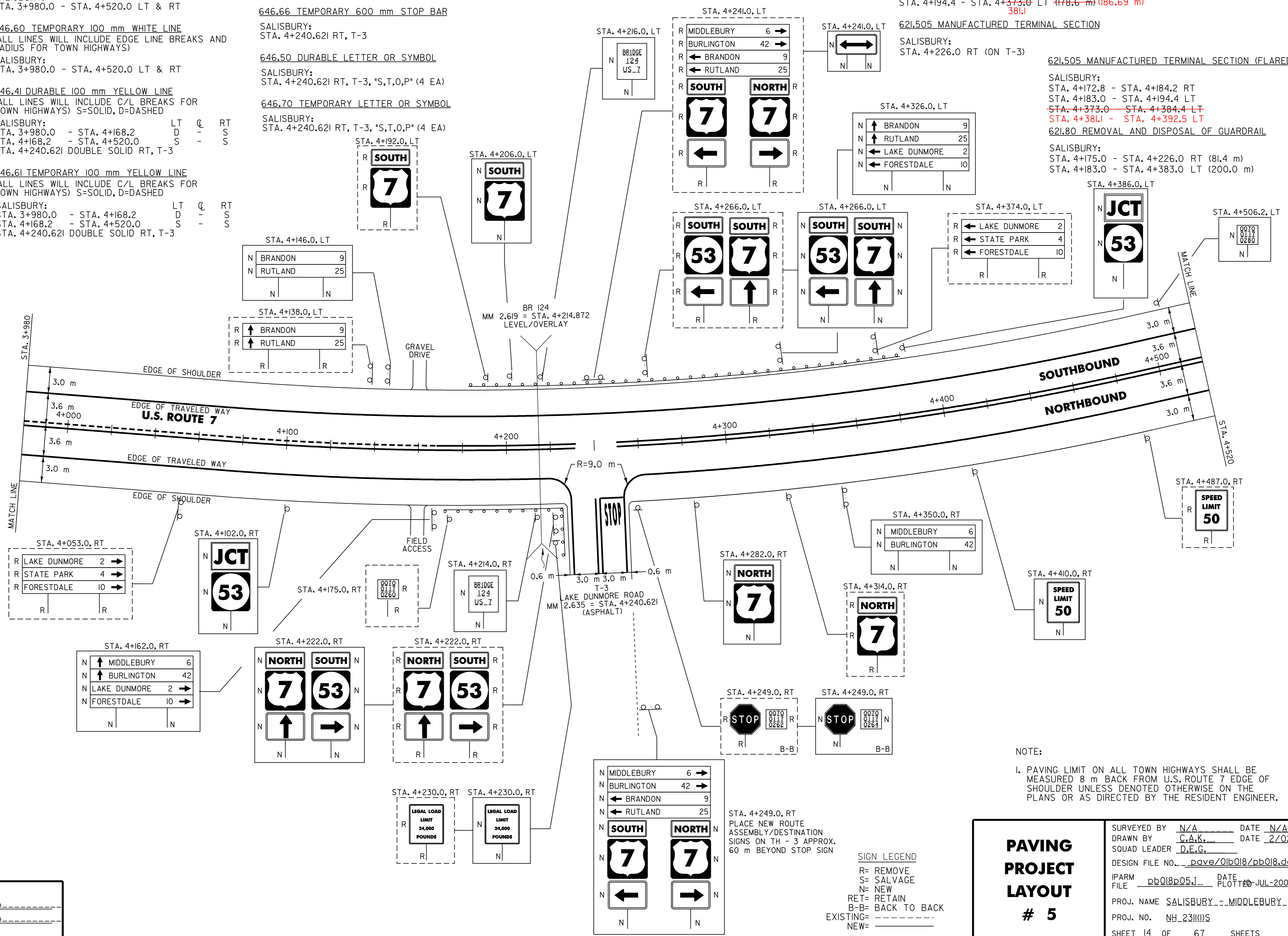

NOTE:
1. PAVING LIMIT ON ALL TOWN HIGHWAYS SHALL BE MEASURED 8 m BACK FROM U.S. ROUTE 7 EDGE OF SHOULDER UNLESS DENOTED OTHERWISE ON THE PLANS OR AS DIRECTED BY THE RESIDENT ENGINEER.

STA. 4+249.0, RT
PLACE NEW ROUTE ASSEMBLY/DESTINATION SIGNS ON TH - 3 APPROX. 60 m BEYOND STOP SIGN

SIGN LEGEND
R= REMOVE
S= SALVAGE
N= NEW
RET= RETAIN
B-B= BACK TO BACK
EXISTING= _____
NEW= _____

<h2>PAVING PROJECT LAYOUT # 5</h2>	SURVEYED BY <u>N/A</u> DATE <u>N/A</u>
	DRAWN BY <u>C.A.K.</u> DATE <u>2/02</u>
	SQUAD LEADER <u>D.E.G.</u>
	DESIGN FILE NO. <u>pave/01b018/pb018.dgn</u>
	IPARM FILE <u>pb018p05.i</u> DATE <u>10-JUL-2006 13:</u>
PROJ. NAME <u>SALISBURY - MIDDLEBURY</u>	
PROJ. NO. <u>NH_231111</u>	
SHEET <u>14</u> OF <u>67</u> SHEETS	

DATUM
VERTICAL N/A
HORIZONTAL N/A