

**CONSTRUCTION NOTES**

**DURABLE 4" WHITE LINE**  
 STA 12+05 LT - STA 15+20 LT  
 STA 12+05 RT - STA 23+25 RT  
 STA 13+71 RT - STA 15+20 RT  
 STA 20+25 LT - STA 21+60 LT  
 STA 22+00 LT - STA 23+25 LT

**DURABLE 4" YELLOW LINE (DOUBLE CENTER LINE)**  
 STA 11+30 - STA 13+00  
 STA 13+75 - STA 15+20  
 STA 20+30 - STA 21+65  
 STA 21+85 - STA 24+30

**DURABLE LETTER OR SYMBOL**  
 STA 12+87 RT = "STOP"

**DURABLE 24" STOP BAR**  
 STA 13+00 RT

**REMOVING SIGNS**  
 STA 13+15 RT (4 SIGNS)  
 STA 13+19 RT (5 SIGNS)  
 STA 13+41 LT (1 SIGN)  
 STA 13+45 LT (8 SIGNS)  
 STA 14+25 LT (1 SIGN)  
 STA 20+24 LT (8 SIGNS)  
 STA 20+29 LT (4 SIGNS)  
 STA 20+50 LT (1 SIGN)  
 STA 21+60 LT (2 SIGNS)

**LEGEND**

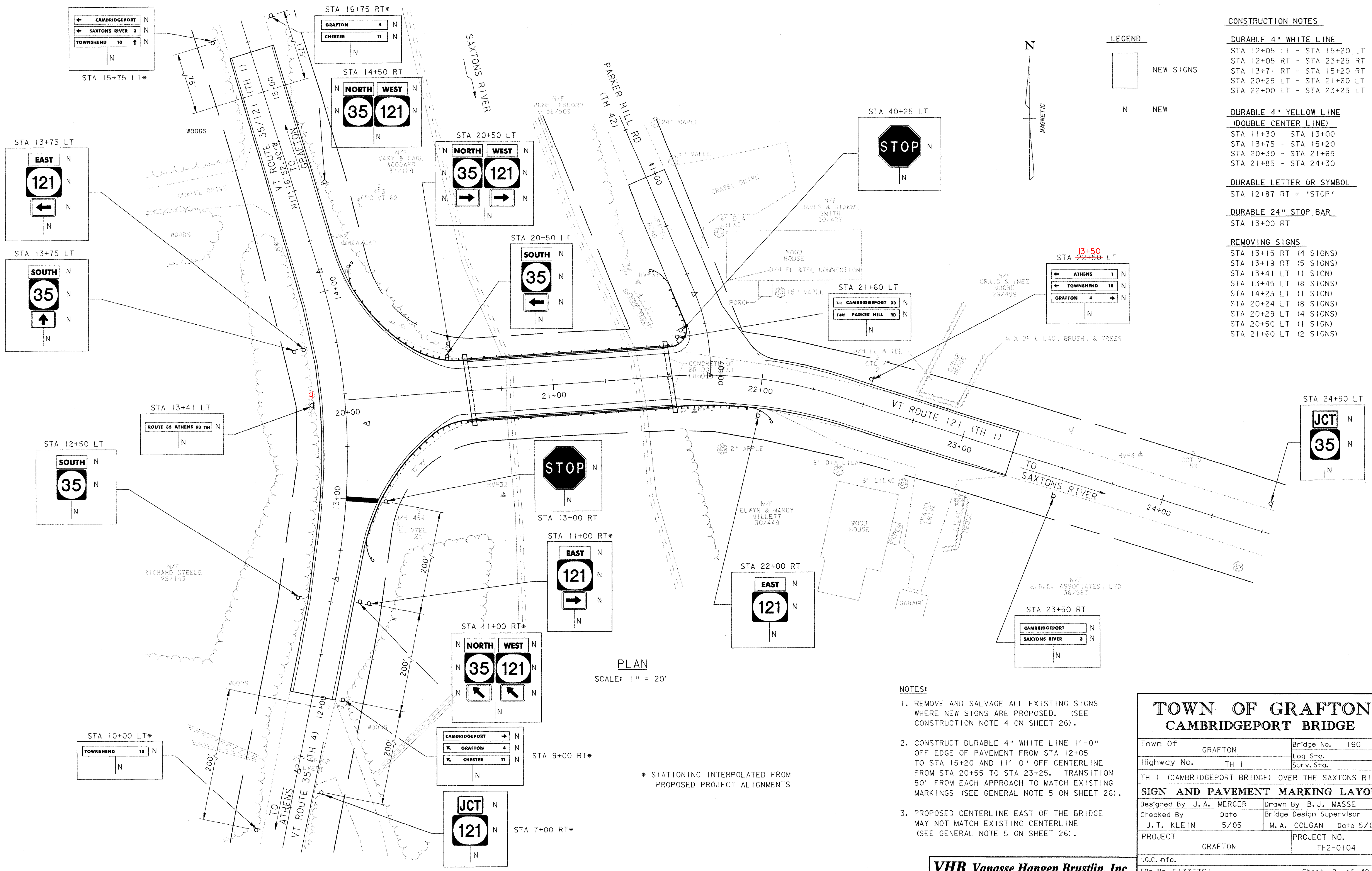
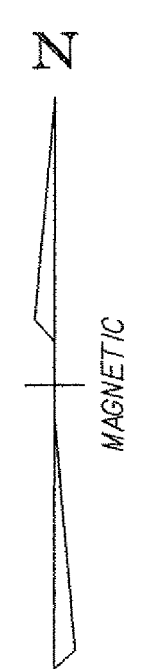
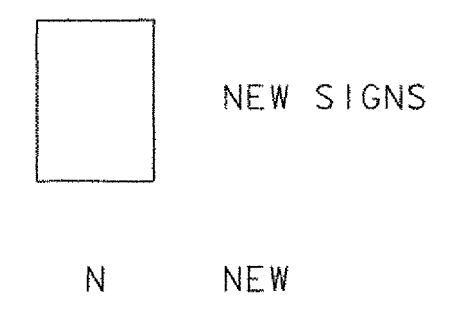

**PLAN**  
 SCALE: 1" = 20'

\* STATIONING INTERPOLATED FROM PROPOSED PROJECT ALIGNMENTS

**NOTES:**

1. REMOVE AND SALVAGE ALL EXISTING SIGNS WHERE NEW SIGNS ARE PROPOSED. (SEE CONSTRUCTION NOTE 4 ON SHEET 26).
2. CONSTRUCT DURABLE 4" WHITE LINE 1'-0" OFF EDGE OF PAVEMENT FROM STA 12+05 TO STA 15+20 AND 11'-0" OFF CENTERLINE FROM STA 20+55 TO STA 23+25. TRANSITION 50' FROM EACH APPROACH TO MATCH EXISTING MARKINGS (SEE GENERAL NOTE 5 ON SHEET 26).
3. PROPOSED CENTERLINE EAST OF THE BRIDGE MAY NOT MATCH EXISTING CENTERLINE (SEE GENERAL NOTE 5 ON SHEET 26).

**TOWN OF GRAFTON  
 CAMBRIDGEPORT BRIDGE**

Town Of	GRAFTON	Bridge No.	16G
Highway No.	TH 1	Log Sta.	
		Surv. Sta.	
TH 1 (CAMBRIDGEPORT BRIDGE) OVER THE SAXTONS RIVER			
<b>SIGN AND PAVEMENT MARKING LAYOUT</b>			
Designed By	J. A. MERCER	Drawn By	B. J. MASSE
Checked By	Date	Bridge Design Supervisor	
J. T. KLEIN	5/05	M. A. COLGAN	Date 5/05
PROJECT	GRAFTON	PROJECT NO.	TH2-0104
I.G.C. Info.			
File No.	51335TS1	Sheet	9 of 42

**VHB Vanasse Hangen Brustlin, Inc.**