

INDEX OF SHEETS

- 1R TITLE SHEET
- 2R PRELIMINARY INFORMATION SHEET
- 3 QUANTITY SHEET (1 OF 3)
- 4 QUANTITY SHEET (2 OF 3)
- 5 QUANTITY SHEET (3 OF 3)
- 6 TIE SHEET & TYPICAL DETAILS
- 7 ROADWAY PLAN
- 8 PROFILES
- 9 SIGN AND PAVEMENT MARKING LAYOUT
- 10 TRAFFIC SIGN SUMMARY SHEET (1 OF 3)
- 11 TRAFFIC SIGN SUMMARY SHEET (2 OF 3)
- 12 TRAFFIC SIGN SUMMARY SHEET (3 OF 3)
- 13 TRAFFIC CONTROL PLAN
- 14 DETOUR PLAN & PROFILE
- 15 PLAN AND ELEVATION
- 16 EROSION CONTROL NARRATIVE
- 17 EXISTING CONDITIONS SITE PLAN
- 18 EROSION PREVENTION & SEDIMENT CONTROL (EPSC) PLAN
- 19 FINAL CONDITIONS SITE PLAN
- 20 EPSC-1
- 21 EPSC-2
- 22 EPSC-3
- 23 EPSC-4
- 24 EPSC-5
- 25 EPSC-6
- 26R CONSTRUCTION NOTES
- 27R DECK DETAILS
- 28R DECK REINFORCEMENT
- 29R CURTAIN WALL
- 30R FRAMING PLAN
- 31R BEAM ELEVATION
- 32R BEARING DETAILS
- 33 APPROACH SLAB DETAILS
- 34R ABUTMENT REMOVAL AND REPAIR
- 35R ABUTMENT DETAILS
- 36R REINFORCING STEEL SCHEDULE
- 37-39 ROADWAY CROSS SECTIONS
- 40-42 CHANNEL CROSS SECTIONS

STANDARD SHEETS

E-100	01-02-04	E-151	05-01-04
E-100A	01-02-04	E-152	05-01-04
E-101	05-30-03	E-160	05-20-99
E-102	06-30-03	E-163	05-20-99
E-102A	05-01-04	E-164	05-20-99
E-106	03-01-04	E-171A	08-09-95
E-107	06-30-03	E-171B	08-09-95
E-108	08-18-95	E-172	08-09-95
E-110	08-08-95	E-175	11-17-93
E-121	08-08-95	E-180A	08-09-95
E-123	03-16-04	E-193	08-18-95
E-127	08-08-95	G-1	01-03-00
E-136C	08-08-95	G-1D	01-03-00
E-140	08-30-96	G-18	06-01-94
E-142	09-20-95	G-19	11-15-02
E-143	06-15-04	J-3	08-07-95
E-144	03-29-99	SB-R4A-82	09-19-89
		SB-R6-82	01-06-95

TOWN OF GRAFTON, VT CAMBRIDGEPORT BRIDGE

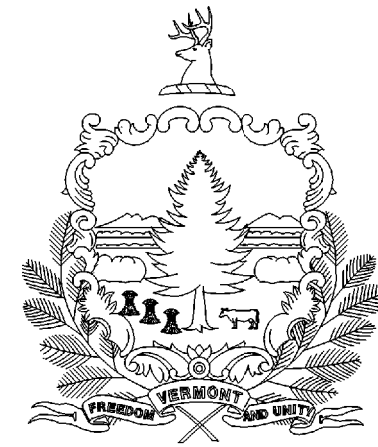

PROPOSED IMPROVEMENT BRIDGE PROJECT COUNTY OF WINDHAM

VT ROUTE 121, BRIDGE NO. 16G

PROJECT LOCATION: BEGINNING AT A POINT 600.0' WESTERLY OF THE GRAFTON/ROCKINGHAM TOWN LINE AND EXTENDING EASTERLY 98.0'.

PROJECT DESCRIPTION: REMOVAL OF THE EXISTING SUPERSTRUCTURE, CONSTRUCTION OF A STEEL BEAM, CONCRETE DECK SUPERSTRUCTURE, REHABILITATION OF ABUTMENTS, REMOVAL OF PIER, AND RELATED ROADWAY APPROACHES.

LENGTH OF STRUCTURE: 98.0'
 LENGTH OF ROADWAY: 54.0'
 LENGTH OF PROJECT: 152.0'

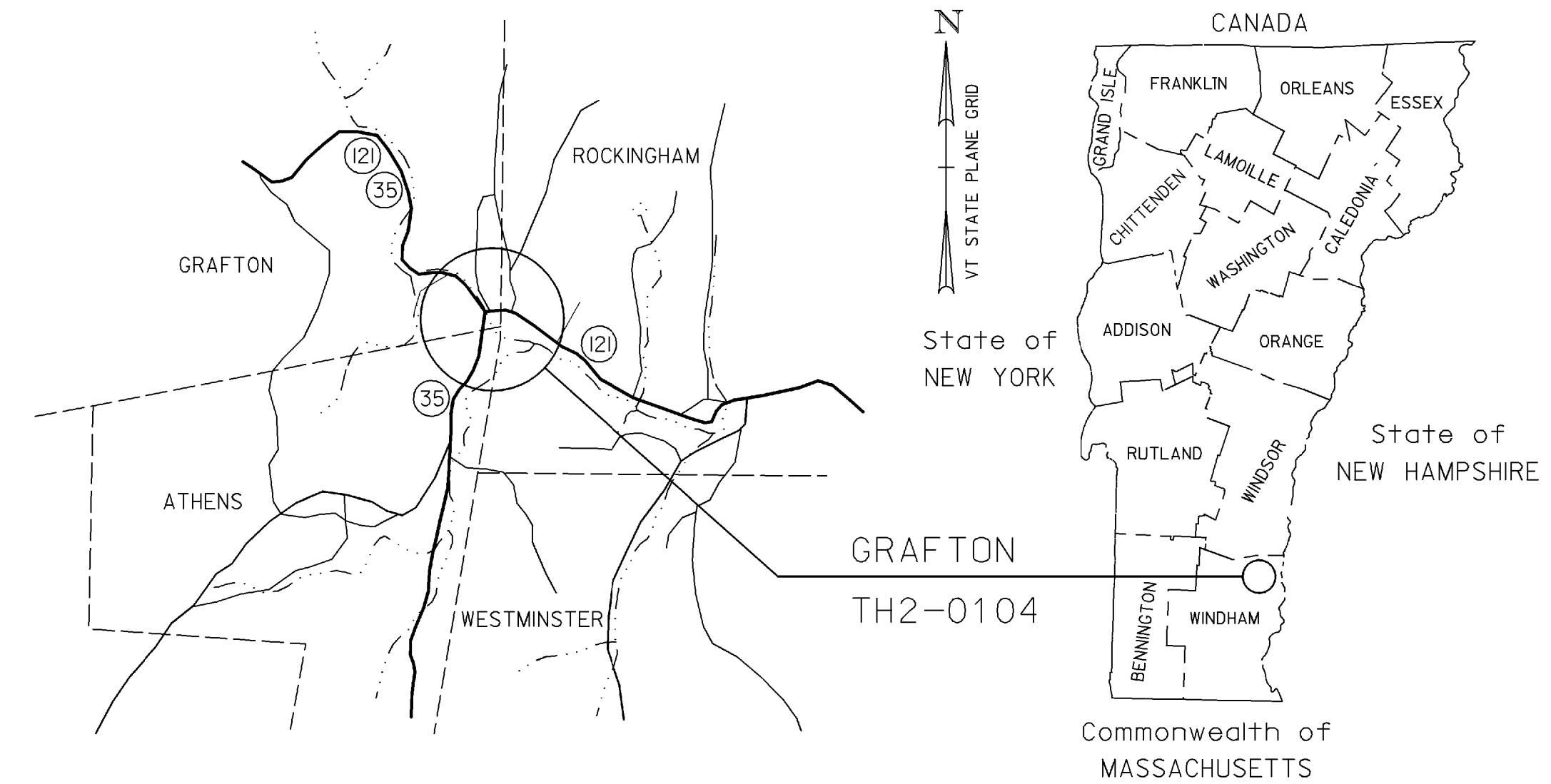

LOCATION MAP
SCALE: 1" = 1.6 MILES

ROUTE 121 TRAFFIC DATA *

2000 ADT = 2200	2000-2020 ESAL'S 881,000
2000 DHV = 310	2000-2040 ESAL'S 2,198,000
2000 ADTT = 110	DESIGN SPEED = 35 mph
2020 ADT = 3000	
2020 DHV = 420	
2020 ADTT = 100	
% D = 50	
% T = 2.0	

* TRAFFIC DATA PROVIDED BY THE TOWN OF ROCKINGHAM FROM THE GRAFTON-ROCKINGHAM, ROUTE 121 PROJECT (STP 0126(4) S).

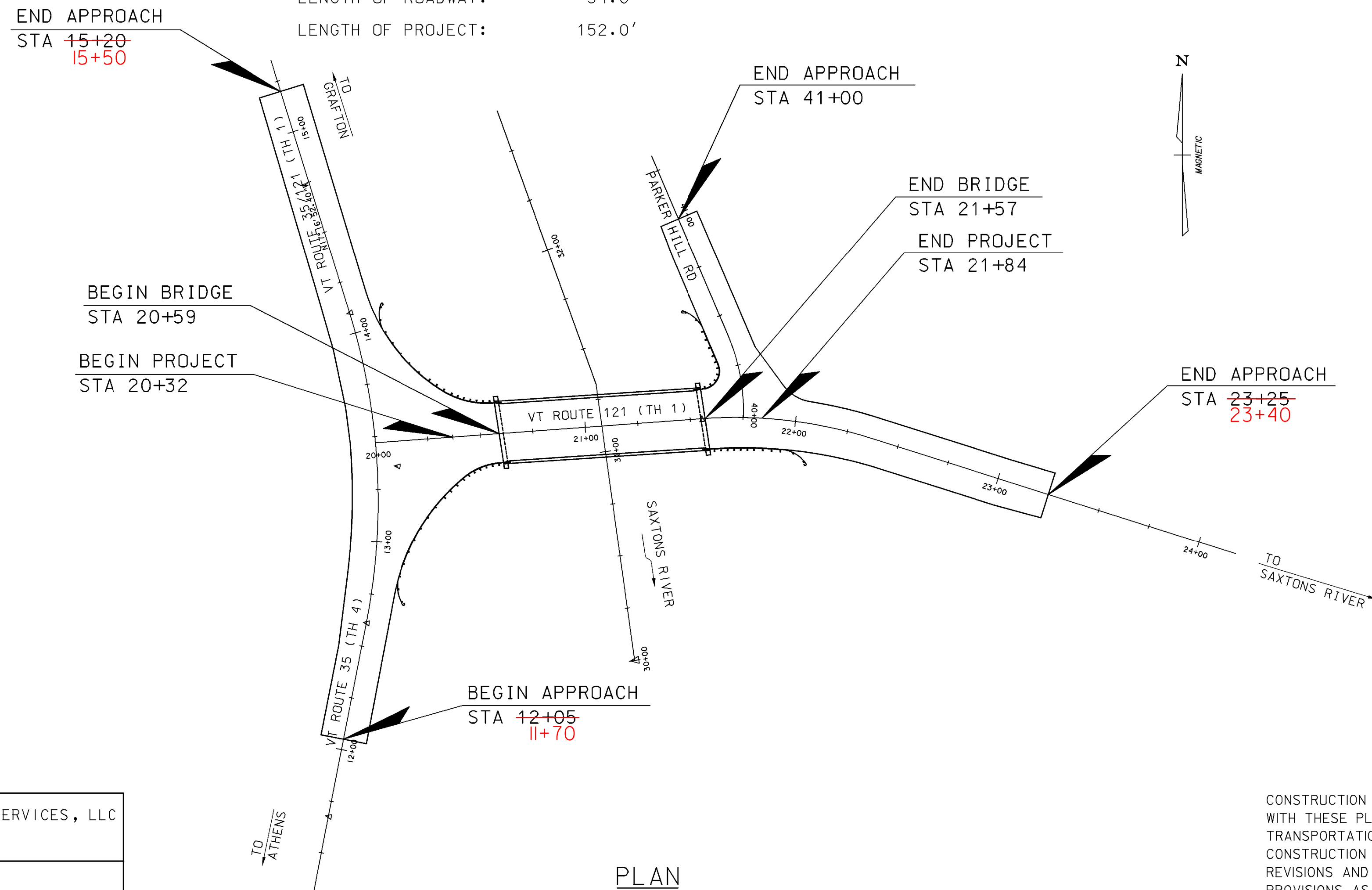

PLAN

SCALE: 1" = 40'

CONVENTIONAL SYMBOLS

COUNTY LINE	
TOWN LINE	
LIMITS OF ACCESS	
POINT OF ACCESS	
FENCE LINE	
STONE WALL	
TRAVELED WAY	
GUARD RAIL	
RAILROAD	
SURVEY LINE	
CULVERT	
POWER POLE	
TELEPHONE POLE	
TREES	
CONTROL OF ACCESS	
PROPERTY LINE	
R.O.W. TAKING LINE	
SLOPE RIGHTS	
TOP OF CUT	
TOE OF SLOPE	

SURVEYED BY : EIV TECHNICAL SERVICES, LLC
 SURVEYED DATE : JUNE 2002

DATUM

VERTICAL NAVD 88
 HORIZONTAL ASSUMED

THIS SHEET SUPERSEDES CONTRACT PLAN SHEET 1 DATED 6/05. REVISIONS ON THIS SHEET REFLECT CHANGES IN DESIGN AND DETAILS AS PER CHANGE ORDER NO. 2, SUBSTITUTING NEW STEEL BEAMS FOR RECYCLED BEAMS.

CONSTRUCTION IS TO BE CARRIED ON IN ACCORDANCE WITH THESE PLANS AND THE VERMONT AGENCY OF TRANSPORTATION'S STANDARD SPECIFICATIONS FOR CONSTRUCTION DATED 2001, INCLUDING ALL SUBSEQUENT REVISIONS AND SUCH REVISED SPECIFICATIONS AND SPECIAL PROVISIONS AS ARE INCORPORATED IN THESE PLANS.

DIRECTOR OF PROGRAM DEVELOPMENT
 APPROVED _____ DATE _____

PROJECT MANAGER : WARREN TRIPP

PROJECT NAME : GRAFTON
 PROJECT NUMBER : TH2-0104

SHEET 1R OF 42 SHEETS

VHB Vanasse Hangen Brustlin, Inc.