

PARK & RIDE LOT

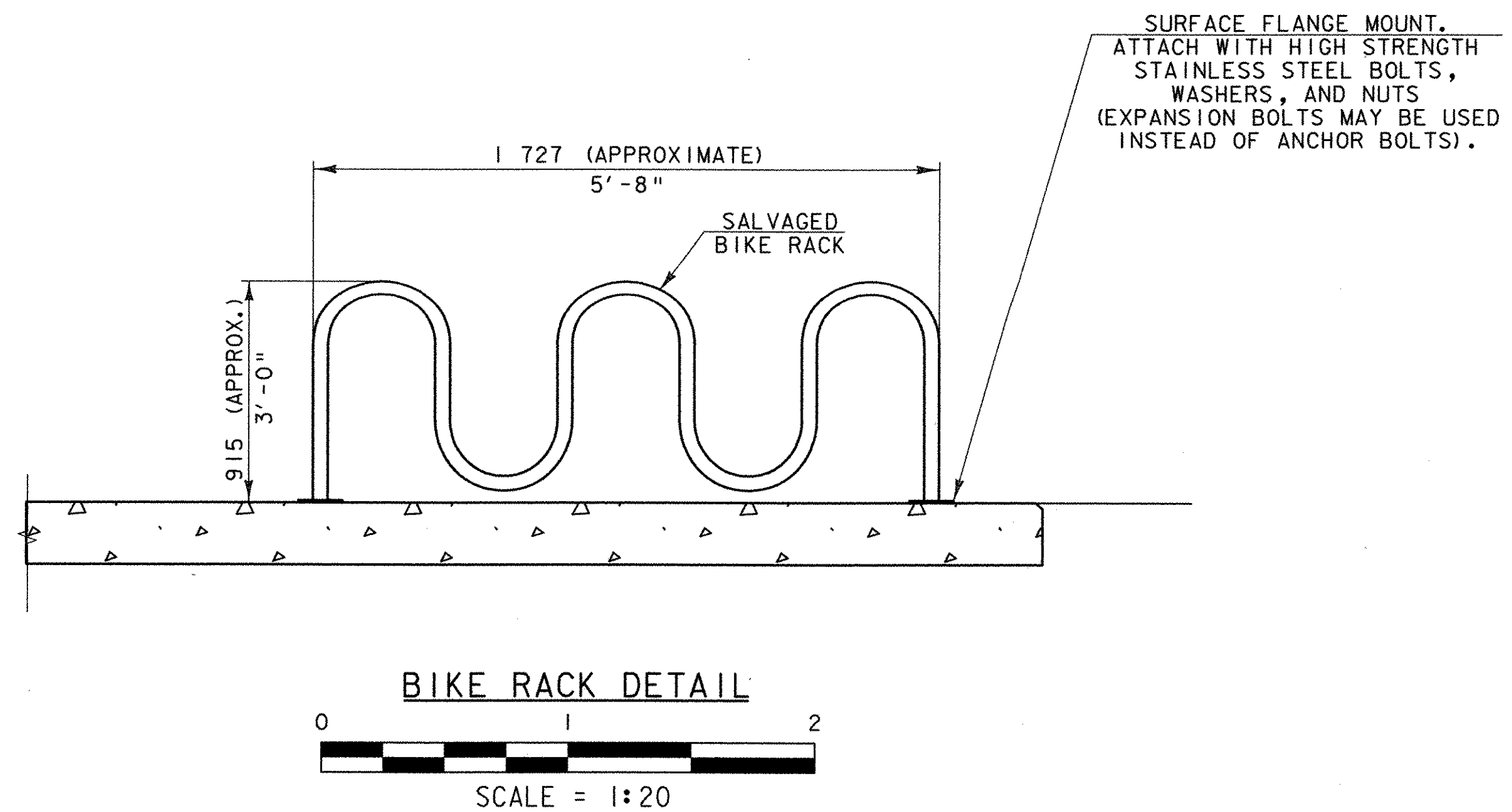

- NOTES:**
- BIKE RACK REMOVAL AND REINSTALLATION OF THE BIKE RACK SHALL BE PAID FOR UNDER ITEM 658.20 "REST AREA BENCH (MOD. - BIKE RACK)".
 - CONTRACTOR TO CLEAN AND PAINT THE SALVAGED BIKE RACK (MATCH EXISTING COLOR) AS DEEMED NECESSARY TO THE RESIDENT ENGINEER. PAYMENT SHALL BE INCIDENTAL TO ITEM 658.20 "REST AREA BENCH (MOD. - BIKE RACK)".

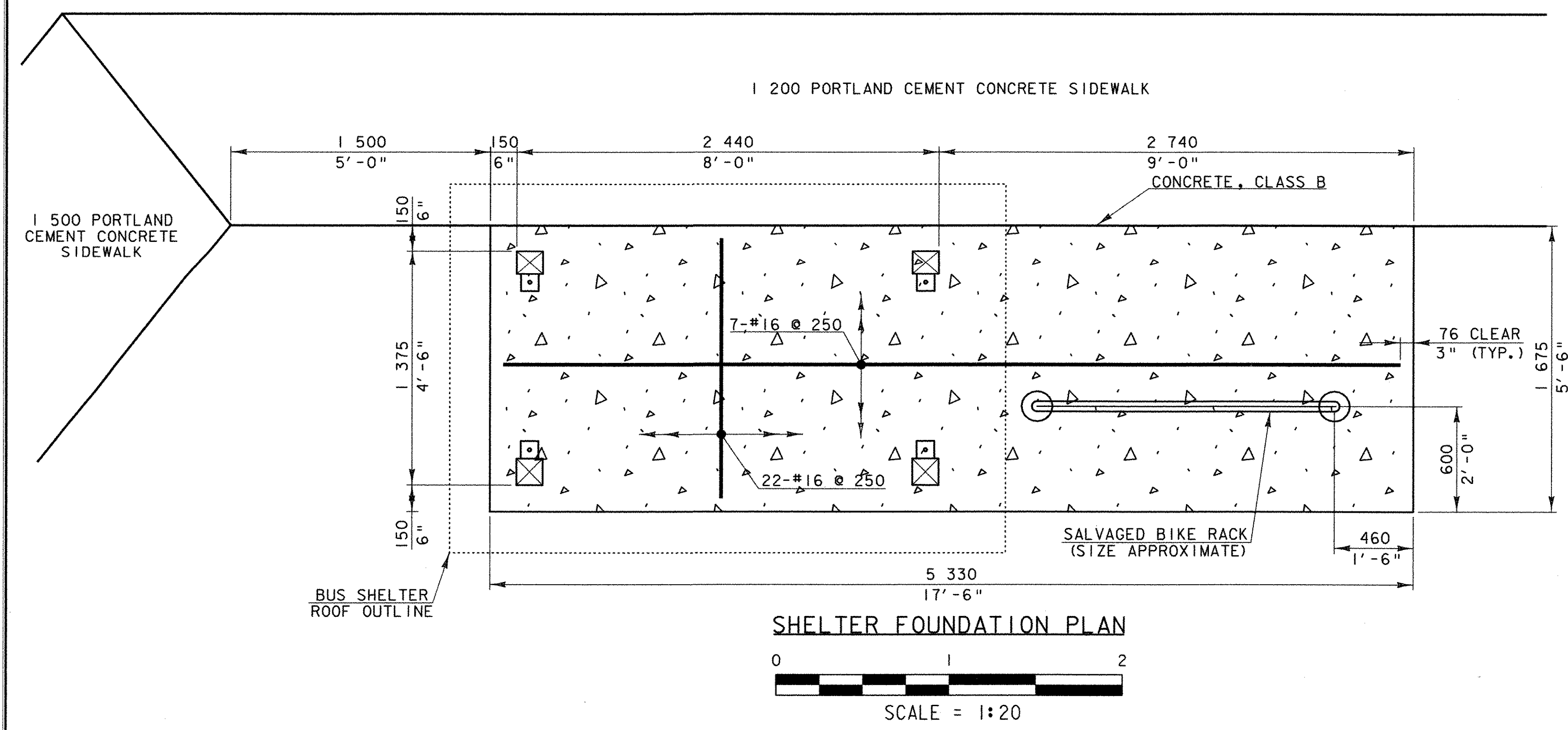
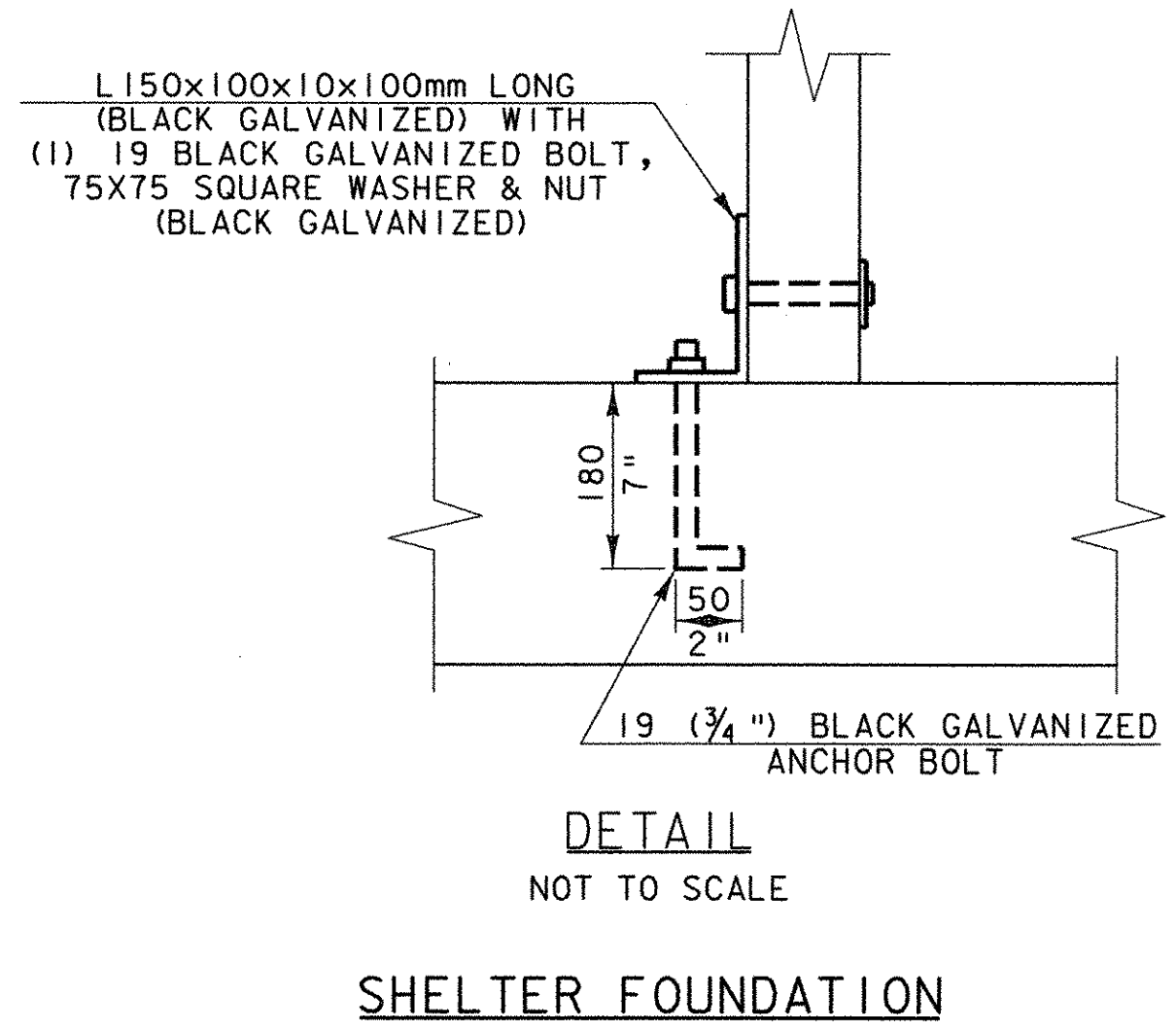
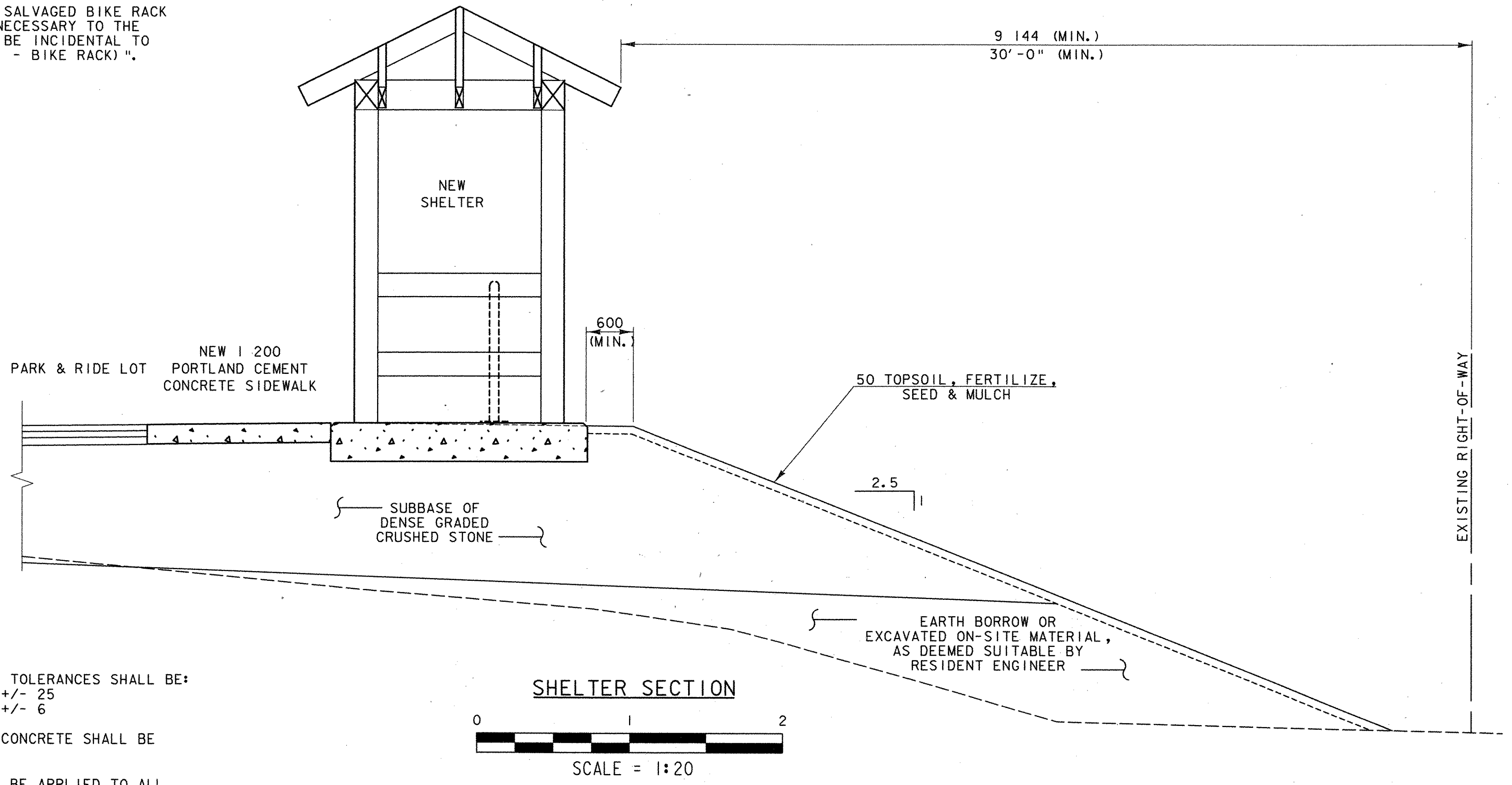
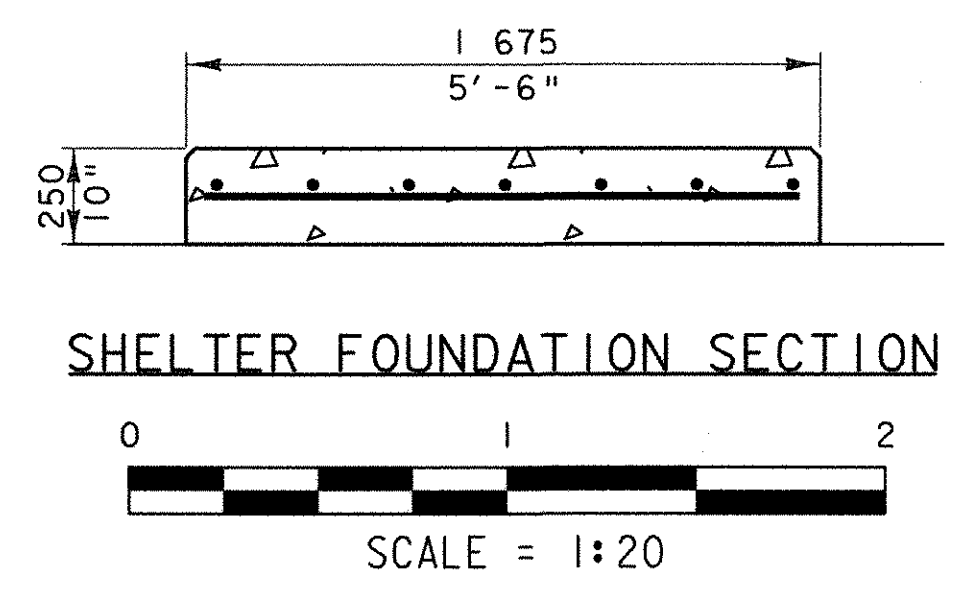

- NOTES**
- REINFORCING PLACEMENT TOLERANCES SHALL BE:
SPACING +/- 25
CLEARANCE +/- 6
 - ALL EXPOSED EDGES OF CONCRETE SHALL BE CHAMFERED 19 BY 19.
 - WATER REPELLENT SHALL BE APPLIED TO ALL EXPOSED CONCRETE.

PROJECT NAME:	ST. ALBANS PARK & RIDE
PROJECT NUMBER:	CMG PARK (23)S
FILE NAME:	PLOT DATE: 10/14/2005
PROJECT LEADER: JWT	DRAWN BY: PGJ
DESIGNED BY: PGJ	CHECKED BY: EPD
SHELTER FOUNDATION & BIKE RACK DETAILS	SHEET 26 OF 29