

STATE OF VERMONT
AGENCY OF TRANSPORTATION



PROPOSED IMPROVEMENT
VERMONT ROUTE 10A
TOWN: NORWICH
COUNTY: WINDSOR

NORWICH, VT ROUTE 10A, AT THE INTERSECTION OF VT ROUTE 10A AND RIVER ROAD.

WORK TO BE PERFORMED UNDER THIS PROJECT INCLUDES
REPLACING WOOD POLES & SPANWIRE WITH NEW STRAINPOLES
AND MAST ARMS. REPLACING SIGNAL HEADS, CONTROLLER,
CABINET & PEDESTRIAN HEADS.

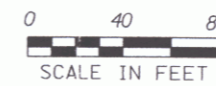
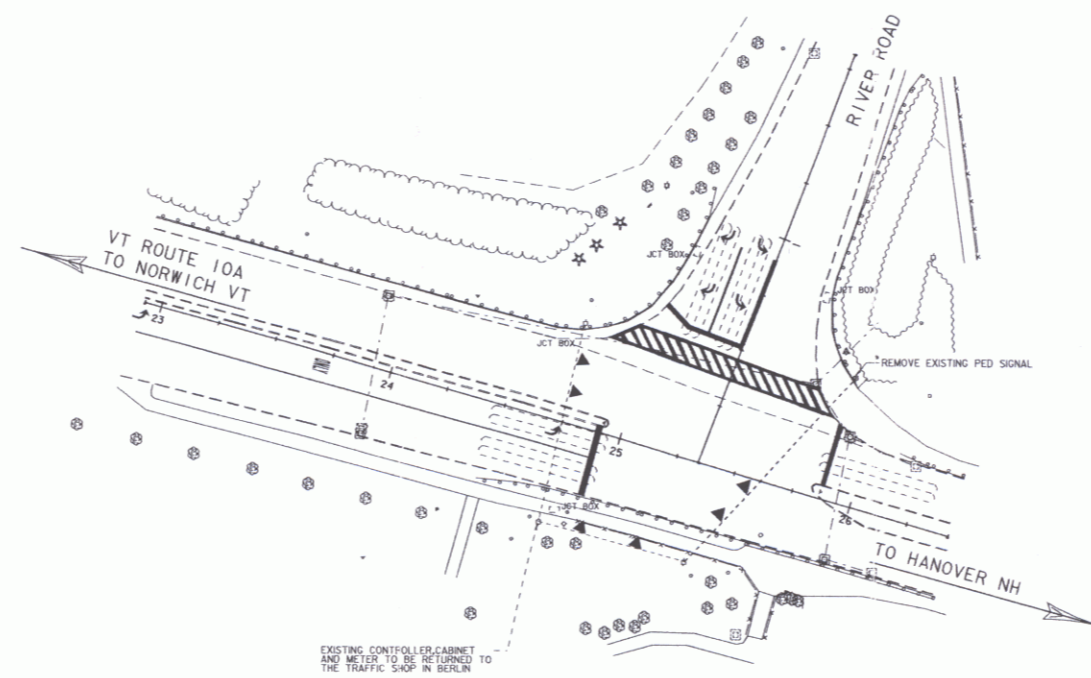

INDEX OF SHEETS

1. TITLE SHEET
2. QUANTITY SHEET
3. TRAFFIC SIGNAL NOTES SHEET
4. CROSS SECTIONS - EAST & WEST VIEWS
5. CROSS SECTION - SOUTH VIEW
6. PLAN SHEET - EXISTING EQUIPMENT LAYOUT
7. PLAN SHEET - NEW EQUIPMENT LAYOUT
8. MAST ARM CANTILEVER / FOOTING DETAIL SHEET
9. CANTILEVER / OVERHEAD SIGN / SIGNAL SUPPORT NOTES SHEET

STANDARDS

E-100	CONSTRUCTION APPROACH SIGNS	01-02-04
E-101	CONSTRUCTION SIGN DETAILS	05-30-03
E-102	CONSTRUCTION SIGN DETAILS	06-30-03
E-102A	CONSTRUCTION SIGN DETAILS	05-01-04
E-106	TRAFFIC CONTROL - MISCELLANEOUS DETAILS	03-01-04
E-107	DELINEATION, BARRICADES AND DETOURS FOR CONSTRUCTION AREAS	06-30-03
E-107A	BREAKAWAY BARRICADES DETAILS	08-08-95
E-119	UTILITY WORK ZONE	03-01-04
E-120	STANDARD SIGN PLACEMENT - EXPRESSWAY & FREEWAY	08-08-95
E-121	STANDARD SIGN PLACEMENT - CONVENTIONAL ROADS	08-08-95
E-123	GUIDE SIGN PLACEMENT - MISCELLANEOUS DETAILS	03-16-04
E-170	TRAFFIC CONTROL SIGNALS PEDESTAL POST MOUNTED	11-04-99
E-171A	TRAFFIC CONTROL SIGNALS GENERAL NOTES & DETAILS	08-09-95
E-171B	TRAFFIC CONTROL SIGNALS MISC. DETAILS	08-09-95
E-171C	TRAFFIC CONTROL SIGNALS CANTILEVER MOUNTING DETAILS	08-09-95
E-172	VEHICLE DETECTOR LOOP DETAILS	08-09-95
E-173	PULL BOXES AND JUNCTION BOXES	08-09-95
E-175	POWER DROP STANCHIONS	11-17-93

CONVENTIONAL SYMBOLS

COUNTY LINE	
TOWN LINE	
LIMITS OF ACCESS	
POINT OF ACCESS	
FENCE LINE	
STONE WALL	
TRAVELED WAY	
GUARD RAIL	
RAILROAD	
SURVEY LINE	
CULVERT	
POWER POLE	
TELEPHONE POLE	
TREES	
CONTROL OF ACCESS	
PROPERTY LINE	
R.O.W. TAKING LINE	
SLOPE RIGHTS	
TOP OF CUT	
TOE OF SLOPE	

SURVEYED BY : R. GILMAN
SURVEYED DATE : 01-30-2001

DATUM
VERTICAL NAVD 88
HORIZONTAL NAD 83 (96)

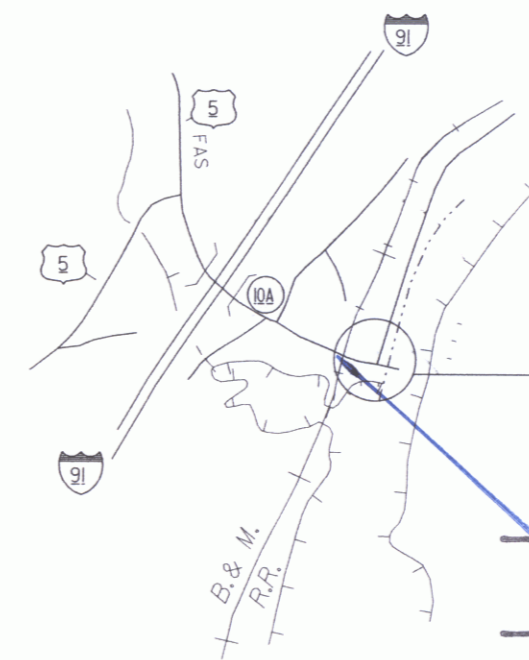
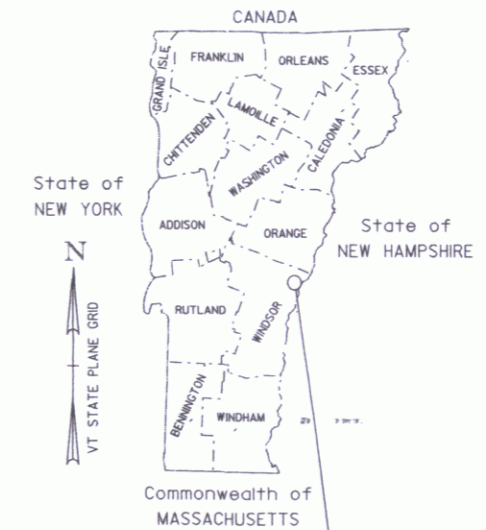

PROJECT LOCATION

Mouffson North Corporation
P.O. Box 348
Biddeford, ME 04005

Contractor

Signature

Title

Wardle Durr
Secretary of Transportation
or Duly Authorized Agent

2/15/06
Date

THESE PLANS ARE SUBJECT TO SUCH ENGINEERING CHANGES AS MAY BE REQUIRED BY THE FEDERAL HIGHWAY ADMINISTRATION OR THE DIRECTOR OF PROGRAM DEVELOPMENT.
CONSTRUCTION IS TO BE CARRIED ON IN ACCORDANCE WITH THESE PLANS AND THE STANDARD SPECIFICATIONS FOR CONSTRUCTION DATED 2001, AS APPROVED BY THE FEDERAL HIGHWAY ADMINISTRATION ON JANUARY 4, 2001 FOR USE ON THIS PROJECT, INCLUDING ALL SUBSEQUENT REVISIONS AND SUCH REVISED SPECIFICATIONS AND SPECIAL PROVISIONS AS ARE INCORPORATED IN THESE PLANS.

DIRECTOR OF PROGRAM DEVELOPMENT
APPROVED: *[Signature]* DATE 12-1-05
PROJECT MANAGER: BRUCE T. NYQUIST
PROJECT NAME: NORWICH
PROJECT NUMBER: STPG 0170 (3) S
SHEET 1 OF 9 SHEETS