

EXISTING TYPICAL SECTION

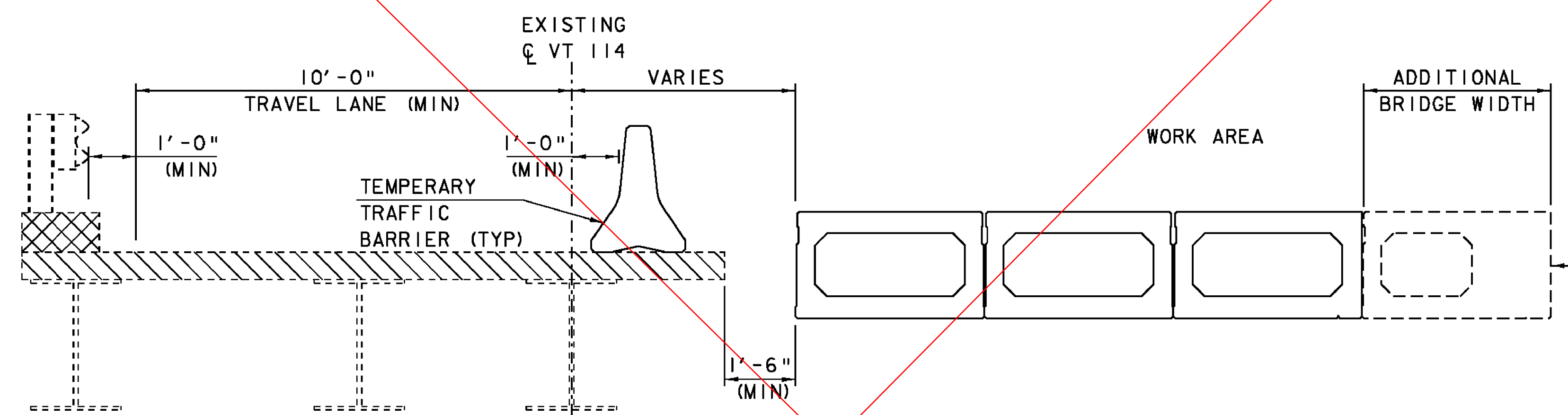

PHASE I

- VOID -

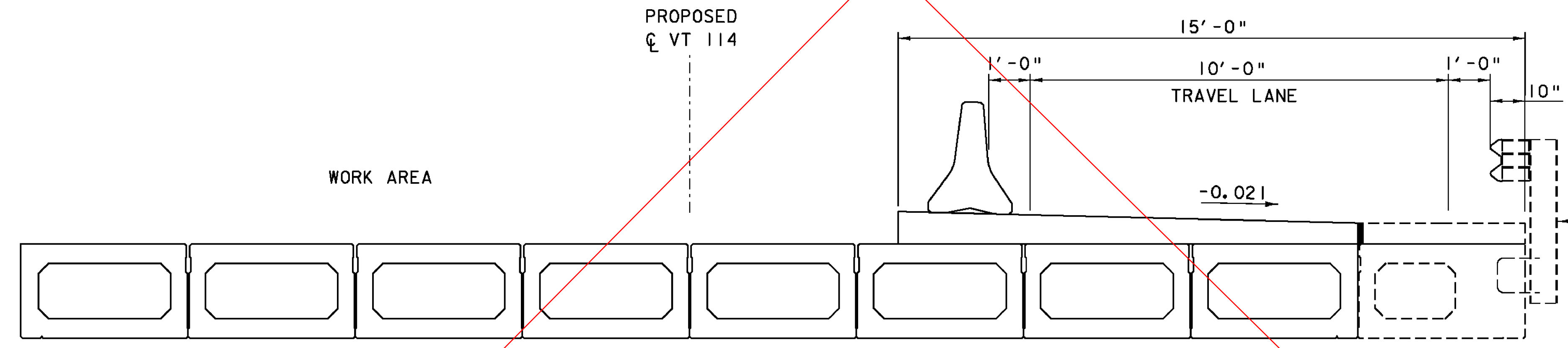

PHASE II

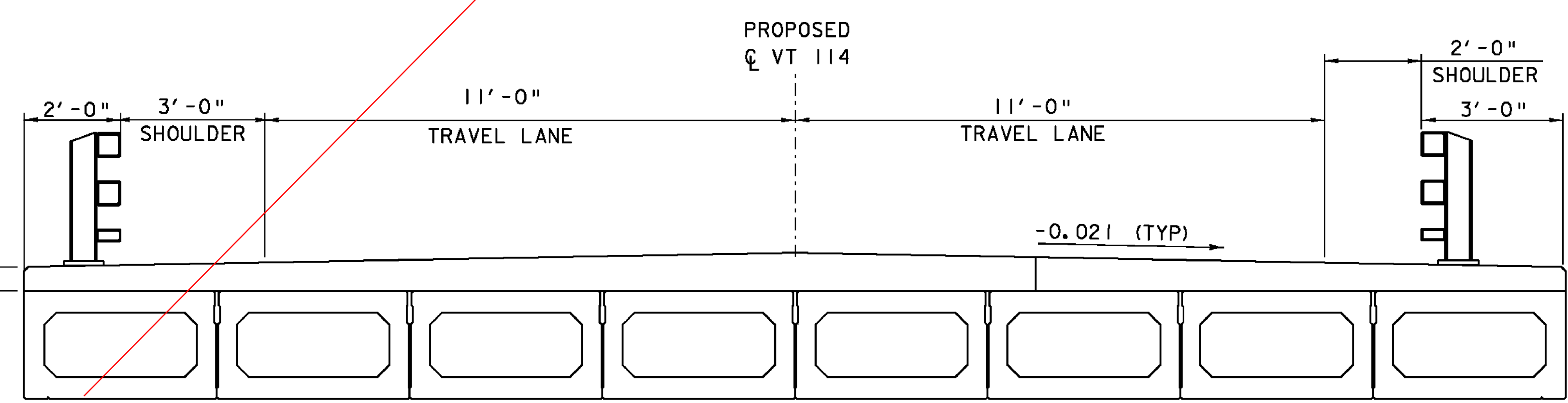

FINAL CONDITION

NOTE:

THE TRAFFIC CONTROL PHASING SHOWN IS OF A CONCEPTUAL NATURE ONLY. THE CONTRACTOR SHALL SUPPLY A DETAILED TRAFFIC CONTROL PLAN, WHICH NEED NOT UTILIZE PHASING OR THE PHASING SHOWN HERE. SEE THE TRAFFIC CONTROL NOTES AND THE SPECIFICATIONS FOR ITEM 900.645 SPECIAL PROVISION (TRAFFIC CONTROL, ALL-INCLUSIVE) FOR MORE DETAILS.

CONTRACTOR TO PROVIDE ADDITIONAL WIDTH FOR PHASED CONSTRUCTION. SEE SPECIAL PROVISIONS FOR ITEM 900.645 SPECIAL PROVISION (TEMPORARY BRIDGE WIDENING FOR PHASED CONSTRUCTION)

NOTE - THIS PHASED CONCEPTUAL DESIGN WAS NOT USED. THE CONTRACTOR WAS ABLE TO INSTALL A ONE-WAY TEMPORARY BRIDGE & CONSTRUCT A NEW BRIDGE IN A SINGLE PHASE.

TEMPORARY BRIDGE RAILING, AASHTO TL-2 (MIN) (PAID FOR UNDER SPECIAL PROVISION (TEMPORARY BRIDGE WIDENING FOR PHASED CONSTRUCTION))

6" (MIN) OVERLAY

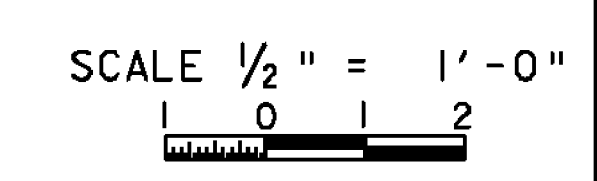

PROJECT NAME: EAST HAVEN	PLOT DATE: 08-AUG-2011
PROJECT NUMBER: BRP 0269(II)	DRAWN BY: R. PELLETT
FILE NAME: s00cl62phasing.dgn	CHECKED BY: J. LACROIX
PROJECT LEADER: K. HIGGINS	SHEET II OF 40
DESIGNED BY: J. LACROIX	
TRAFFIC PHASING TYPICALS	