

1

**BALLANTINE,
NORMAN A., JR. & SALLIE**

**BEGIN ROW PROJECT
STP 013-1(14)
STA. 18+60 60'LT**

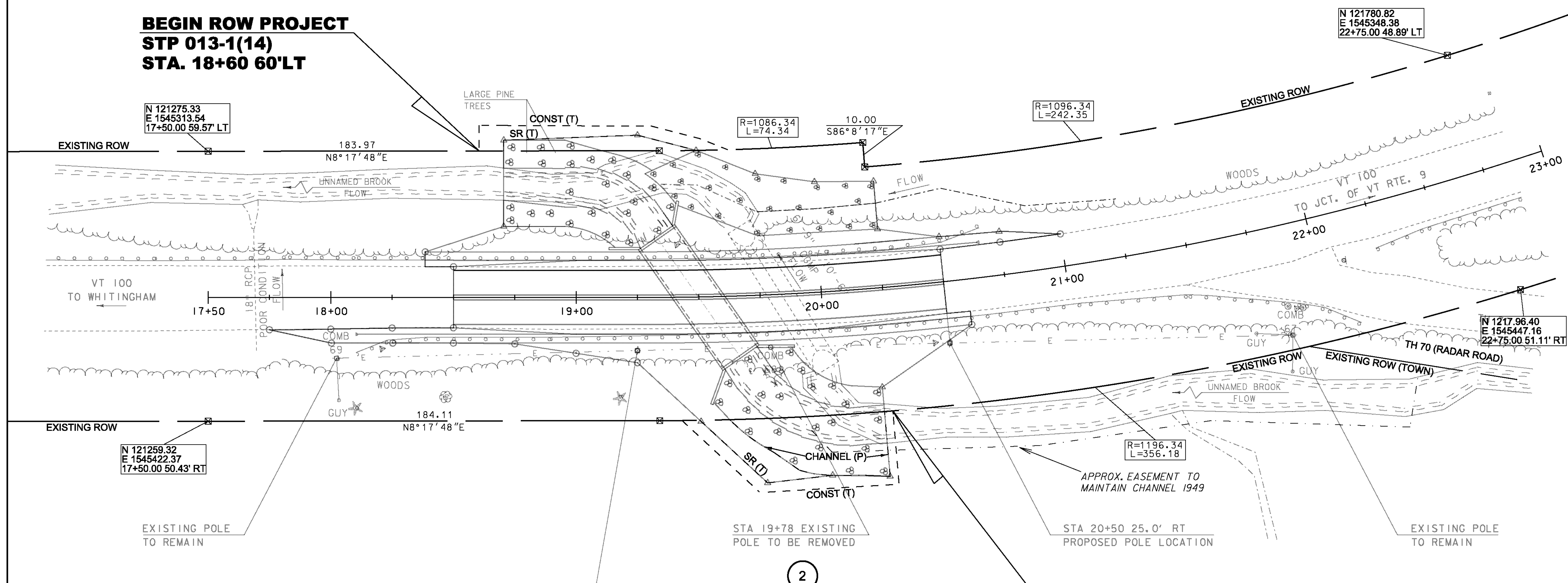

N 121275.33
E 1545313.54
17+50.00 59.57' LT

N 121259.32
E 1545422.37
17+50.00 50.43' RT

R=1086.34
L=74.34

R=1096.34
L=242.35

N 121780.82
E 1545348.38
22+75.00 48.89' LT

N 121796.40
E 1545447.16
22+75.00 51.11' RT

R=1196.34
L=356.18

2

MORENA, MARIE L.

**END ROW PROJECT
STP 013-1(14)
STA. 20+25 50'RT**

EXISTING BRIDGE DATA
6'-11" x 10'-8" CGMPA
CULVERT BUILT IN 1949
CULVERT BARREL LENGTH = 68 FT
WATERWAY AREA = 96 SF

LAYOUT SHEET

SCALE 1" = 20' - 0"
20 0 20

**FOR R.O.W.
USE ONLY**

LINES SHOWN ON THIS PLAN AS EXISTING PROPERTY LINES P/L ARE BELIEVED TO BE ACCURATE BUT SHOULD NOT BE RELIED UPON FOR PURPOSES UNRELATED TO THE STATE OF VERMONT'S ACQUISITION OF LAND AND RIGHTS FOR THIS PROJECT.

PROJECT NAME: WILMINGTON	PLOT DATE: 02-JAN-2014
PROJECT NUMBER: STP 013-1(14)	DRAWN BY: A. EGIZI
FILE NAME: r00b252lay.dgn	CHECKED BY: E. PIERCE
PROJECT LEADER: K. HIGGINS	SHEET 31 OF 31
DESIGNED BY: J. SALVATORI	
ROW LAYOUT SHEET 1 OF 1	