

**REINFORCED CONCRETE DROP INLET
WITH CAST IRON GRATE, TYPE D**

11+44.4 LT.
13+46.6 LT.

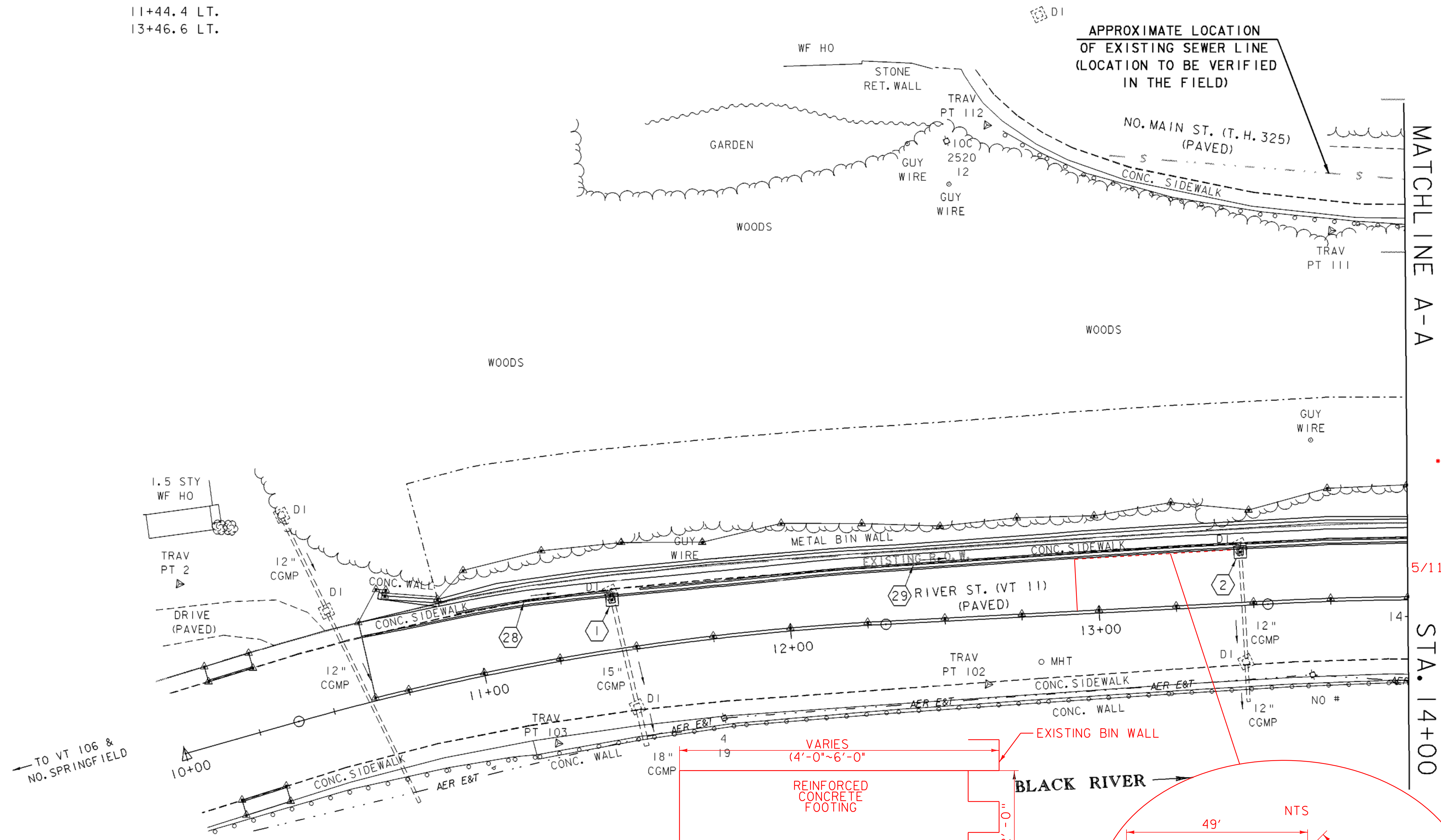
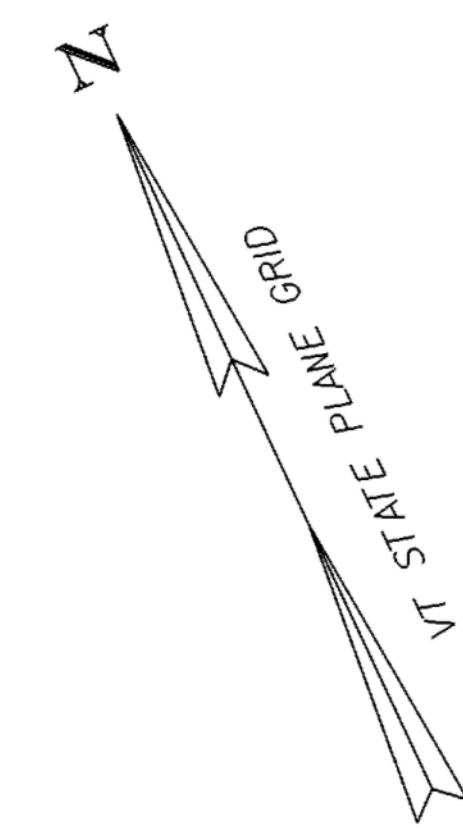

CB #2 - REMOVED EXISTING CB 4/28/05
- OLD BASE SITTING ON LEDGE
- 15' CMP 100% FULL OF DEBRIS

EXISTING CULVERT CROSSING PIPES @ CB #1-3
CLEANED BY JETTING/VAC. TRUCK ON 4/29/05
CHANGE ORDER TO FOLLOW

6" UNDERDRAIN INSTALLATION - MILLER
5/11/05 CB #2 (STA 13+46) TO STA 12+93 LT. = 56 LF
(SEE AS BUILT SKETCH)

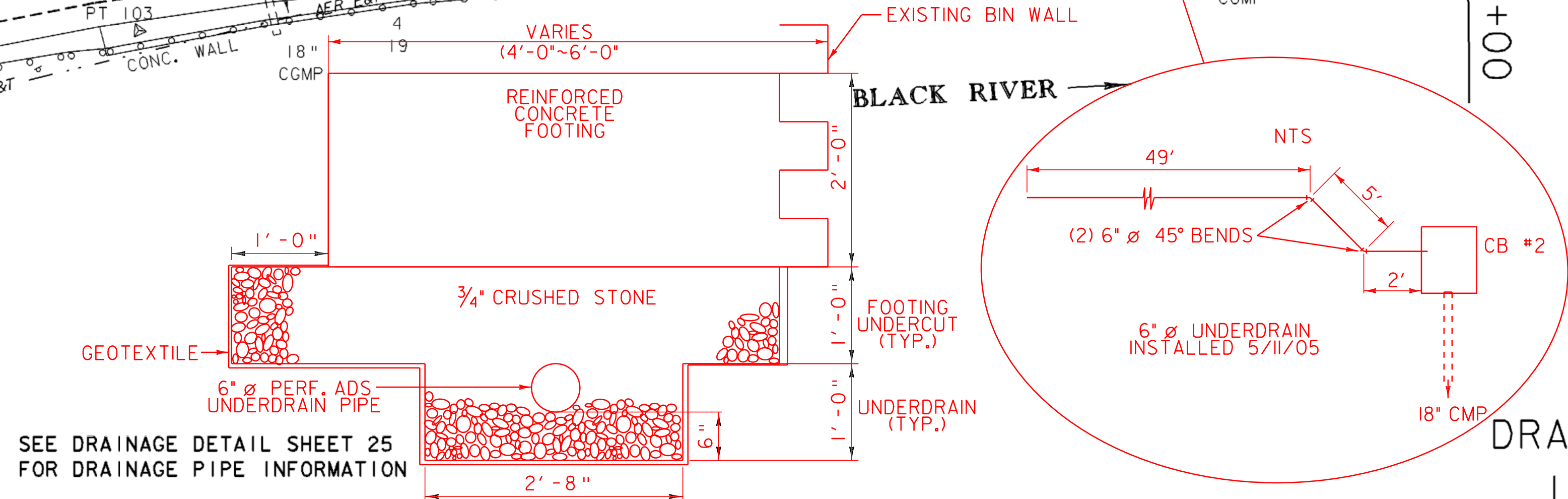

SEE DRAINAGE DETAIL SHEET 25
FOR DRAINAGE PIPE INFORMATION

NOTE:
UNDERGROUND UTILITIES ARE NOT SHOWN.

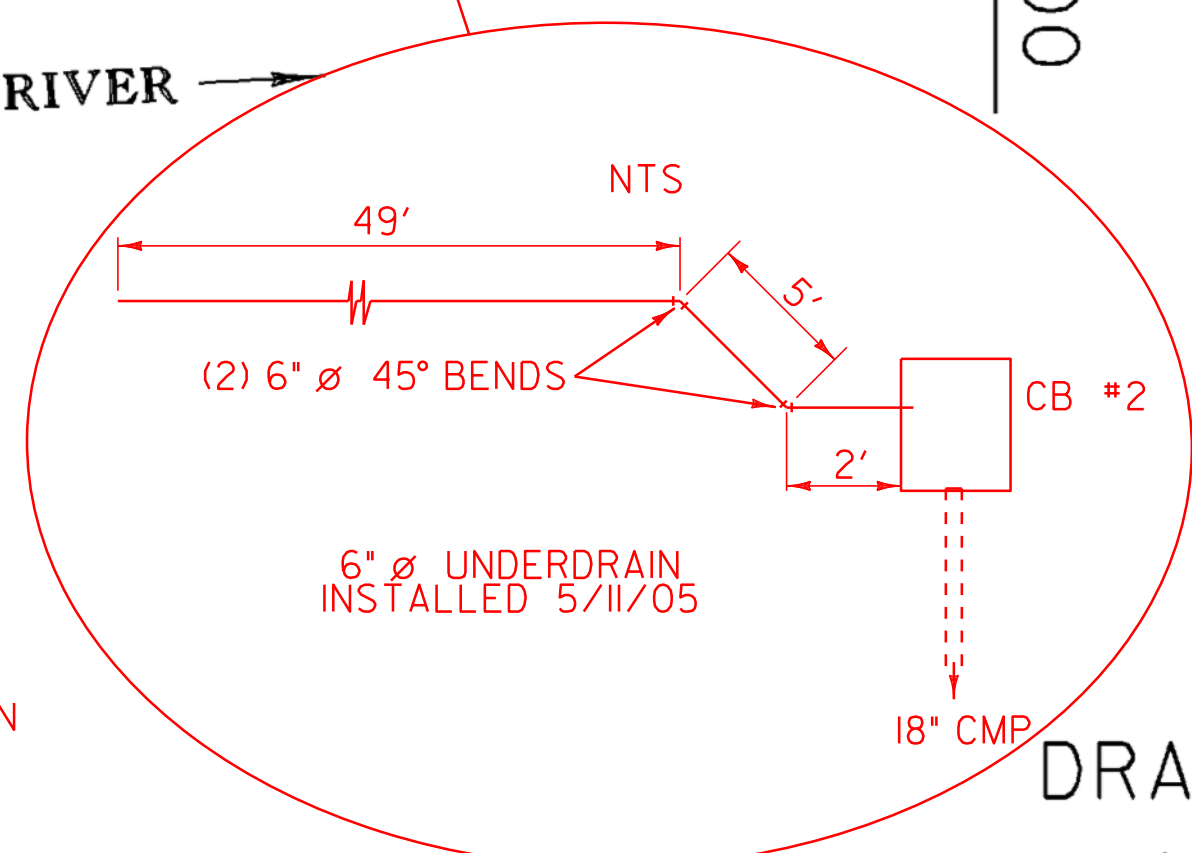

NOTE: SEE AS-BUILT SKETCHES
WITH ELEVATIONS IN FINALS
COMPUTATION BINDER FOR
ALL DRAINAGE STRUCTURES

**DRAINAGE & UTILITIES
LAYOUT SHEET (I)**

SCALE: 1" = 20'-0"
20 0 20

PROJECT NAME:	SPRINGFIELD	FILE NAME:	00b124/Structures/sb124d11.1	PLOT DATE:	17-AUG-2004
PROJECT NUMBER:	STP 016-2 (10)S	PROJECT MANAGER:	R. WHITCOMB	DRAWN BY:	G. ROY
		DESIGNED BY:	G. ROY	CHECKED BY:	R. WHITCOMB
				SHEET	21 OF 72