

**INDEX OF SHEETS**

- 1. TITLE SHEET
- 2-3. PROJECT TYPICAL SECTIONS
- 4-5. QUANTITY SHEETS
- 6-8. R.O.W. SHEETS
- 9. TIE SHEET
- 10. ALIGNMENT SHEET
- 11-12. LAYOUT SHEETS
- 13-14. WALL PROFILE SHEETS
- 15-16. HOLE STATIONS & ELEVATIONS SHEETS
- 17-18. TRAFFIC DETOUR SHEETS
- 19-20. TRAFFIC CONTROL SHEETS
- 21-22. DRAINAGE & UTILITIES LAYOUT SHEETS
- 23-24. DRAINAGE PROFILE SHEETS
- 25. DRAINAGE DETAIL SHEETS
- 26-33. BORING INFORMATION SHEETS
- 34-43. EROSION CONTROL SHEETS
- 44. PROJECT NOTES
- 45-47. WALL ELEVATION SHEETS
- 48. SOIL NAIL WALL DETAILS
- 49. RETAINING WALL NO.3 DETAILS
- 50. WALL DETAILS
- 51. CONCRETE STEPS AND METAL HAND RAILING DETAILS
- 52. HEADWALL DETAILS
- 53. REINFORCING STEEL SCHEDULE
- 54-61. VT 11 CROSS SECTIONS
- 62-67. TH 325 CROSS SECTIONS
- 68-72. REFERENCE SHEETS

**LIST OF STANDARDS**

- B-5 06-01-1994
- C-1 01-03-2000
- C-2B 01-03-2000
- C-3A 02-02-2004
- D-2 06-01-1994
- D-4 06-01-1994
- D-8 01-03-2000
- D-9 06-01-1994
- D-11 06-01-1994
- D-13 01-03-2000
- D-15 06-01-1994
- E-100 01-02-2004
- E-101 05-30-2003
- E-102 06-30-2003
- E-102A 08-08-1995
- E-106 03-01-2004
- E-107 06-30-2003
- E-107A 08-08-1995
- E-121 08-08-1995
- E-160 05-20-1999
- E-191 02-01-1999
- E-193 08-18-1995
- G-4 06-01-1994
- G-18 06-01-1994

# STATE OF VERMONT AGENCY OF TRANSPORTATION



## PROPOSED IMPROVEMENT SAFETY PROJECT TOWN OF SPRINGFIELD COUNTY OF WINDSOR

ROUTE NOS : TH 1/VT 11 (RIVER ST.) AND TH 325 (NORTH MAIN ST.)

**PROJECT LOCATION:** ALONG THE NORTH SIDE OF TH 1, BEGINNING APPROXIMATELY AT MM 4.234 AND EXTENDING SOUTHEASTERLY TO THE INTERSECTION OF NORTH MAIN STREET, ALSO ALONG NORTH MAIN STREET BEGINNING AT THE INTERSECTION OF TH 1 AND EXTENDING NORTHWESTERLY APPROXIMATELY 387 FEET.

**PROJECT DESCRIPTION:** PARTICIPATION: REPAIR AND REHABILITATION OF EXISTING METAL BINWALL ALONG LEFT SIDE OF TH 1, INSTALLATION OF NEW DRAINAGE AND SIDEWALK ALONG LEFT SIDE OF TH 325, COLD PLANING AND PLACING NEW BITUMINOUS CONC. PAVEMENT ON TH 325 .

**NON-PARTICIPATION:** REMOVAL AND DISPOSAL OF EXISTING METAL BINWALL, CONSTRUCTING STONE LINED DITCH AND REGRADING OF SIDE SLOPE ALONG RIGHT SIDE OF TH 325.

LENGTH OF PARTICIPATION PROJECT ALONG TH 1/VT 11: 713.50 FEET.  
LENGTH OF PARTICIPATION PROJECT ALONG TH 325: 386.44 FEET.

LENGTH OF NON-PARTICIPATION PROJECT ALONG TH 325: 170.00 FEET.

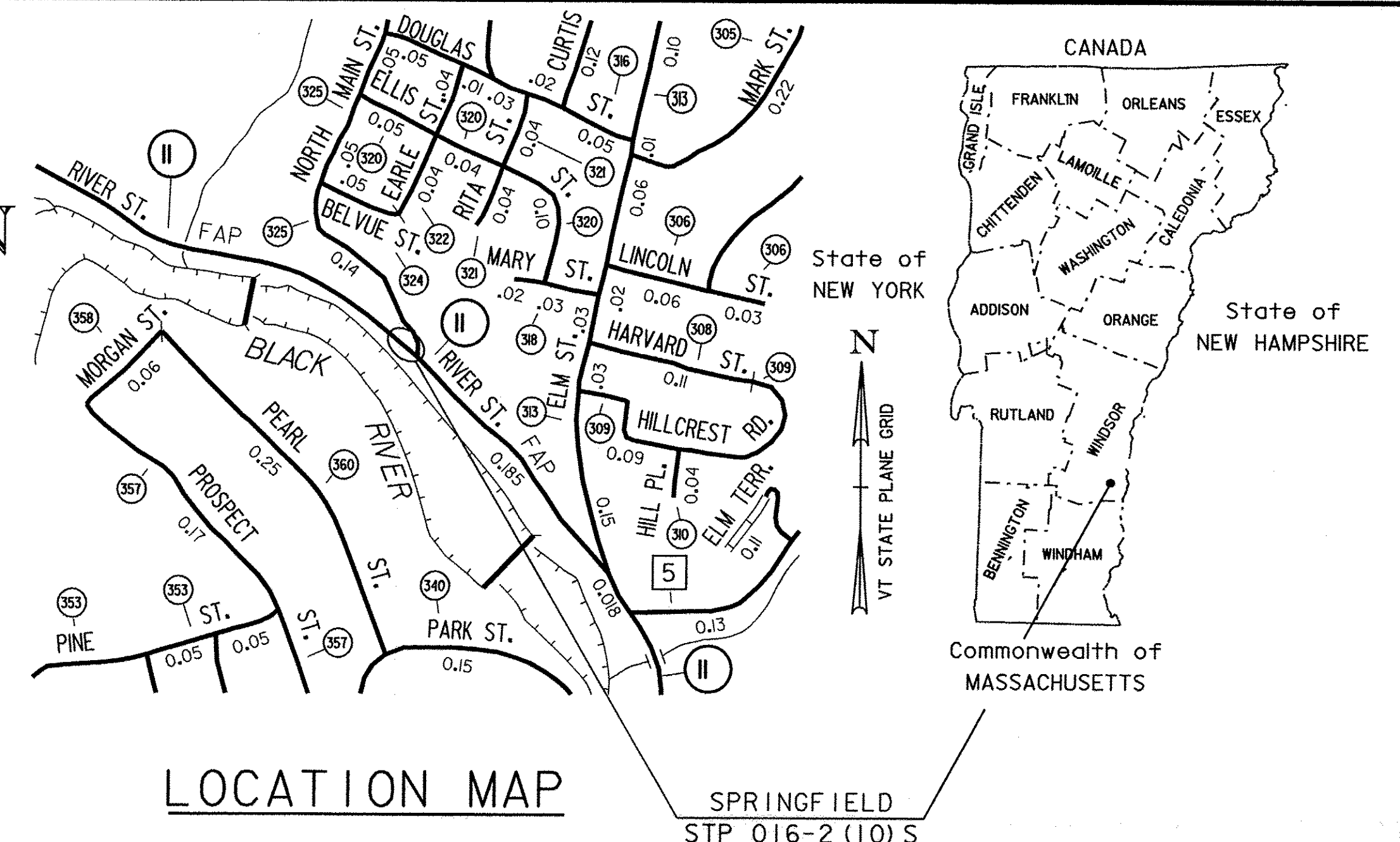

**LOCATION MAP**

SPRINGFIELD  
STP 016-2 (10) S  
VT. RTE. 11

**RECORD PLANS**

**CONTRACTOR:** MILLER CONSTRUCTION, INC. - WINDSOR, VT  
**RESIDENT ENGINEER:** BUTCH COLBY  
**CONSTRUCTION BEGAN:** APRIL 11, 2005  
**CONSTRUCTION COMPLETE:** SEPTEMBER 22, 2006  
**RECORD PLANS BY:** BUTCH COLBY & AMOS KEMPTON

I HEREBY CERTIFY THAT ALL THE CONSTRUCTION REQUIRED BY THIS SET OF DRAWINGS HAS BEEN ACCOMPLISHED AS INDICATED HEREIN.

BY *[Signature]* RESIDENT ENGINEER  
DATE 7/20/11

NOTE: Any further information concerning final quantities, amounts or other details relative to this project may be found at Central Files in the electronic archives.

**TRAFFIC DATA**

YEAR	ADT	DHV	% D	% T	ADTT
2004	12,300	1300	51	5	600
2024	16,500	1700	51	7	1200

18 Kip ESAL for flexible pavement from 2004 to 2024: 5,146,000  
18 Kip ESAL for flexible pavement from 2004 to 2044: 13,383,000  
Design speed: 35 mph

**CONVENTIONAL SYMBOLS**

- COUNTY LINE
- TOWN LINE
- LIMITS OF ACCESS
- POINT OF ACCESS
- FENCE LINE
- STONE WALL
- TRAVELED WAY
- GUARD RAIL
- RAILROAD
- SURVEY LINE
- CULVERT
- POWER POLE
- TELEPHONE POLE
- TREES
- CONTROL OF ACCESS
- PROPERTY LINE
- R.O.W. TAKING LINE
- SLOPE RIGHTS
- TOP OF CUT
- TOE OF SLOPE

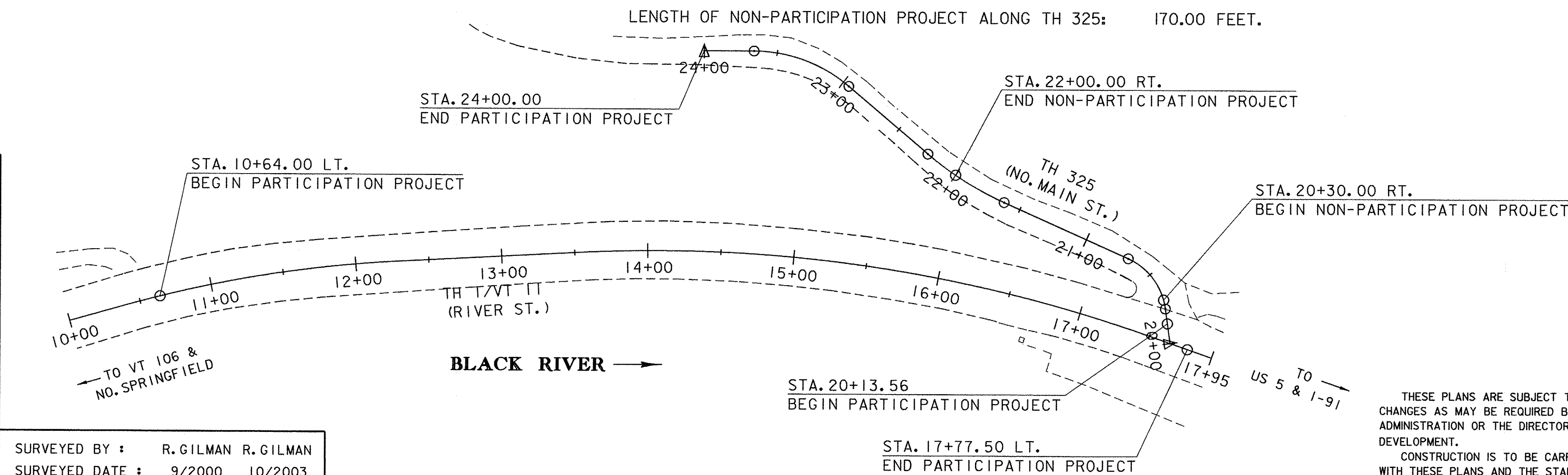

SURVEYED BY : R. GILMAN R. GILMAN  
SURVEYED DATE : 9/2000 10/2003

**DATUM**  
VERTICAL NAVD 88  
HORIZONTAL NAD83 (96)

SCALE: 1" = 50'-0"  
50 0 50

THESE PLANS ARE SUBJECT TO SUCH ENGINEERING CHANGES AS MAY BE REQUIRED BY THE FEDERAL HIGHWAY ADMINISTRATION OR THE DIRECTOR OF PROGRAM DEVELOPMENT.

CONSTRUCTION IS TO BE CARRIED ON IN ACCORDANCE WITH THESE PLANS AND THE STANDARD SPECIFICATIONS FOR CONSTRUCTION DATED 2001, AS APPROVED BY THE FEDERAL HIGHWAY ADMINISTRATION ON JANUARY 4, 2001 FOR USE ON THIS PROJECT, INCLUDING ALL SUBSEQUENT REVISIONS AND SUCH REVISED SPECIFICATIONS AND SPECIAL PROVISIONS AS ARE INCORPORATED IN THESE PLANS.

DIRECTOR OF PROGRAM DEVELOPMENT

APPROVED *[Signature]* DATE 8/4/09

PROJECT MANAGER : R. WHITCOMB

PROJECT NAME : SPRINGFIELD

PROJECT NUMBER : STP 016-2 (10) S

SHEET 1 OF 72 SHEETS