

30-136

WOOD GUARD RAIL REQUIRED			CABLE GUARD RAIL REQUIRED			NEW REIN. CONCRETE PIPE CULVERTS REQUIRED						
CULVERT STATION	LEFT	RIGHT	STATIONS	LEFT	RIGHT	STR. DIAM.	LEN.	CONC. A	CONC. C	REIN. STEEL	D.I.	EXPOSED TOP
130+80	-	24'	130+38-135+26	4.88'	-	130+50	18'	4.0'	1.5	1.5	174	1b.

CONCRETE CURB & GUTTER REQUIRED				
STATIONS	L OR R	WIDTH	CURE SET	STEEL
130+80-134+50	L	2'-0"	6'	24 ex 733 lbs.

GROUTED COBBLE GUTTER REQUIRED				
STATIONS	L OR R	WIDTH	LENGTH	AREA
134+50-136+00	R	3'-0"	45'-0"	150 sq yds.

Joints in Curb & Gutter section to be placed so that one will occur opposite every transverse joint in the pavement.

Note: Joints in Curb and Gutter not to exceed 9" apart. Provisioned bituminous expansion joint filler, 1/2" thick, to be placed between every 5th section (every 40') (drainage joints to be either full joints pointed with bituminous material or cut plate joints).

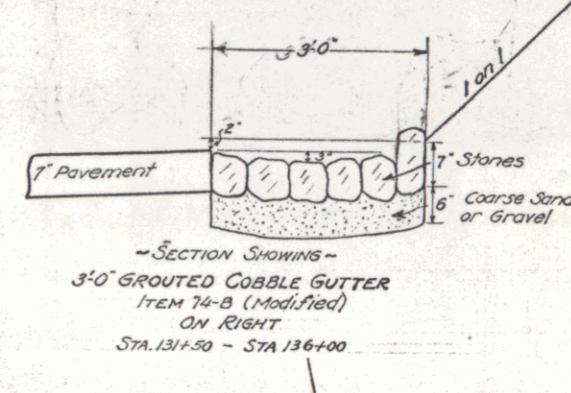
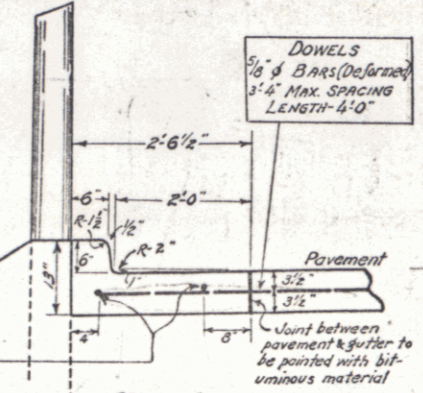

CURVE

Δ	25°-23' Lt
D	9"
E	637.3
T	143.4
L	930.5
E	68.4

Curve not widened

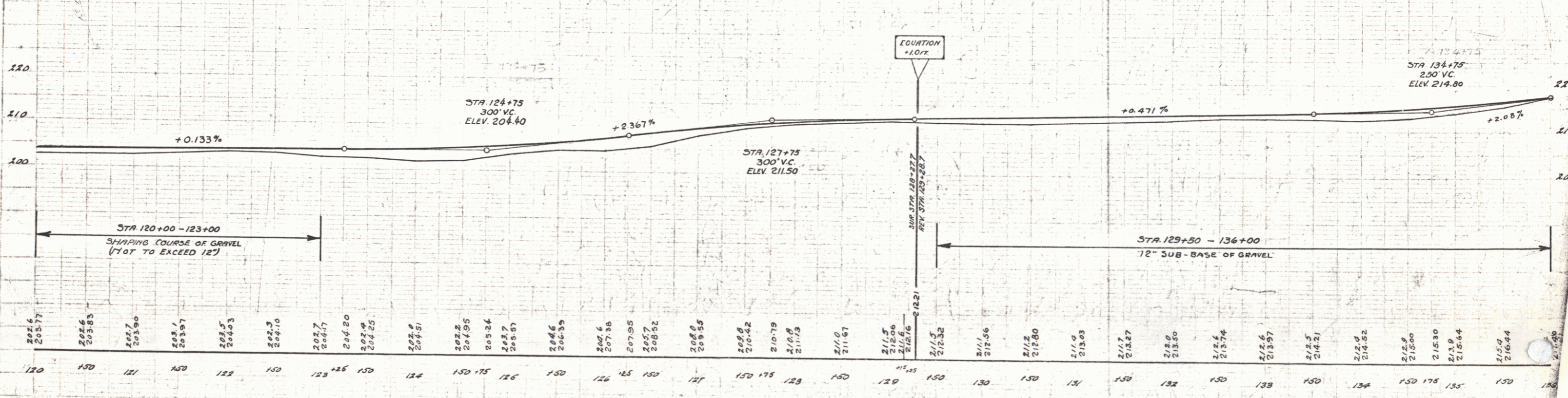
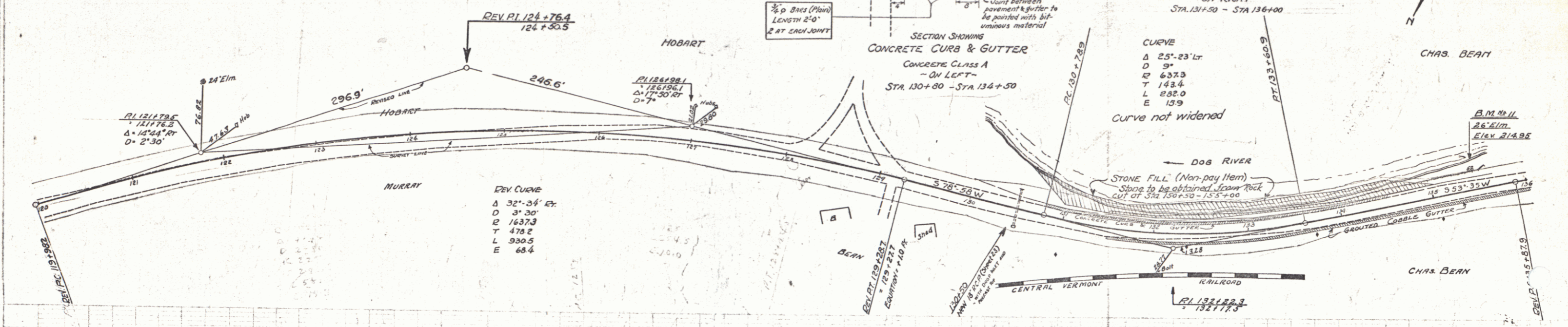

B.M. #11 Spike in root of 26' Elm Left of Sta. 135+45 Elev 214.95

FED. ROAD DIST. NO.	STATE	FED. AID PROJ. NO.	FISCAL YEAR	SHEET NO.	TOTAL SHEETS
VI	VT	70-C	1950	12	66

1948  
 1949  
 1950  
 1951  
 1952  
 1953  
 1954  
 1955  
 1956  
 1957  
 1958  
 1959  
 1960  
 1961  
 1962  
 1963  
 1964  
 1965  
 1966  
 1967  
 1968  
 1969  
 1970  
 1971  
 1972  
 1973  
 1974  
 1975  
 1976  
 1977  
 1978  
 1979  
 1980  
 1981  
 1982  
 1983  
 1984  
 1985  
 1986  
 1987  
 1988  
 1989  
 1990  
 1991  
 1992  
 1993  
 1994  
 1995  
 1996  
 1997  
 1998  
 1999  
 2000  
 2001  
 2002  
 2003  
 2004  
 2005  
 2006  
 2007  
 2008  
 2009  
 2010  
 2011  
 2012  
 2013  
 2014  
 2015  
 2016  
 2017  
 2018  
 2019  
 2020  
 2021  
 2022  
 2023  
 2024  
 2025  
 2026  
 2027  
 2028  
 2029  
 2030  
 2031  
 2032  
 2033  
 2034  
 2035  
 2036  
 2037  
 2038  
 2039  
 2040  
 2041  
 2042  
 2043  
 2044  
 2045  
 2046  
 2047  
 2048  
 2049  
 2050  
 2051  
 2052  
 2053  
 2054  
 2055  
 2056  
 2057  
 2058  
 2059  
 2060  
 2061  
 2062  
 2063  
 2064  
 2065  
 2066  
 2067  
 2068  
 2069  
 2070  
 2071  
 2072  
 2073  
 2074  
 2075  
 2076  
 2077  
 2078  
 2079  
 2080  
 2081  
 2082  
 2083  
 2084  
 2085  
 2086  
 2087  
 2088  
 2089  
 2090  
 2091  
 2092  
 2093  
 2094  
 2095  
 2096  
 2097  
 2098  
 2099  
 2100  
 2101  
 2102  
 2103  
 2104  
 2105  
 2106  
 2107  
 2108  
 2109  
 2110  
 2111  
 2112  
 2113  
 2114  
 2115  
 2116  
 2117  
 2118  
 2119  
 2120  
 2121  
 2122  
 2123  
 2124  
 2125  
 2126  
 2127  
 2128  
 2129  
 2130  
 2131  
 2132  
 2133  
 2134  
 2135  
 2136  
 2137  
 2138  
 2139  
 2140  
 2141  
 2142  
 2143  
 2144  
 2145  
 2146  
 2147  
 2148  
 2149  
 2150  
 2151  
 2152  
 2153  
 2154  
 2155  
 2156  
 2157  
 2158  
 2159  
 2160  
 2161  
 2162  
 2163  
 2164  
 2165  
 2166  
 2167  
 2168  
 2169  
 2170  
 2171  
 2172  
 2173  
 2174  
 2175  
 2176  
 2177  
 2178  
 2179  
 2180  
 2181  
 2182  
 2183  
 2184  
 2185  
 2186  
 2187  
 2188  
 2189  
 2190  
 2191  
 2192  
 2193  
 2194  
 2195  
 2196  
 2197  
 2198  
 2199  
 2200

SERIES F No. 75C  
SHEET 12 OF 66

10