

WOOD GUARD RAIL REQUIRED

CULVERT STATION	LEFT	RIGHT
68+35	24'	24'
57+00	24'	24'

NEW REINFORCED CONCRETE PIPE CULVERTS REQUIRED

STATION	DIAM	LENG	CODE	CONC. C	REIN. STEEL
68+35	18"	36'	27 cy.	—	102 lbs.
57+00	15"	36'	1.8 cy.	—	54 lbs.

DRIVEWAY PIPE CULVERTS REQUIRED

STATION	LEN	DIAM	LENG	CEMENT	PIED	MASONRY
63+30	LT	24"	30'	4.0	cu. yds.	
64+35	LT	24"	24'	4.0	cu. yds.	
64+60	Rt	24"	24'	4.0	cu. yds.	

GROUTED COBBLE GUTTER REQUIRED

STATIONS	LEN	R	WIDTH	LENGTH	AREA
59+50-62+00	LT	VARIABLE	2'-0"	270.50	549.00
56+00-57+00	Rt	—	1'-0"	111	80.34
56+00-59+50	LT	5'-0"	1'-30"	72	34.56
62+00-63+30	LT	—	1'-30"	134.4	53.34

DESIGNED BY: [Signature]
 CHECKED BY: [Signature]
 DATE: 7-8-1930
 SHEET NO. 66

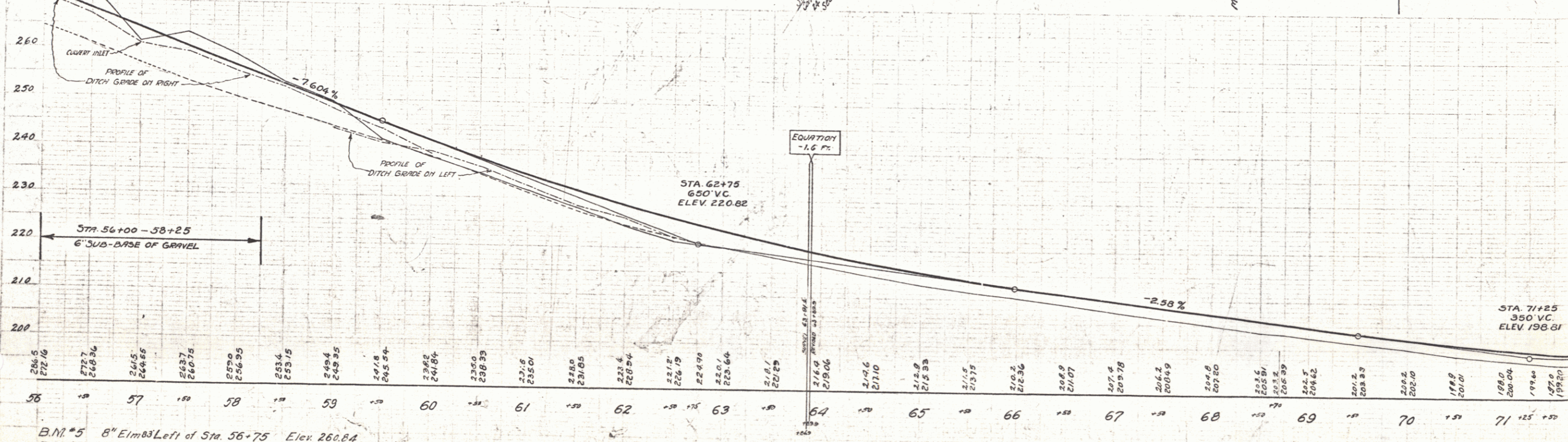
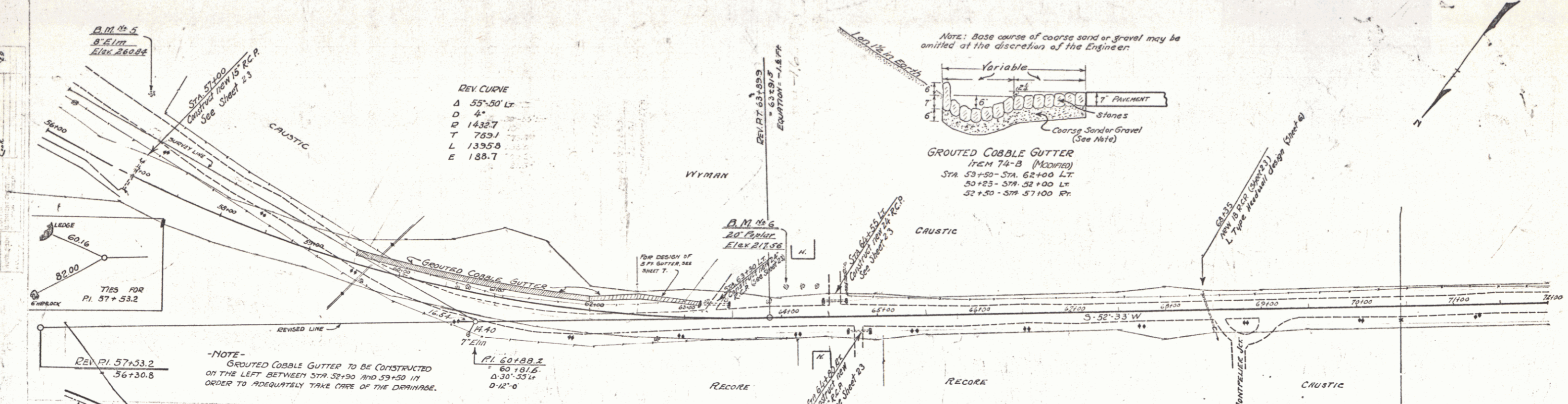

B.M. #5 8" Elm 83' Left of Sta. 56+75 Elev. 260.84
 B.M. #6 20" Poplar 32' Left of Sta. 64+05 Elev. 217.56

SERIES F
 SHEET 6