

CABLE GUARD RAIL REQUIRED		NEW REIN. CONCRETE PIPE CULVERTS REQUIRED			GROUTED COBBLE GUTTER REQUIRED			DRAINWAY PIPE CULVERT REQUIRED									
STATIONS	LEFT	RIGHT	STA.	DIAM.	LENS	CONC. CONC.	REIN. STEEL	STATIONS	L+R	WIDTH	LENS	AREA	STATION	L+R	DIAM.	LENS	CEMENT PASTE MASONRY
40+00 - 40+66	46'	46'	52+34	24"	112'	3.6 cu yd	127 lbs.	50+28 - 52+00	LT	VARIABLE	170'	194 sq yd	47+34	LT	18"	24'	3.3 cu yd
51+43 - 52+07	64'	-						52+00 - 52+30	RT	"	350'	389 sq yd					
52+43 - 53+07	64'	-						52+00 - 52+30	LT	5'-0"	90'	50 sq yd					
								52+30 - 52+00	LT	-	810'	178 sq yd					

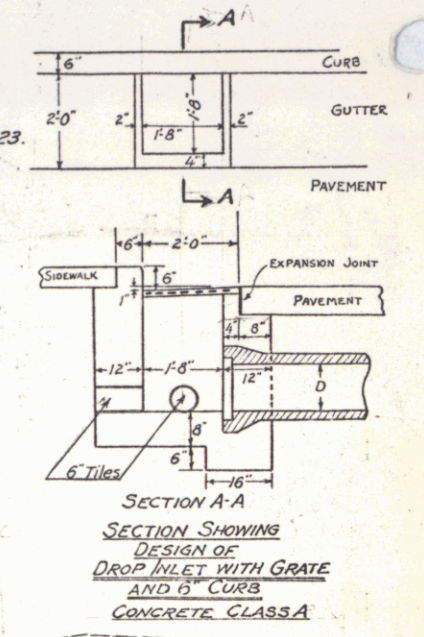
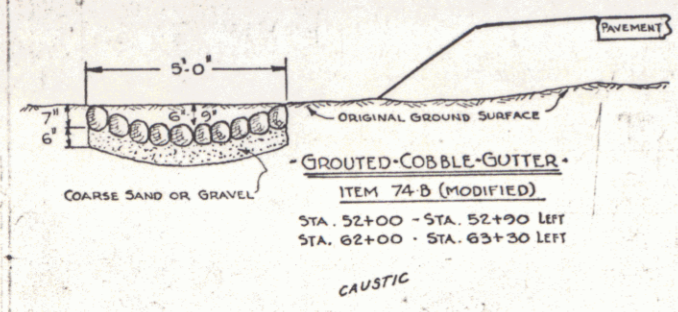
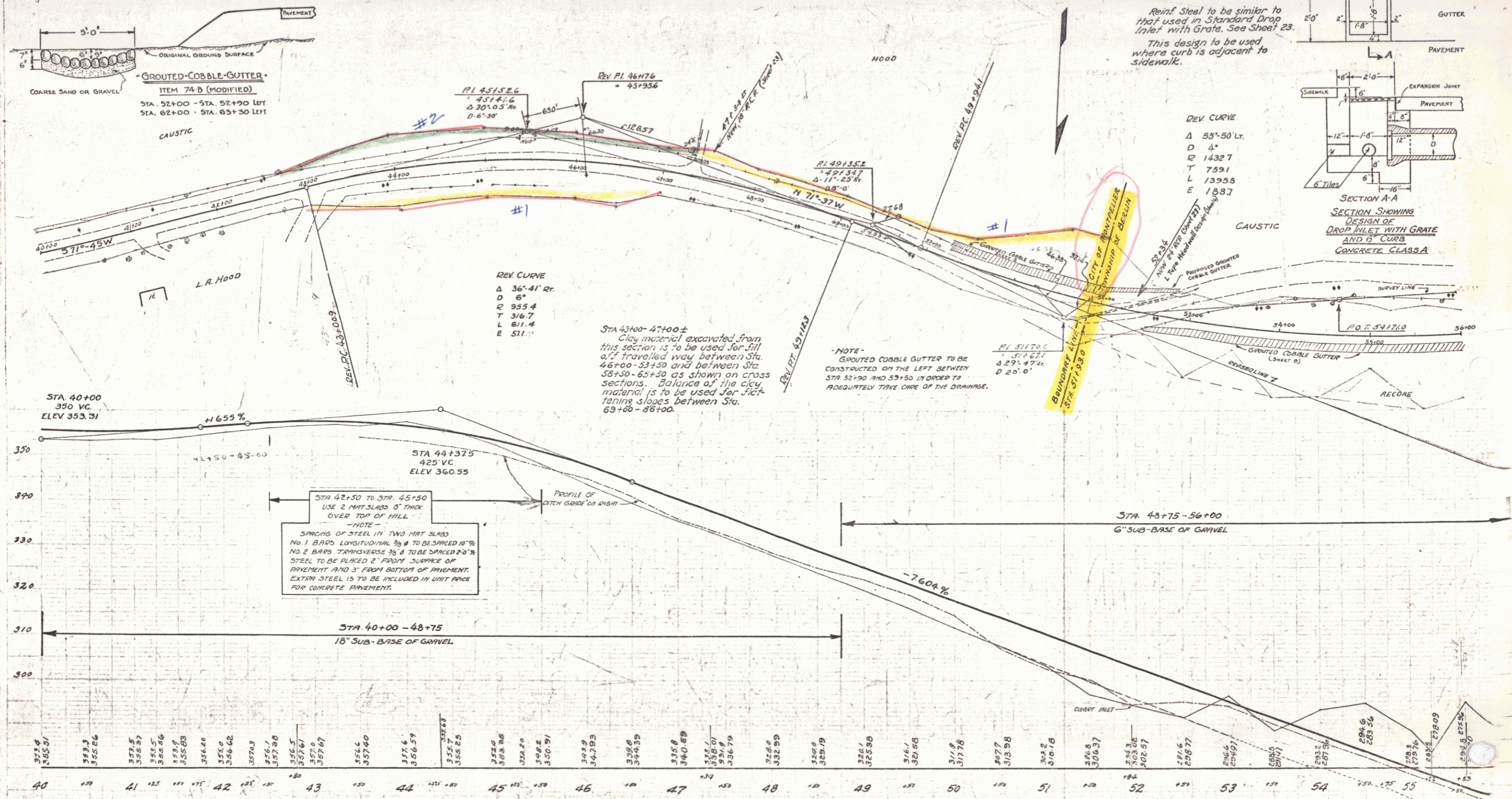

Rein. Steel to be similar to that used in Standard Drop Inlet with Grate. See Sheet 23. This design to be used where curb is adjacent to sidewalk.

STA 43+00 - 47+00 ± City material excavated from this section is to be used for fill or travelled way between Sta. 46+00 - 53+50 and between Sta. 53+00 - 53+50 as shown on cross sections. Balance of the city material is to be used for flattening slopes between Sta. 69+00 - 86+00.

NOTE - GROUTED COBBLE GUTTER TO BE CONSTRUCTED ON THE LEFT BETWEEN STA 52+30 AND 53+50 IN ORDER TO ADEQUATELY TAKE CARE OF THE DRAINAGE.

STA 42+50 TO STA 45+50 USE 2 MAT SLABS 8" THICK OVER TOP OF HILL. NOTE - SPACING OF STEEL IN TWO MAT SLABS NO. 1 BARS LONGITUDINAL 36" TO BE SPACED 18" NO. 2 BARS TRANSVERSE 36" TO BE SPACED 24" STEEL TO BE PLACED 2" FROM SURFACE OF PAVEMENT AND 3" FROM BOTTOM OF PAVEMENT. EXTRA STEEL IS TO BE INCLUDED IN UNIT PRICE FOR CONCRETE PAVEMENT.

STA.	ELEV.	STA.	ELEV.	STA.	ELEV.	STA.	ELEV.	STA.	ELEV.	STA.	ELEV.	STA.	ELEV.	STA.	ELEV.	STA.	ELEV.	STA.	ELEV.												
40	353.31	41	353.3	42	353.3	43	353.3	44	353.3	45	353.3	46	353.3	47	353.3	48	353.3	49	353.3	50	353.3	51	353.3	52	353.3	53	353.3	54	353.3	55	353.3