

INDEX OF SHEETS

Index of Sheets

- 1 Title Sheet
- 2 Typical Sections
- 3 Plan, Quantity and Grading Sheet
- 4 Earthwork and Grade Sheet
- 5-8 Layouts and Profile Sheet
- 9-23 Cross Sections

STATE OF VERMONT
DEPARTMENT OF HIGHWAYS



Pin# 99R 995

FEDERAL AID PROJECT
PROPOSED IMPROVEMENT
TOWN OF NORTHFIELD

COUNTY OF WASHINGTON
MONTPELIER-RANDOLPH ROAD
VT. RTE. 12

BEGINNING AT A POINT APPROXIMATELY 0.729 MILES
SOUTHERLY OF THE BERLIN-NORTHFIELD TOWN LINE
AND EXTENDING 0.341 MILES NORTHERLY.

LENGTH OF ROADWAY	FEET	MILES
LENGTH OF BRIDGE	FEET	MILES
LENGTH OF PROJECT	1800.00 FEET	0.341 MILES
LENGTH OF R.O.W PROJ	2190.14 FEET	0.414 MILES

R.O.W. PLANS

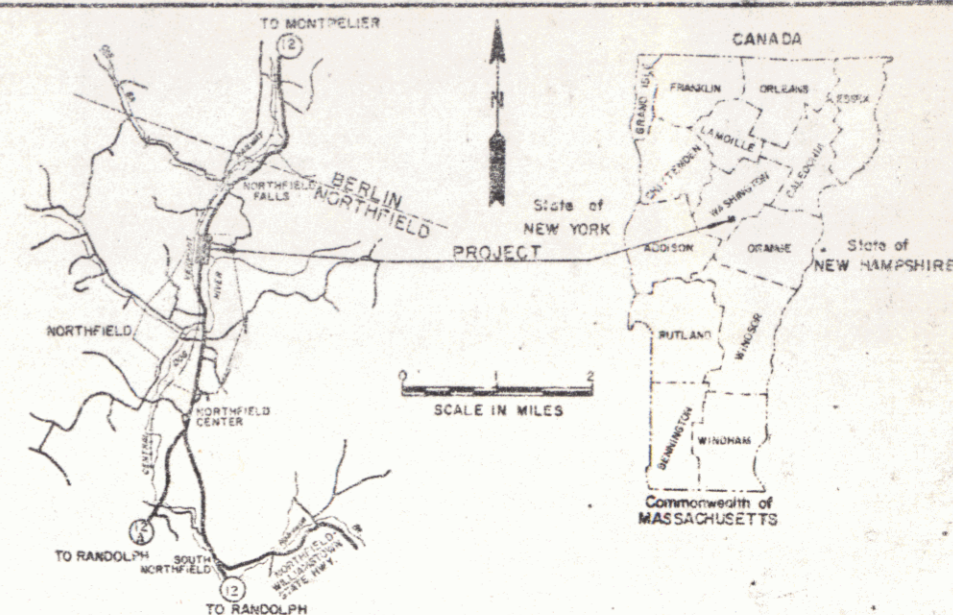

BEGIN ROW PROJ. RF-BRF-035-2(3)
STA. REV. VT. RTE. 12 17+19.86 LT.

END R.O.W. PROJ. RF-BRF-035-2(3)
STA. REV. VT. RTE. 12 39+10 LT.

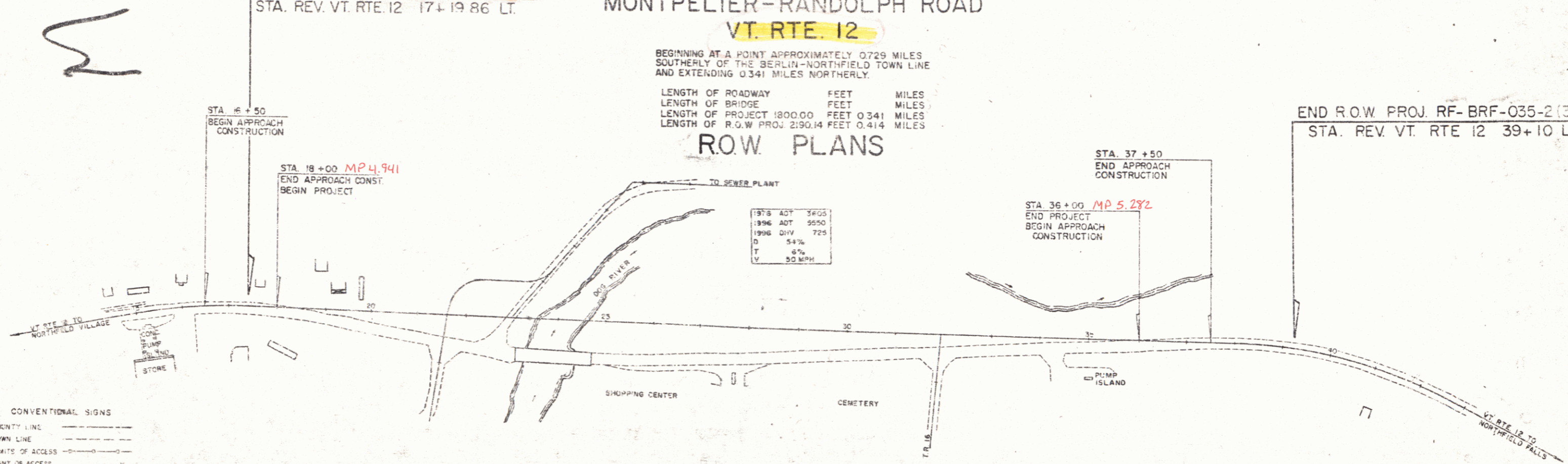

1978 ADT	3605
1996 ADT	9550
1996 DIV	729
D	54%
T	6%
V	50 MPH

CONVENTIONAL SIGNS

- COUNTY LINE
- TOWN LINE
- LIMITS OF ACCESS
- POINT OF ACCESS
- FENCE LINE
- STONE WALL
- TRAVELED WAY
- QUAD RAIL
- RAILROAD
- SURVEY LINE
- CULVERT
- POWER POLE
- TELEPHONE POLE
- TREES
- F.A. CONST. IDENTIFICATION SIGNS
- PROPERTY LINE
- R.O.W. TAKING LINE
- SLOPE RIGHTS
- TOP OF DUT
- TOE OF SLOPE

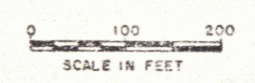

These plans are subject to such engineering changes as may be required by the Federal Highway Administration or the Chief Engineer.
Construction is to be carried on in accordance with these plans and the Standard Specifications for Highway and Bridge Construction dated January 3, 1972 as approved by the Federal Highway Administration on December 25, 1971 for use on this project, including all subsequent revisions and such revised specifications and special provisions as are incorporated in these plans.

SUBMITTED BY ORDER OF THE STATE HIGHWAY BOARD

APPROVED *S. H. [Signature]* 1-5-76
CHIEF ENGINEER

DEPARTMENT OF TRANSPORTATION
FEDERAL HIGHWAY ADMINISTRATION

APPROVED _____ DATE _____
DIVISION ENGINEER

PROJECT RF-BRF NO. 035-2(3)
SHEET 1 OF 7 SHEETS

APPROVED *[Signature]*
R.O.W. DIRECTOR
DATE 1-5-76

9/23 12-19-76