

WOOD GUARD RAIL REQUIRED
 STATION LEFT RIGHT
 423-75 24'

CABLE GUARD RAIL REQUIRED
 STATION LT. RT.
 423 104-424 100 06'

DEEP INLETS REQUIRED

Sta.	Conc. H.	Size	Grade
417+23.07	18" Cy	30"	1
417+50.04	18"	30"	1
417+60.04	18"	30"	1
419+00.01	18"	30"	1

REINFC CONC. PIPE REQUIRED

Stations	Size	Length
417+23.07 - 417+50.04	12"	26'
417+23.07 - 417+60.04	12"	36'
416+00 - 417+23.07	12"	124'
419+00 - 417+23.07	12"	176'
423+22 - 423+70 RT	12"	48'

NEW REINFC CONCRETE BOX CULVERT REQUIRED
 STATION SIZE CONC. REINFC STEEL
 423+96 4x2 31cy 2100*

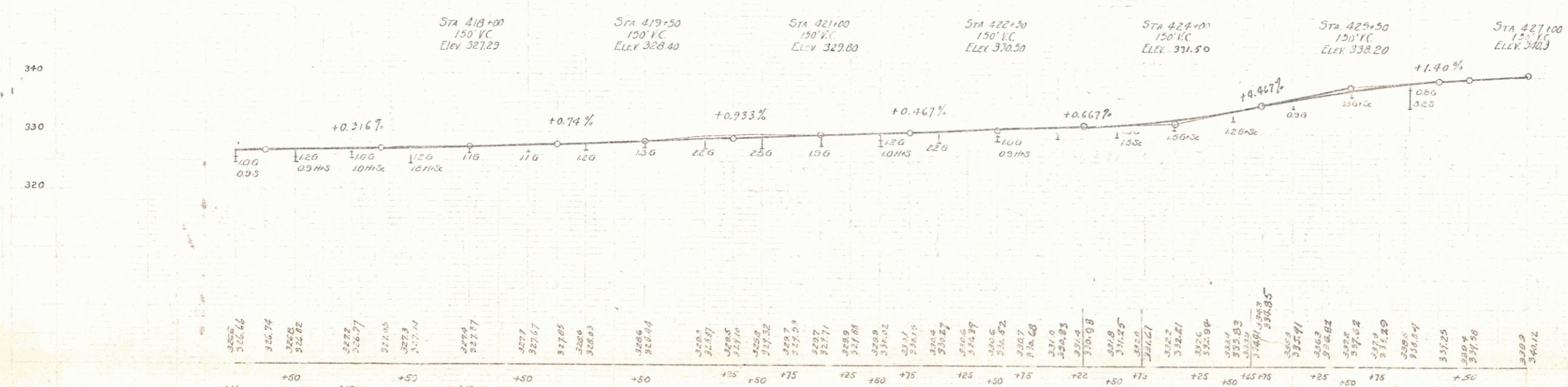
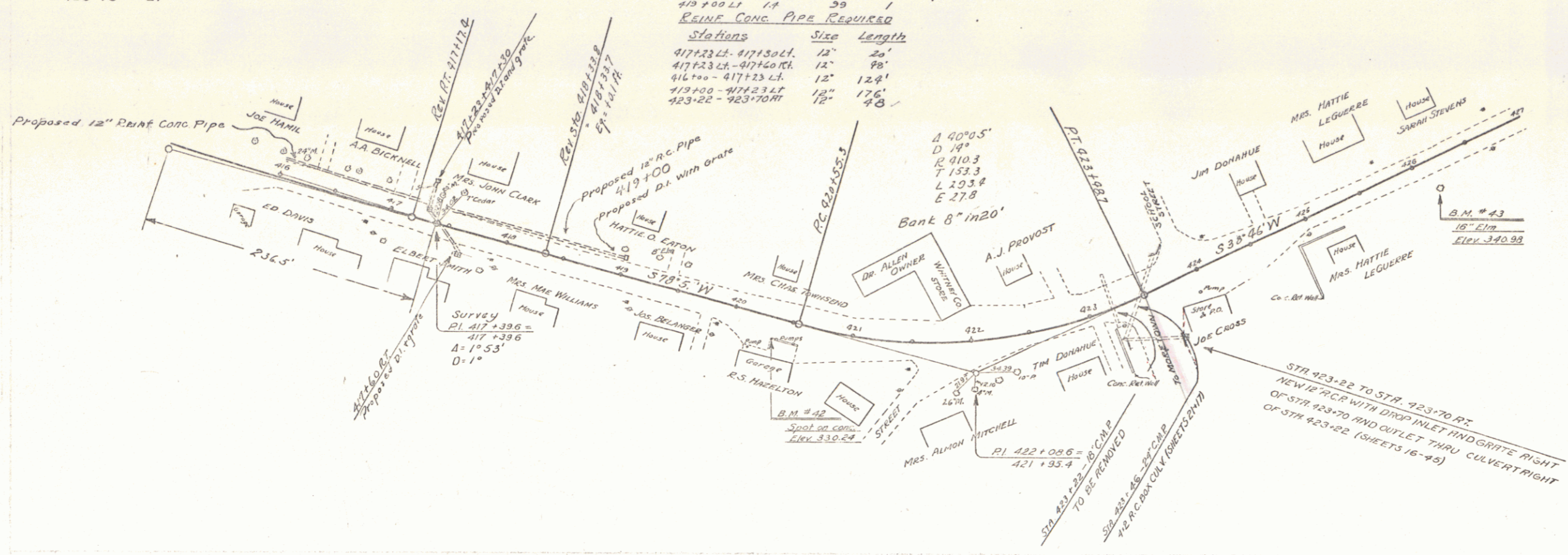

B.M. #42 Gas pump foundation Northfield Falls Filling Sta 170 ft. rt. sta 420+36 Elev 330.24
 B.M. #43 Spike in rest 16" Elm 25.0 ft. rt. sta. 426+13 Elev 340.98

REVISIONS AUG. 29, 1930

STR 423-75 PRESENT CULV. IS C.M.P. TO BE REMOVED INSTEAD OF REINFC.	24" OF WOOD GUARD RAIL ADDED LEFT OF STA. 423+75.
STR 423-96 PRESENT CULV. IS C.M.P. NEW REINFC BOX CULVERT TO BE INSTALLED.	NEW 12" DIA. GRATE WITH 48" OF 12" W.C.P. FROM 423+70 - 423+70 RT.

SERIES F No. 78-E
 SHEET 11 OF