

CABLE GUARD RAIL REQUIRED

Stations	LL	RL
37610-376190	80'	80'
382+74-387+74	50'	-
382+74-391+02	-	832

REINF. CONC. PIPE CULVERT REQUIRED

Station	Diam.	Length	Conc. A.	Reinf. Steel
376+76	18"	52'	1.8 c.y.	54"

12" REINF. CONC. PIPE REQUIRED

Sta.	Diam.	Length	Cem. Rub. Mts.
382+24 LT.	12"	24'	2.30 y.

REINF. CONC. BOX CULVERTS REQUIRED

Sta.	Size	Conc. A.	Steel
383+28	3x3'	2.83 c.y.	1859"

STD. UNDERDRAIN WITH 6" CORR. GALV. NET PIPE

Sta.	Length	Cem. Rub. Mts.
378+00-380+94 LT.	294'	1.0 c.y.
381+04-382+32 LT.	128'	-

6" VIT. CLAY PIPE REQUIRED

Sta.	Length	Cem. Rub. Mts.
376160	18'	1.30 y.

Existing file underdrain to be retained. Construct headwall on right, extending underdrain as necessary.

NOTE FOR DISPOSAL OF ROCK EXCAVATION
 Rock excavation over the entire project is to be used at the locations and in the manner herein after described:
 1. Such amount as may be necessary shall be placed under the direction of the Engineer as protection for the toe of slope on right of Sta. 3242 and 3292, also 9202 right.
 2. Such amount of rock as may be necessary shall be used as riprap for bank protection in the relocated river channel, as protection along the present river bank from 380+50 to 389+00 as riprap in the roadway fill. Sta. 382 to 387+75 and as stone fill for river cut off.
 3. The balance of rock excavated over the entire project shall be used in the roadway fill Sta. 383+00 to 387+00.

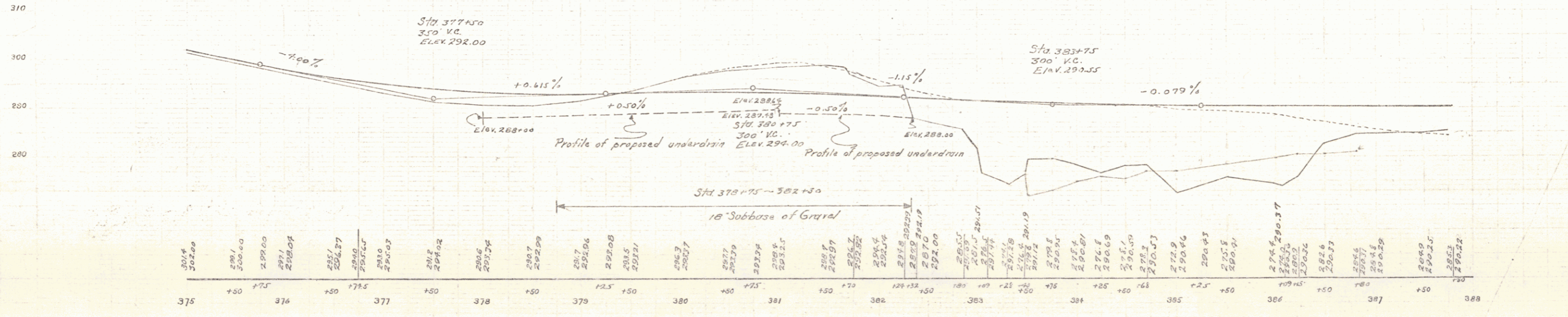
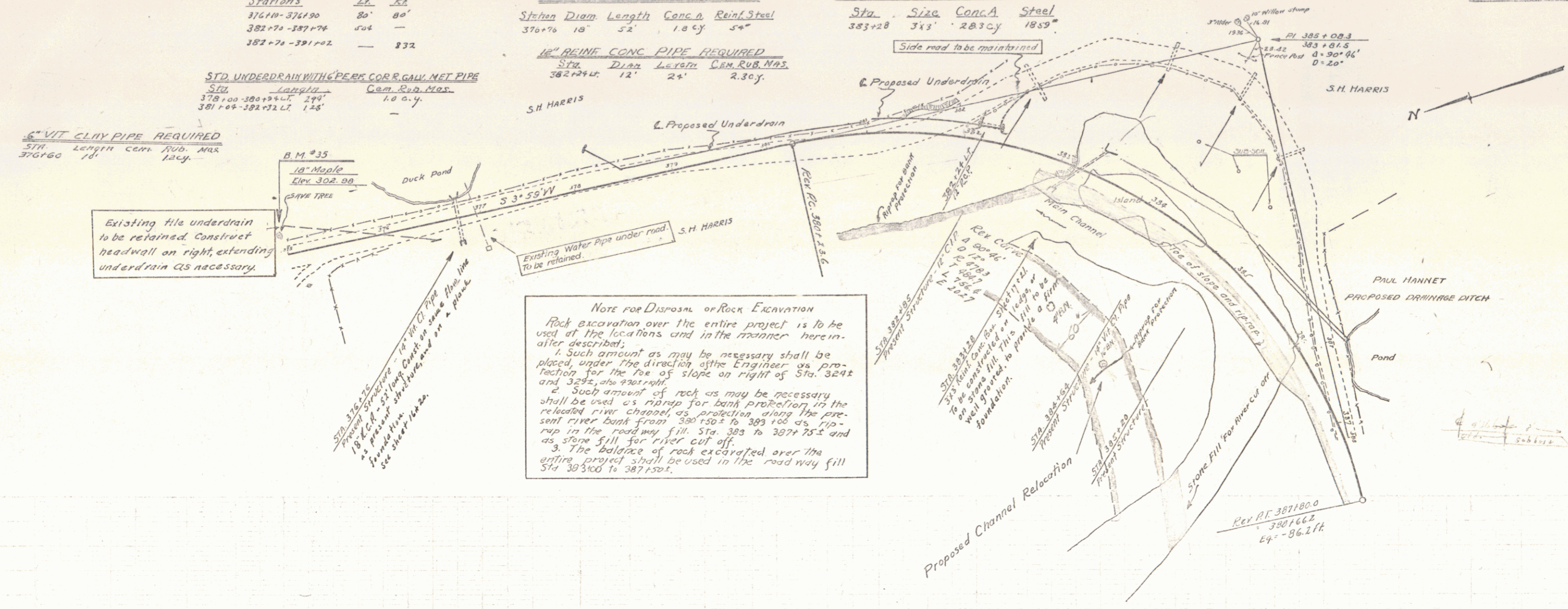

B.M. #35 Spike in root 18" Maple 20.0 ft. sta. 374+93
 B.M. #36 Destroyed

6