

WOOD GUARD RAIL REQUIRED

Station	LI	RI
359+10	24'	24'
359+28	24'	24'

CABLE GUARD RAIL REQUIRED

Station	LI	RI
351+00-351+48	18'	-
357+60-358+10	-	80'

CULVERT REPAIRS REQUIRED

Station	Length	Comp. B	Steele
357+33	31	cy.	200'
359+10	5.0		411'

GROUTED COBBLE GUTTER REQUIRED

Station	Width	Area
352+00-357+00	3'-0"	1830 sq. ft.
356+10-357+00	3'-0"	585 sq. ft.

78-E 1930 6

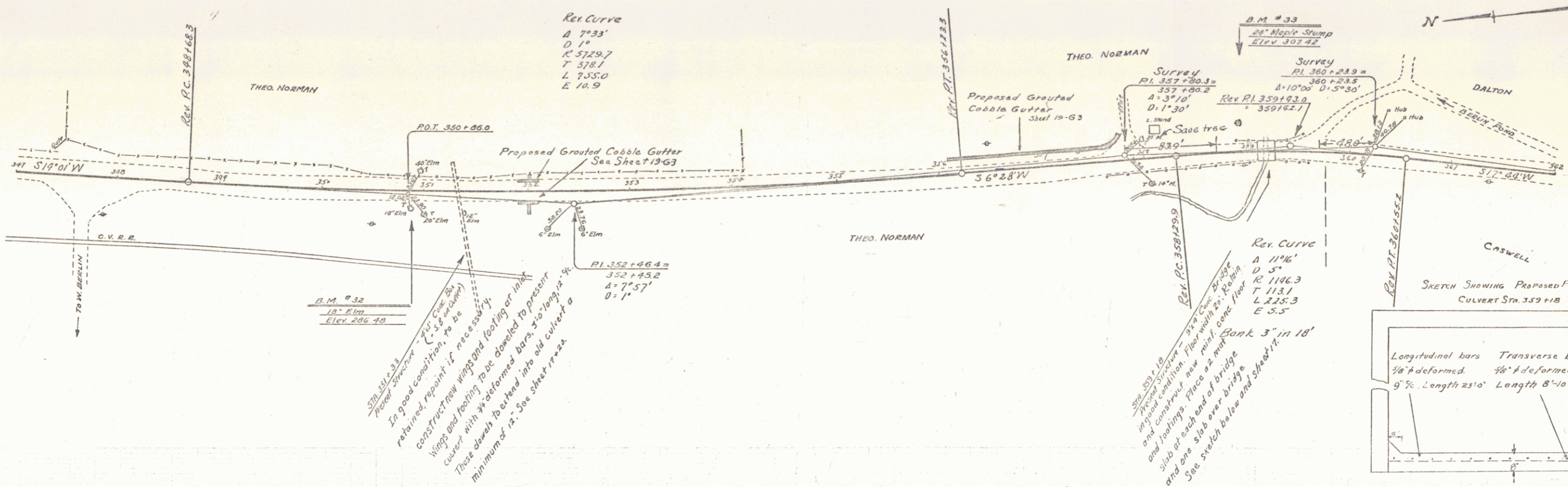

Ret Curve
 A 7°33'
 D 1°
 R 5729.7
 T 378.1
 L 335.0
 E 10.9

Ret Curve
 A 11°16'
 D 3°
 R 1146.3
 T 113.1
 L 225.3
 E 5.5

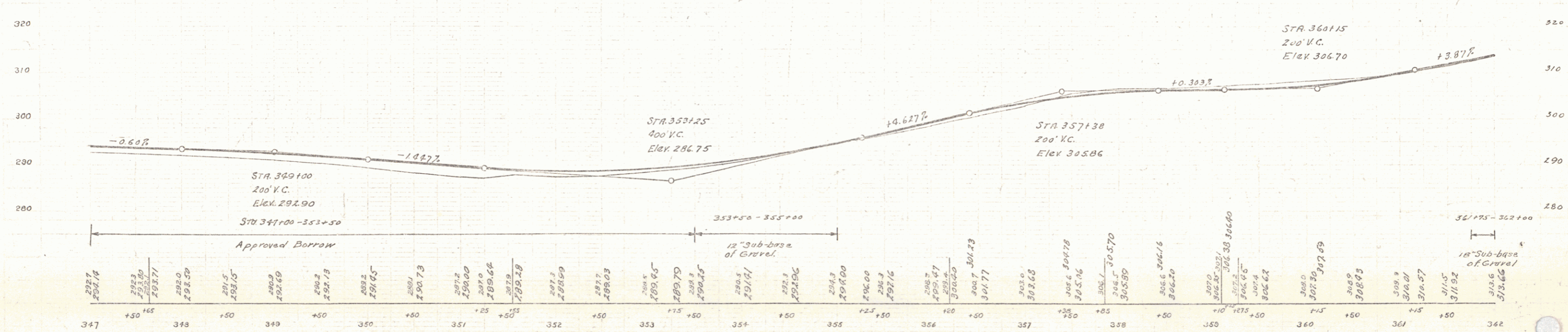
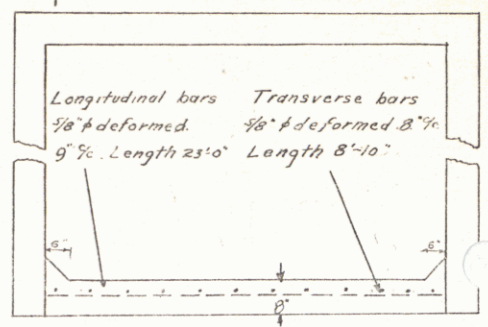

B.M. #32 Spike in root 18" Elm 17.0 ft. rt. sta 350+86 Elev 286.48
 B.M. #33 " " top 24" Maple Stump 28.0 ft. ll. sta. 353+91 " 307.42

SERIES F No. 78-E
 SHEET 6 OF