

Present Bridge Data
 Concrete Bridge
 O.L. 19.2'
 Cl. Span 13.3'
 Bet. Footings 11.2'
 Cl. Height 7.7'
 Roadway 20.2'
 Dead Load 2.3' (cover)
 Stone Abuts. Conc. Faced
 Conc. Rails
 Footings setting on ledge.

NOTE:
 Drives are to be constructed with a minimum width of 12' to a flare radius of at least 15'

- INDEX OF SHEETS**
- 1 Plan & Profile & Title Page
 - 2 Drainage & Quantity Sheet
 - 3 Earthwork & Summary Sheet
 - 4-6 Cross Sections
 - 7 18" x 10" CGMIRPA Details
 - 8 Channel Sections
 - 9 E 33 Appr Signs - Bridge Constr. (1-16-67)
 - 10 E 36 Road Constr Signs - Dist. (1-16-67)
 - 11 E 26 Two Cable Guard Rail (3-10-65)
 - 12 G 26 Two Cable Guard Rail (3-10-65)
 - 13 G 26 Two Cable Guard Rail (3-10-65)

STATE OF VERMONT
 COUNTY OF WASHINGTON
 TOWN OF NORTHFIELD
 NORTHFIELD - RANDOLF ROAD
 VT. ROUTE 12

BEGINNING AT A POINT APPROXIMATELY 0.787 MILES NORTH OF THE NORTHFIELD - ROXBURY TOWN LINE AND EXTENDING SOUTHERLY FOR A DISTANCE OF 0.114 MILES.

LENGTH OF PROJECT 603.12 FT.

DATE: 5/67
 BY: [Signature]
 CHECKED: [Signature]
 APPROVED: [Signature]

DATE: 5/67
 BY: [Signature]
 CHECKED: [Signature]
 APPROVED: [Signature]

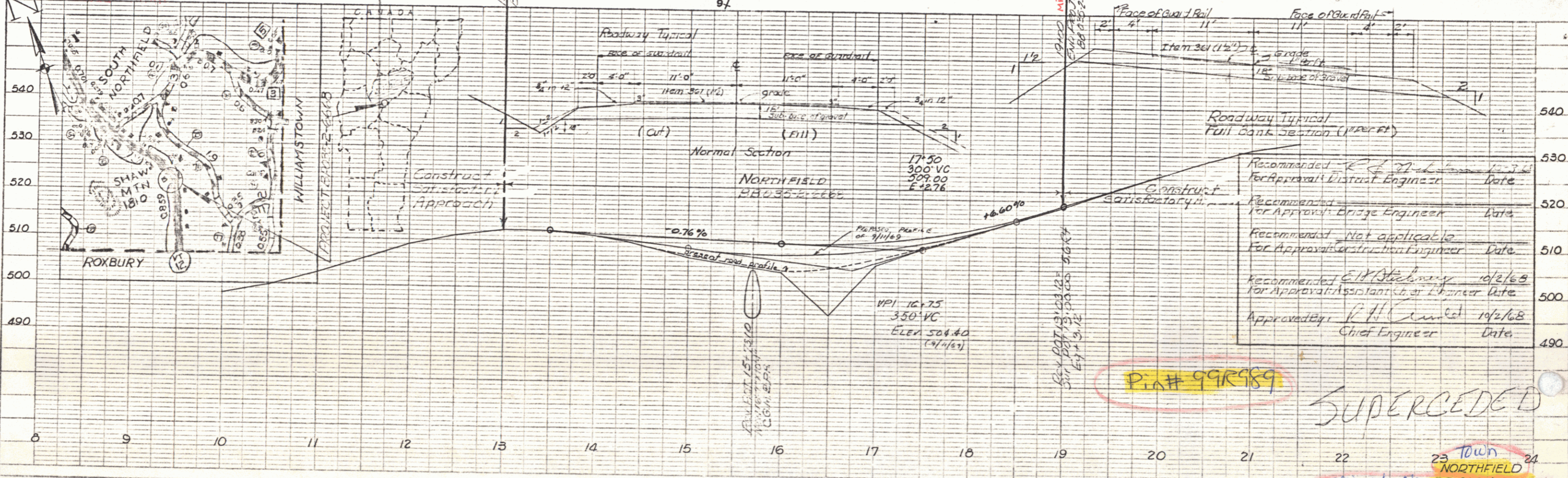
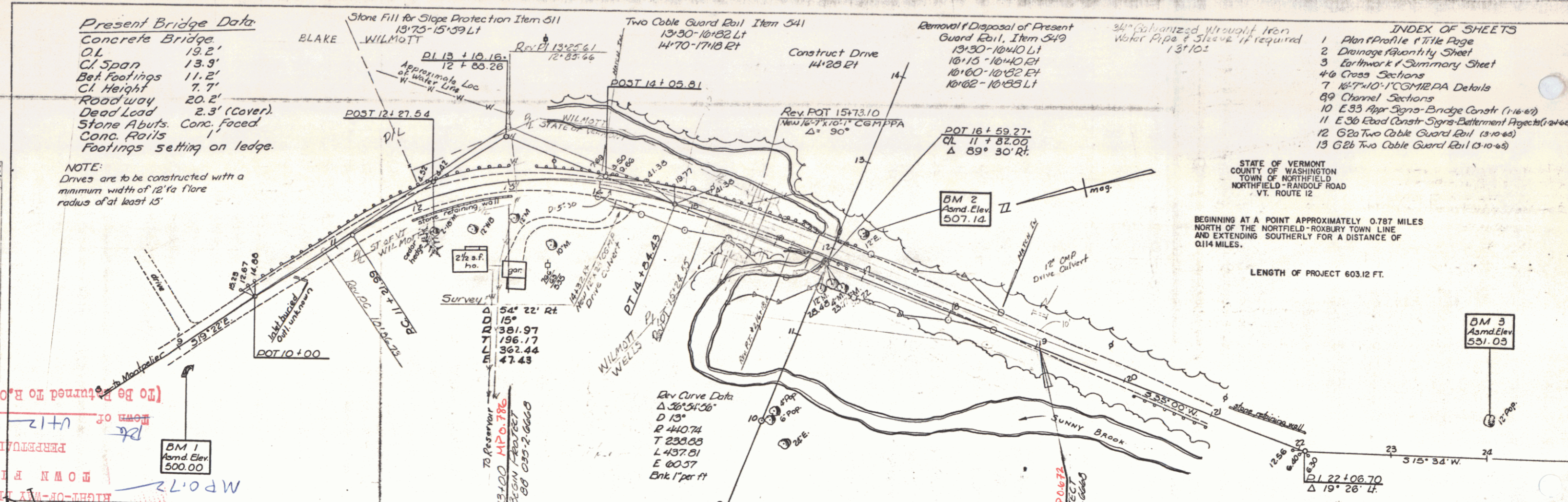

Recommended by [Signature]	Date
For Approval: District Engineer	
Recommended by [Signature]	Date
For Approval: Bridge Engineer	
Recommended: Not applicable	
For Approval: Construction Engineer	Date
Recommended by [Signature]	Date
For Approval: Assistant Engineer	
Approved by [Signature]	Date
Chief Engineer	

Plan # 9912989

SUPERCEDED

23 Town NORTHFIELD 24
 project No. BB 035-2-6668
 VT. RTE. 12 OF 56
 Sheet 1 of 13