

REAR VIEW OF BRIDGE

Note: Sheet 4 of 10, of Proj. FAP 113A, covering Sta 805+00-815+00, is bound with Northfield-Roxbury Project FAP 786

FAP 113A WOOD GUIDED RAIL			
STA	STN	RT	LT
819+00		40'	40'
823+00		64'	64'
827+00		74'	74'
831+00		74'	74'

FAP 113A WOODGUIDE POSTS		
STA	RT	LT
823+00		1
828+06		2
831+06		1
832+75		1

SEE STATE MAP NO. 10 SHEET TOTAL SHEETS  
78+1936 5 7  
FAP 113-A 1936 5 10

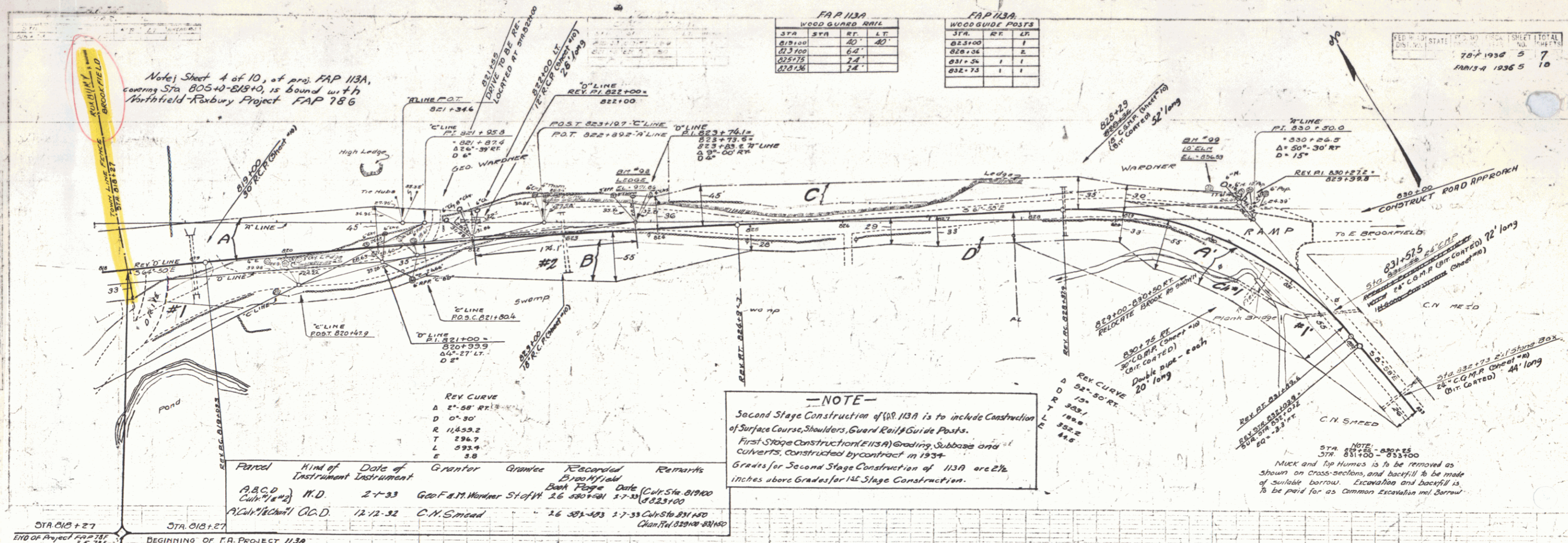

REV. CURVE

A	4° 58' RT
D	0° 30'
R	11459.2
T	294.7
L	293.4
E	3.0

Parcel	Kind of Instrument	Date of Instrument	Grantor	Grantee	Recorded Book Page	Date	Remarks
A, B, C, D	N.D.	2-1-33	Geo. F. M. Warden	St. J. H. 2.6	480+00	2-7-33	(Civ. Sta. 819+00 to 823+00)
A, C, D, E	O.C.D.	12-12-32	C. N. Smead		2.6	381-493	2-7-33 Civ. Sta. 831+00 to 833+00

**NOTE**  
Second Stage Construction of 113A is to include Construction of Surface Course, Shoulders, Guard Rail & Guide Posts.  
First Stage Construction (E 113A) Grading, Subbase and Culverts, constructed by contract in 1934.  
Grades for Second Stage Construction of 113A are 2 1/2 inches above Grades for 1st Stage Construction.

NOTE - ABOVE STA 831+00 - 833+00  
MUCK and Top Humus is to be removed as shown on cross-sections, and backfill to be made of suitable borrow. Excavation and backfill is to be paid for as Common Excavation and Borrow.

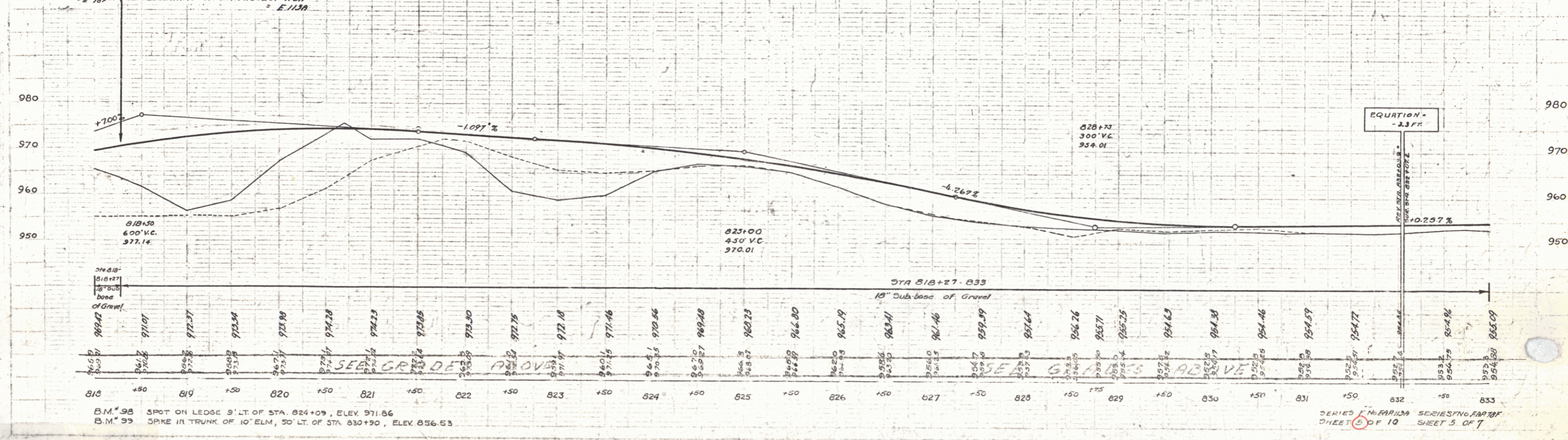

B.M. 95 SPOT ON LEDGE 9' LT. OF STA. 824+09, ELEV. 971.86  
B.M. 93 SPIKE IN TRUNK OF 10" ELM, 50' LT. OF STA. 830+30, ELEV. 856.53

SERIES NO. 113A SERIES NO. 113A  
SHEET 4 OF 10 SHEET 5 OF 7