

FAP 78F		
STATION	RT	LT
812.50	24	24
812.50	24	24

FAP 78F		
STATION	RT	LT
812.50	24	24
812.50	24	24

78F 1936 4 7
 FAP 78F 1936 4 10
 FAP 78F 1936 20 22

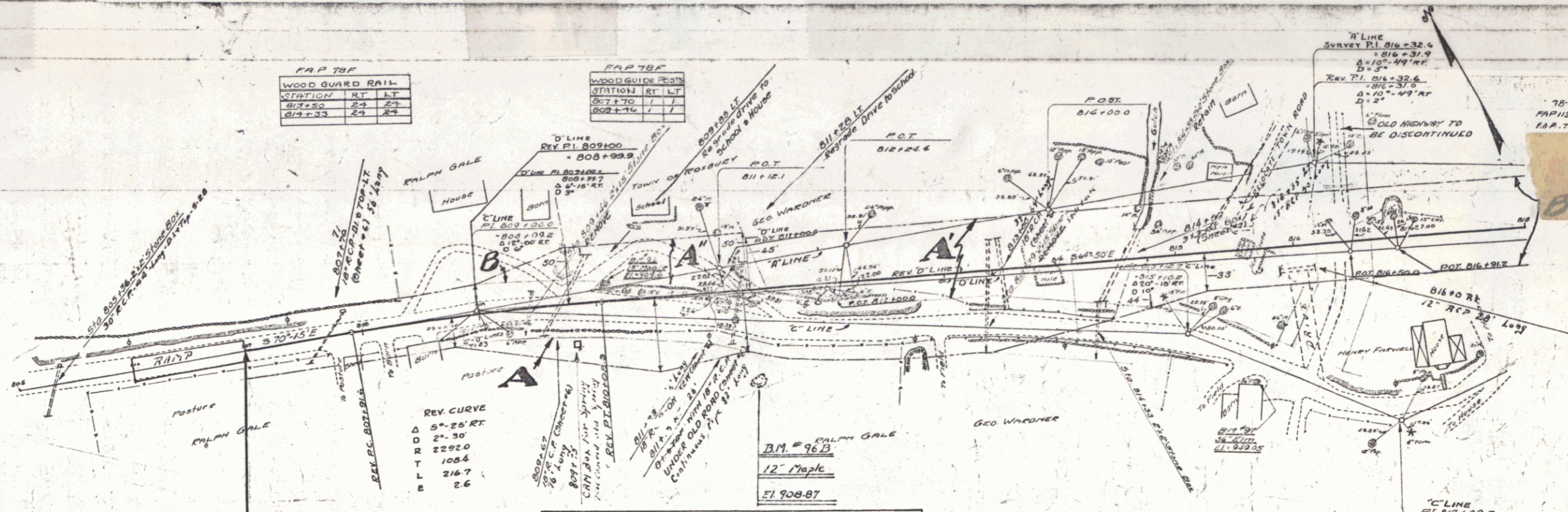

NOTE
 SECOND STAGE CONSTRUCTION OF PROJ. 78-F
 IS TO INCLUDE CONSTRUCTION OF SURFACE COURSE,
 SHOULDERS, GUARD RAIL & GUIDE POSTS.
 FIRST STAGE CONSTRUCTION (78-F) INCLUDED GRADING,
 SUBBASE AND CURVERTS CONSTRUCTED BY CONTRACT
 IN 1934.
 GRADES FOR SECOND STAGE CONSTRUCTION OF 78-F ARE 2" INCHES
 ABOVE GRADES FOR FIRST STAGE CONSTRUCTION.

PARCEL	NO	DATE OF SURVEY	GRANTOR	GRANTEE	RECORDED	REMARKS
A-B	Q.C.D.	7-31-33	BRANKIN & RUTH GALE	J.P. H.	22 473	8-14-33
A'-B'	W.D.	2-1-33	GEO. F. & MATTIE WARREN	"	20 146-7	2-6-33
A''	Q.C.D.	12-12-32	TOWN OF ROXBURY	"	20 148	2-13-33

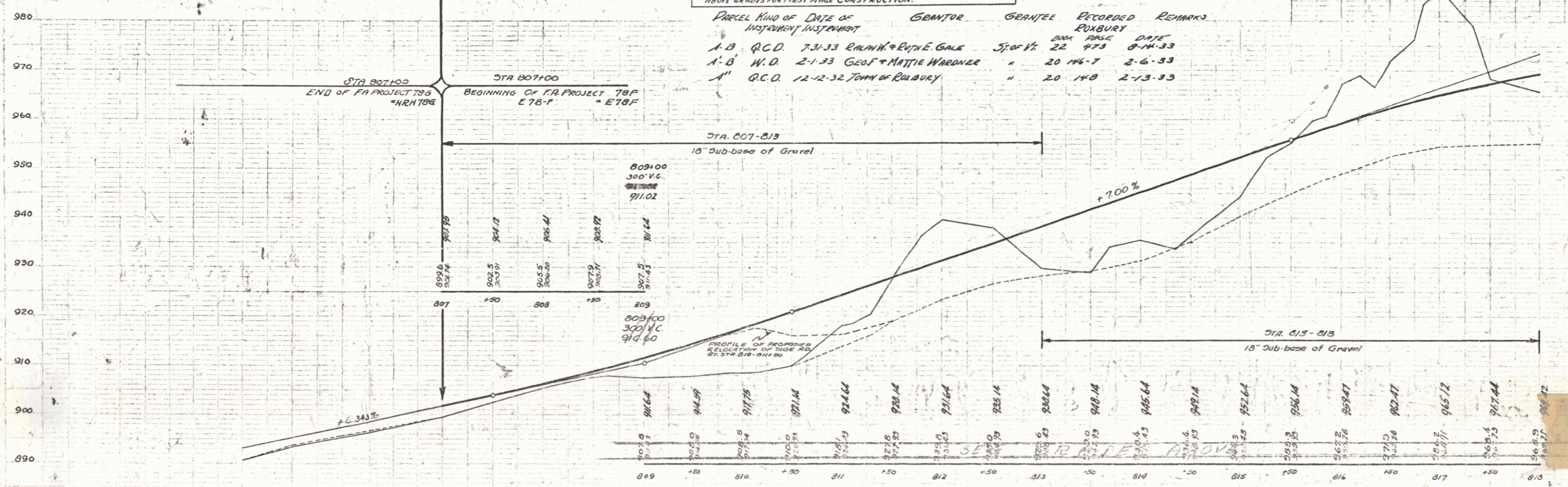

B.M. 96 SPIKE IN TRUNK OF 18" MAPLE, 1' LT OF STA 810+11, ELEV. 309.61
 B.M. 97 SPIKE IN ROOT OF 36" ELM, 15' RT OF STA 815+10 (C'LINE) ELEV. 349.05

SERIES FAP NO 78-G SHEET 20 OF 22
 SERIES FAP NO 113-A SHEET 4 OF 10
 SERIES FAP 78-F SHEET 4 OF 7