

PLAN	DATE	10/6/64
BY	MA	Martin
CHECKED	BY	Blair
DATE	11/6/64	
BY	MA	C.E.H.

PROFILE	DATE	11/6/64
BY	MA	Martin
CHECKED	BY	Blair
DATE	11/6/64	
BY	MA	C.E.H.

PARCEL	: 2	STA.	186+12 - 188+75
GRANTOR	: TOWN OF WORCESTER		
TAKING	: 03 AT	REM.	
TITLE TAKEN	: 9/1/62		
RE-GRAB	: WORCESTER BK 15 PG 54 DF 9/6/62		

The section of Montpelier-Morrisville State Highway, beginning at a point in the centerline of former highway, 100' easterly from approximate sta. 175+66 or Highway Project SB 241(2), and continuing 0.59 ± miles northerly to a point in the believed Worcester-Elmore Town Line and also the Washington-Lamotte County Line, 275 feet easterly of sta. 212+15 of said Project, is hereby relinquished and returned to the Town of Worcester, except those areas within a distance of 50 feet of the Project Center Line located as follows: (1) between sta. 175+85 and 178+50, (2) between sta. 197+53 and 204+23. Recorded in Book 15, Page 532 of Land Records of the Town of Worcester, on July 9, 1964.

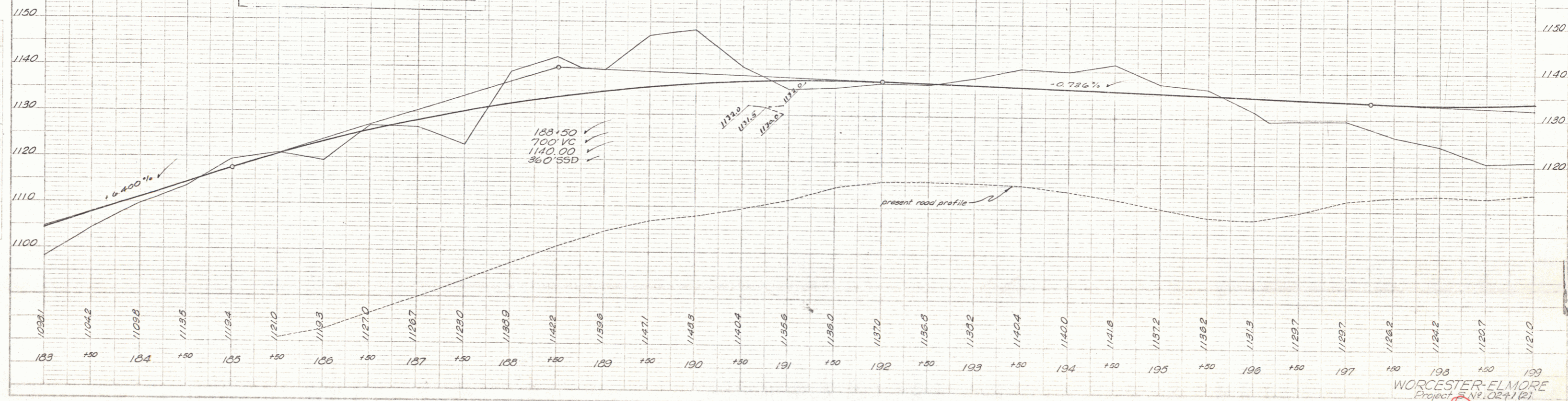

WORCESTER-ELMORE
Project No. 0241(2)
Sheet 25 of 64