

INDEX OF SHEETS

SHEET NO.	TITLE PAGE
1	TITLE PAGE (SINGLE TACK COAT OF CUTBACK ASPHALT)
2	TYPICAL SECTIONS WITH CRUSHED PEA STONE, ITEM 314
3	BANKING AND WIDENING TABLES
4	QUANTITY SHEET, ITEMS
5	QUANTITY SHEET, DRAINAGE
6-9	EARTHWORKS
10-21	PLAN AND PROFILE SHEETS
22	CONSTRUCTION DETAILS CD DRAINAGE AND MARKERS
23	CONSTRUCTION DETAILS CD-1 DITCHES
24	STANDARD STRUCTURE SHEET S-40 BARRICADES, SIGNS & LIGHTS
25	STANDARD STRUCTURE SHEET S-45-45 TWO CABLE GUARD RAIL
26-55	CROSS SECTIONS

STANDARD STRUCTURE SHEET APPROVED BY THE CHIEF ENGINEER, VERMONT STATE DEPARTMENT OF HIGHWAYS
S-40 JUNE 10, 1950

**STATE OF VERMONT
DEPARTMENT OF HIGHWAYS**

PROPOSED IMPROVEMENT

**TOWN OF FAIRFIELD
COUNTY OF FRANKLIN
STATE AID ROUTE 2
FAIRFIELD-BAKERSFIELD ROAD**

FEDERAL AID
SECONDARY PROJECT

BEGINNING AT A POINT APPROXIMATELY 0.266 MILES EASTERLY FROM THE INTERSECTION OF STATE AID ROUTES 2 AND 3 IN THE TOWN OF FAIRFIELD AND EXTENDING EASTERLY 17,473.9 FEET. LENGTH OF PROJECT 17,473.9 FEET = 3.309 MILES.

Pin # 99R96
Route VT 36

PROJECT NAME & NUMBER	TYPE	PAVEMENT AREA
FAIRFIELD S 53 (9)	SINGLE TACK COAT	3,831 S.Y.
RECORD PLANS MATERIALS		
SUB-BASE OF GRAVEL MACOMBER PIT FAIRFIELD	R.C.P. VERMONT CONCRETE PIPE CO.	
CUTBACK ASPHALT ESSO STANDARD EVERETT, MASS	ACCG.M.P. NEW ENGLAND METAL CULVERT CO.	
PEASTONE FOR SEAL RUBBEROID CORR EDEN, VT.	CABLE FOR GUARD RAIL AMERICAN STEEL & WIRE NEW HAVEN, CONN.	
CONTRACTOR LUCIEN A. DEMIERS ST. ALBANS	CONTRACT DATED MAY 20, 1955	
RESIDENT ENG'R WALDEN J. SHULTS	CONTRACT STARTED JUNE 13, 1955	
INSPECTORS	CONTRACT COMPLETED JULY 19, 1956	
RECORD PLANS WALDEN J. SHULTS	CONTRACT ACCEPTED JULY 19, 1956	

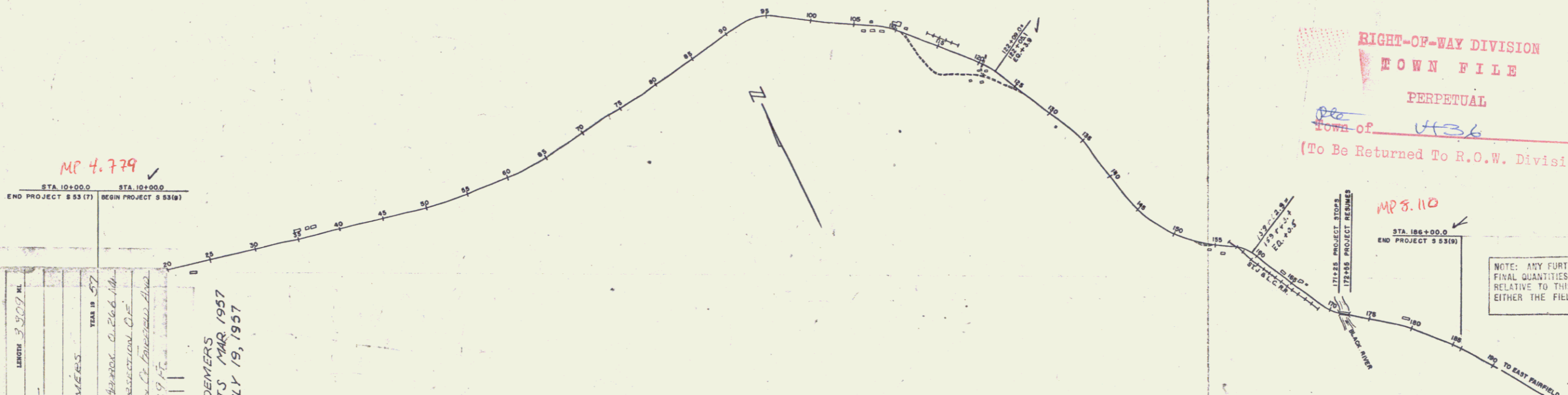
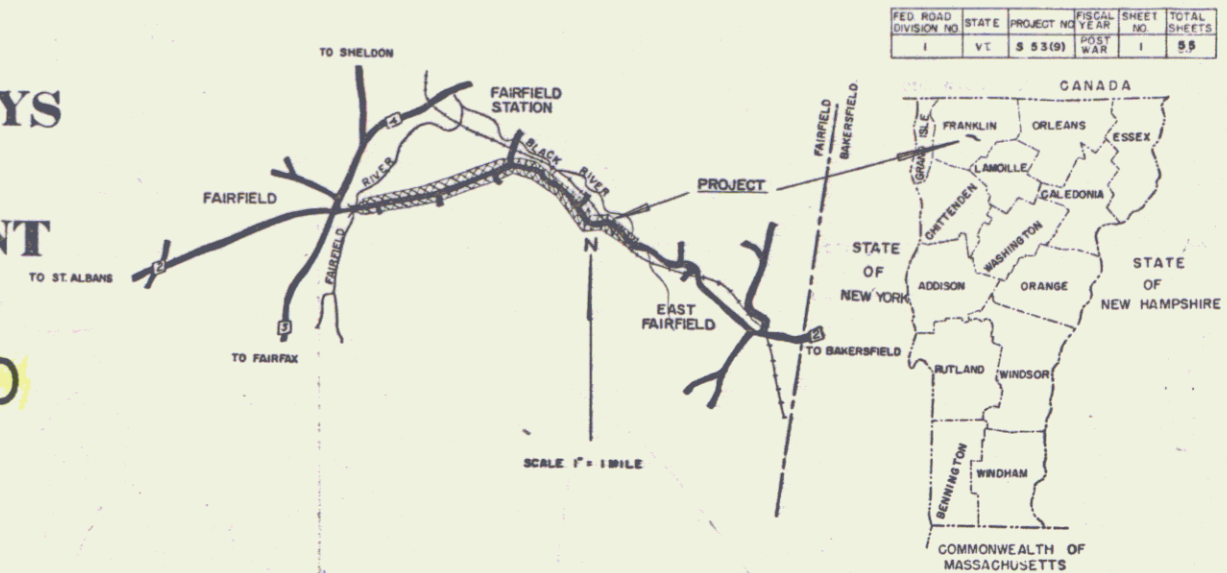

MP 4.779

STA 10+00.0	STA 10+00.0
END PROJECT S 53 (7)	BEGIN PROJECT S 53 (9)

COUNTY	FRANKLIN
TOWN	FAIRFIELD
PROJECT	S 53 (9)
TYPE	SINGLE TACK COAT
CONTRACTOR	LUCIEN A. DEMIERS
LOCATION	Beginning At A Point About 0.266 Miles Easterly From The Intersection Of State Aid Routes 2 & 3 In The Town Of Fairfield
LENGTH	17,473.9 FT.
YEAR	1955
RECORD PLANS	LUCIEN A. DEMIERS
CONST. COMPLETED	JULY 19, 1956

CURVE DATA	
DEFLECTION OF ANGLE	A
DEGREE OF CURVE	B
RADIUS OF CURVE	R
TANGENT DISTANCE	T
LENGTH OF CURVE	L
EXTERNAL DISTANCE	E
POINT OF INTERSECTION	P.I.
POINT OF CURVE	P.C.
POINT OF TANGENT	P.T.
POINT ON TANGENT	P.O.T.
POINT ON SUB-TANGENT	P.O.S.T.

SCALES
TITLE 1" = 600'
TYPICAL 1" = 2'
PLAN 1" = 50'
PROFILE HORIZONTAL 1" = 50'
PROFILE VERTICAL 1" = 10'
GROSS SECTIONS 1" = 5'

THESE PLANS ARE SUBJECT TO SUCH REVISIONS AS MAY BE REQUIRED BY THE BUREAU OF PUBLIC ROADS OR THE COMMISSIONER OF HIGHWAYS.

CONSTRUCTION IS TO BE CARRIED ON IN ACCORDANCE WITH THE PLANS AND THE STANDARD ROAD AND BRIDGE SPECIFICATIONS OF 1948, AS APPROVED JULY 25, 1949 BY THE BUREAU OF PUBLIC ROADS, INCLUDING ALL SUBSEQUENT APPROVED REVISIONS AND SUCH REVISED SPECIFICATIONS AND SPECIAL PROVISIONS AS ARE SUBMITTED WITH THE PLANS.

APPROVED CONSTRUCTION ENGINEER	APPROVED DISTRICT ENGINEER	APPROVED DISTRICT ENGINEER	APPROVED DISTRICT ENGINEER	APPROVED DISTRICT ENGINEER
DATE	DATE	DATE	DATE	DATE

DEPARTMENT OF COMMERCE
BUREAU OF PUBLIC ROADS

APPROVED

DIVISION ENGINEER DATE

PROJECT S NO. 53 (9)

SHEET 1 OF 55 SHEETS

WEBSTER-MARTIN INC. - CONSULTING ENGINEERS
50, BURLINGTON, VT.