

INDEX OF SHEETS

SHEET NO. 1	TITLE PAGE
2	TYPICAL CROSS-SECTION OF IMPROVEMENT
3	BANKING AND WIDENING TABLES
4	CONSTRUCTION DETAILS (DRAINAGE AND MARKERS)
5	QUANTITY SHEET (ITEMS)
6	QUANTITY SHEET (ITEMS) (DRAINAGE)
7	QUANTITY SHEET (ITEMS) (DRAINAGE)
8-10	EARTHWORK SHEETS
11-16	PLAN & PROFILE
17	STANDARD STRUCTURE SHEET S-40 BARRICADES SIGNS & LIGHTS
18-29	GROSS SECTIONS

STANDARD STRUCTURE SHEET APPROVED BY THE CHIEF ENGINEER,  
VERMONT DEPARTMENT OF HIGHWAYS.  
S 40 JUNE 10, 1950

STATE OF VERMONT  
STATE HIGHWAY DEPARTMENT

PLAN AND PROFILE OF PROPOSED  
STATE HIGHWAY

TOWNS OF ST. ALBANS-FAIRFIELD

COUNTY OF FRANKLIN  
ST. ALBANS-FAIRFIELD ROAD  
STATE AID ROUTE 2

Pin # 99R957  
Route VT36

BEGINNING AT A POINT APPROXIMATELY 3200 FEET WEST OF  
ST. ALBANS-FAIRFIELD TOWN LINE AND EXTENDING EASTERLY 7650 FEET.  
LENGTH OF PROJECT 7650 FEET = 1.449 MILES

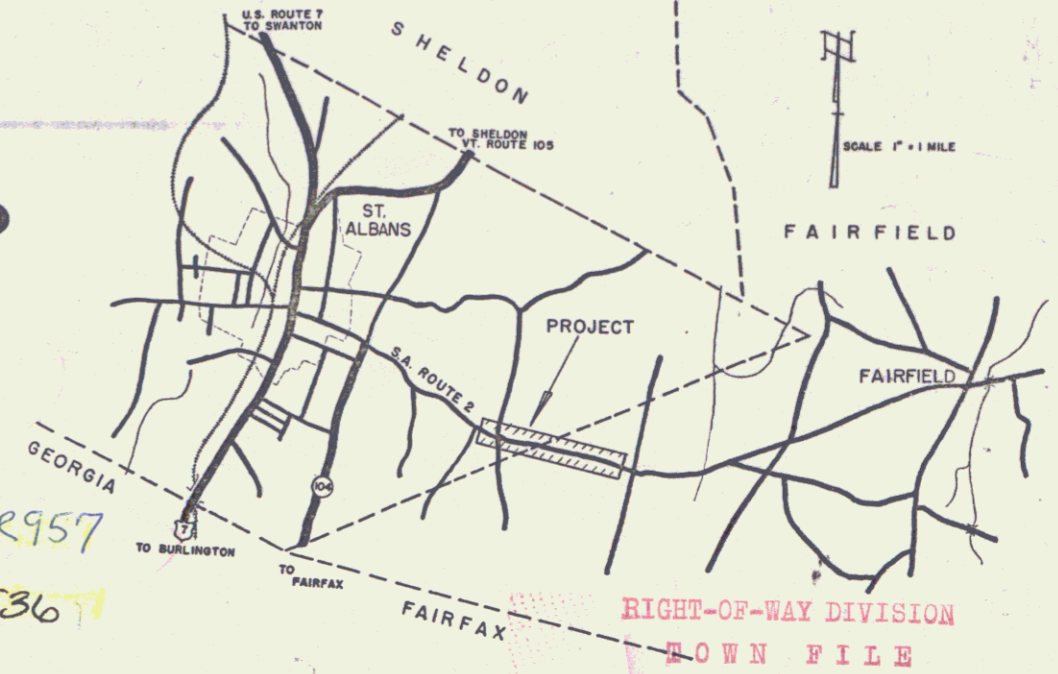

RIGHT-OF-WAY DIVISION  
TOWN FILE  
PERPETUAL  
Town of Rte VT36  
(To Be Returned To R.O.W. Division)

NOTE: Any further information concerning final quantities, amounts or other details relative to this project, may be found in either the field books or the estimate file.

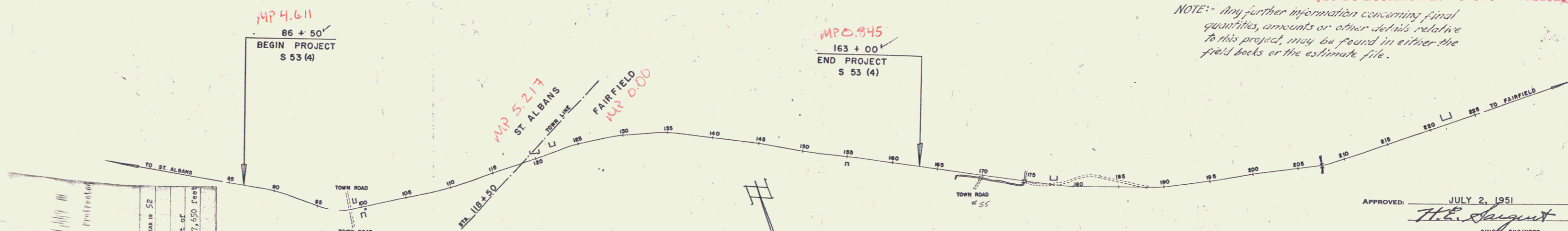

APPROVED: JULY 2, 1951  
*H.E. Sargent*  
CHIEF ENGINEER  
SUBMITTED BY ORDER OF THE STATE HIGHWAY BOARD

6/27 ITEM IN 52  
Common St. Albans-Fairfield Road.  
Beginning at a point approximately 3,200 feet west of  
St. Albans-Fairfield line and extending easterly 7,650 feet

ST. ALBANS-FAIRFIELD S-53(4)  
CONTRACTOR - DENRIK DEGROOT  
COMPLETED JANUARY 1952

GROUND ELEVATION	DATUM	LINE
GRADE ELEVATION	DATUM	LINE

SCALES

TITLE	1" = 800'
TYPICAL	1" = 2'
PLAN	1" = 50'
PROFILE HORIZONTAL	1" = 80'
PROFILE VERTICAL	1" = 10'
CROSS SECTIONS	1" = 5'

PROJECT NAME AND NUMBER	TYPE	PAVEMENT AREA
ST. ALBANS-FAIRFIELD S-53(4)	DOUBLE TRACK	18,180 Sq. Yds.
RECORD PLANS		
MATERIALS		
CEMENT - FOND DU LAC CO. ST. ALBANS, VT.	ACCOMP. - W.E. MORSE CEMENT CO. BOSTON MASS.	
SAND - ALCOCK & SONS SWANTON, VT.	GRAVEL - BROWN CO. BURLINGHAM, N.H.	
STONE - SWANTON LIME CO. SWANTON, VT.	GRAVEL - LAMBERT PT. FAIRFIELD, VT.	
TAR - WASHINGTON, FAIRFIELD MASS.		
ASPHALT - POLYMER EMULSION R.I.		
R.C.P. - VT. CONC. PIPE CO. MONTPELIER		
CONTRACTOR - DENRIK DEGROOT	CONTRACT DATED	OCT. 6, 1951
RES. ENG' - D.R. BURTON, OCT. 13, 1951	" STARTED	OCT. 13, 1951
H.G. GARZES, MAR. 21, 1952	" COMPLETED	JUNE 17, 1952
RECORD PLANS BY - H.G. GARZES 1952	" ACCEPTED	JUNE 17, 1952

THESE PLANS ARE SUBJECT TO SUCH REVISIONS AS MAY BE  
REQUIRED BY THE BUREAU OF PUBLIC ROADS OR THE COM-  
MISSIONER OF HIGHWAYS.

CONSTRUCTION IS TO BE CARRIED ON IN ACCORDANCE WITH  
THE PLANS AND THE STANDARD ROAD AND BRIDGE SPECIFICATIONS  
OF 1948, AS APPROVED JULY 25, 1949 BY THE BUREAU  
OF PUBLIC ROADS INCLUDING ALL SUBSEQUENT APPROVED  
REVISIONS AND SUCH REVISED SPECIFICATIONS AND SPECIAL  
PROVISIONS AS ARE SUBMITTED WITH THE PLANS.

DEPARTMENT OF COMMERCE BUREAU OF PUBLIC ROADS	
RECOMMENDED FOR APPROVAL	
DISTRICT ENGINEER	DATE
APPROVED	

APPROVED: *W.C. Merritt* HIGHWAY ENGINEER  
APPROVED: *W.C. Merritt* DISTRICT ENGINEER  
DIVISION ENGINEER DATE  
PROJECT S. NO. 53 (4) FILED  
SHEET 1 OF 29

FED. ROAD DIV. NO.	STATE	PROJ. NO.	FISCAL YEAR	SHEET NO.	TOTAL SHEETS
1	VT.	S 83(4)	1958	2	29

# TYPICAL SECTIONS

DOUBLE TACK COAT OF BITUMINOUS MATERIAL WITH PRETREATED PEA-STONE SEAL, PRIME COAT OF REFINED TAR AND SEAL COAT OF CUTBACK ASPHALT, ITEM 313

SUB-BASE OF GRAVEL, ITEM 201-A

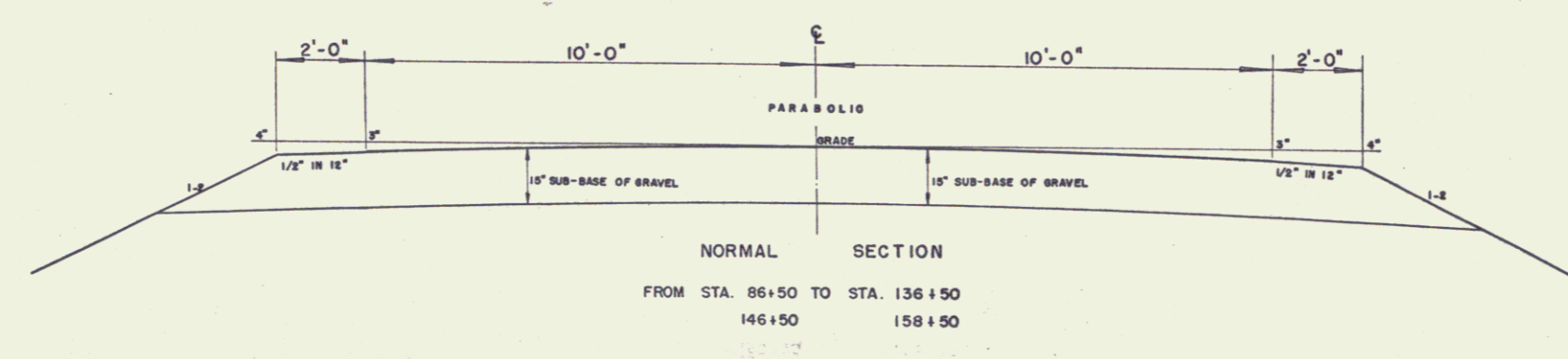
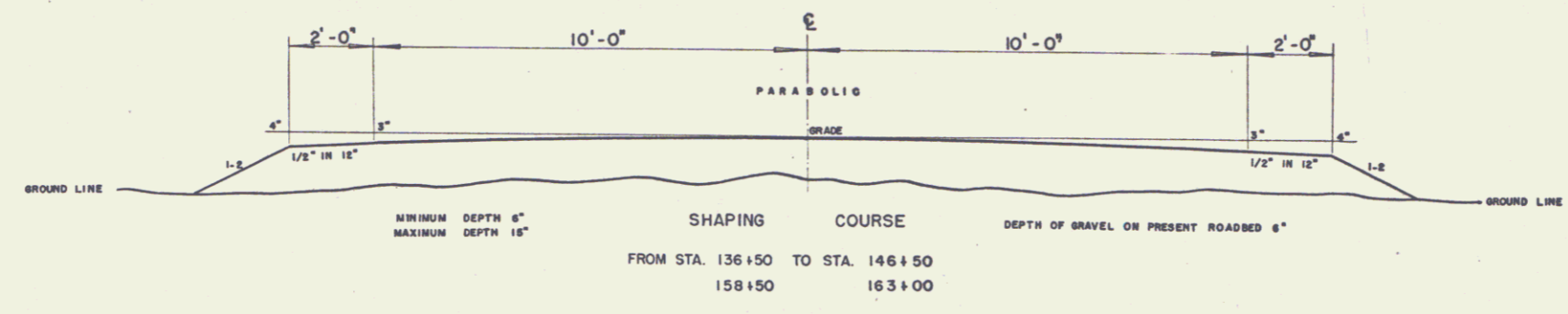

ST. ALBANS - FAIRFIELD

Surveyed by  
 Designed by K. L. STEVENS  
 Drawn by A. AJA  
 Traced by A. AJA  
 Checked by  
 PROJECT S No. 53 (4) Filed  
 Sheet 2 of 29 Sheets



PLAN	DATE	BY
REVISION		
NO.	DATE	BY
1	11/10	MLC
2	11/15	MLC
3	11/15	MLC
4	11/15	MLC
5	11/15	MLC
6	11/15	MLC
7	11/15	MLC
8	11/15	MLC
9	11/15	MLC
10	11/15	MLC
11	11/15	MLC
12	11/15	MLC
13	11/15	MLC
14	11/15	MLC
15	11/15	MLC
16	11/15	MLC
17	11/15	MLC
18	11/15	MLC
19	11/15	MLC
20	11/15	MLC
21	11/15	MLC
22	11/15	MLC
23	11/15	MLC
24	11/15	MLC
25	11/15	MLC
26	11/15	MLC
27	11/15	MLC
28	11/15	MLC
29	11/15	MLC
30	11/15	MLC
31	11/15	MLC
32	11/15	MLC
33	11/15	MLC
34	11/15	MLC
35	11/15	MLC
36	11/15	MLC
37	11/15	MLC
38	11/15	MLC
39	11/15	MLC
40	11/15	MLC
41	11/15	MLC
42	11/15	MLC
43	11/15	MLC
44	11/15	MLC
45	11/15	MLC
46	11/15	MLC
47	11/15	MLC
48	11/15	MLC
49	11/15	MLC
50	11/15	MLC
51	11/15	MLC
52	11/15	MLC
53	11/15	MLC
54	11/15	MLC
55	11/15	MLC
56	11/15	MLC
57	11/15	MLC
58	11/15	MLC
59	11/15	MLC
60	11/15	MLC
61	11/15	MLC
62	11/15	MLC
63	11/15	MLC
64	11/15	MLC
65	11/15	MLC
66	11/15	MLC
67	11/15	MLC
68	11/15	MLC
69	11/15	MLC
70	11/15	MLC
71	11/15	MLC
72	11/15	MLC
73	11/15	MLC
74	11/15	MLC
75	11/15	MLC
76	11/15	MLC
77	11/15	MLC
78	11/15	MLC
79	11/15	MLC
80	11/15	MLC
81	11/15	MLC
82	11/15	MLC
83	11/15	MLC
84	11/15	MLC
85	11/15	MLC
86	11/15	MLC
87	11/15	MLC
88	11/15	MLC
89	11/15	MLC
90	11/15	MLC
91	11/15	MLC
92	11/15	MLC
93	11/15	MLC
94	11/15	MLC
95	11/15	MLC
96	11/15	MLC
97	11/15	MLC
98	11/15	MLC
99	11/15	MLC
100	11/15	MLC
101	11/15	MLC
102	11/15	MLC
103	11/15	MLC
104	11/15	MLC
105	11/15	MLC
106	11/15	MLC
107	11/15	MLC
108	11/15	MLC
109	11/15	MLC
110	11/15	MLC
111	11/15	MLC
112	11/15	MLC
113	11/15	MLC
114	11/15	MLC
115	11/15	MLC

PROFILE	DATE	BY
REVISION		
NO.	DATE	BY
1	11/10	MLC
2	11/15	MLC
3	11/15	MLC
4	11/15	MLC
5	11/15	MLC
6	11/15	MLC
7	11/15	MLC
8	11/15	MLC
9	11/15	MLC
10	11/15	MLC
11	11/15	MLC
12	11/15	MLC
13	11/15	MLC
14	11/15	MLC
15	11/15	MLC
16	11/15	MLC
17	11/15	MLC
18	11/15	MLC
19	11/15	MLC
20	11/15	MLC
21	11/15	MLC
22	11/15	MLC
23	11/15	MLC
24	11/15	MLC
25	11/15	MLC
26	11/15	MLC
27	11/15	MLC
28	11/15	MLC
29	11/15	MLC
30	11/15	MLC
31	11/15	MLC
32	11/15	MLC
33	11/15	MLC
34	11/15	MLC
35	11/15	MLC
36	11/15	MLC
37	11/15	MLC
38	11/15	MLC
39	11/15	MLC
40	11/15	MLC
41	11/15	MLC
42	11/15	MLC
43	11/15	MLC
44	11/15	MLC
45	11/15	MLC
46	11/15	MLC
47	11/15	MLC
48	11/15	MLC
49	11/15	MLC
50	11/15	MLC
51	11/15	MLC
52	11/15	MLC
53	11/15	MLC
54	11/15	MLC
55	11/15	MLC
56	11/15	MLC
57	11/15	MLC
58	11/15	MLC
59	11/15	MLC
60	11/15	MLC
61	11/15	MLC
62	11/15	MLC
63	11/15	MLC
64	11/15	MLC
65	11/15	MLC
66	11/15	MLC
67	11/15	MLC
68	11/15	MLC
69	11/15	MLC
70	11/15	MLC
71	11/15	MLC
72	11/15	MLC
73	11/15	MLC
74	11/15	MLC
75	11/15	MLC
76	11/15	MLC
77	11/15	MLC
78	11/15	MLC
79	11/15	MLC
80	11/15	MLC
81	11/15	MLC
82	11/15	MLC
83	11/15	MLC
84	11/15	MLC
85	11/15	MLC
86	11/15	MLC
87	11/15	MLC
88	11/15	MLC
89	11/15	MLC
90	11/15	MLC
91	11/15	MLC
92	11/15	MLC
93	11/15	MLC
94	11/15	MLC
95	11/15	MLC
96	11/15	MLC
97	11/15	MLC
98	11/15	MLC
99	11/15	MLC
100	11/15	MLC
101	11/15	MLC
102	11/15	MLC
103	11/15	MLC
104	11/15	MLC
105	11/15	MLC
106	11/15	MLC
107	11/15	MLC
108	11/15	MLC
109	11/15	MLC
110	11/15	MLC
111	11/15	MLC
112	11/15	MLC
113	11/15	MLC
114	11/15	MLC
115	11/15	MLC

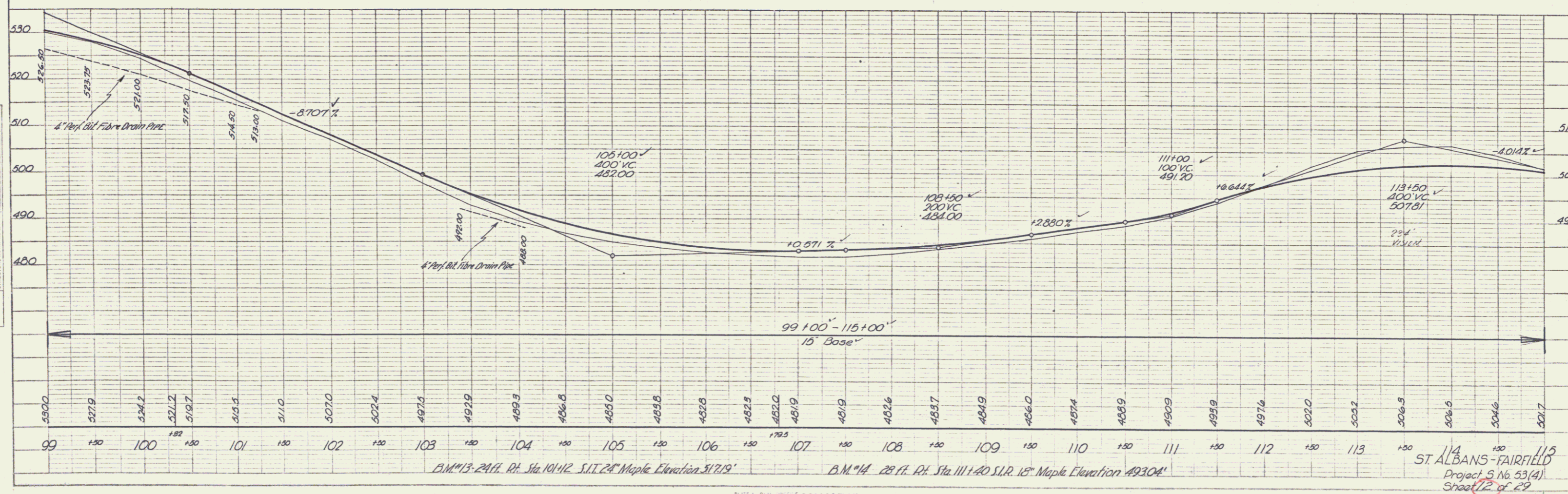
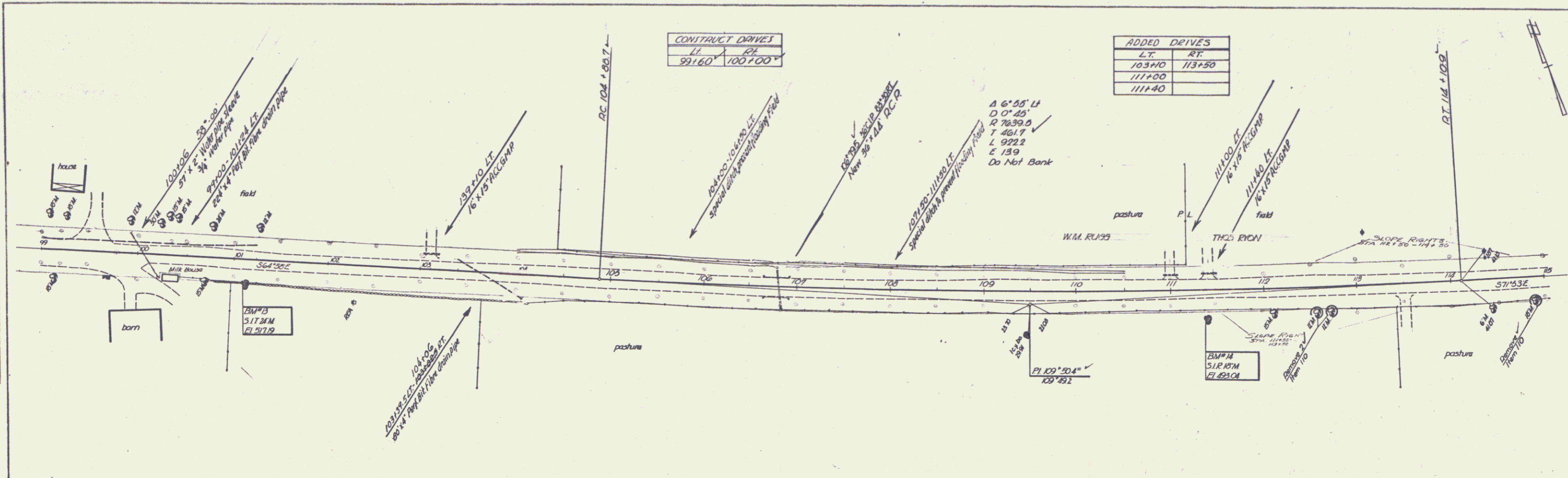

PLATE 1 - PLAN, PROFILE, & CURVE DATA  
 PREPARED BY: M. J. H. & S. STANLEY  
 ENGINEERS & SURVEYORS  
 100 N. 10th St. St. Paul, Minn. 55102

PLAN  
 DATE: 1/28/29  
 DRAWN BY: H. S. HURLEY  
 CHECKED BY: H. S. HURLEY  
 PROJECT: ST ALBANS - FAIRFIELD

PROFILE  
 DATE: 1/28/29  
 DRAWN BY: H. S. HURLEY  
 CHECKED BY: H. S. HURLEY  
 PROJECT: ST ALBANS - FAIRFIELD

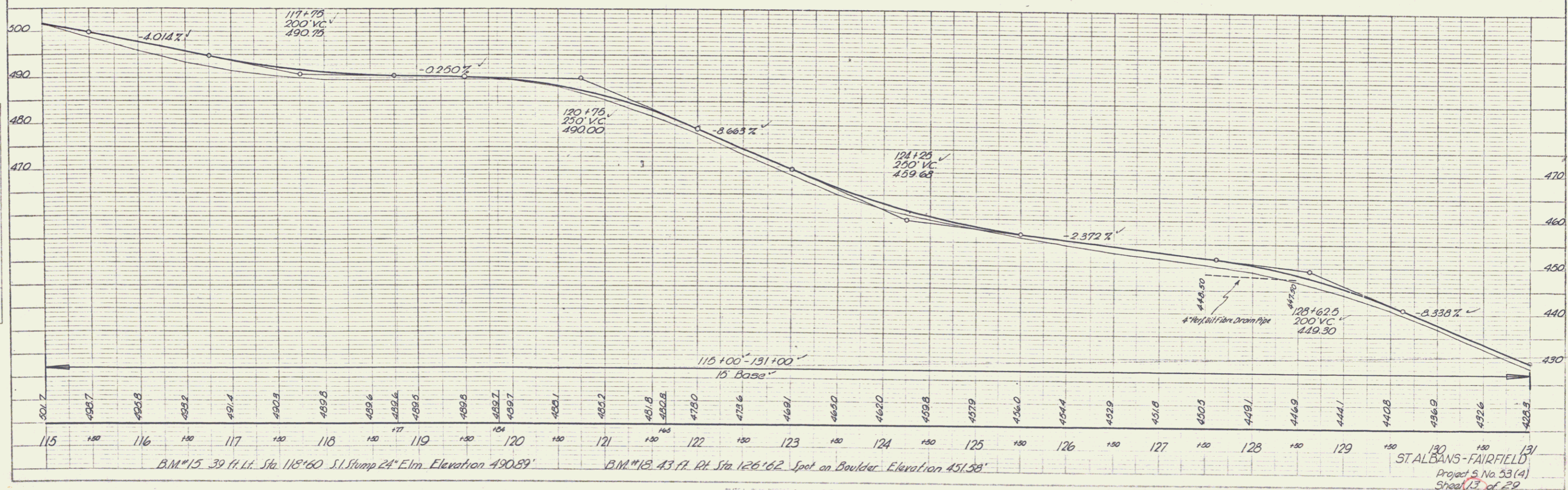
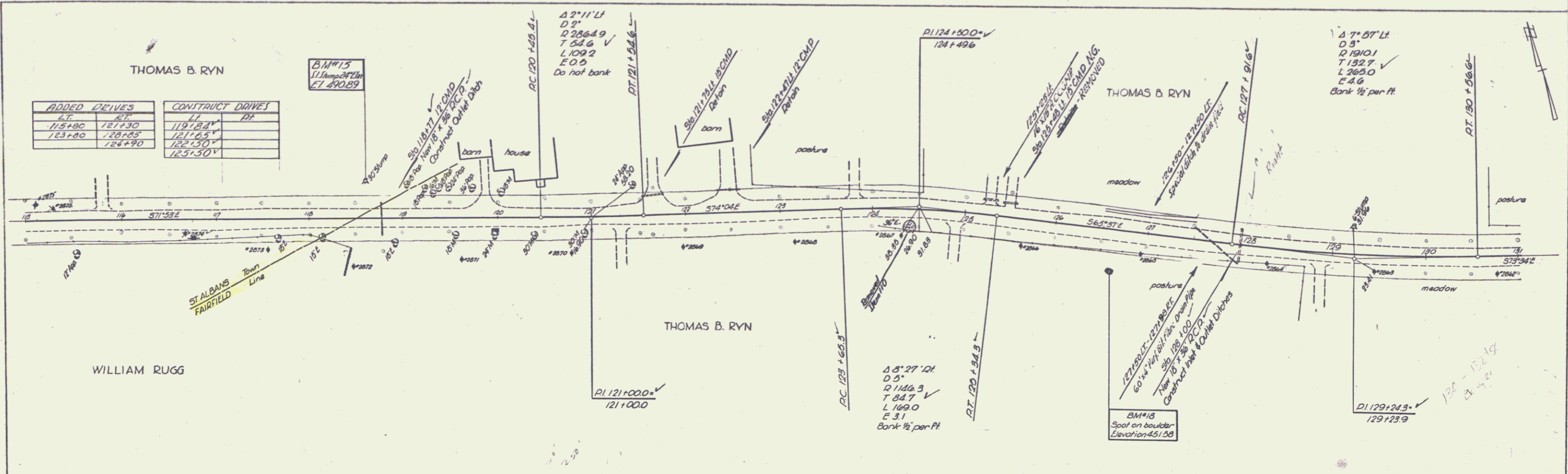

PLATE: 1-PLAN PROFILE  
 PROF. G. & E. S. H. HURLEY

ST ALBANS - FAIRFIELD  
 Project No. 53 (A)  
 Sheet 13 of 29

PLAN	DATE	BY
1/2	1/2	1/2
1/2	1/2	1/2
1/2	1/2	1/2
1/2	1/2	1/2

PROFILE	DATE	BY
1/2	1/2	1/2
1/2	1/2	1/2
1/2	1/2	1/2
1/2	1/2	1/2

CONSTRUCT DRIVES	
LT	RT
139+10	
143+00	
ADDED DRIVES	
LT	RT
133+80	
146+90	

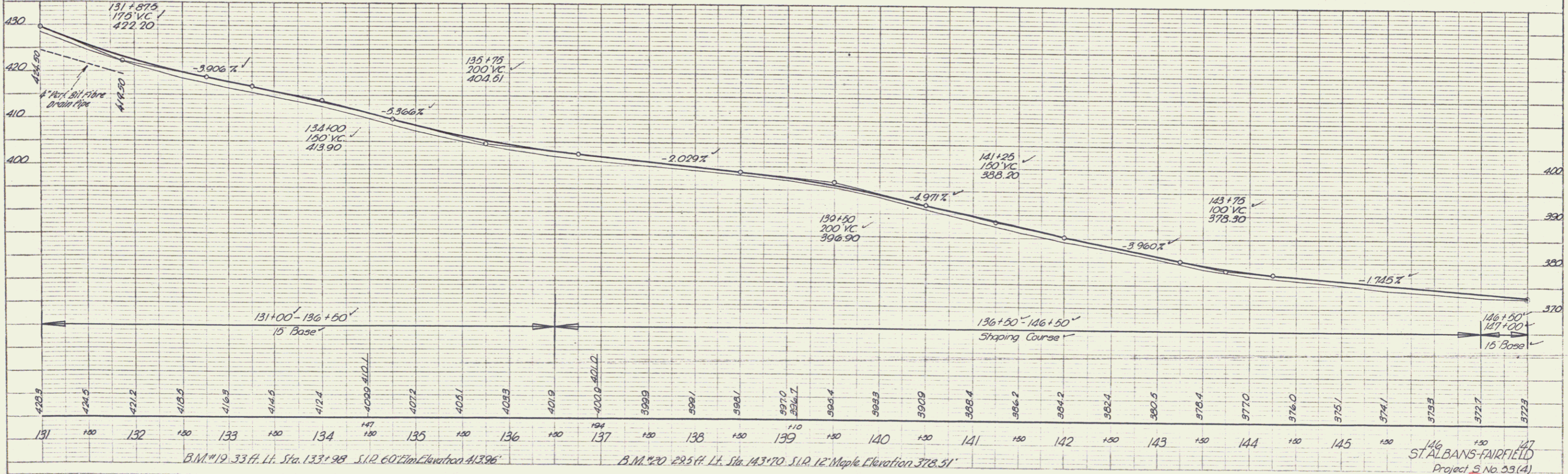
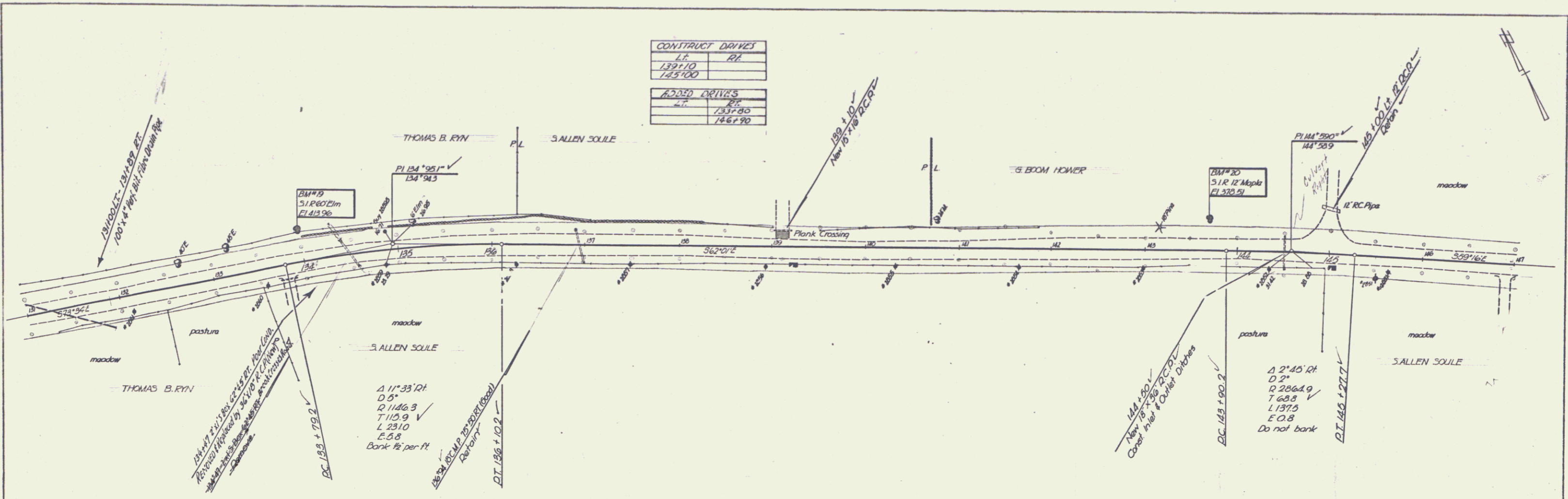

PLATE 1 - PLAN - PROFILE  
REVISED & ISSUED BY: H. H. & SONS  
NEW YORK, N.Y.

ST. ALBANS-FAIRFIELD  
Project No. 53 (A)  
Sheet 14 of 29

PLAN	DATE	BY	NO.
DATE	1/12/27	Murray	118
NO.			

PROFILE	DATE	BY	NO.
DATE	1/12/27	Ruddy	288
NO.			

CONSTRUCT DRIVES		ADDED DRIVES	
LL	RT	LT	RT
155+25		147+70	

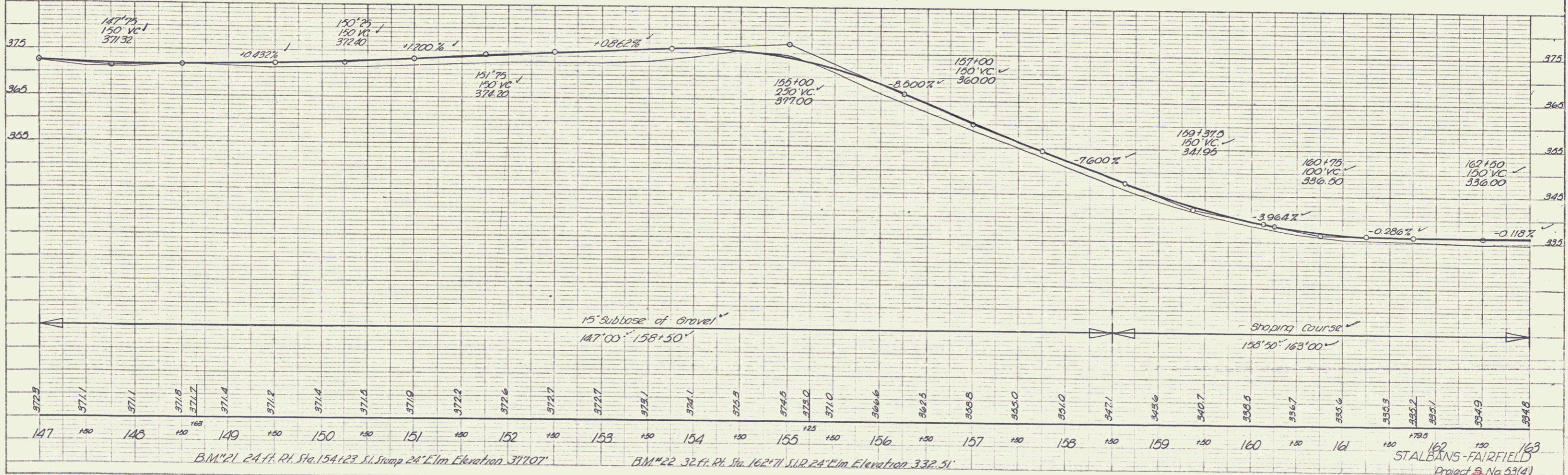
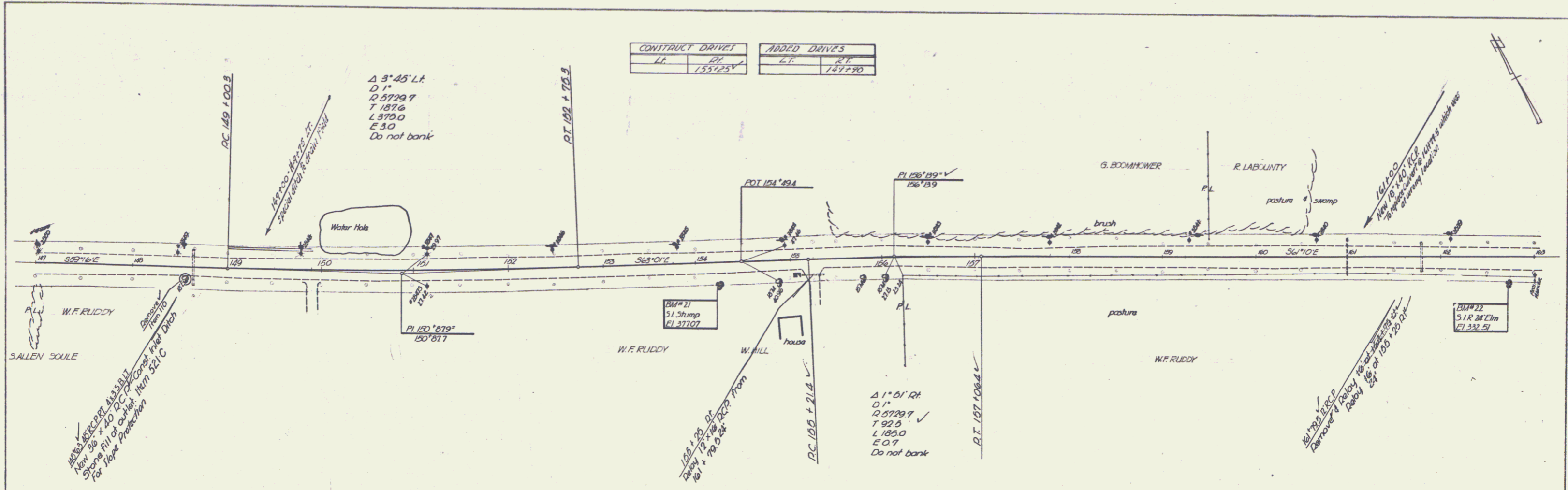

B.M. #21 24 ft. Rt. Sta. 154+23 51 Stump 24' Elm Elevation 371.07'      B.M. #22 32 ft. Rt. Sta. 162+71 S.W. 24' Elm Elevation 332.51'

STALBANS-FAIRFIELD  
Project No. 53(4)  
Sheet 15 of 29

PLATE 1 - PLAN - PROFILE & P. & E. SHEETS  
REDFIELD & BERRY CO., NEW YORK  
N.Y. CIV. ENGR. NO. 348-1-1202

