

INDEX OF SHEETS

SHEET NO. 1	TITLE PAGE
2	TYPICAL CROSS-SECTION OF IMPROVEMENT
3	BANKING AND WIDENING TABLES
4-7	PLAN AND PROFILE SHEETS
8	STANDARD STRUCTURE SHEET 5-30 GUARD RAIL AND GUIDE POSTS.
9	5-40 SIGNS AND LIGHTS & BARBICADES

STANDARD STRUCTURE SHEET 5-30 APPROVED BY THE CHIEF ENGINEER ON AUGUST 15, 1933

2 1/2" Gravel Mixed-in-Above Surface Course with Contract Top 10% of 2 1/2" Gravel
 2 1/2" Plant Mixed Gravel Surface Course with Cut-Back Asphalt, Item 97.

FED. ROAD DIST. NO.	STATE	FISCAL YEAR	SHEET NO.	TOTAL SHEETS
9	VT.	1936	1	9

**STATE OF VERMONT
STATE HIGHWAY DEPARTMENT**

**PLAN AND PROFILE OF PROPOSED
STATE HIGHWAY**

FEDERAL AID PROJECT

TOWN OF BROOKFIELD

MONTPELIER-RANDOLPH ROAD

FROM 500 FEET SOUTH OF BEAR HILL ROAD
SOUTHERLY 0.713 MILES TO 1900 FT. SOUTH
OF THE RESIDENCE OF T. W. KIRKPATRICK
LENGTH OF PROJECT 3765.1 FT.=0.713 MILES

Pin# 99R949

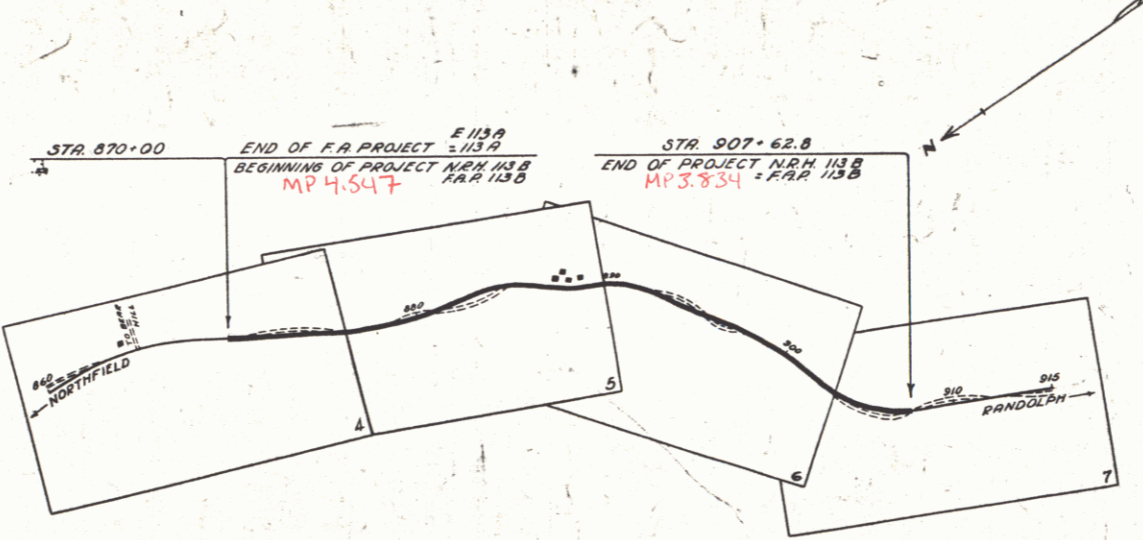
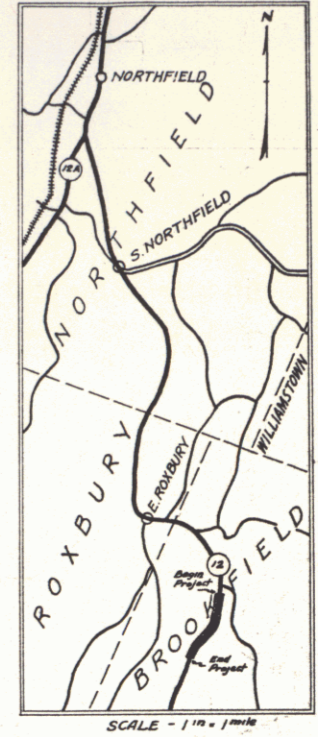

Rte VT12

FEB 29 1930

APPROVED: *July 20, 1936 (April 1, 1936)*
F. S. Stewart
COMMISSIONER OF HIGHWAYS

SUBMITTED BY ORDER OF THE STATE HIGHWAY BOARD

NOTE: ANY FURTHER INFORMATION CONCERNING FINAL QUANTITIES, MATERIALS OR OTHER DETAILS RELATIVE TO THIS PROJECT MAY BE FOUND IN EITHER THE FIELD BOOKS OR THE ESTIMATE FILE.

RECOMMENDED: [Signature] DISTRICT ENGINEER BUREAU OF PUBLIC ROADS
 RECOMMENDED FOR APPROVAL: [Signature] CHIEF ENGINEER BUREAU OF PUBLIC ROADS
 APPROVED: [Signature] DIRECTOR BUREAU OF PUBLIC ROADS

Note: These plans are subject to such revisions as may be required by the Bureau of Public Roads or the Commissioner of Highways. Construction is to be carried on in accordance with the plans and Standard Road and Bridge Specifications of 1930 including all subsequent approved revisions, and such revised specifications and special provisions as are submitted with these plans.

Note: The alignment and grades for this project are to be the same as on the original plans originally submitted for NRH 113-B, except that the grade is raised 2 1/2 inches.

RECORD PLANS

NOTE: THE SAME SET OF PLANS, LAYOUTS, AND CROSS-SECTIONS ARE USED FOR TWO CONTRACTS.

NRH 113-B, FISCAL YEAR 1933. DRAINAGE AND ROUGH GRADING.
TROY PAVING COMPANY, CONTRACTOR.

FAP 113-B FISCAL YEAR 1936. PAVING AND GUARD RAIL.
CALLAN CONSTRUCTION CO.- CONTRACTOR.

ALL NOTES IN RED INK REFER TO NRH 113-B. FINAL ESTIMATE OF FAP 113-B IS ON BLUEPRINT SHEET.

Project No. FAP 113B

APPROVED: *July 22, 1936*
F. S. Stewart
ROAD ENGINEER

SERIES FAP NO. 113-B FILED SHEET (1) OF 9

Brookfield - Odd Jobs
Pre - 1940

M

CONVENTIONAL SIGNS

COUNTY LINE
TOWN LINE
FENCE LINE
STONE WALL
UNFENCED PROPERTY
GUARD RAIL
TRAVELED WAY
RAILROAD
RETAINING WALL
CENTER LINE
SURVEY LINE
CULVERT
DROP INLET
TROLLEY POLE
POWER POLE
TELEPHONE POLE
TREES
HEDGE

CURVE DATA

DEFLECTION ANGLE
DEGREE OF CURVE
RADIUS OF CURVE
TANGENT DISTANCE
LENGTH OF CURVE
EXTERNAL DISTANCE
POINT OF INTERSECTION
POINT OF CURVE
POINT OF TANGENT
POINT ON TANGENT

SCALES
 TITLE 1" = 500 FT.
 PLAN 1" = 50 FT.
 PROFILE HOR. 1" = 50 FT.
 VERT. 1" = 10 FT.