

EDGE OF PAVEMENT TRANSITION		
STATION	LEFT	RIGHT
5+0	10'-9"	13'-6"
+75	11'-3"	14'-0"
+50	13'-3"	14'-6"
+25	14'-10"	15'-0"
4+0	15'-0"	15'-0"
+75	16'-0"	15'-0"
+50	15'-7"	13'-6"
+25	13'-6"	12'-0"
3+0	14'-4"	10'-6"

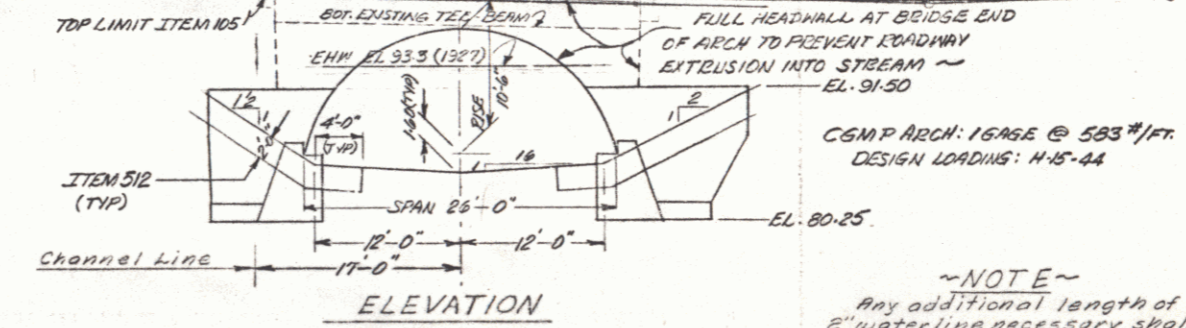
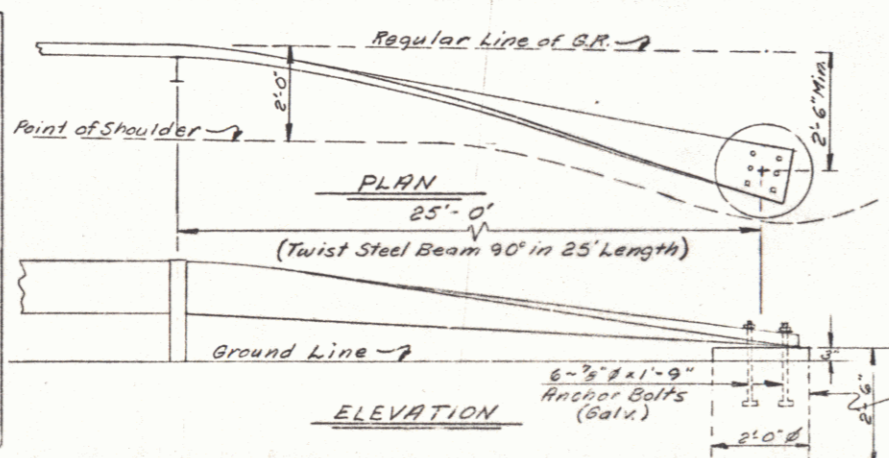

SEE SHEET #5 FOR GENERAL NOTES

STATE OF VERMONT  
 DEPARTMENT OF HIGHWAYS

TOWN OF BRAINTREE

ROUTE No. VI. 12 LOG STA. 46+39

VT ROUTE #12 OVER AYERS BROOK

GENERAL PLAN & ELEVATION

SCALE 1/8" = 1'-0"

SECTION R.L. MERCHANT

SUPERVISOR

DRAWN BY CERUTTI CHECKED BY JURENTUPE

PROJECT No. BB-035-2-6649

SHEET 2 OF 10