

BETTERMENT PROJECT

TOWN OF BRAINTREE
 COUNTY OF ORANGE
 VT. ROUTE 12 OVER AYERS BROOK

BEGINNING AT A POINT 0.698 MILES SOUTHERLY
 OF THE BRAINTREE - BROOKFIELD TOWN LINE AND
 EXTENDING WESTERLY 0.038 MILES
 PROJECT LENGTH: 0.038 MILES = 200 FEET

HYDRAULIC DATA
 Q 50 = 2000 cfs
 High Water Elev. = 94.7
 Br # 47

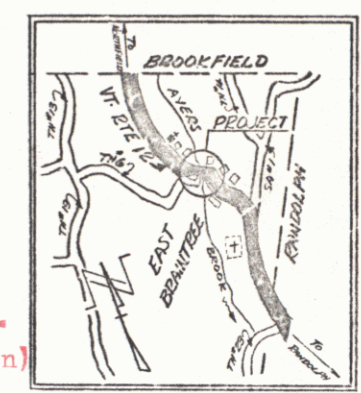

CURVE DATA
 Δ 62°-48' RT.
 D 34'
 R 171.02
 T 102.87
 L 104.71
 E 28.91

EXISTING BRIDGE DATA
 CONC. T-BEAM (1928)
 SOLID RAIL
 CLEAR SPAN - 30'
 CLEAR HEIGHT - 12.5'
 O.D. LENGTH - 33'
 ROADWAY - 81'
 WATERWAY - 400 SQ. FT.
 DESIGN LOADING H-15

CONSTRUCT DRIVES (by others)
 3+0 ~ RT.
 3+50 ~ LT.
 CONSTRUCT APPROACH (by others)
 TH#6 = 4+80 ~ LT.

ITEM 435 REMAINING RELAYING WATER PIPE
 STA 3+75 TO 4+80 ET.
 ITEM 595-C ~ 1" GALV. WROUGHT IRON WATER PIPE
 STA 4+075 RT - APPROX 47' LBS. AS SHOWN

ITEM 549 ~ REMOVAL & DISPOSAL OF PRESENT G.R. (by others)
 STA. 3+00 TO STA. 3+43 ET. = 43'
 STA. 3+57 TO STA. 3+85 ET. = 31'
 STA. 3+163 TO STA. 3+188 LT. = 25'
 STA. 4+22 TO STA. 4+167 RT. = 45'
 STA. 4+22 TO STA. 4+177 LT. = 55'
 169'

ITEM 545-C Medium Duty Steel Beam Guard Rail w/ Steel Posts (by others)
 STA. 3+37 TO STA. 4+92 ET. = 155'
 STA. 3+65 TO STA. 3+90 LT. = 25'
 STA. 4+20 TO STA. 4+65 LT. = 45'
 225'

THE CONTRACT PORTION OF THIS PROJECT INCLUDES THE
 INSTALLATION OF A 26'-0" SPAN x 10'-6" RISE x 32'-0" LONG
 CSMP ARCH WITH POURED CONCRETE ABUTMENTS, HALF-CIRCLE
 HEIGHT WINGS AT THE INLET END, FULL HEADWALL AT THE OUTLET
 END, CHANNEL ENCAVATION AND PLACEMENT OF LIGHT-TYPE STONE
 FILL AS INDICATED ON THE PLANS AND CHANNEL SECTIONS, THE
 REMOVING AND RELAYING OF WATERLINES AS INDICATED, THE FILLING
 AND GRADING OF THE EXISTING WATER-WAY AREA AS SHOWN ON THE
 CHANNEL SECTIONS, AND THE BACK FILLING TO SUB-GRADE ELEVATION
 WITH GRANULAR BORROW WITHIN THE LIMITS INDICATED ON
 THE ROAD-WAY SECTIONS AND AS DIRECTED BY THE ENGINEER ~
 THE REMAINING WORK SHALL BE PERFORMED BY FORCES OF THE
 STATE OF VERMONT ~

CURVE DATA
 Δ 62°-30' LT.
 D 48'
 R 122.93
 T 72.43
 L 130.21
 E 20.26

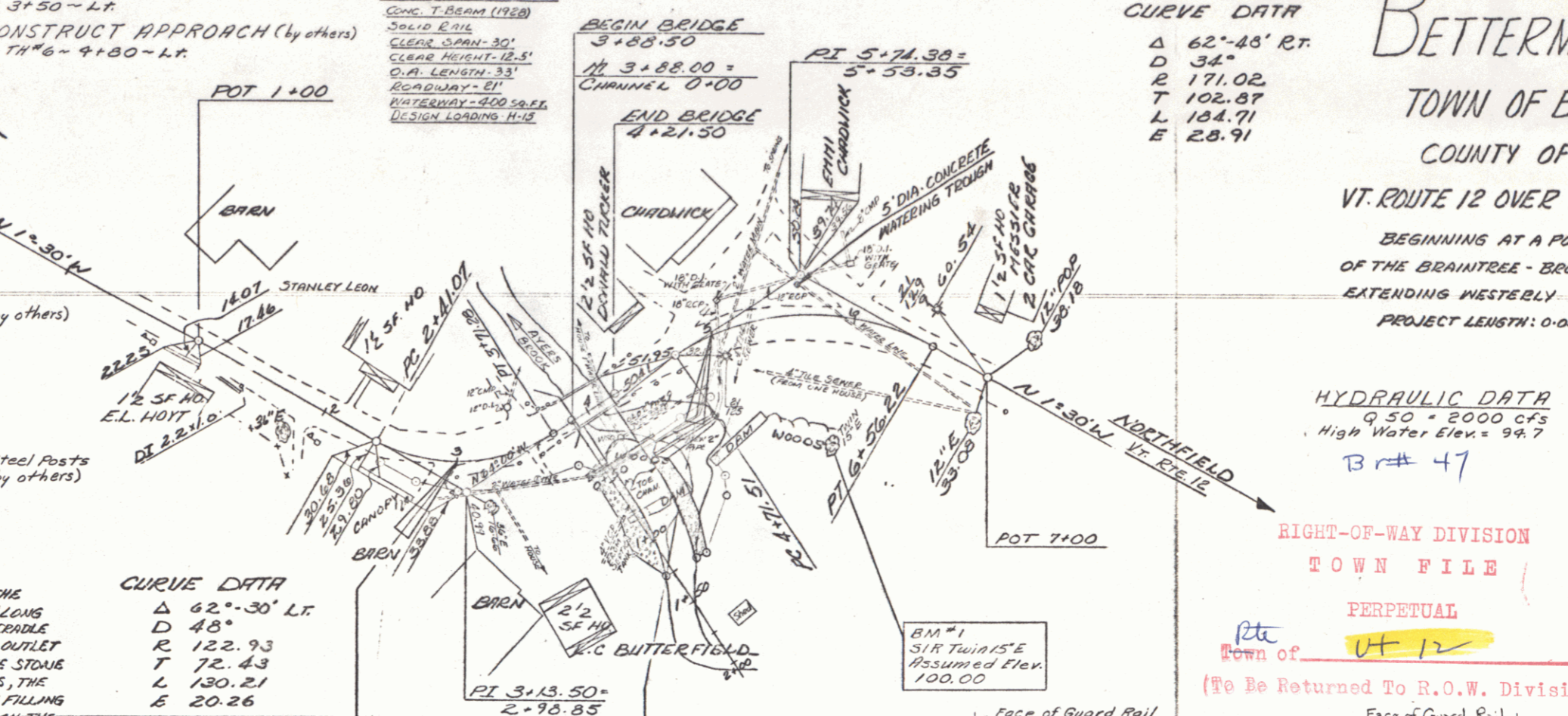

RIGHT-OF-WAY DIVISION
 TOWN FILE
 PERPETUAL
 Town of VT 12
 (To Be Returned To R.O.W. Division)

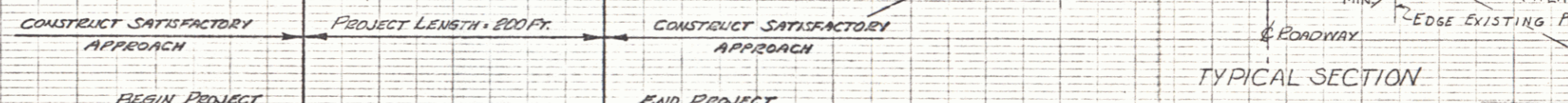

- INDEX OF SHEETS
- TITLE SHEET
 - PLAN & ELEVATION
 - BRIDGE QUANTITIES
 - BORING SHEET
 - TYPICAL SECTION & DETAILS
 - ARCH INLET & OUTLET DETAILS
 - REINFORCING STEEL SCHEDULE
 - R.O.W. LAYOUT
 - R.O.W. DETAILS
 - R.O.W. ROADWAY X-SECTIONS
 - CHANNEL X-SECTIONS

- STANDARD SHEETS
- FOR CONTRACT:
- 15E-33 1-6-67
 - 15E-38 1-4-68
 - 16S1B-D6-57 1-24-68 @
- FOR FORCE ACCOUNT:
- B-13 3-1-65
 - E-35 1-4-67
 - E-36 1-4-68
 - G-18 7-11-67 8-11 1-11-68
 - SB-R1-64 11-3-66 (SHEET 2 OF 2)

RECOMMENDED FOR APPROVAL	<i>[Signature]</i>	5/24/68	120
DISTRICT ENGINEER		DATE	
RECOMMENDED FOR APPROVAL	<i>[Signature]</i>	5/21/68	110
BRIDGE ENGINEER		DATE	
RECOMMENDED FOR APPROVAL	<i>[Signature]</i>	5/21/68	110
CONSTRUCTION ENGINEER		DATE	
RECOMMENDED FOR APPROVAL	<i>[Signature]</i>	6/4/68	100
ASSISTANT CHIEF ENGINEER		DATE	
APPROVED BY	<i>[Signature]</i>	6/4/68	100
CHIEF ENGINEER		DATE	

TOWN OF
 BRAINTREE
 BB-035-2-6649
 Pin # 992948
 2/6/1968
 SHEET 1 OF 15

PLAN
 1/11/68
 2/12/68
 3/12/68
 4/12/68
 5/12/68
 6/12/68
 7/12/68
 8/12/68
 9/12/68
 10/12/68
 11/12/68
 12/12/68

120
 110
 100
 90
 80

PROJECT NAME & NUMBER
 BRAINTREE BB-035-2-6649
 CONTRACTOR W.B. ROGERS, INC.
 RESIDENT ENGINEER W.B. WALKER
 RECORD PLANS BY W.B. WALKER
 CONTRACT DATED SEPT. 30, 1968
 PROJECT ACCEPTED MAY 27, 1968
 COMPARED NEW ENGLAND
 C.B. CONG. MILLER READY MIX
 REINF. STEEL K. ROSS CO.

PROJECT BEGIN AT A POINT 0.698 MILES SOUTHERLY
 OF THE BRAINTREE - BROOKFIELD TOWN LINE
 AND EXTENDING WESTERLY 0.038 MILES

