

FED. ROAD DIST. NO.	STATE	FLOOD RELIEF PROJ. NO.	FISCAL YEAR	SHEET NO.	TOTAL SHEETS
9	VT	12 D	1926	18	25

WOOD GUARD RAIL REQUIRED

~ LEFT ~
 STA 2+78 TO STA 3+10 = 32 LIN. FT.
 STA 3+30 TO STA 3+70 = 40 " "
 ~ RIGHT ~
 STA 2+94 TO STA 3+10 = 16 LIN. FT.
 STA 3+30 TO STA 3+62 = 32 " "
 ~ TOTAL ~ 120 LIN. FT.

GRAVEL SURFACE COURSE REQUIRED
 ESTIMATED QUANTITY 175 CU YDS

SHEETS TO BE USED

PLAN AND PROFILE
 TYPICAL SECTION OF IMPROVEMENT
 S.L.B. 20 - 3R 20' SPAN 15" SKEW WITH CURB
 S.A.R. 20' 15" SKEW
 S.B.2 TYPICAL DETAILS
 CROSS SECTIONS
 S.A.S.19 STANDARD STRUCTURES

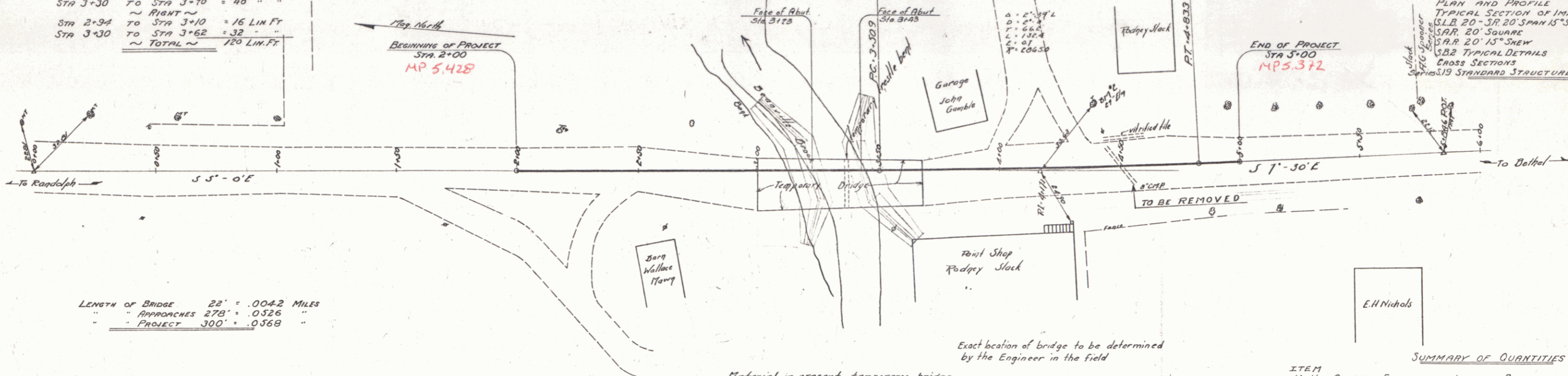

LENGTH OF BRIDGE 22' = .0042 MILES
 " " APPROACHES 278' = .0526 " "
 " " PROJECT 300' = .0568 "

Exact location of bridge to be determined by the Engineer in the field

Material in present temporary bridge to become the property of the contractor and to be removed by him

SUMMARY OF QUANTITIES

ITEM	DESCRIPTION	QUANTITY	UNIT
10-11	COMMON EXCAVATION INCLUDING BORROW	325	CU YDS
15	STRUCTURE EXCAVATION	225	" "
20A	GRAVEL SURFACE COURSE	175	" "
34A	CONCRETE CLASS A (1-2-4)	43	" "
34B	CONCRETE CLASS B (1-2-5)	388	" "
35	REINFORCING STEEL	32,065	LBS.
5-5	TEMPORARY BRIDGE	1	LAMP SUR.
6-6	WOOD GUARD RAIL	120	LIN. FT.

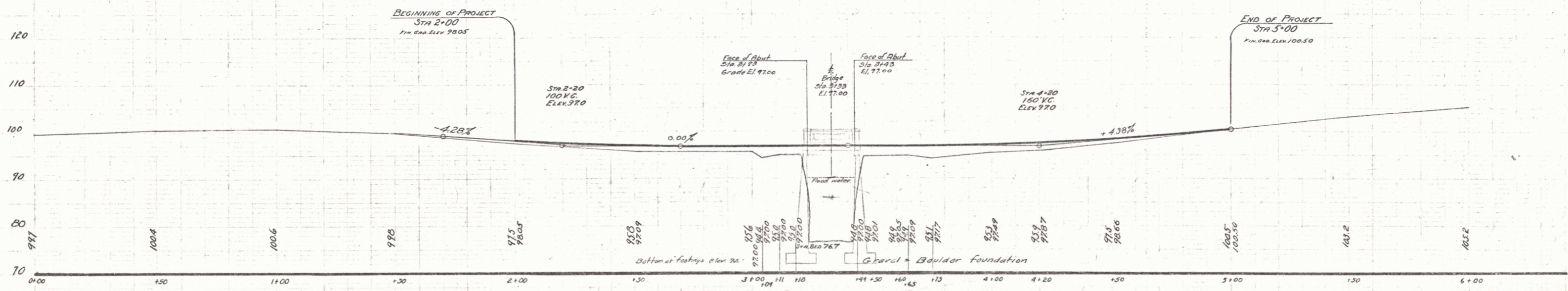

DISTRICT NO. 7
 BRIDGE NO. 97
 RANDOLPH
 Scale - 1" = 20' 0"

3.17' The Maple on left - Elev. 100.00
 2.17' Elev. Sta. + 39.42 2.5' 93.11