

**WOOD GUARD RAIL REQUIRED**  
 LEFT  
 Sta. 2+51 to 2+53 = 32 Lin. Ft.  
 " 3+27 " 3+59 = 32 " "  
 RIGHT  
 Sta. 2+51 to 2+53 = 32 Lin. Ft.  
 " 3+27 " 3+59 = 32 " "  
 Total - 128 Lin. Ft.

**GRAVEL SURFACE COURSE REQUIRED**  
 Estimated Quantity - 570 Cu. Yds.

| PER. ROAD DIST. NO. | STATION  | FOOTING NO. | PIERCING NO. | SHEET NO. | TOTAL SHEETS |
|---------------------|----------|-------------|--------------|-----------|--------------|
| 3                   | VT. 12 D | 1926        | 3            | 25        |              |

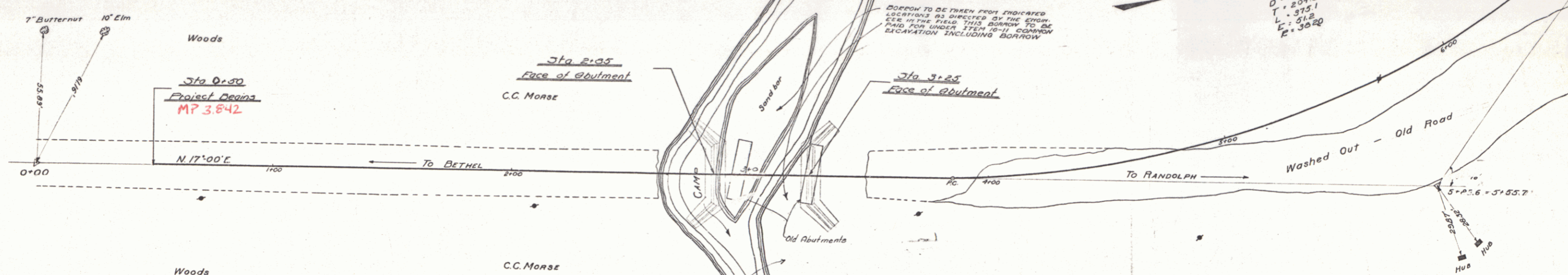

**SHEETS TO BE USED**  
 TYPICAL CROSS SECTION OF IMPROVEMENT (2' Gravel)  
 S.D. 20 - 10' Square  
 S.D. 2 - Typical Details  
 S.D. 4 - Solid Rail  
 S.D. 19 - Standard Structures

**SUMMARY OF QUANTITIES**

| Item No. | Description                        | Quantity | Unit     |
|----------|------------------------------------|----------|----------|
| 10-11    | Common Excavation including Borrow | 2150     | Cu. Yds  |
| 15       | Structure Excavation               | 300      | "        |
| 20       | Gravel Surface Course              | 570      | "        |
| 34       | Concrete Class B (1-2-4)           | 50       | "        |
| 34       | Concrete Class B (1-2-3)           | 170      | "        |
| 35       | Reinforcing Steel                  | 18,000   | Lbs.     |
| 66       | Wood Guard Rail                    | 128      | Lin. Ft. |

Length of Bridge 43' = 0.008 Miles  
 Approaches 907' = 0.172  
 Project 950' = 0.180

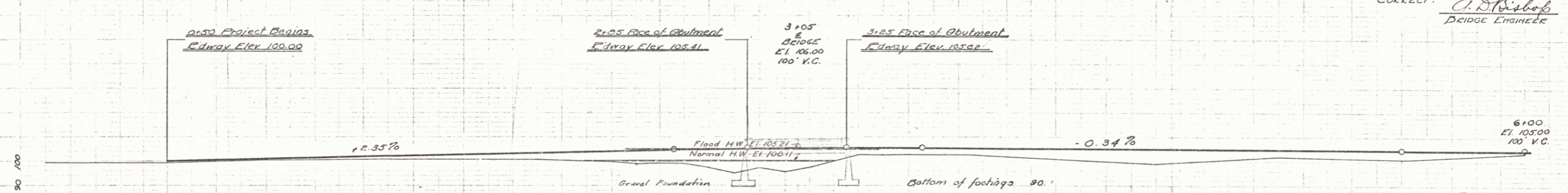

CORRECT: C. St. Bishop  
 BRIDGE ENGINEER

**BETHEL**  
 BRIDGE No. 25-20  
 DISTRICT No. 5  
 Scales Hor. 1" = 20'  
 Vert. 1" = 20'

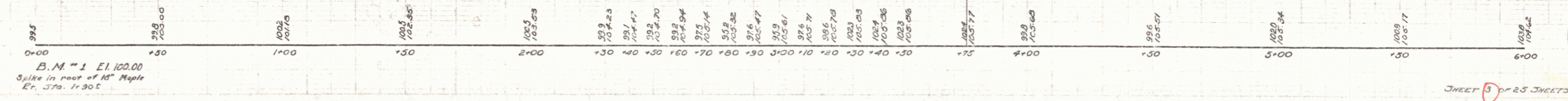

SHEET 3 OF 25 SHEETS