

C. & R. TREE
 ITEM 110

B.M. #62
 S.I.R. 15" Pine
 El. 833.65

Construct Drives
 Lt
 Sta 661+80
 Sta 663+80
 Sta 669+50
 Sta 666+90

B.M. #62-A
 S.I.R. 18" E
 El. 827.30

Construct Drives
 Sta 661+0 Rk
 Sta 670+25 Rk
 Sta 670+70 Lk Rk
 Sta 671+0 Rk

Rev Curve Data
 Δ: 0°-56' Lt
 D: 0°-30'
 R: 11459.2'
 T: 93.3'
 L: 186.6'
 E: 0.41'
 No Bank

PLAN
 SURVEYED BY: [Signature]
 PLOTTED BY: [Signature]
 NOTE BOOK ALIGNED CHECKED BY: [Signature]
 NO. OF PAGES: 1/53

School House

LAURA I. CAMPBELL

LAURA I. CAMPBELL

Sta. 670+65 Non Gov't Participation
 Install sleeve for water pipe across
 roadway, Item 103 (Non Gov't)
 Sleeve to be furnished by Property Owner.

Sta 658+0 Rk 659+50 Rk
 Parking Area

Sta 660+0 Rk
 New 18" S.I.R. E.C.P.
 S.H. Inlet

Sta 662+0 Rk
 New 24" S.I.R. E.C.P.
 S.H. Inlet

Sta 662+87
 New 24" S.I.R. E.C.P.
 S.H. Inlet

Sta 663+89 Rk 664+80 Lt
 15' Lk - 6' Part. ACCUM Underdrain
 S.H. Outlet 37' x 1' Long

Sta 667+95 Rk 668+0 Rk
 8' Part. ACCUM Underdrain
 S.H. Outlet 37' x 1' Long

Rev. P.T. 670+43.3
 P.I. 669+50
 669+50

PROFILE
 SURVEYED BY: [Signature]
 PLOTTED BY: [Signature]
 NOTE BOOK ALIGNED CHECKED BY: [Signature]
 NO. OF PAGES: 1/53

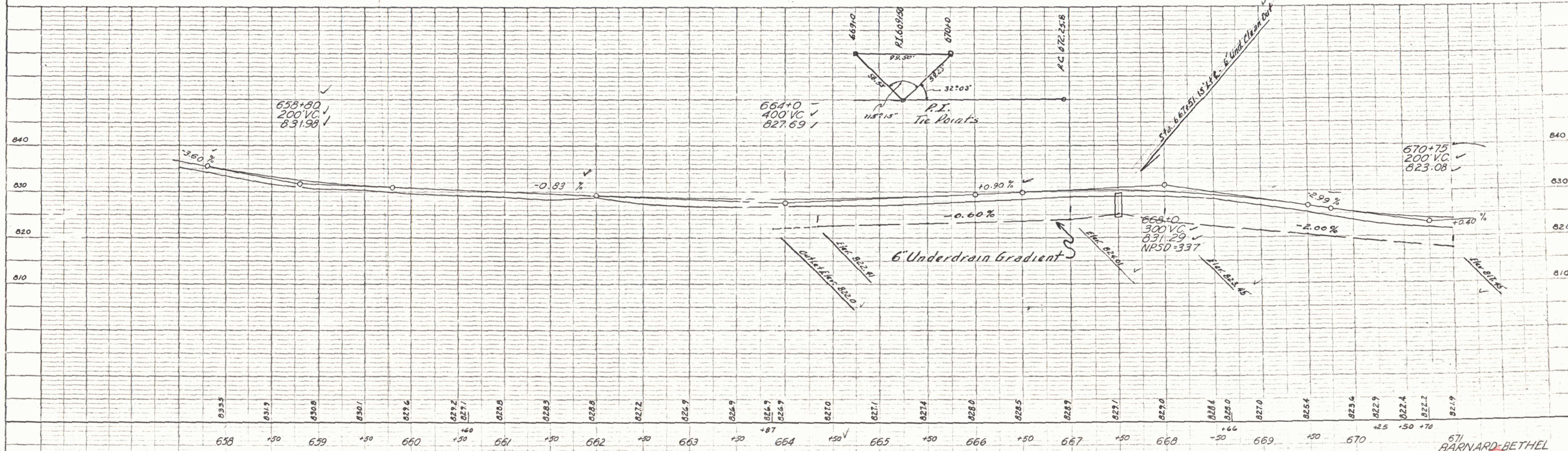

B.M. #62 S.I.R. 15" Pine 38' Lt. of Sta 658+90 El. 833.65
 B.M. #62-A S.I.R. 18" Elm 32' Lt. of Sta 663+05 El. 827.30

671 BARNARD-BETHEL
 40