

VERMONT DEPARTMENT OF HIGHWAYS  
 RIGHT - OF - WAY PLANS  
 PROJECT: WEATHERSFIELD  
 No. FO19-1(1)  
 SHEET 2 OF 8

3141.29  
 4143.27  
 4189.29  
 5190.24  
 5192.17

REVISIONS TO PLANS OF ROAD  
 SURVEYS AND ADJUSTMENTS  
 7-25-24 3017  
 10-28  
 2-15-24 3022  
 2-15-24 3029  
 4-10-24 3027

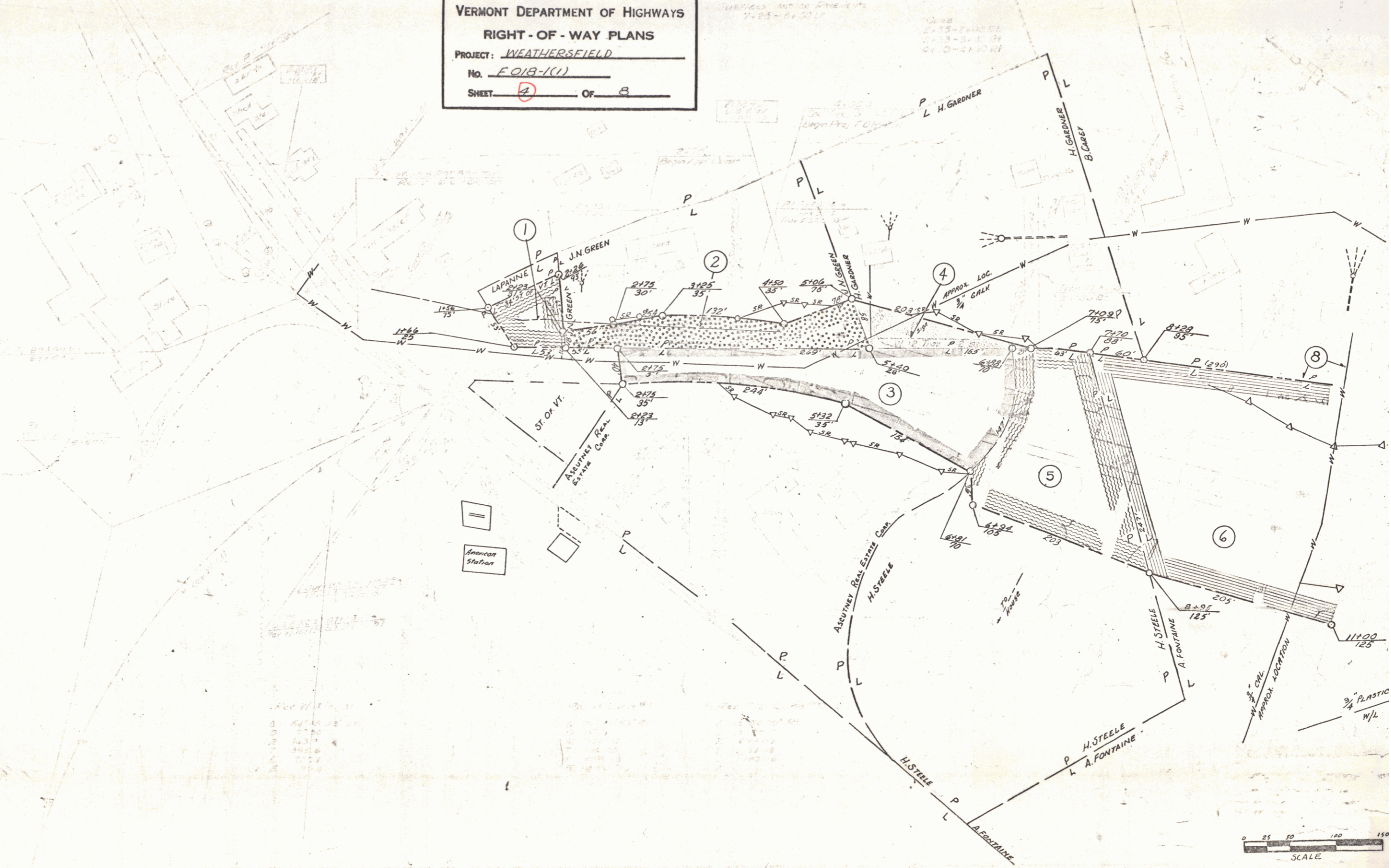

ST. OR. V.  
 American Station

SCALE  
 0 25 50 100 150

SHEET 4 of 8

5