

INDEX OF SHEETS

1a	TITLE SHEET	
2a	TYPICAL SECTION, BITUMINOUS CONCRETE PAVEMENT, ITEM 361 MOD.	
3a	QUANTITY SHEET	
4a	DRAINAGE SHEET	
5a	GRADE AND EARTHWORK SHEET	
6a-9a	PLAN AND PROFILE SHEETS	
10a	B-5 TYPICAL SLOPE GRADING	3/10/65
11a-b	C-1 CURBS	10/23/68 R
12a	C-1A CURBS	3/10/65
13a	C-2A SIDEWALK AND DRIVES	3/10/65
14a	C-2B SIDEWALK AND DRIVES	3/10/65
15a	D-2 UNDERDRAIN AND HEADWALLS	7/25/67 R
16a	D-4 CAST IRON COVERS FOR FLUSHING BASINS	12/4/68 R
17a	D-8 DROP INLETS	3/10/65
18a	D-9 DROP INLET TOPS	3/10/65
19a	D-10 DROP INLET TOPS	3/10/65
20a	D-11 DETAILS OF GRATES AND COVERS	3/10/65
21a	E-31 FEDERAL AID CONSTRUCTION IDENTIFICATION SIGNS	8/21/67 R
22a	E-32 ROAD CONSTRUCTION APPROACH SIGNS	1/ 6/67
23a	E-34 ON-PROJECT CONSTRUCTION SIGNS	9/ 3/67 R
24a	G-4 WOOD AND STEEL MARKER POSTS	12/30/65 R
25a	J-1 PROJECT MARKERS, BOUNDARY MARKERS	3/10/65
26a	K-1 TRAFFIC SIGNS	
27a-31a	SECTIONS	
32a-40a	DRAINAGE SECTION	

**STATE OF VERMONT
DEPARTMENT OF HIGHWAYS
PROPOSED IMPROVEMENT**

TOWN OF FAIR HAVEN

**COUNTY OF RUTLAND
RELOCATION OF STATE AID ROUTE 5**

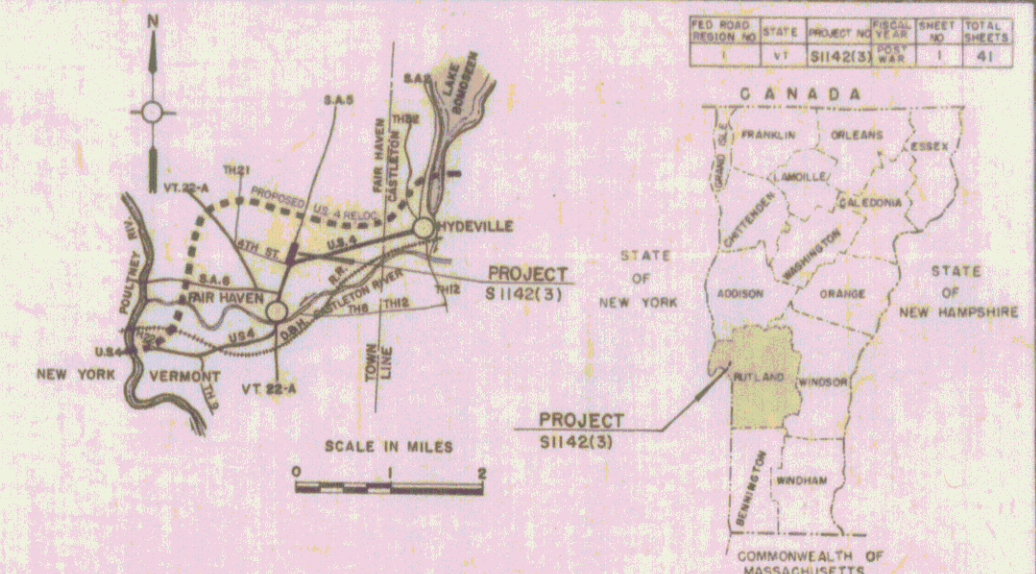

PROJECT NAME & NUMBER TYPE PAVEMENT AREA
FAIR HAVEN S 1142(3) BIT. CONC. 4,825 S.Y.
RECORD PLANS
MATERIALS

SUBBASE OF GRAVEL — BISHOP PIT — WEST HAVEN, VT.
 CRUSHED GRAVEL OR CRUSHED STONE PLANT MIXED BASE COURSE &
 BITUMINOUS CONCRETE — L.M. PIKE PLANT — FLORENCE, VT.
 CONCRETE CLASS B — J.P. GARRARA & SONS PLANT — CASTLETON, VT.
 REINFORCING STEEL — MILTON MFG. CO., DIV. CECO CORP. — MILTON, PA.
 REINFORCED CONCRETE PIPE, GRANITE CURBS, BOUNDS & EROSION CONTROL
 ITEMS — S.T. GRISWOLD & CO., INC. — WILLISTON, VT.
 UNDERDRAIN — KAISER ALUMINUM & CHEMICAL SALES, INC. — SCHENACTADY, N.Y.

CONTRACTOR — THE LANE CONSTR. CORP.
 MERIDEN, CT.
RESIDENT ENGINEER — R.W. BUTLER.
INSPECTORS — D. LATHROP & J. STEARNS.
RECORD PLANS — A.G. SPIDLE.

CONTRACT DATED — MAY 16, 1969.
STARTED — MAY 21, 1969.
ACCEPTED — JUNE 16, 1971.

BEGINNING AT THE POINT OF INTERSECTION OF
 U.S. ROUTE 4 AND STATE AID ROUTE 5 AND
 PROCEEDING NORTHERLY 0.187 MILES.
 LENGTH OF PROJECT 98700 FEET = 0.187 MILES
TRAFFIC DATA

1965	ADT	150
1965	ADT	2300
1965	DHV	315
	D	94%
	T	8%
	V	50 MPH

- CONVENTIONAL SIGNS**
- RDW. FENCE
 - SLOPE RIGHTS
 - CONTROL OF ACCESS
 - RDW.
 - COUNTY LINE
 - TOWN LINE
 - FENCE LINE
 - STONE WALL
 - UNFENCED PROPERTY
 - GUARD RAIL
 - TRAVELED WAY
 - RAILROAD
 - RETAINING WALL
 - CENTER LINE
 - SURVEY LINE
 - CULVERT
 - DROP INLET
 - TROLLEY POLE
 - POWER POLE
 - TELEPHONE POLE
 - TREES
 - HEDGE
 - ACCESS POINT

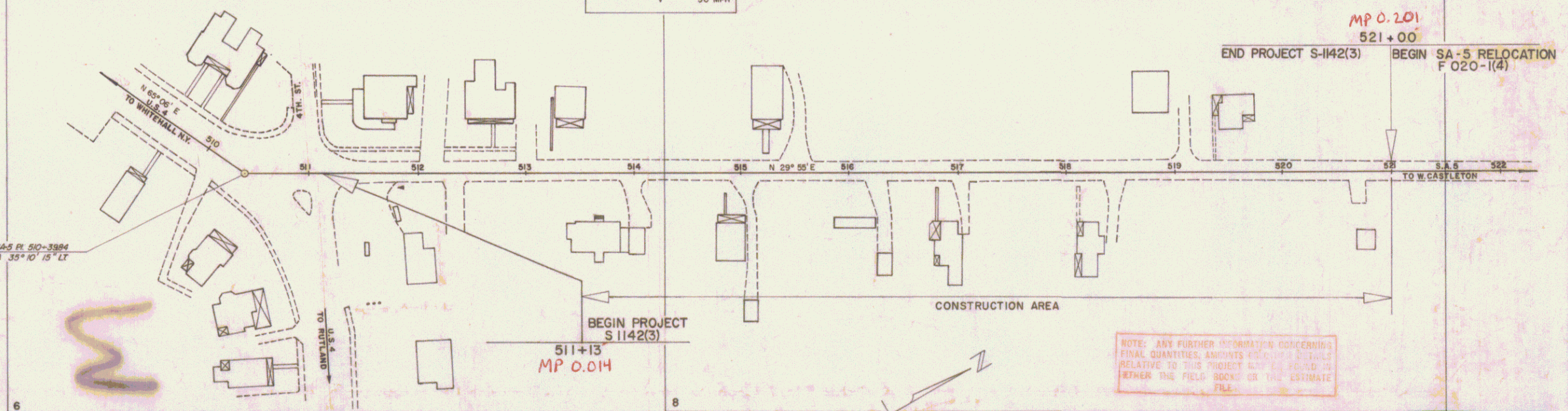

GROUND ELEVATION DATUM MEAN SEA LEVEL
 ALL ELEVATIONS ARE U.S. ELEVATIONS

GRADE ELEVATION DATUM

SCALE IN FEET
 0 50 100 150

DEFLECTION OF ANGLE	Δ
DEGREE OF CURVE	D
RADIUS OF CURVE	R
TANGENT DISTANCE	T
LENGTH OF CURVE	L
EXTERNAL DISTANCE	E
POINT OF INTERSECTION	P.I.
POINT OF CURVE	P.C.
POINT OF TANGENT	P.T.
POINT ON TANGENT	P.O.T.
POINT ON SUB-TANGENT	P.O.S.T.
CONSTRUCTION IDENTIFICATION SIGNS	

WEBSTER-MARTIN, INC.
 Robert A. Slafos
 No. 814
 PROFESSIONAL ENGINEER
 SUBMITTED APRIL 30, 1968
 DATE

FOR RIGHT-OF-WAY DETAILS, SEE RIGHT-OF-WAY PLANS FOR THIS PROJECT.
 REQUIRED NUMBER OF FEDERAL AID CONSTRUCTION IDENTIFICATION SIGNS 1 EACH.
 THESE PLANS ARE SUBJECT TO SUCH REVISIONS AS MAY BE REQUIRED BY THE BUREAU OF PUBLIC ROADS OR THE COMMISSIONER OF HIGHWAYS.
 CONSTRUCTION IS TO BE CARRIED ON IN ACCORDANCE WITH THESE PLANS AND THE STANDARD SPECIFICATIONS FOR HIGHWAY AND BRIDGE CONSTRUCTION DATED APRIL, 1964, AS APPROVED BY THE BUREAU OF PUBLIC ROADS ON OCTOBER 12, 1964, INCLUDING ALL SUBSEQUENT APPROVED REVISIONS AND SUCH REVISED SPECIFICATIONS AND SPECIAL PROVISIONS AS ARE INCORPORATED IN THESE PLANS.

DEPARTMENT OF TRANSPORTATION
 BUREAU OF PUBLIC ROADS

APPROVED

DIVISION ENGINEER DATE

APPROVED *E.H. Stebbins* DIST. ENG. DATE 10/18/67
 APPROVED *G.P. Lamb* CONSTR. ENGINEER DATE 10/18/67
 APPROVED *B. Brown* S. CIV. ENGINEER DATE 10/18/67
 APPROVED *J. Decker* DIST. ENGINEER DATE 10/18/67
 APPROVED *G.M. Lane* HIGHWAY ENGINEER DATE 10/18/67
 APPROVED *R.H. Arnold* SUIP ENGINEER DATE 10/21/67
 SUBMITTED BY ORDER OF THE STATE HIGHWAY BOARD

Pin # 992919
 Route ST HWY
 PROJECT S 1142(3)
 SHEET 19 OF 41 SHEETS

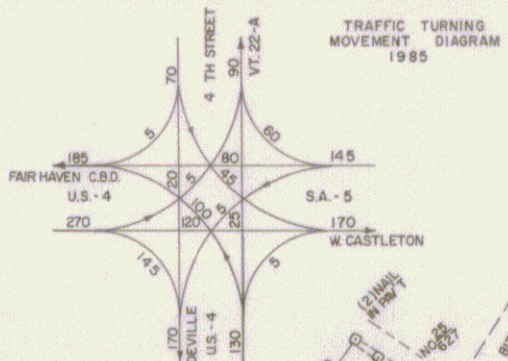
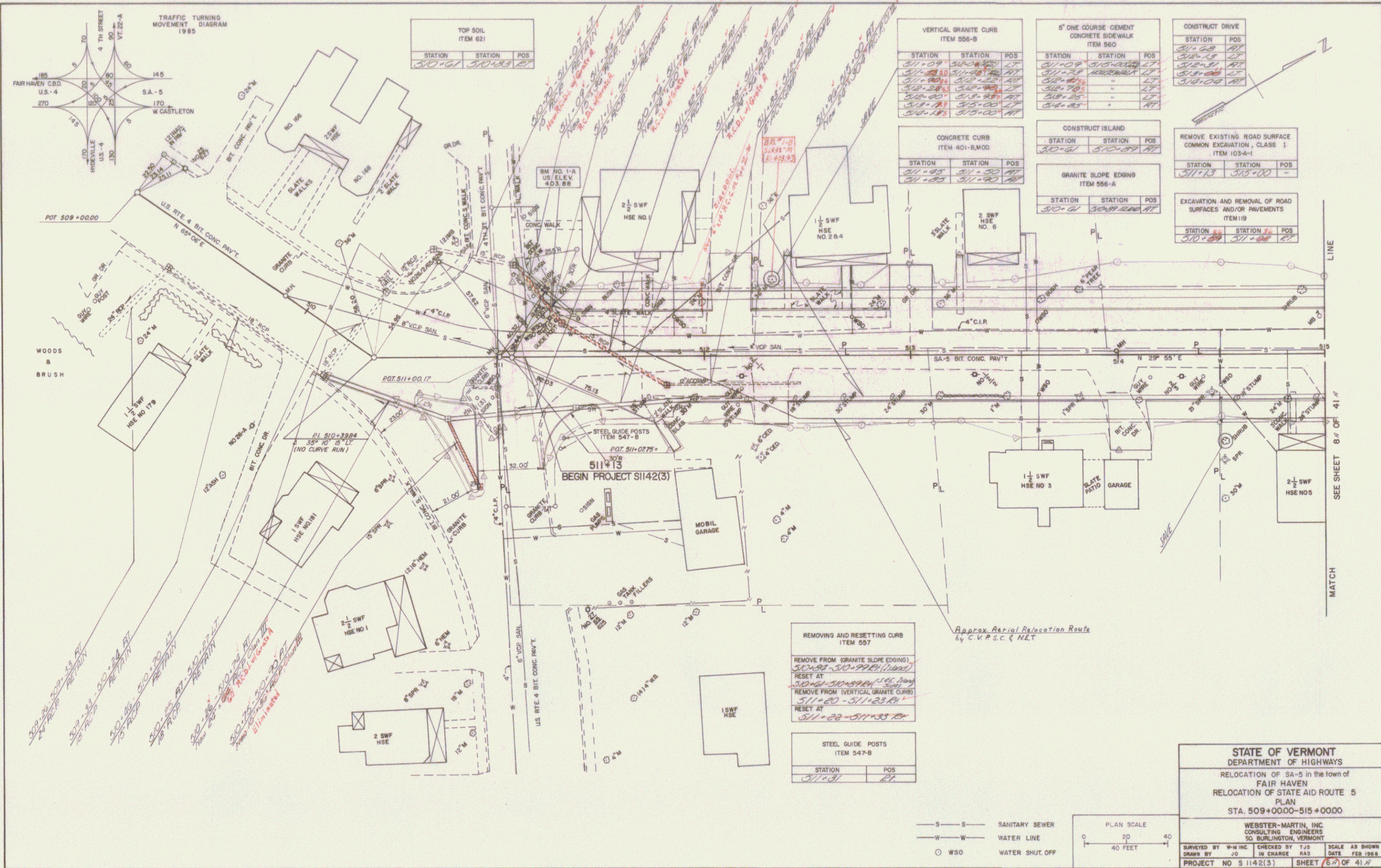

TOP SOIL ITEM 621		
STATION	STATION	POS
510+61	510+83	RT

VERTICAL GRANITE CURB ITEM 556-B		
STATION	STATION	POS
511+09	510+83	LT
511+09	510+83	RT
511+09	510+83	LT
511+09	510+83	RT
511+09	510+83	LT
511+09	510+83	RT
511+09	510+83	LT
511+09	510+83	RT
511+09	510+83	LT
511+09	510+83	RT

6" ONE COURSE CEMENT CONCRETE SIDEWALK ITEM 560		
STATION	STATION	POS
511+09	510+83	LT
511+09	510+83	RT
511+09	510+83	LT
511+09	510+83	RT
511+09	510+83	LT
511+09	510+83	RT
511+09	510+83	LT
511+09	510+83	RT
511+09	510+83	LT
511+09	510+83	RT

CONSTRUCT DRIVE		
STATION	POS	
511+09	RT	
511+09	LT	
511+09	RT	
511+09	LT	
511+09	RT	
511+09	LT	

CONCRETE CURB ITEM 401-B/MOD		
STATION	STATION	POS
511+09	511+50	RT
511+09	511+50	LT

CONSTRUCT ISLAND		
STATION	STATION	POS
510+61	510+83	RT

REMOVE EXISTING ROAD SURFACE COMMON EXCAVATION, CLASS 1 ITEM 103-4-1		
STATION	STATION	POS
511+13	515+00	-

GRANITE SLOPE EDGING ITEM 556-A		
STATION	STATION	POS
510+61	510+83	RT

EXCAVATION AND REMOVAL OF ROAD SURFACES AND/OR PAVEMENTS ITEM 119		
STATION	STATION	POS
510+61	511+00	RT

REMOVING AND RESETTING CURB ITEM 557		
REMOVE FROM (GRANITE SLOPE EDGING)		
510+83 - 510+92 (11' long)		
RESET AT 510+61 - 510+83 (11' long)		
REMOVE FROM (VERTICAL GRANITE CURB)		
511+20 - 511+23 (3' long)		
RESET AT 511+22 - 511+23 (1' long)		

STEEL GUIDE POSTS ITEM 547-B		
STATION	POS	
511+31	RT	

STATE OF VERMONT
DEPARTMENT OF HIGHWAYS
 RELOCATION OF SA-5 in the town of FAIR HAVEN
 RELOCATION OF STATE AID ROUTE 5
 PLAN
 STA. 509+0000-515+0000

WEBSTER-MARTIN, INC.
 CONSULTING ENGINEERS
 30 BURLINGTON, VERMONT

DESIGNED BY W-M INC | CHECKED BY TJS | SCALE AS SHOWN
 DRAWN BY JO | IN CHARGE: NAS | DATE: FEB 1988

PROJECT NO S 1142(3) | SHEET 6 OF 41

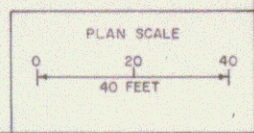
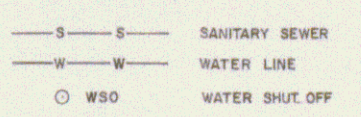

SEE SHEET 8 OF 41
 MATCH

