

INDEX OF SHEETS

- 1 TITLE SHEET
- 2-12 PLANS
- 13-16 QUANTITY SHEETS, ITEMS
- 17-19 EARTHWORK AND GRADE SHEETS
- 20-24 PLAN SHEETS
- 25-28 PROFILES
- 29-31 PLAN AND ELEVATION OF BRIDGE OVER WHITE RIVER
- 32-34 END CONTOUR PLAN
- 35-37 DETAILS OF BRIDGE BASE DETAILS
- 38-40 UTILITY SHEETS
- 41-43 UTILITY SHEETS F037-1(1)
- 44-46 UTILITY SHEETS F041-3(1)
- 47-49 UTILITY SHEETS F020-3(1)
- 50-52 BLANK-59 8-8 METHOD OF SLOPE STABILIZATION 3-10-65 F037-1(3)
- 53-55 LOCATION OF UNDERGROUND SYSTEM FOR STREET LIGHTING F041-3(1)
- 56-57 LOCATION OF UNDERGROUND SYSTEM FOR STREET LIGHTING F020-3(1)
- 58-60 TRAFFIC CONTROL SIGNALS F041-3(1)
- 61-63 TRAFFIC CONTROL SIGNALS F020-3(1)
- 64-66 TRAFFIC SIGNS F041-3(1)
- 67-69 TRAFFIC SIGNS F020-3(1)
- 70-72 TRAFFIC SIGNS F041-3(1)
- 73-75 TRAFFIC SIGNS F020-3(1)
- 76-78 TRAFFIC SIGNS F041-3(1)
- 79-81 TRAFFIC SIGNS F020-3(1)
- 82-84 ISLANDS 7-21-67 R
- 85-87 DETAILS FOR YIELDING TYPE SIGN POSTS
- 88-90 CONSTRUCTION AND ASSEMBLY DETAILS FOR PLYWOOD SIGNS
- 91-93 OVERHEAD TRAFFIC SIGN SUPPORTS F041-3(1)
- 94-96 OVERHEAD TRAFFIC SIGN SUPPORTS F020-3(1)
- 97-99 TYPICAL ALUMINUM BRIDGE ROLING 1-31-68 B II-R-66 R
- 100-102 BANKING TABLES 1-17-67 R
- 103-105 CURBS 3-10-65
- 106-108 CURBS 3-10-65
- 109-111 CURBS 3-10-65
- 112-114 CURBS 3-10-65
- 115-117 CURBS 3-10-65
- 118-120 CURBS 3-10-65
- 121-123 CURBS 3-10-65
- 124-126 CURBS 3-10-65
- 127-129 CURBS 3-10-65
- 130-132 CURBS 3-10-65
- 133-135 CURBS 3-10-65
- 136-138 CURBS 3-10-65
- 139-141 CURBS 3-10-65
- 142-144 CURBS 3-10-65
- 145-147 CURBS 3-10-65
- 148-150 CURBS 3-10-65
- 151-153 CURBS 3-10-65
- 154-156 CURBS 3-10-65
- 157-159 CURBS 3-10-65
- 160-162 CURBS 3-10-65
- 163-165 CURBS 3-10-65
- 166-168 CURBS 3-10-65
- 169-171 CURBS 3-10-65
- 172-174 CURBS 3-10-65
- 175-177 CURBS 3-10-65
- 178-180 CURBS 3-10-65
- 181-183 CURBS 3-10-65
- 184-186 CURBS 3-10-65
- 187-189 CURBS 3-10-65
- 190-192 CURBS 3-10-65
- 193-195 CURBS 3-10-65
- 196-198 CURBS 3-10-65
- 199-201 CURBS 3-10-65
- 202-204 CURBS 3-10-65
- 205-207 CURBS 3-10-65
- 208-210 CURBS 3-10-65
- 211-213 CURBS 3-10-65
- 214-216 CURBS 3-10-65
- 217-219 CURBS 3-10-65
- 220-222 CURBS 3-10-65
- 223-225 CURBS 3-10-65
- 226-228 CURBS 3-10-65
- 229-231 CURBS 3-10-65
- 232-234 CURBS 3-10-65
- 235-237 CURBS 3-10-65
- 238-240 CURBS 3-10-65
- 241-243 CURBS 3-10-65
- 244-246 CURBS 3-10-65
- 247-249 CURBS 3-10-65
- 250-252 CURBS 3-10-65
- 253-255 CURBS 3-10-65
- 256-258 CURBS 3-10-65
- 259-261 CURBS 3-10-65
- 262-264 CURBS 3-10-65
- 265-267 CURBS 3-10-65
- 268-270 CURBS 3-10-65
- 271-273 CURBS 3-10-65
- 274-276 CURBS 3-10-65
- 277-279 CURBS 3-10-65
- 280-282 CURBS 3-10-65
- 283-285 CURBS 3-10-65
- 286-288 CURBS 3-10-65
- 289-291 CURBS 3-10-65
- 292-294 CURBS 3-10-65
- 295-297 CURBS 3-10-65
- 298-300 CURBS 3-10-65

STATE OF VERMONT
DEPARTMENT OF HIGHWAYS
PROPOSED IMPROVEMENT

FEDERAL PROJECTS

TOWN OF HARTFORD
COUNTY OF WINDSOR

VERMONT ROUTE 14
LEBANON, N.H. - BARRE, VT. ROAD
PROJECT F037-1(3)
BEGINNING AT A POINT 0.452 MILE WESTERLY OF THE
HARTFORD, VT. - LEBANON, N.H. TOWN LINE AND EXTEND-
ING EASTERLY 0.189 MILE.
LENGTH OF PROJECT 1,000 FT. = 0.189 MILE

U.S. ROUTE 5
HARTFORD-NORWICH ROAD
PROJECT F041-3(1)
BEGINNING AT A POINT 3.513 MILES SOUTH OF THE
HARTFORD-NORWICH TOWN LINE AND EXTENDING
NORTHERLY 0.215 MILE.
LENGTH OF PROJECT 1,133.60 FT. = 0.215 MILE

U.S. ROUTE 4
BARRE, VT. - LEBANON, N.H. ROAD
PROJECT F020-3(1)
BEGINNING AT A POINT 0.206 MILE WESTERLY OF THE
HARTFORD, VT. - LEBANON, N.H. TOWN LINE AND EXTEND-
ING EASTERLY 0.141 MILE.
LENGTH OF PROJECT 743.00 FT. = 0.141 MILE

ADT 1967	3200
ADT 1986	4480
DHV 1986	-630
D	58%
T	7%
V	40 M.P.H.

ADT 1967	5000
ADT 1986	8660
DHV 1986	1190
D	60%
T	6%
V	40 M.P.H.

ADT 1967	6000
ADT 1986	8660
DHV 1986	1200
D	53%
T	6%
V	40 M.P.H.

TOTAL LENGTH OF CONTRACT 2,876.60 FT. = 0.545 MI.

PROJECT NAME & NUMBER TYPE
HARTFORD F020-3(1), R.O.W. DEMOLITION &
F041-3(1) & F037-1(3) REM. OF BLDGS.

RECORD PLANS
CONTRACTOR - ROBERT DAVIS - WOLCOTT, VT.
RESIDENT ENGINEER - RICHARD HAUGER
RECORD PLANS - A.G. SPIDLE
CONTRACT
DATED - OCTOBER 20, 1967
STARTED - OCTOBER 15, 1967
COMPLETED - DEC. 0, 1967
ACCEPTED - DEC. 13, 1967

- CONVENTIONAL SIGNS
- R.O.W.
- COUNTY LINE
- TOWN LINE
- FENCE LINE
- STONE WALL
- UNFENCED PROPERTY
- RAILROAD
- RETAINING WALL
- CENTRE LINE
- SURVEY
- CULVERT
- DROP INLET
- TROLLEY POLE
- POWER POLE
- TELEPHONE POLE
- WATER
- SEA CONSTRUCTION IDENTIFICATION SIGN

- LIMITED ACCESS
- SLOPE RIGHTS
- GROUND ELEVATION
- GRADE ELEVATION
- CURVE DATA
- DEFLECTION OF ANGLE
- DEGREE OF CURVE
- RADIUS OF CURVE
- TANGENT DISTANCE
- LENGTH OF CURVE
- EXTERNAL DISTANCE
- POINT OF INTERSECTION
- POINT OF CURVE
- POINT OF TANGENT
- POINT ON TANGENT
- POINT ON SUB-TANGENT

SCALE IN FEET
0 100 200 300 400 500

APPROVED [Signature] DATE 11/2/66
APPROVED [Signature] DATE 11/2/66
APPROVED [Signature] DATE 11/2/66
APPROVED [Signature] DATE 11/2/66
APPROVED [Signature] DATE 11/2/66
APPROVED [Signature] DATE 11/2/66

THESE PLANS ARE SUBJECT TO SUCH REVISIONS AS MAY BE
REQUIRED BY THE BUREAU OF PUBLIC ROADS OR THE COMMISSIONER
OF HIGHWAYS.
CONSTRUCTION IS TO BE CARRIED ON IN ACCORDANCE WITH
THESE PLANS AND THE STANDARD SPECIFICATIONS FOR HIGHWAY AND BRIDGE
CONSTRUCTION DATED APRIL, 1964, AS APPROVED BY THE BUREAU OF
PUBLIC ROADS ON OCTOBER 17, 1964, INCLUDING ALL SUBSEQUENT
APPROVED REVISIONS AND SUCH REVISED SPECIFICATIONS AND SPECIAL
PROVISIONS AS ARE INCORPORATED IN THESE PLANS.

DEPARTMENT OF TRANSPORTATION BUREAU OF PUBLIC ROADS	
PROJECT	F 037-1(3)
	F 041-3(1)
	F 020-3(1)
SHEET	1

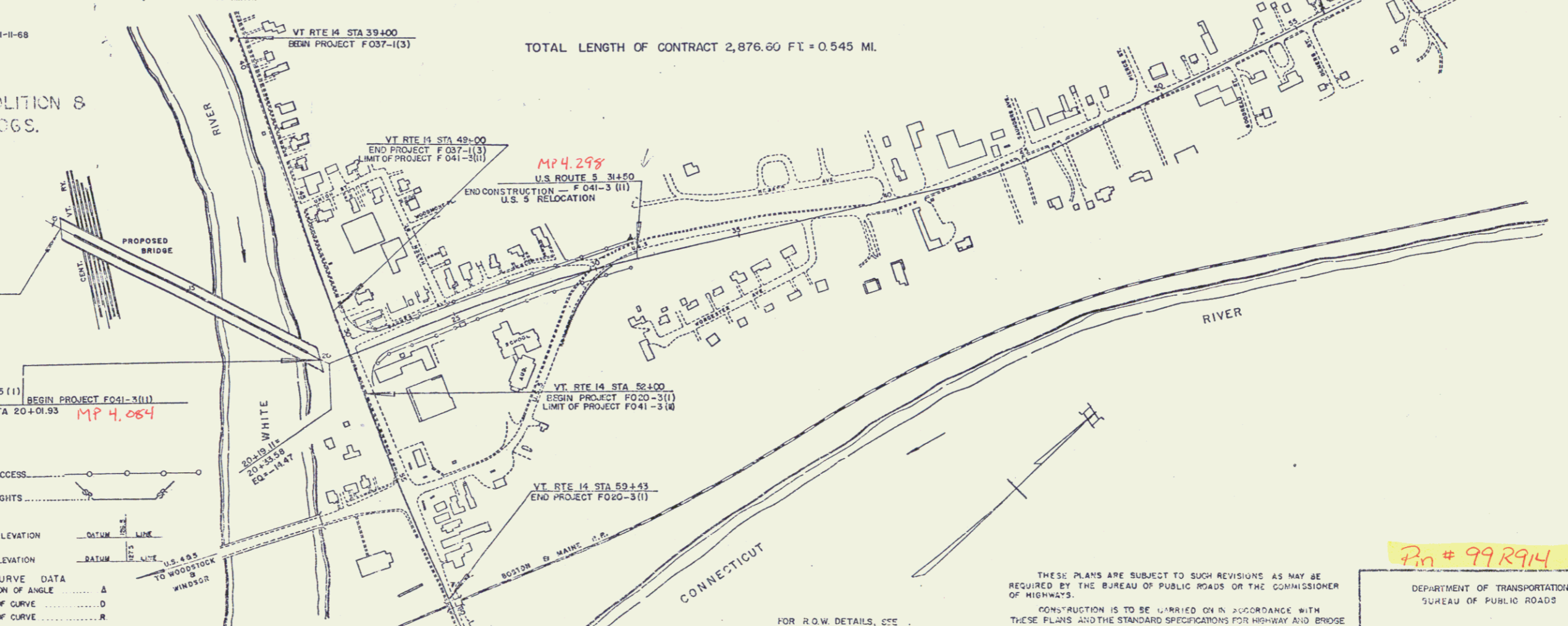
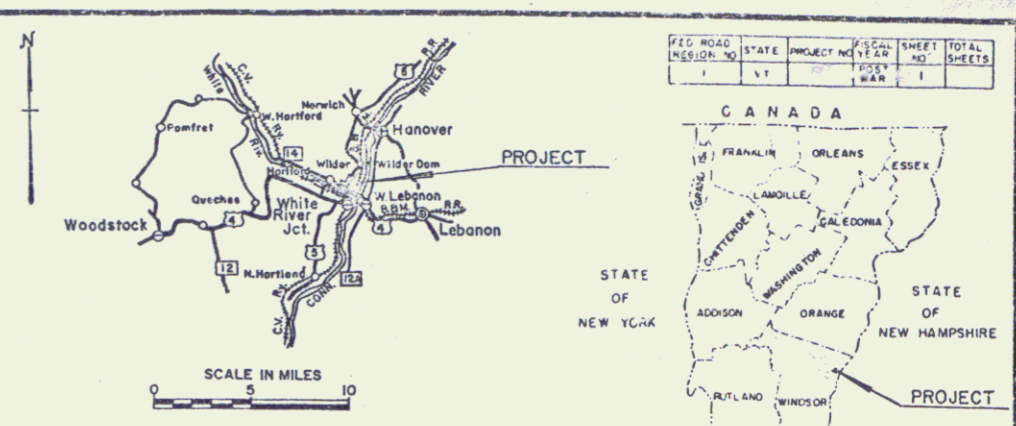

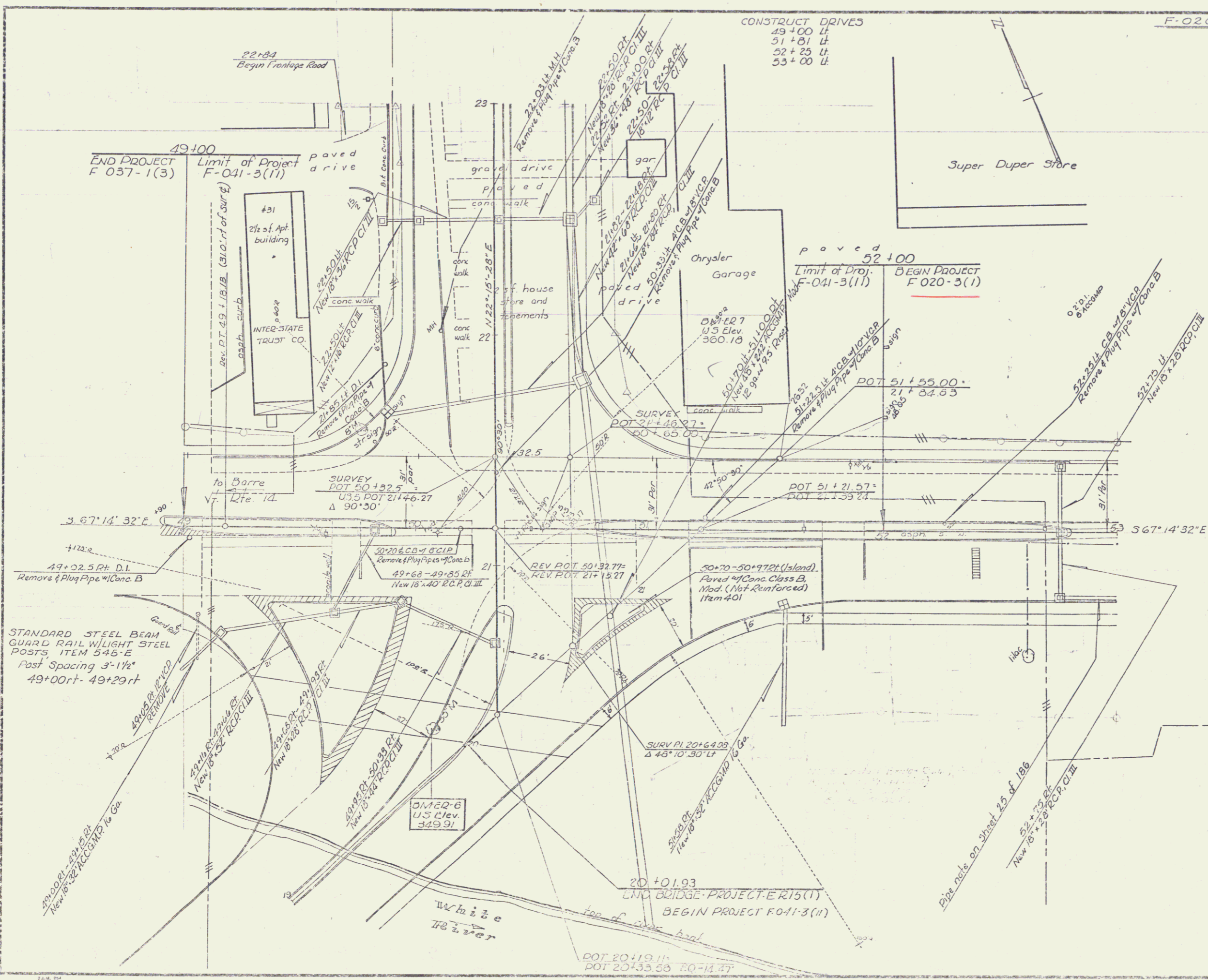

CONSTRUCT DRIVES
 49+00 Lt
 51+81 Lt
 52+25 Lt
 53+00 Lt

F-020-3(1) VERTICAL GRANITE CURB, ITEM 556-B
 52+00 - 53+00 Lt
 52+06 - 52+13 Lt
 52+42 - 52+80 Lt
 52+00 - 52+80 Island
 5" CEMENT CONC. SIDEWALK, ITEM 560
 52+00 - 53+00 Lt
 52+00 - 52+05 Lt
 52+42 - 52+80 Lt
 8" CEMENT CONC. SIDEWALK, ITEM 560
 52+05 - 52+42 Lt
 52+80 - 53+00 Lt
 BITUMINOUS CONC. CURB ITEM 555
 22+50 - 23+00 Rt (Frontage Rd)

F-041-3(11)
 VERTICAL GRANITE CURB, ITEM 556-B
 49+12 Lt (M/L) - 23+00 Lt (Barnes Ave)
 23+00 Rt (Barnes Ave) - 51+60 Lt (M/L)
 51+97 Lt - 52+00 Lt
 49+00 Lt - 49+36 Rt
 49+00 Lt - 49+92 Lt (Island)
 50+77 Lt - 52+00 Lt (Island)
 49+38 Rt - 49+92 Lt (Island)
 50+07 Lt - 50+42 Lt (Island)
 50+70 Lt - 50+97 Lt (Island)
 50+58 Lt - 52+00 Lt
 5" CEMENT CONC. SIDEWALK, ITEM 560
 49+12 Lt (M/L) - 23+00 Lt (Barnes Ave)
 23+00 Rt (Barnes Ave) - 51+60 Lt (M/L)
 51+97 Lt - 52+00 Lt
 50+58 Lt - 52+00 Lt
 8" CEMENT CONC. SIDEWALK, ITEM 560
 49+00 Lt - 49+12 Lt
 51+60 Lt - 51+97 Lt

INSTALL BRIDGE RAILING FOR BRIDGE APPROACHES WITH SPINDLES, MOD, ITEM 512
 50+30 rt - 51+36 rt
 For details of concrete bases, Item 401-B and 402, refer to sheets 36 and 37 of 186

Note: 49+38rt-49+92rt - Island
 50+07rt-50+42rt - Island
 Rein. Conc. Paving, Item 401-B and 402.
 For details refer to sheet 36 of 186
 STONE FILL FOR SLOPE PROTECTION (HEAVY TYPE), ITEM 511
 50+90 - 51+10 Rt

STANDARD STEEL BEAM GUARD RAIL WITH LIGHT STEEL POSTS, ITEM 545-E
 Post Spacing 3'-1 1/2"
 49+00rt - 49+29rt

HARTFORD

SURVEYED BY: Jewett DATE: 2-1-50
 DRAWN BY: Kovic DATE: 1-1-50
 TRACED BY: PLW DATE: 1-1-50

PROJ. F NO. 041-3(11)
 SHEET 27 of 186

VT. Dep. of Transp. & Cons. U.S. Dept. of Transp.

10a 2

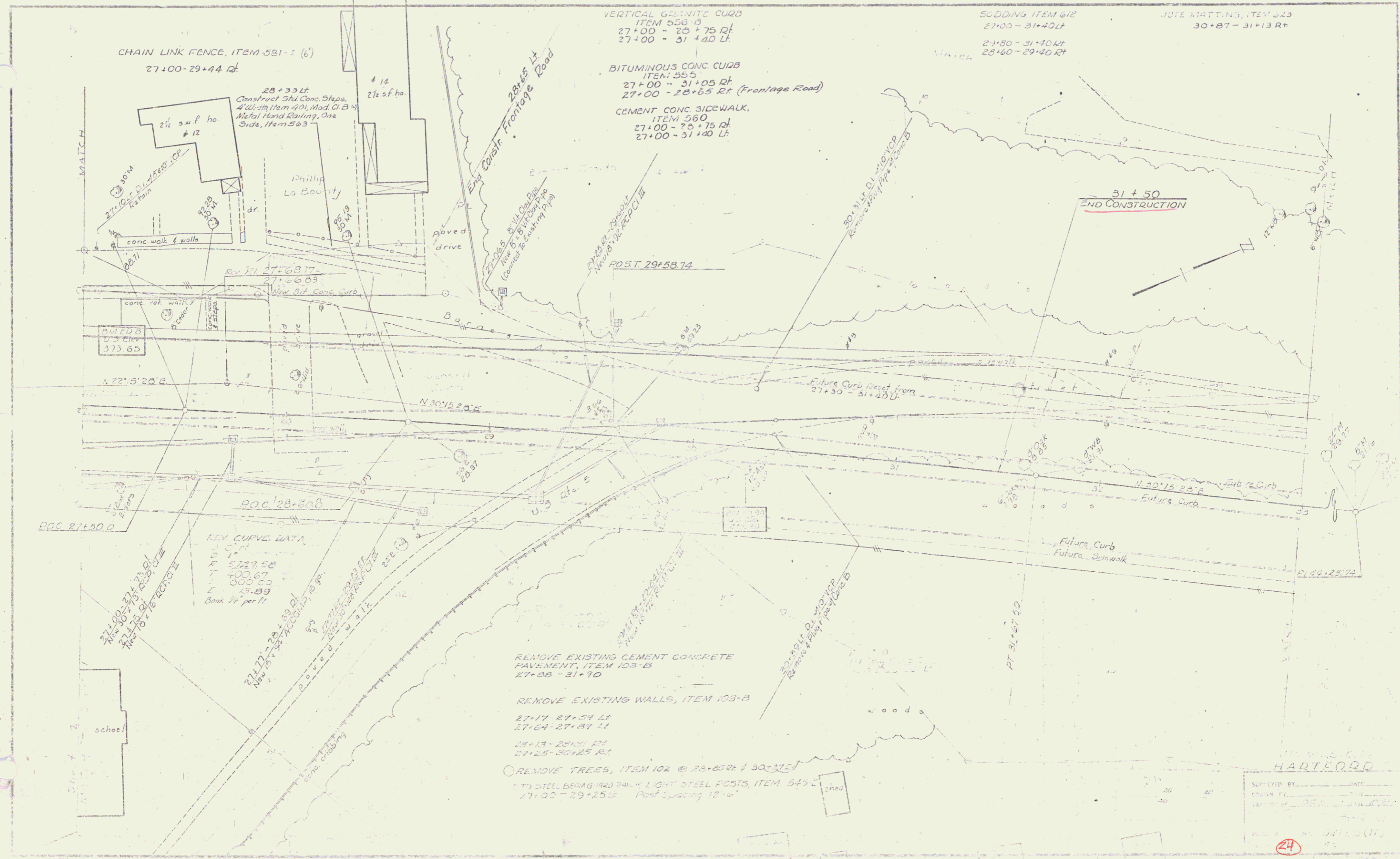

CHAIN LINK FENCE, ITEM 581-1 (6')
27+00-29+44 Lt

VERTICAL GRANITE CURB
ITEM 558-B
27+00 - 28+75 Rt
27+00 - 31+40 Lt

SODDING, ITEM 612
27+00 - 31+40 Lt
27+80 - 31+40 Rt
28+60 - 29+40 Rt

JUTE MATTING, ITEM 529
30+87 - 31+13 Rt

BITUMINOUS CONC. CURB
ITEM 555
27+00 - 31+05 Rt
27+00 - 28+65 Rt (Frontage Road)

CEMENT CONC. SIDEWALK,
ITEM 560
27+00 - 31+75 Rt
27+00 - 31+40 Lt

28+33 Lt
Construct 3rd Conc. Steps,
4' x 2' x 1/2" Item 401, 1/2" dia. C.B.
Metal Hand Railing, One
Side, Item 563

REV. CURVE DATA
D = 127.00
R = 5229.58
T = 400.67
L = 300.00
E = 13.89
Bank 1/4 per ft.

REMOVE EXISTING CEMENT CONCRETE
PAVEMENT, ITEM 103-B
27+36 - 31+90

REMOVE EXISTING WALLS, ITEM 103-B
27+17 - 27+59 Lt
27+64 - 27+84 Lt
28+13 - 28+21 Rt
27+25 - 30+25 Rt

REMOVE TREES, ITEM 102 @ 28+83Rt & 30+37L
STD STEEL BEAM 14x20 24" x 4" LIGHT STEEL POSTS, ITEM 545 L
27+00 - 29+25 Lt Post spacing 12'-6"

HARTFORD
DRAWN BY: _____ DATE: _____
CHECKED BY: _____ DATE: _____
PROJECT NO. 10415 (11)
24

16a 4