

INDEX OF SHEETS

SHEET NO.	TITLE PAGE
1	TITLE PAGE
2	TYPICAL CROSS-SECTION OF IMPROVEMENT
3	BANKING AND WIDENING TABLES
4	PLAN AND PROFILE
11	STANDARD STRUCTURE SHEET S 28 PIPE CULVERTS
12	" " " " S 30 GUARD RAIL
13	" " " " S 30A BOUNDARY MARKERS
14	" " " " S 40 BARRICADES SIGNS & LIGHTS
15	" " " " S 41 TYPICAL GRADING
16	1641 CROSS SECTIONS

DOUBLE TRACK COAT OF REFINED TAR WITH PEA STONE SEAL, ITEM 29A

STANDARD STRUCTURE SHEETS APPROVED BY THE CHIEF ENGINEER VT STATE DEPT OF HIGHWAYS

S 28 APRIL 26, 1941
 S 30 MAY 12, 1941
 S 30A APRIL 19, 1941
 S 40 DECEMBER 18, 1945

(To Be Returned To R.O.W. Division)

Town of Northfield
 Right-of-Way Division
 PERPETUAL

STATE OF VERMONT
 STATE HIGHWAY DEPARTMENT

PLAN AND PROFILE OF PROPOSED
 STATE HIGHWAY

SECONDARY PROJECT

TOWN OF NORTHFIELD
 NORTHFIELD-ROXBURY ROAD
 VERMONT ROUTE 12A

BEGINNING AT A POINT APPROXIMATELY 8600 FEET SOUTHERLY FROM THE INTERSECTION OF VERMONT ROUTES 12 AND 12A IN NORTHFIELD CENTER AND EXTENDING 8396.8 FEET SOUTHWESTERLY EXCLUDING BRIDGE

LENGTH OF PROJECT 8396.8 LIN. FT. = 1.590 MILES

FED. ROAD DIST. NO.	STATE	DESIGN PROJ. NO.	FISCAL YEAR	SHEET NO.	TOTAL SHEETS
9	Vt.	S 145(3)	1946	1	47

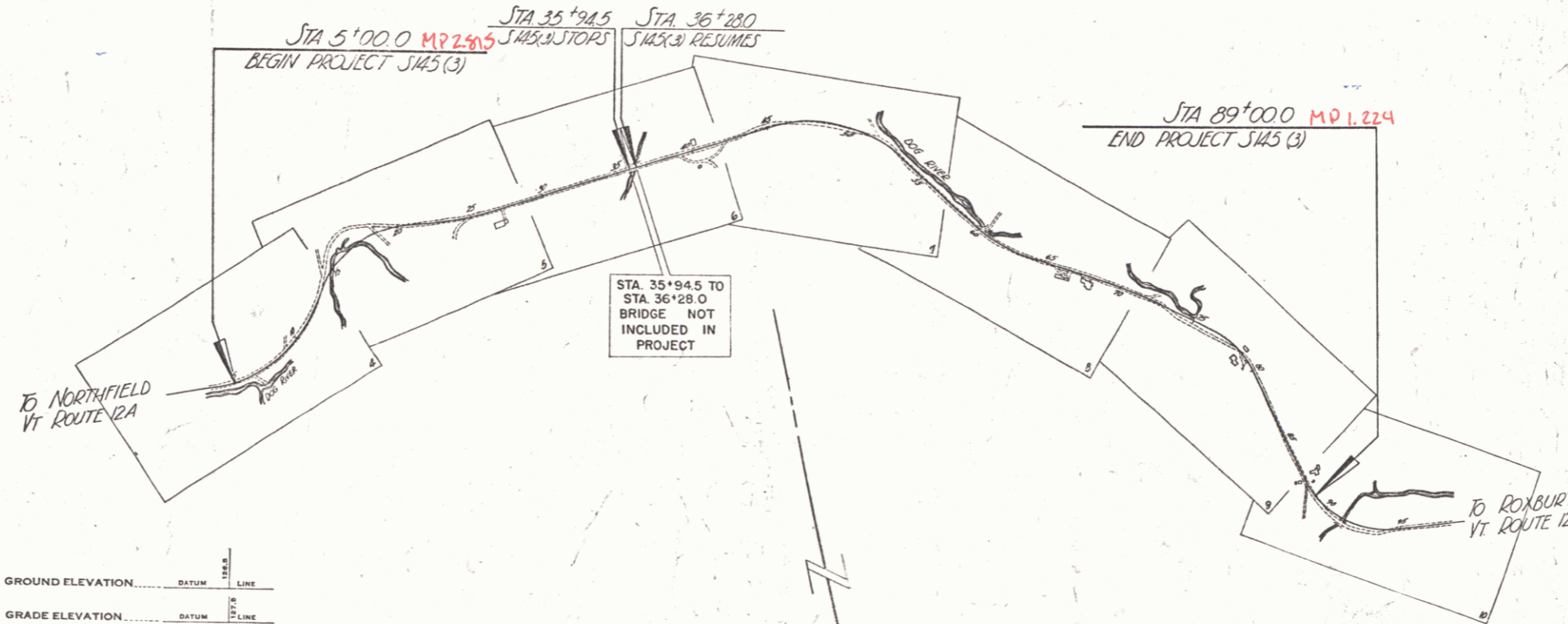

GROUND ELEVATION DATUM LINE
 GRADE ELEVATION DATUM LINE

CURVE DATA

DEFLECTION ANGLE	Δ
DEGREE OF CURVE	D
RADIUS OF CURVE	R
TANGENT DISTANCE	T
LENGTH OF CURVE	L
EXTERNAL DISTANCE	E
POINT OF INTERSECTION	P. I.
POINT OF CURVE	P. C.
POINT OF TANGENT	P. T.
POINT ON TANGENT	P. O. T.

SCALES

TITLE	1" = 500'
TYPICAL	1" = 2'
PLAN	1" = 50'
PROFILE	HORIZONTAL 1" = 50'
	VERTICAL 1" = 10'
CROSS SECTIONS	1" = 5'

CONTRACTOR: Matthew Westbrook
 DESIGNER: [Signature]
 CHECKED: [Signature]
 DRAWN: [Signature]
 DATE: [Signature]

APPROVED: Feb 12, 1947

[Signature]

COMMISSIONER OF HIGHWAYS

SUBMITTED BY ORDER OF THE STATE HIGHWAY BOARD

Pin # 998906

RECOMMENDED FOR APPROVAL
 DISTRICT ENGINEER
 PUBLIC ROADS ADMINISTRATION
 FEDERAL WORKS AGENCY

APPROVED
 DISTRICT ENGINEER
 PUBLIC ROADS ADMINISTRATION
 FEDERAL WORKS AGENCY

THESE PLANS ARE SUBJECT TO SUCH REVISIONS AS MAY BE REQUIRED BY THE PUBLIC ROADS ADMINISTRATION OR THE COMMISSIONER OF HIGHWAYS.
 CONSTRUCTION IS TO BE CARRIED ON IN ACCORDANCE WITH THE PLANS AND THE STANDARD ROAD AND BRIDGE SPECIFICATIONS OF 1936 AS APPROVED DECEMBER 29TH, 1936 BY THE PUBLIC ROADS ADMINISTRATION, INCLUDING ALL SUBSEQUENT APPROVED REVISIONS AND SUCH REVISED SPECIFICATIONS AND SPECIAL PROVISIONS AS ARE SUBMITTED WITH THE PLANS.

APPROVED: Jan 21, 1947
 [Signature]
 DISTRICT ENGINEER

APPROVED: Feb 12, 1947
 [Signature]
 DISTRICT HIGHWAY COMMISSIONER

SERIES S No. 145(3) FILED
 SHEET 1 OF 47