

INDEX OF SHEETS

SHEET NO.	1	TITLE PAGE
"	2	PLAN & PROFILE OF IMPROVEMENT
"	3	PLAN-CIRCUITS FOR AUTO-HIGHWAY CROSSING PROTECTION (E 5883)
"	4	AUTOMATIC HIGHWAY SIGNAL

FED. ROAD DIST. NO.	STATE	W.P.G.S. PROJ. NO.	FISCAL YEAR	SHEET NO.	TOTAL SHEETS
9	VT.	145-A	1936	1	4

STATE OF VERMONT  
STATE HIGHWAY DEPARTMENT

PLAN AND PROFILE OF PROPOSED  
STATE HIGHWAY  
U.S. WORKS PROGRAM GRADE CROSSING PROJECT

Pin# 99R964

TOWN OF ROXBURY

AUTOMATIC FLASH SIGNALS AT CROSSING OF  
CENTRAL VERMONT RAILWAY AND ROUTE <sup>VT</sup> 12A  
APPROXIMATELY 1.0 MILE NORTH OF ROXBURY  
RAILWAY STATION.

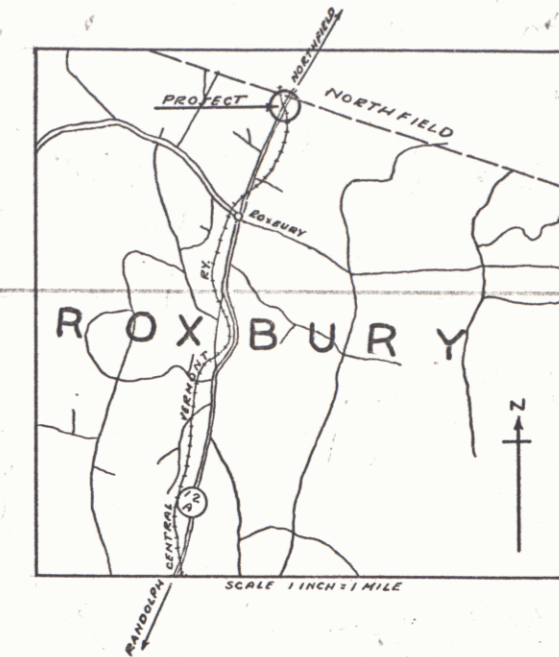

APPROVED: *N.D. Garvin*  
Chief Engineer  
CENTRAL VERMONT RAILWAY

LENGTH OF PROJECT 95.0 FEET = 0.017 MILES

MP 0.686-0.704

APPROVED: *December 31 1936*  
*H. Wagner*  
COMMISSIONER OF HIGHWAYS  
SUBMITTED BY ORDER OF THE STATE HIGHWAY BOARD

THESE PLANS ARE SUBJECT TO SUCH REVISIONS AS MAY BE REQUIRED BY THE BUREAU OF PUBLIC ROADS AND COMMISSIONER OF HIGHWAYS. CONSTRUCTION IS TO BE CARRIED ON IN ACCORDANCE WITH THE PLANS AND SPECIFICATIONS OF THE ASSOCIATION OF AMERICAN RAILROADS WHICH APPLY TO THIS WORK.

Project No. WPGS 145-A

CONVENTIONAL SIGNS

COUNTY LINE	GROUND ELEVATION..... DATUM	LINE
TOWN LINE	GRADE ELEVATION..... DATUM	LINE
FENCE LINE		
STONE WALL		
UNFENCED PROPERTY		
GUARDRAIL		
TRAVELED WAY		
RAILROAD		
RETAINING WALL		
CENTER LINE		
SURVEY LINE		
CULVERT		
DROP LET		
TROLLEY POLE		
POWER POLE		
TELEPHONE POLE		
TREE		
WEDGE		

CURVE DATA

DEFLECTION ANGLE..... Δ
DEGREE OF CURVE..... D
RADIUS OF CURVE..... R
TANGENT DISTANCE..... T
LENGTH OF CURVE..... L
EXTERNAL DISTANCE..... E
POINT OF INTERSECTION..... P. I.
POINT OF CURVE..... P. C.
POINT OF TANGENT..... P. T.
POINT ON TANGENT..... P. O. T.

SCALES

PLAN	1" = 50 FEET
PROFILE	1" = 10 "

SHEET #3  
WIRING DIAGRAM & ETC  
PLAN NO. E 5883  
FILE WITH ROYALTON

RECOMMENDED \_\_\_\_\_  
DISTRICT ENGINEER BUREAU OF PUBLIC ROADS  
RECOMMENDED FOR APPROVAL \_\_\_\_\_  
CHIEF ENGINEER BUREAU OF PUBLIC ROADS  
APPROVED \_\_\_\_\_  
DIRECTOR - BUREAU OF PUBLIC ROADS

SERIES W.P.G.S. NO. 145-A FILED  
SHEET 1 OF 4

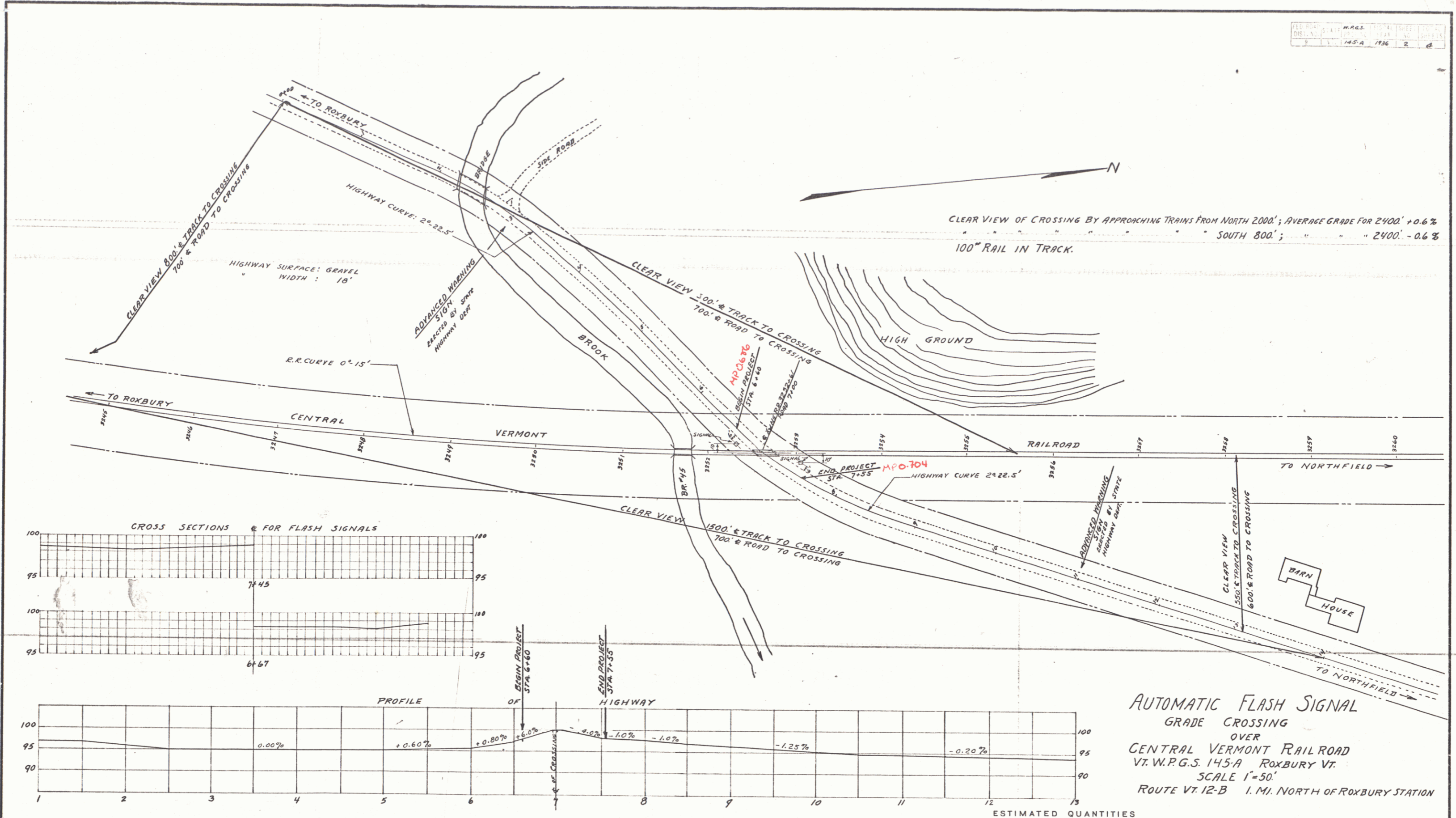

CLEAR VIEW OF CROSSING BY APPROACHING TRAINS FROM NORTH 2000'; AVERAGE GRADE FOR 2400' +0.6%  
 100' RAIL IN TRACK.  
 SOUTH 800'; " " 2400' -0.6%

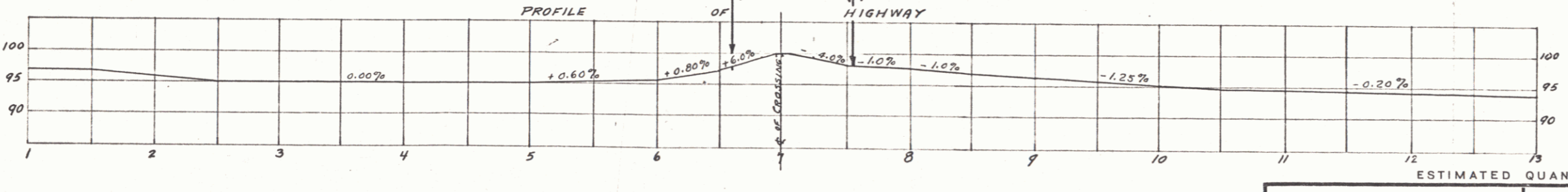
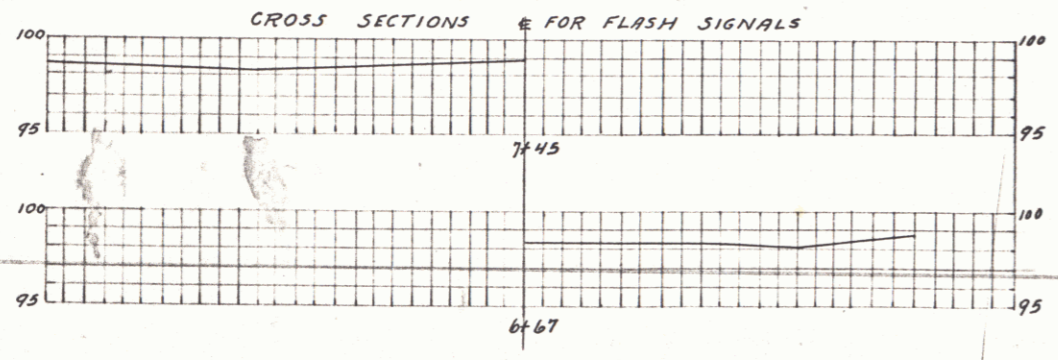

AUTOMATIC FLASH SIGNAL  
 GRADE CROSSING  
 OVER  
 CENTRAL VERMONT RAILROAD  
 VT. W.P.G.S. 145-A ROXBURY VT.  
 SCALE 1"=50'  
 ROUTE VT. 12-B 1 MI. NORTH OF ROXBURY STATION

REQUIRED: 2 SIGNALS WITH WIRING & WARNING SIGNALS	Surveyed by HOBSON Designed by Drawn by Traced by A.P.C. 3/18/36 Checked by Series W.P.G.S. No. 145-A Filed Sheet 2 of 4 Sheets
---	---