

Parcel no. 1
 Joseph L. Williams and David Williams
 Sta. 71+00Rt.-74+00Rt. (0.06A± Take)
 Sta. 72+00Rt.-72+50Rt. Channel Rights

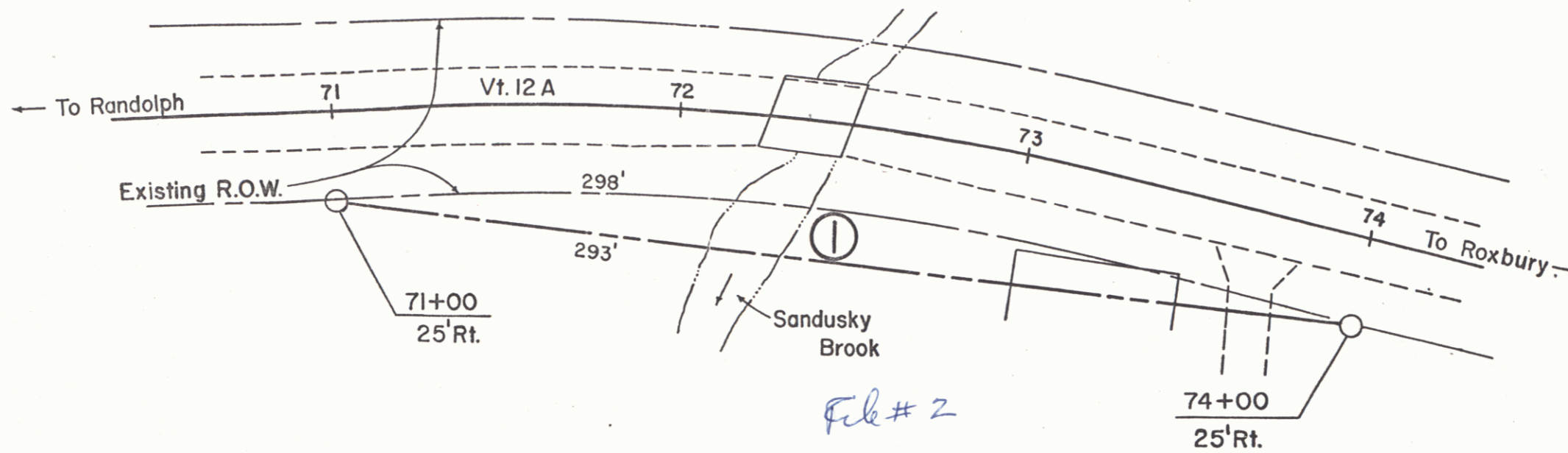

RIGHT-OF-WAY DIVISION
 TOWN FILE
 PERPETUAL
 Town of Vt. 12 A
 (To Be Returned To R.O.W. Division)

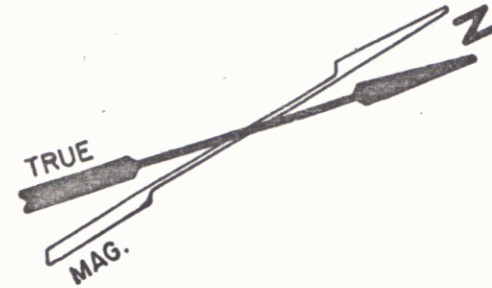
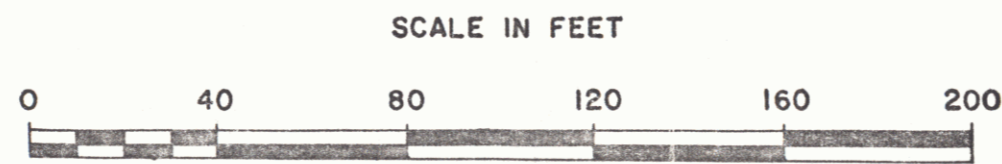

STATE OF VERMONT DEPT. OF HIGHWAYS		
Town of Granville		SHEET (1A)
PROJECT GRANVILLE	BMA 6312	2
APPROX. SCALE 1" = 40'	DATE 10-3-74	DRAWN BY RODS.