

TREES
 ○ = Remove, Item 109

Drives Constructed

STA	POS
9+75	RT
10+25	LT

FED. ROAD STATE: 9 FISCAL YEAR: 1999
 DIST. NO.: 1400 SHEET NO.: 4 OF 33

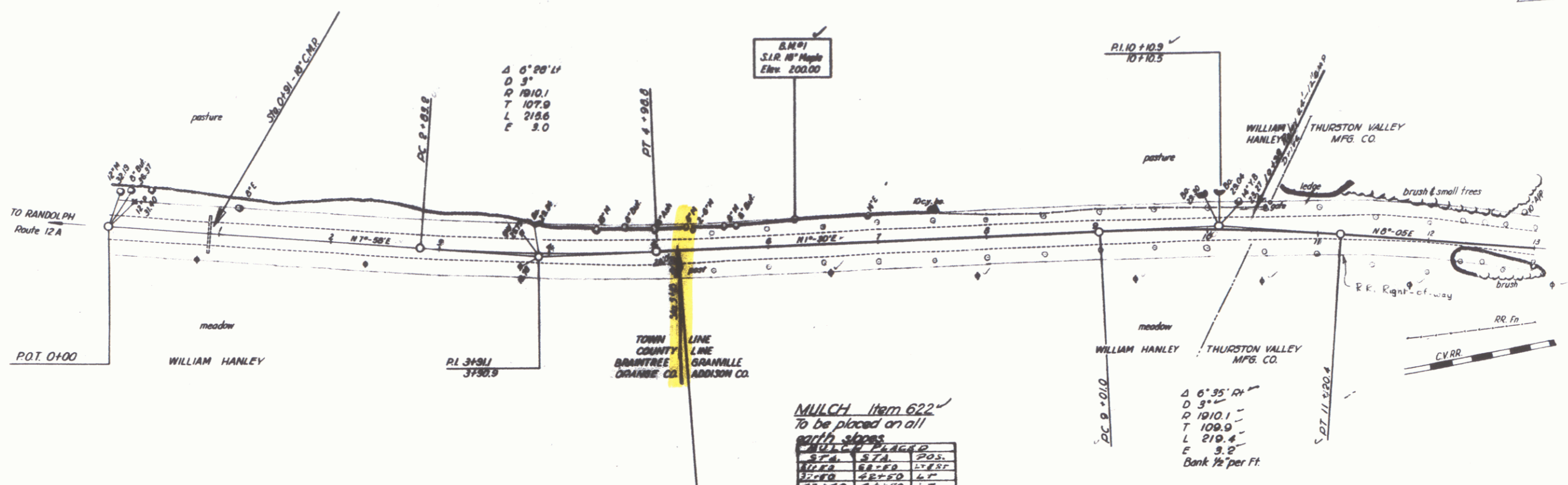

MULCH Item 622
 To be placed on all earth slopes

STA	STA	POS
9+75	9+75	RT
10+25	10+25	LT

Federal Aid Marker □
 Boundary Markers □

Vertical
 Alignment
 Heights

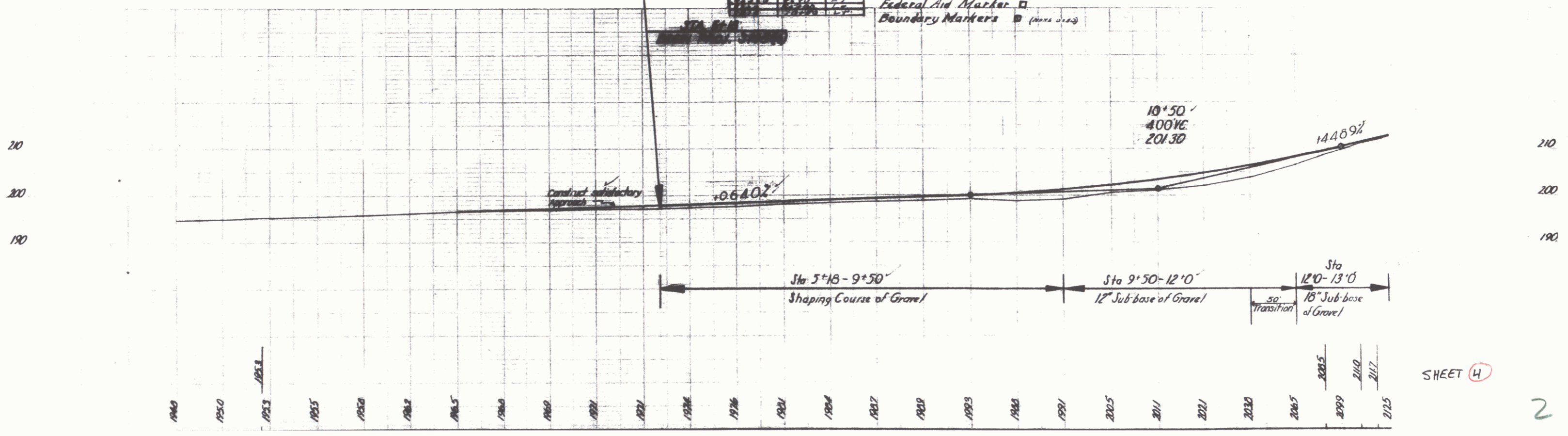

SHEET 4

2