

FED. ROAD DIST. NO.	STATE	FISCAL YEAR	SHEET NO.	TOTAL SHEETS
9	VT.	1928	6	27

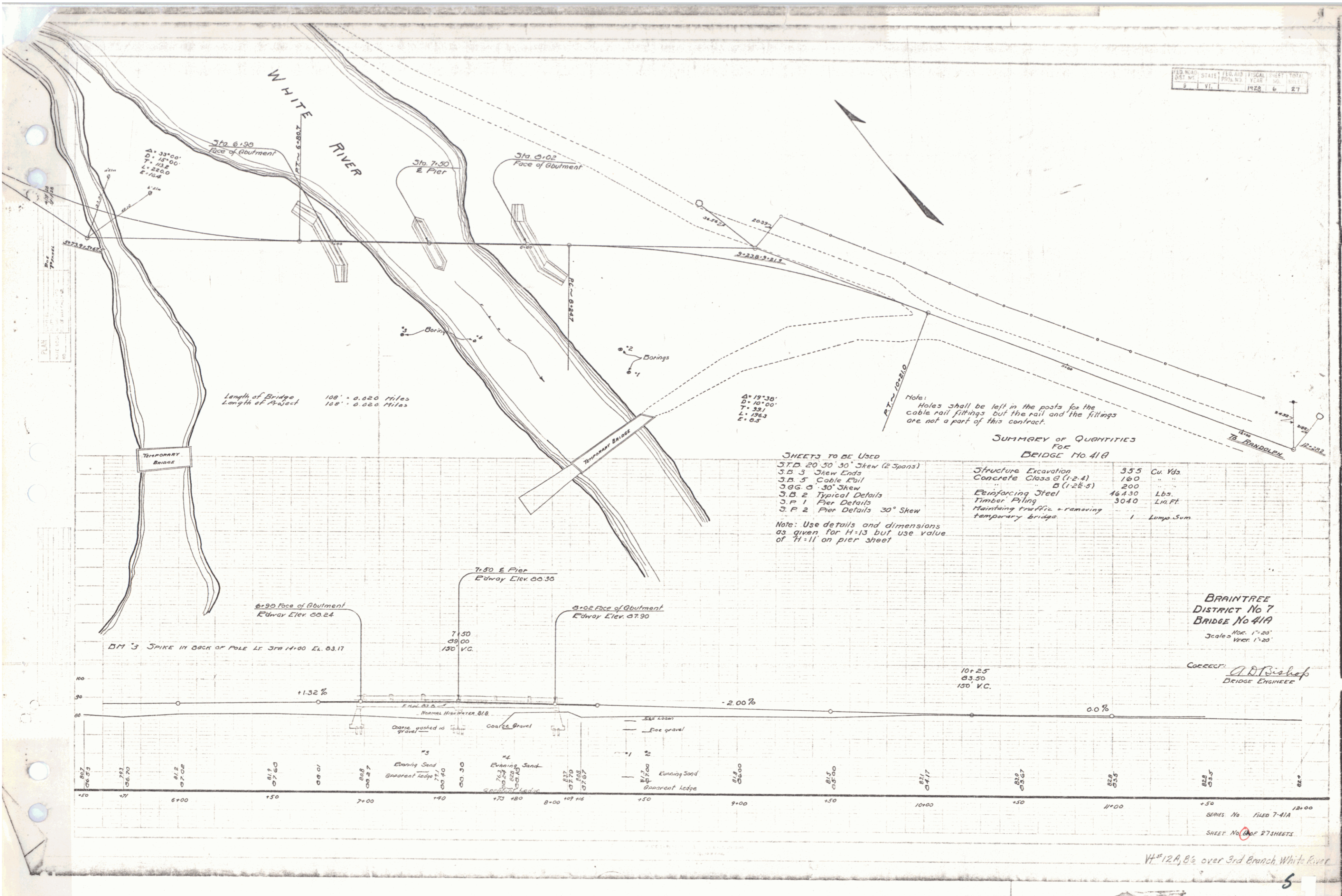

$\Delta = 33^{\circ}00'$   
 $D = 15.00'$   
 $T = 13.50'$   
 $L = 250.0'$   
 $E = 16.8'$

Length of Bridge 108' - 0.000 Miles  
 Length of Project 108' - 0.000 Miles

$\Delta = 19^{\circ}30'$   
 $D = 10^{\circ}00'$   
 $T = 32.1'$   
 $L = 192.3'$   
 $E = 6.5'$

Note:  
 Holes shall be left in the posts for the cable rail fittings but the rail and the fittings are not a part of this contract.

- SHEETS TO BE USED**
- S.T.D. 20 30' 30" Skew (2 Spans)
  - S.B. 3 Skew Ends
  - S.B. 5 Cable Rail
  - S.G. 3 30' Skew
  - S.B. 2 Typical Details
  - S.P. 1 Pier Details
  - S.P. 2 Pier Details 30' Skew

Note: Use details and dimensions as given for H-13 but use value of H-11 on pier sheet

**SUMMARY OF QUANTITIES FOR BRIDGE No. 41A**

Structure Excavation	355	Cu. Yds.
Concrete Class A (12-4)	180	"
" " B (12-5)	200	"
Reinforcing Steel	46.30	Lbs.
Timber Piling	30.40	Lin. Ft.
Maintaining traffic - removing temporary bridge	1	Lump Sum

BRAINTREE DISTRICT No. 7  
 BRIDGE No. 41A  
 Scale: Hor. 1" = 20'  
 Vert. 1" = 20'

CORRECTED: *A. D. Bishop*  
 BRIDGE ENGINEER

SERIES No. 1568 7-41A  
 SHEET No. 6 OF 27 SHEETS

VH 12A, B<sub>2</sub> over 3rd Branch White River