

Note: Clearing & Grubbing Item 13
This work to be paid for under the item
of Clearing & Grubbing, Item 13, and the
item shall apply to such locations as
ordered by the Engineer.
Horizontal measurements shall be used
in computing areas for payment of
Clearing & Grubbing, Item 13.

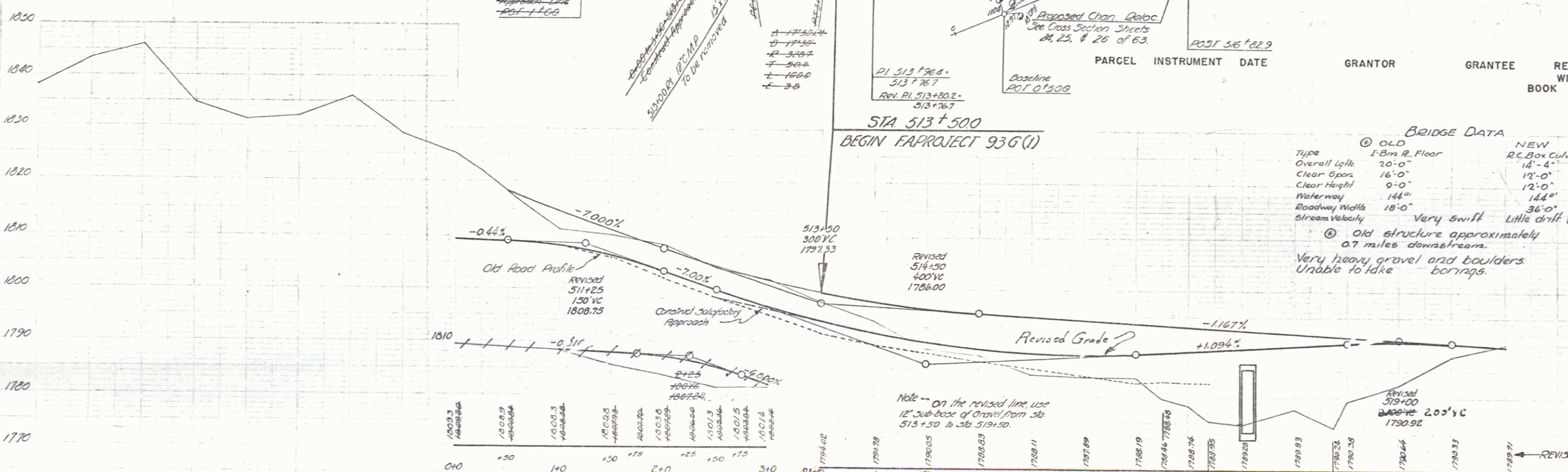
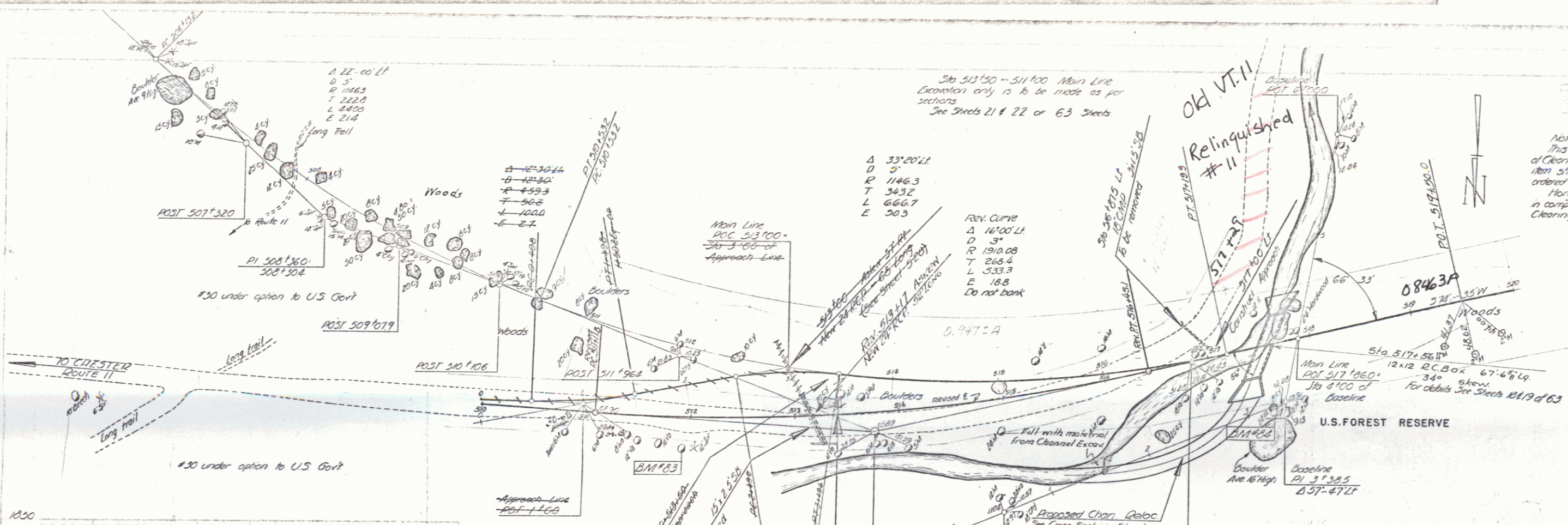

BRIDGE DATA

Type	OLD	NEW
Overall Lgth	14'-0"	14'-4"
Clear Span	16'-0"	12'-0"
Clear Height	9'-0"	12'-0"
Waterway	144"	144"
Roadway Width	18'-0"	36'-0"
Stream Velocity	Very swift	Little drift Very little scour

② Old structure approximately
0.7 miles downstream.
Very heavy gravel and boulders
Unable to take borings.

Approach-Line Profile & Grade

Station	Elevation	Grade
513+00	1797.33	-0.44%
513+50	1803.75	-7.00%
514+25	1808.75	-7.00%
519+00	1790.92	-1.167%

Note: On the revised line use
12' Sub-base of Gravel from Sta.
513+50 to Sta. 519+00.

Station	Elevation	Grade
513+00	1797.33	-0.44%
513+50	1803.75	-7.00%
514+25	1808.75	-7.00%
515+00	1808.75	-1.167%
516+00	1808.75	-1.167%
517+00	1808.75	-1.167%
518+00	1808.75	-1.167%
519+00	1790.92	-1.167%

WINHALL
JAMES FAR, No. 936(1)
JULY 1942 OF 63 SHEETS