

INDEX OF SHEETS

SHEET NO.	1.	Title Sheet
	2.	Typical Sections
	3.	Quantity Sheet (Earthworks, Drainage & Items)
	4.	Plan & Profile SA 20. W. 20.0.0.0
5-18.	Bridge Series 100	
19-21.	Cross Sections	
16.	Standard C-1	
17.	Standard D-4	
18.	Standard D-16	
19.	Standard G-3	
20.	Standard G-4	
21.	Standard SCB-06-65	
22.	Standard SB-21-56	

(To Be Returned to R.O.W. Division)
 Town of Winhall
 PERPETUAL
 TOWN FILE
 RIGHT-OF-WAY DIVISION

STATE OF VERMONT
 DEPARTMENT OF HIGHWAYS
 PROPOSED IMPROVEMENT

TOWN OF WINHALL
 COUNTY OF BENNINGTON
 VERMONT ROUTES 11 & 30
 MANCHESTER-LONDONDERRY ROAD

Pin # 992894

BEGINNING AT A POINT ON VERMONT ROUTE 11, APPROXIMATELY
 2.356 MILE EASTERLY OF THE INTERSECTION OF VERMONT ROUTES 11
 AND 30, AND EXTENDING SOUTHWESTERLY 0.085 MILES
 LENGTH OF PROJECT 450 FT = 0.085 MILES

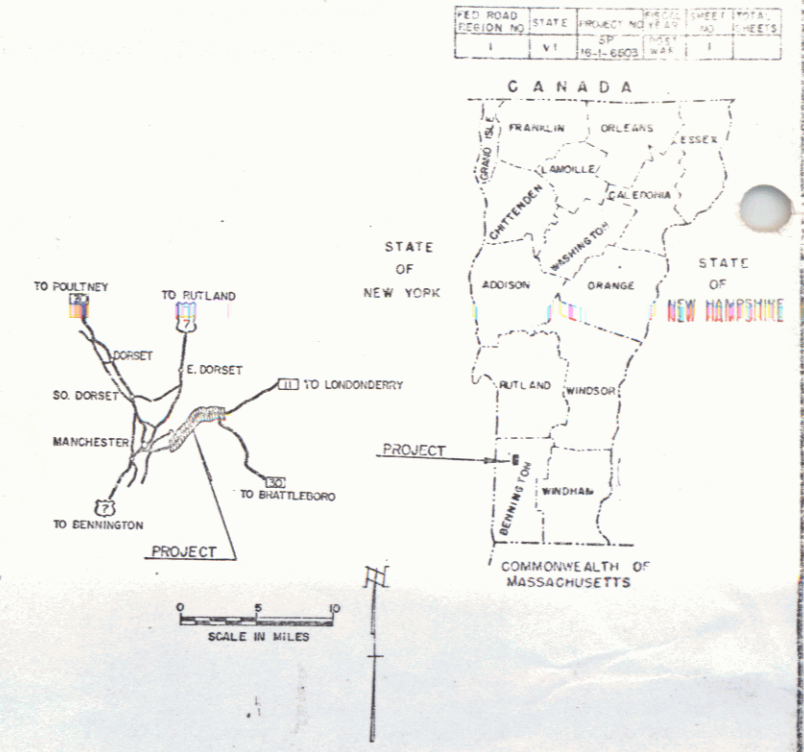

CONVENTIONAL SIGNS

COUNTY LINE	-----
TOWN LINE	-----
FENCE LINE	-----
STONE WALL	-----
UNFENCED PROPERTY	-----
GUARD RAIL	-----
TRAVELED WAY	-----
RAILROAD	-----
RETAINING WALL	-----
CENTER LINE	-----
SURVEY LINE	-----
CULVERT	-----
DROP INLET	-----
TROLLEY POLE	-----
POWER POLE	-----
TELEPHONE POLE	-----
TREES	-----
HEDGE	-----

CURVE DATA

DEFLECTION OF ANGLE Δ
DEGREE OF CURVE D
RADIUS OF CURVE R
TANGENT DISTANCE T
LENGTH OF CURVE L
EXTERNAL DISTANCE E
POINT OF INTERSECTION P.I.
POINT OF CURVE P.C.
POINT ON TANGENT P.T.
POINT ON SUB-TANGENT P.O.T.

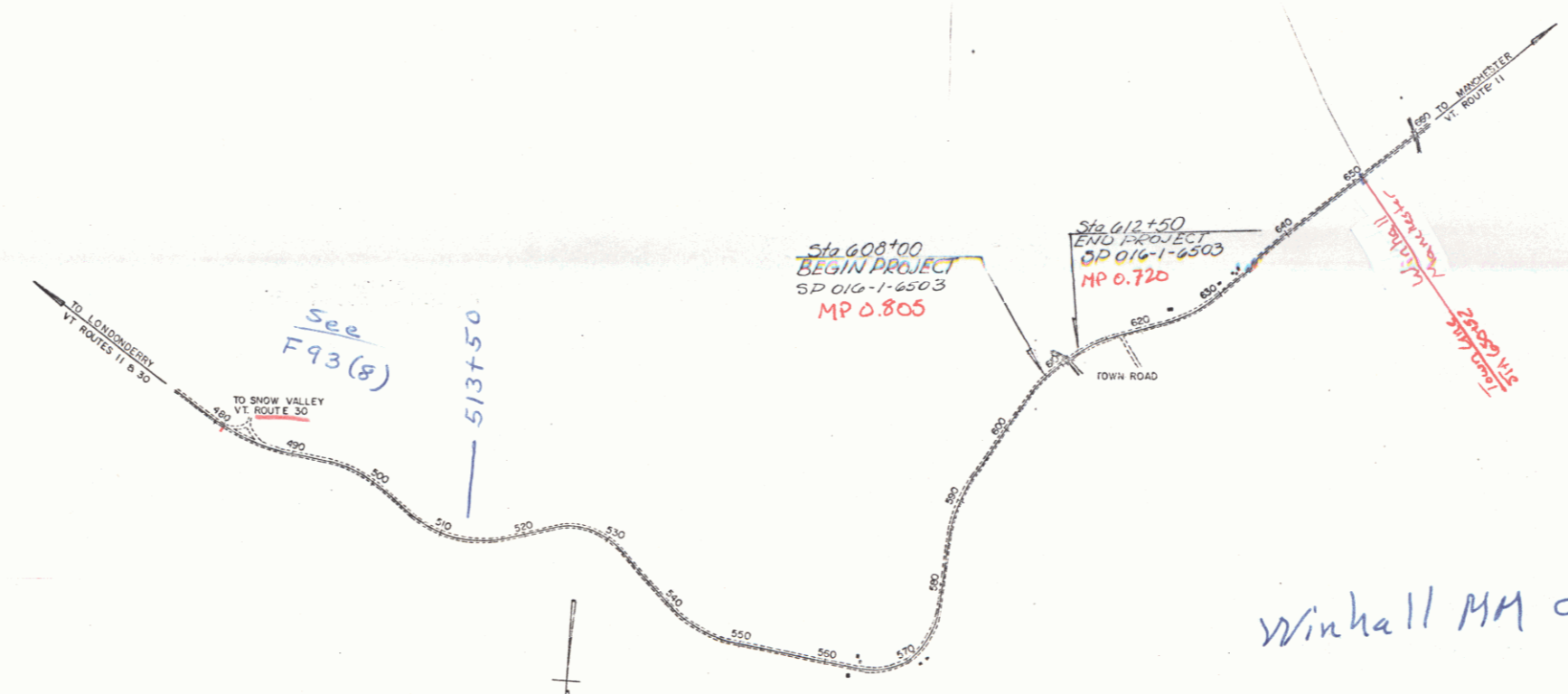

Winhall MA 0106~0313

THESE PLANS ARE SUBJECT TO SUCH REVISIONS AS MAY BE REQUIRED BY THE BUREAU OF PUBLIC ROADS OR THE COMMISSIONER OF HIGHWAYS.
 CONSTRUCTION IS TO BE CARRIED ON IN ACCORDANCE WITH THESE PLANS AND THE STANDARD SPECIFICATIONS FOR HIGHWAY AND BRIDGE CONSTRUCTION DATED APRIL, 1964, AS APPROVED BY THE BUREAU OF PUBLIC ROADS ON OCTOBER 12, 1964, INCLUDING ALL SUBSEQUENT APPROVED REVISIONS AND SUCH REVISED SPECIFICATIONS AND SPECIAL PROVISIONS AS ARE INCORPORATED IN THESE PLANS.

APPROVED <i>E.H. Stearns</i> ASST CHIEF ENGINEER DATE 8/2/66	APPROVED <i>R. L. ...</i> SUPERVISOR ENGINEER DATE 8/1/66	APPROVED <i>A. ...</i> TRIDGE ENGINEER DATE 8-11-66	APPROVED <i>...</i> DISTRICT ENGINEER DATE 8-1-66	APPROVED <i>G.M. ...</i> HIGHWAY ENGINEER DATE 8/1/66	APPROVED <i>...</i> CHIEF INSPECTOR DATE 8/2/66
--	---	---	---	---	---

DEPARTMENT OF COMMERCE
 BUREAU OF PUBLIC ROADS

APPROVED _____ DATE _____
 DIVISION ENGINEER

PROJECT 50 NO. 016-1-6503 S.P.
 SHEET 15 OF 22 SHEETS

STEARNS R. JENKINS = Bte 11