

INDEX OF SHEETS

SHEET NO. 1	TITLE PAGE
2	TYPICAL CROSS-SECTION OF IMPROVEMENT
3	PLAN AND PROFILE STA. 0+00 TO 1+50
4	S.T.B. 20-30' SPAN 30' SKEW WITH GRAVEL
5	S.B. 2 TYPICAL DETAILS
6	S.B. 3 SKEW ENDS
7	S.B. 4 SOLID RAIL AND CURB
8	S.A.G. 10' 30' SKEW
9	CROSS SECTIONS
10	S. 19 STANDARD STRUCTURES

FED. ROAD DIST. NO.	STATE	F.R.	FISCAL YEAR	SHEET NO.	TOTAL SHEETS
9	Vt.	10B	1929	1	10

STATE OF VERMONT
STATE HIGHWAY DEPARTMENT

PLAN AND PROFILE OF PROPOSED
STATE HIGHWAY

FEDERAL AID PROJECT

MANCHESTER

MANCHESTER-PERU ROAD

TOM SMITH BRIDGE

LOCATED .5 MILES WEST OF MANCHESTER-WINHALL LINE

LENGTH 150 FEET=0.028MILES

SCALES
Plan 1" = 10 Feet
Profile (Vert) 1" = 10 Feet
Profile (Horiz) 1" = 10 Feet
Sections 1" = 5 Feet

LAYOUT
See sheet 3

This Project to be constructed in Accordance with Standard Specifications on file with the U.S. Bureau of Public Roads. Approved 7/7/29

Structures on this Project to be constructed in Accordance with details given on Standard Structure sheets Series Nos. 317-18-19.



Pin # 99R891

MP 3.08
RIGHT-OF-WAY DIVISION
TOWN FILE
PERPETUAL
Town of UH
(To Be Returned To R.O.W. Division)

DISTRICT NO. 1
BRIDGE NO. 26
MANCHESTER

APPROVED: JULY 2, 1929
H. S. Sargent
CHIEF ENGINEER

SUBMITTED BY ORDER OF THE STATE HIGHWAY BOARD

S. B. Balch
COMMISSIONER OF HIGHWAYS

CONVENTIONAL SIGNS

- COUNTY LINE
- TOWN LINE
- FENCE LINE
- STONE WALL
- UNFENCED PROPERTY
- GUARD RAIL
- TRAVELED WAY
- RAILROAD
- RETAINING WALL
- CENTER LINE
- SURVEY LINE
- CULVERT
- DROP INLET
- TROLLEY POLE
- POWER POLE
- TELEPHONE POLE
- TREES
- HEDGE

- GROUND ELEVATION
- GRADE ELEVATION

- CURVE DATA
- DEFLECTION ANGLE
 - DEGREE OF CURVE
 - RADIUS OF CURVE
 - TANGENT DISTANCE
 - LENGTH OF CURVE
 - EXTERNAL DISTANCE
 - POINT OF INTERSECTION
 - POINT OF CURVE
 - POINT OF TANGENT
 - POINT ON TANGENT



Project No. FR 10B

RECOMMENDED
DISTRICT ENGINEER BUREAU OF PUBLIC ROADS
RECOMMENDED FOR APPROVAL
CHIEF ENGINEER BUREAU OF PUBLIC ROADS
APPROVED
DIRECTOR - BUREAU OF PUBLIC ROADS

SERIES F. R. No. 10B FILED
SHEET 1 OF 10

DIST # 1 PLANS

MANCHESTER
TOM SMITH BR

WOOD GUARD RAIL REQUIRED
 Left
 Sta 0+54 to Sta 0+70 = 16 Lin. Ft.
 Sta 1+00 to Sta 1+16 = 16 " "
 Right
 Sta 0+46 to Sta 0+70 = 24 Lin. Ft.
 Sta 1+00 to Sta 1+16 = 16 " "
 Total = 72 " "

GRAVEL SURFACE COURSE REQUIRED
 Estimated Quantity = 90 Cu. Yds.

DATE F.R. 1928 3 10
 SHEETS TO BE USED

Series STB-20 No. 30 Span 30' Skew with gravel
 Series SB No. 2 Typical Details
 Series SB No. 3 Skew Ends
 Series SB No. 4 Solid Rail
 Series SA 6 No. 10 Height Tee Beam 30' Skew
 Series S-19 Standard Structures

Camber shown in Camber Diagram on Sheet Series STB 20 No 30 is to be retained when full dead load is applied

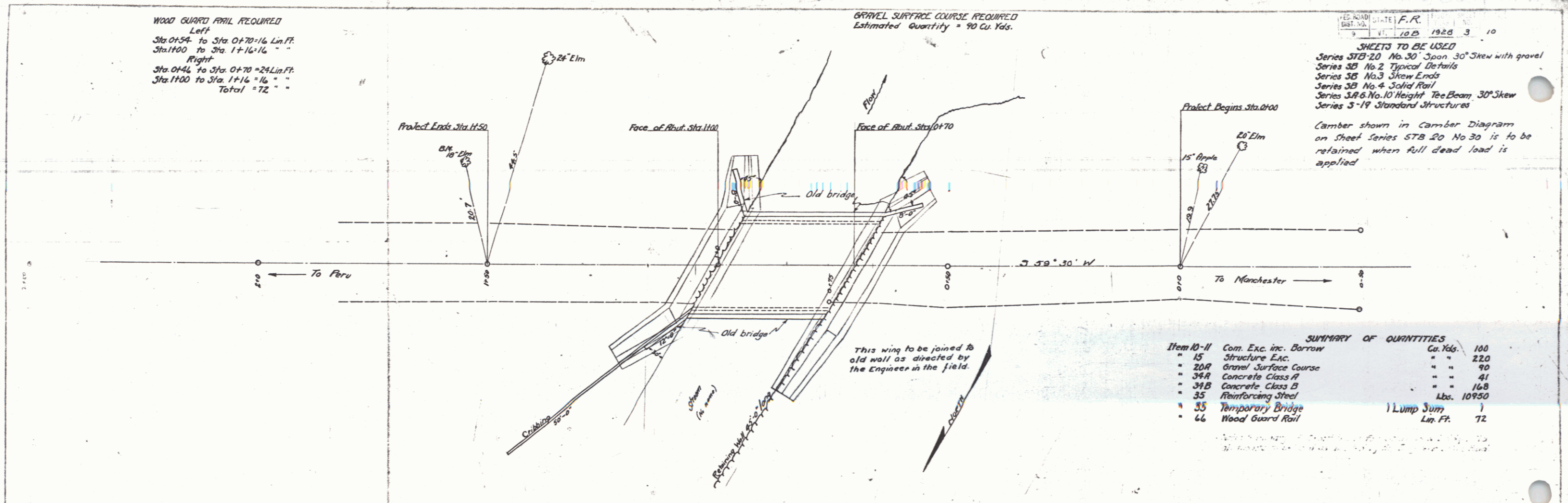

SUMMARY OF QUANTITIES

Item	Com. Exc. inc. Borrow	Structure Etc.	Cu. Yds.	100
15			160	
20A			220	
34A			90	
34B			41	
35			168	
35			10950	
35				1
66				72
Lump Sum				
				72

Length of Bridge = 33' = .006 miles
 Length of Approaches = 117' = .022 "
 Length of Project = 150' = .028 "

CONCERN *A. B. Bishop*
 BRIDGE ENGINEER

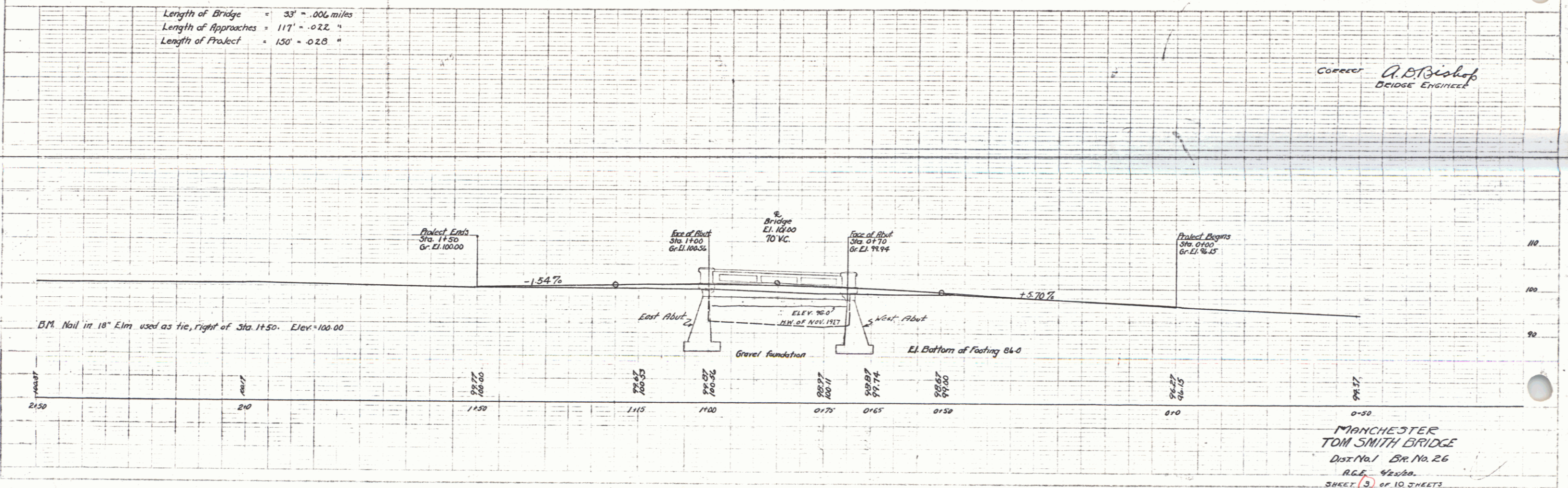

MANCHESTER
 TOM SMITH BRIDGE
 Dist. No. 1 Br. No. 26
 R.G.E. 4/22/28
 SHEET (3) OF 10 SHEETS