

WOOD GUARD RAIL REQUIRED  
 Left  
 Sta 0+54 to Sta 0+70 = 16 Lin. Ft.  
 Sta 1+00 to Sta 1+16 = 16 " "  
 Right  
 Sta 0+46 to Sta 0+70 = 24 Lin. Ft.  
 Sta 1+00 to Sta 1+16 = 16 " "  
 Total = 72 " "

GRAVEL SURFACE COURSE REQUIRED  
 Estimated Quantity = 90 Cu. Yds.

DATE F.R. 1928 3 10  
 SHEETS TO BE USED

Series STB-20 No. 30 Span 30' Skew with gravel  
 Series SB No. 2 Typical Details  
 Series SB No. 3 Skew Ends  
 Series SB No. 4 Solid Rail  
 Series SA 6 No. 10 Height Tee Beam 30' Skew  
 Series S-19 Standard Structures

Camber shown in Camber Diagram on Sheet Series STB 20 No 30 is to be retained when full dead load is applied

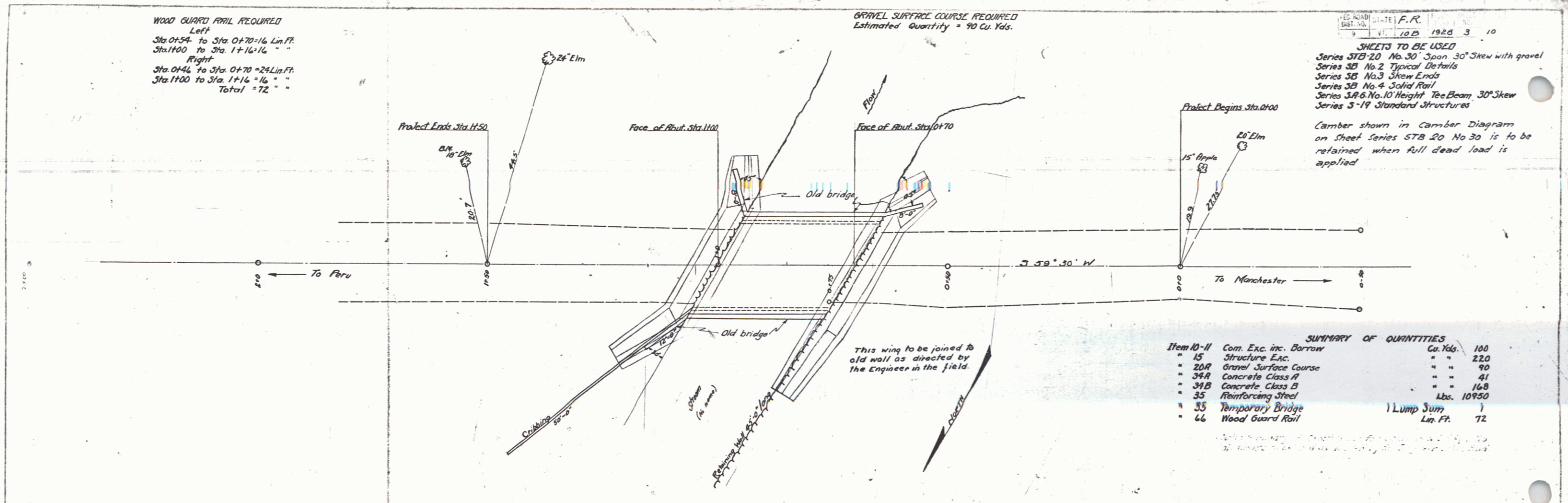

SUMMARY OF QUANTITIES

Item	Com. Exc. inc. Borrow	Cu. Yds.	Lbs.
15	Structure Eac.	160	
20A	Gravel Surface Course	220	
34A	Concrete Class A	90	
34B	Concrete Class B	41	
35	Reinforcing Steel	168	
35	Reinforcing Steel	10950	
35	Temporary Bridge		1
66	Wood Guard Rail		72
Lump Sum			

Length of Bridge = 33' = .006 miles  
 Length of Approaches = 117' = .022 "  
 Length of Project = 150' = .028 "

CONVEYER A. B. Bishop  
 BRIDGE ENGINEER

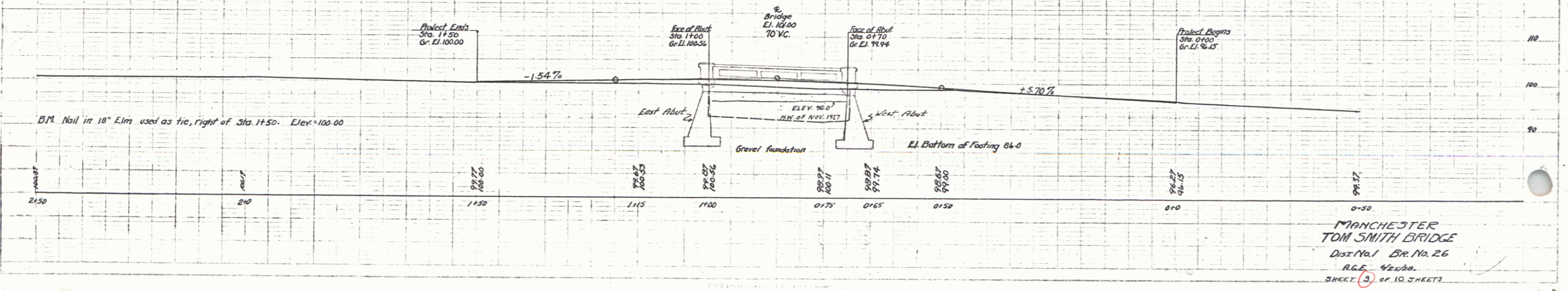

MANCHESTER  
 TOM SMITH BRIDGE  
 Dist. No. 1 Br. No. 26  
 R.E. 4222a  
 SHEET 3 OF 10 SHEETS