

RIPRAP FOR BANK PROTECTION REQUIRED
 LEET
 STA 19+30 TO STA 20+32 - 30 CURS
 BRIDGE IS AT VT-11 R1B L13
 STA 59+33

GRAVEL SURFACE COURSE REQUIRED
 ESTIMATED QUANTITIES 375 CURS

CABLE GUARD RAIL REQUIRED
 LEET
 STA 19+00 TO STA 23+50 - 450 LINE FT
 STA 20+50 TO STA 24+50 - 400 LINE FT
 TOTAL 850 LINE FT

1544
 1756

POOR ORIGINAL COPY

CURVE NO. 2
 P.C. 19+42.1
 P.T. 19+57.2
 L 15.1
 E 11.2

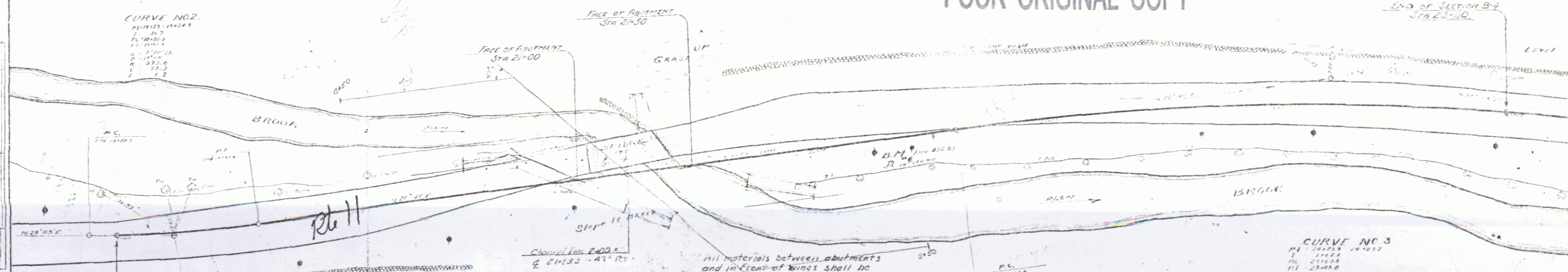

1. CROSS SECTION CHANNEL LINE EVERY 25' SECTION AT LEAST 30' APART.
 2. RUN IN & EXISTING CHANNEL 500' EACH SIDE OF STA 21+25.2 - ROAD PROFILE AND SECTION 50' EACH SIDE OF & THREE SECTIONS @ 30' SPACINGS.
 3. PICK UP TOWN.

All materials between abutments and in front of wings shall be excavated to Elev 447.00 and shall be paid for under the item of Structure Excavation.

27.00
 13.50
 8.60
 22.95

SECTION B-4
 SUMMARY OF QUANTITIES

| | |
|--|---------------|
| Item no. 10-11 Common excavation incl borrow | 2140 Cu Yds |
| 15 Structure excavation | 1022 Cu Yds |
| 20A Gravel surface course | 375 Cu Yds |
| 34-A Concrete class B(1-2-4) | 92 Cu Yds |
| 34-B Concrete class B(1-2-3) | 428 Cu Yds |
| 35 Reinforcing steel | 26,320 Pounds |
| 62 Rip rap for bank protection | 50 CURS |
| 67 Cable guard rail | 850 LINE FT |
| MAINTENANCE, TRAFFIC, AND RESUMING | 1 Lump Sum |

CURVE NO. 3
 P.C. 24+50.0
 P.T. 25+05.0
 L 55.0
 E 11.9

SECTION B-4
 SHEETS TO BE USED

- 2 Sheets Plan and Profile
- 3 Sheets Cross Sections
- Earthwork Sheet
- Special Section of Improvement - 24' Gravel
- 1 Sheet Superstructure Details
- 2 Sheets Abutment Details
- SB2 Typical Details
- SB2A Typical Details
- SD3 Cable Rail and Curb
- 3 22 Standard Specifications

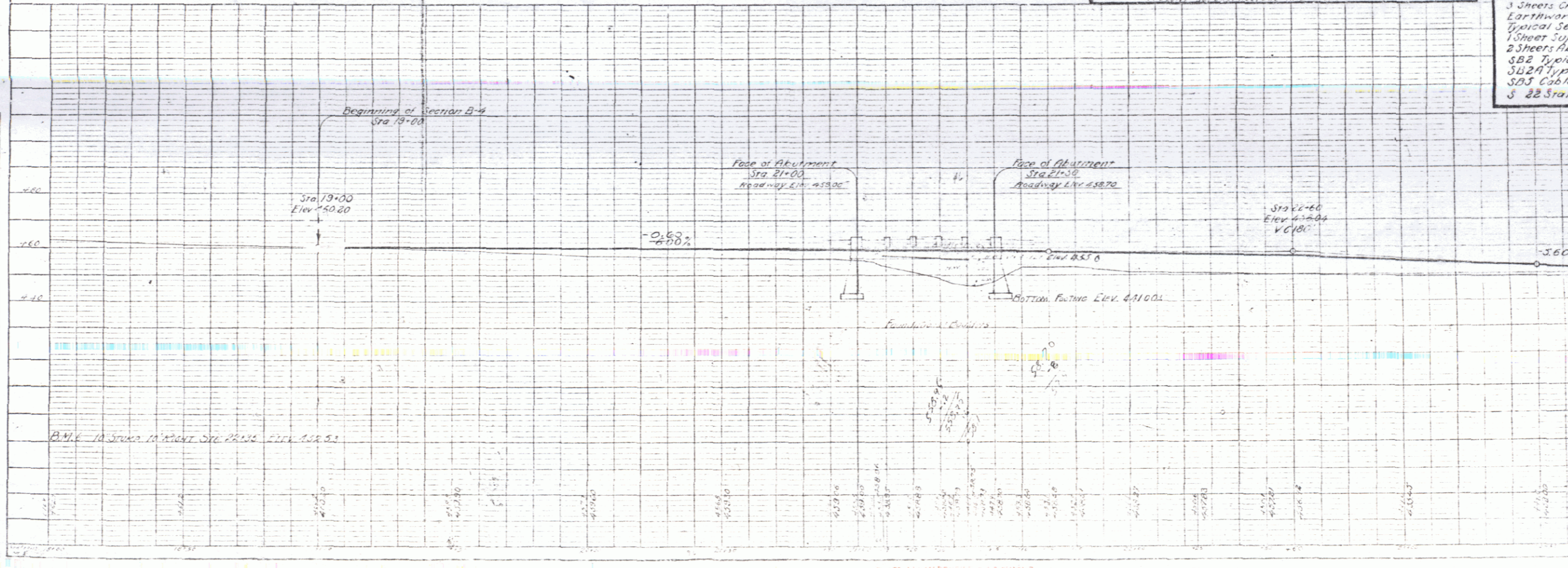

BRIDGE NO. 4
 OVER
 PFLUGER BROOK
 ANDOVER, VT.

PLAN
 SHEET NO. 1
 OF 2 SHEETS

PROFILE
 SHEET NO. 1
 OF 2 SHEETS