

**BRIDGE # 5**  
 Type Conc. T. Beam  
 Long Overall 33.0'  
 Clear Span 30.0'  
 Roadway Width 20.0'  
 Built as F.A.P. 100-C (1929)

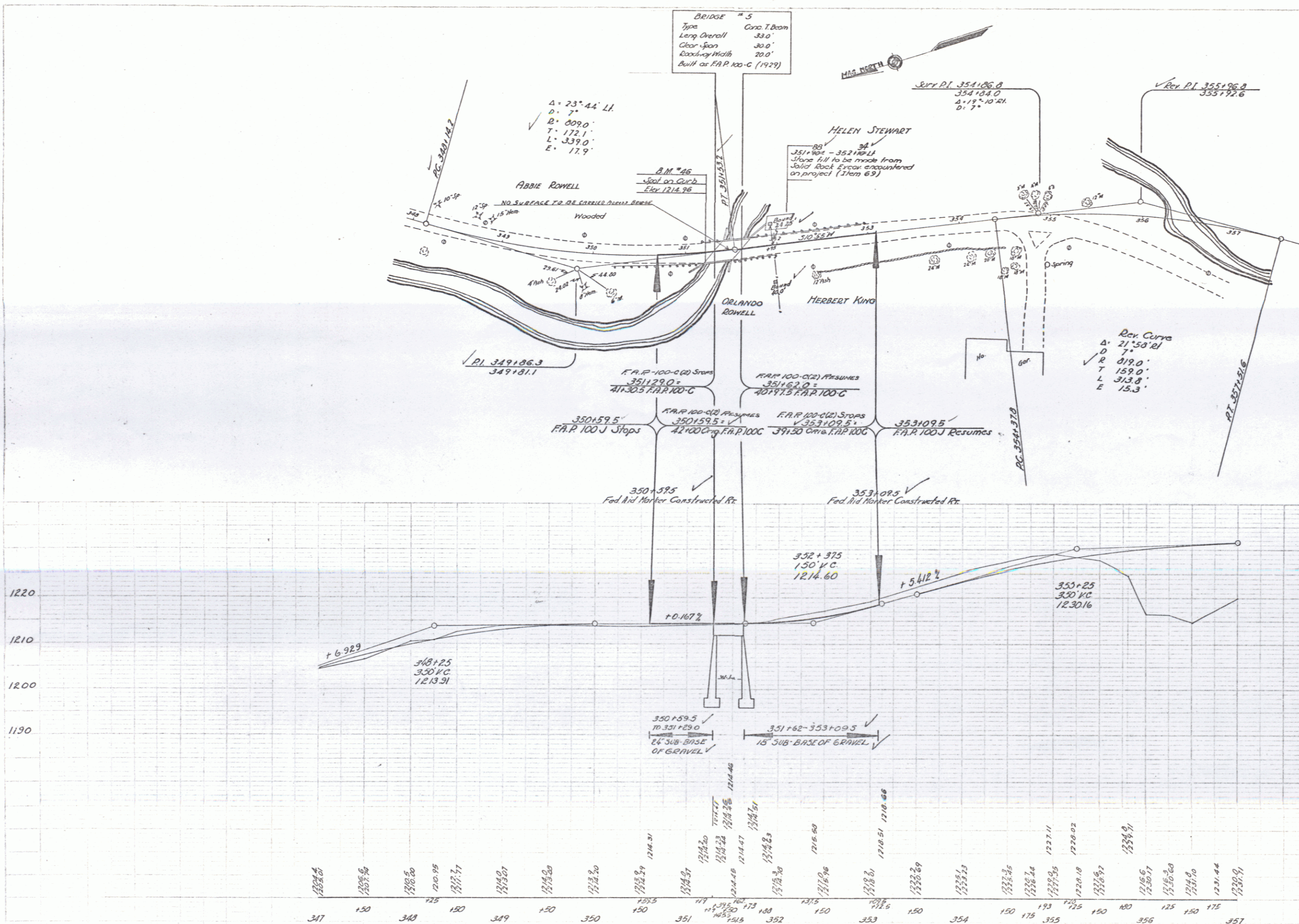

PLAN  
 DISTRICT  
 COUNTY  
 SHEET NO.  
 OF SHEETS



1220  
 1210  
 1200  
 1190

347 150 348 150 349 150 350 150 351 150 352 150 353 150 354 150 355 150 356 150 357