

PARCEL	INSTRUMENT	DATE	GRANTOR	GRANTEE	RECORDED PERU	REMARKS
#3A	W.D.O.E.	11-20-46	MABEL E. WHITNEY	ST. OF VT.	BOOK 17 PAGE 187	DATE 10-25-46
#1A	CONDEM.	10	FLORENCE B. CHAPMAN		166-173	SEE REPORT OF HEARING (19)

PLAN
 SHOWS
 THE
 LOCATION
 OF
 THE
 PROPERTY
 LINES
 AND
 THE
 POSITION
 OF
 THE
 SURVEY
 POINTS
 AND
 THE
 LOCATION
 OF
 THE
 PROPERTY
 LINES
 AND
 THE
 POSITION
 OF
 THE
 SURVEY
 POINTS

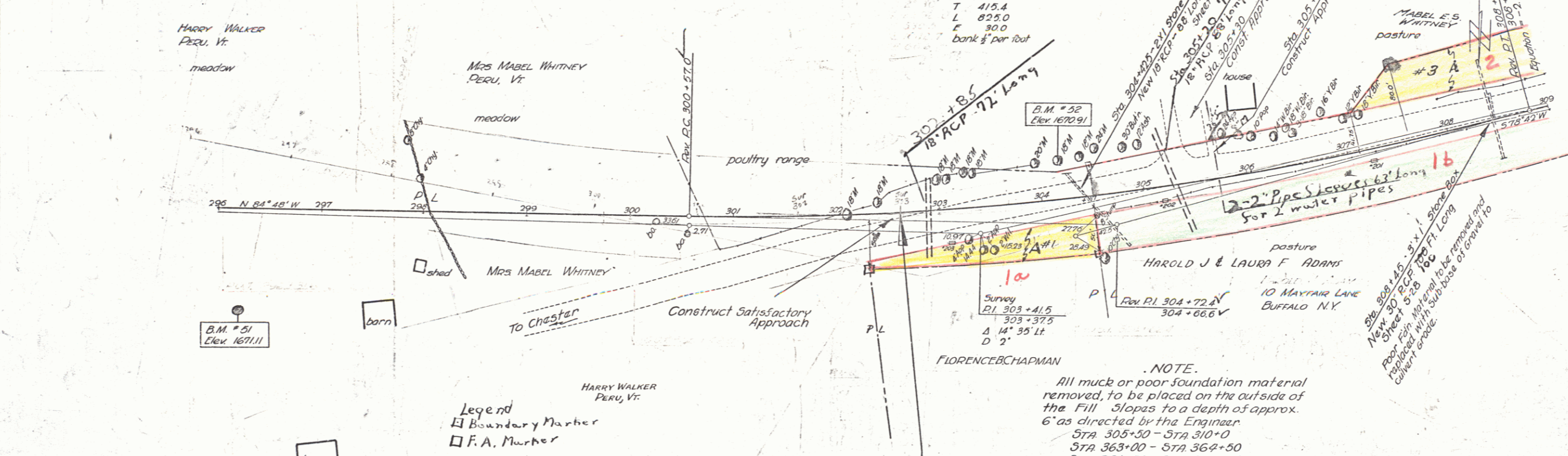

Rev Curve
 Δ 16° 30' Lt
 D 2'
 R 2864.9
 T 415.4
 L 825.0
 E 300
 bank of per foot

Survey
 P.I. 303+41.5
 303+37.5
 Δ 14° 35' Lt
 D 2'

FLORENCE B. CHAPMAN

. NOTE.
 All muck or poor foundation material removed, to be placed on the outside of the fill slopes to a depth of approx. 6' as directed by the Engineer.
 STA 305+30 - STA 310+0
 STA 363+00 - STA 362+50
 STA 381+50 - STA 383+50

PARCEL	INSTRUMENT	DATE	GRANTOR	GRANTEE	RECORDED PERU	REMARKS
#1A	W.D.O.E.	11-20-46	MABEL E. S. WHITNEY	ST. OF VT.	BOOK 17 PAGE 187	DATE 11-20-46
#2A	COND.	10	FLORENCE B. CHAPMAN	" " "	166-173	10-25-46 SEE REPORT OF HEARING

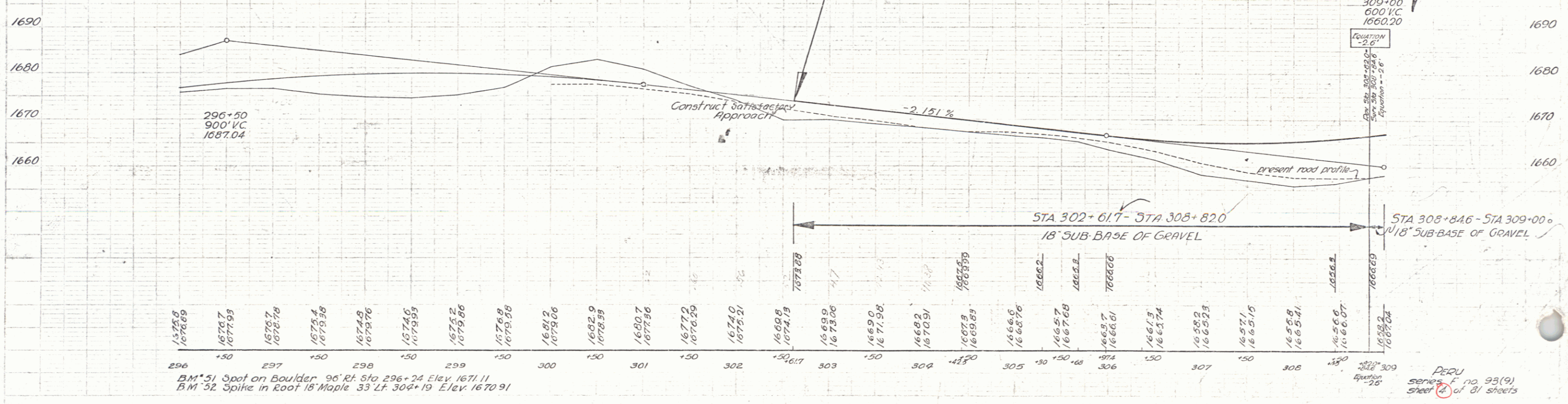

B.M. #31 Spot on Boulder 96 Rt Sta 296+24 Elev 1671.11
 B.M. #32 Spike in Roof 18 Maple 33 Lt Sta 302+19 Elev 1670.91

PERU
 series F no. 93(9)
 sheet 14 of 81 sheets