

Stone Fill (Heavy Type) 1425  
 95+00-95+25.11  
 99+25-111+00.11  
 Gravel Stone Barrier 1225  
 90+75-103+20.21  
 Bituminous Concrete 1125  
 103+50-109+00.21

2.5' to 1.5' Stone Drain  
 1125  
 103+00-111+00.11  
 Construct Channel  
 1225  
 101+25-103+25.11

2.5' to 1.5' Stone Drain  
 1125  
 103+00-111+00.11  
 103+00.21  
 102+00.21  
 104+00.11

103+50-109+00.21

POOR ORIGINAL COPY

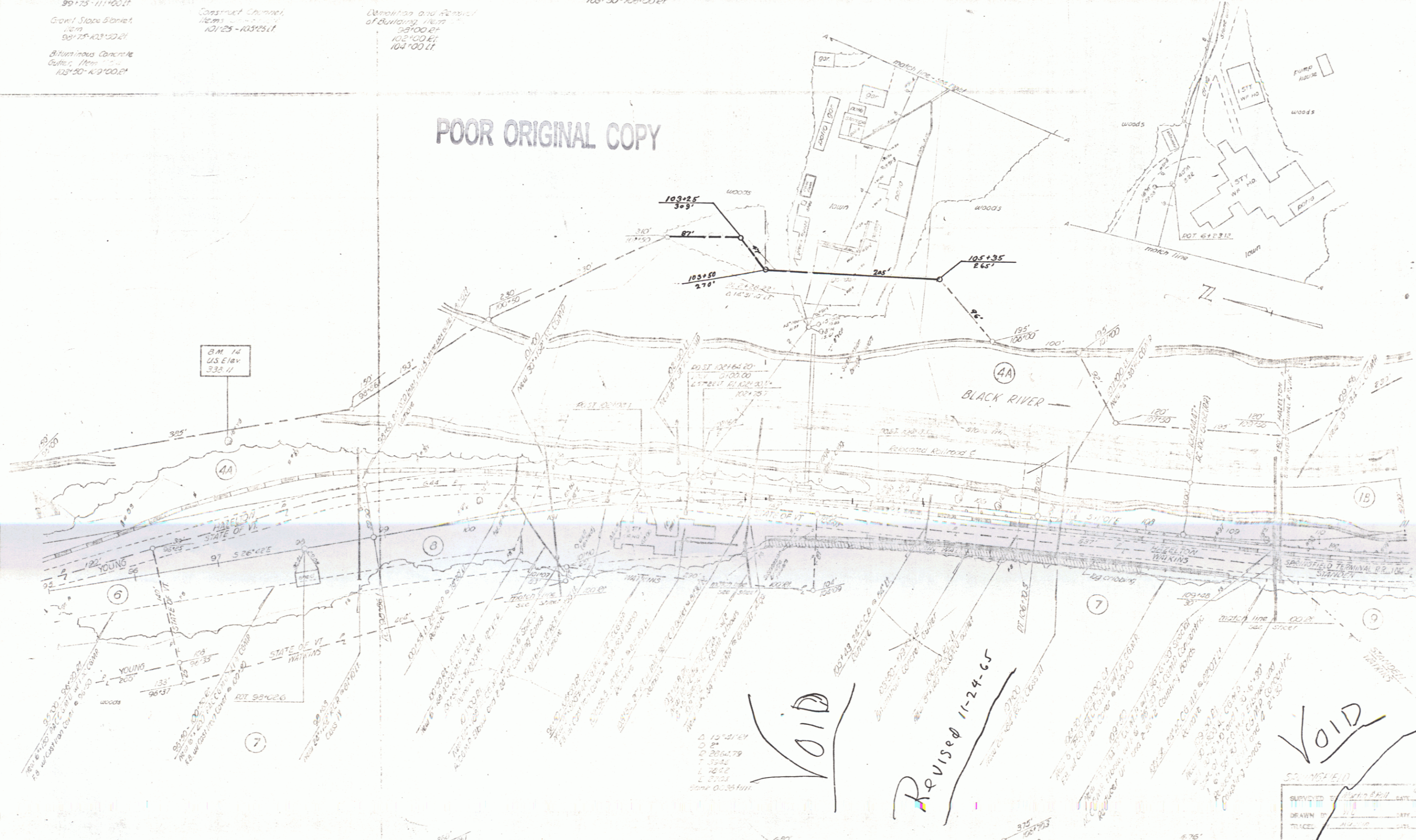

VOID

Revised 11-29-65

VOID

SUPPLIED BY	DATE
DRAWN BY	CHECKED BY
SCALE	PROJECT
SHEET 15	