

INDEX OF SHEETS

SHEET NO	1	TITLE PAGE
	2	TYPICAL CROSS-SECTION OF IMPROVEMENT (BITUMINOUS CONCRETE PAVEMENT, ITEM 361-B)
	3	BANKING AND WIDENING TABLES
	4	QUANTITY SHEET (ITEMS AND DRAINAGE)
	5-6	EARTHWORK SHEETS
	7-8	PLAN AND PROFILE SHEETS
	9	CONSTRUCTION DETAILS CD (DRAINAGE AND MARKERS)
	10	CONSTRUCTION DETAILS CD-2 (TYPICAL GRADING)
	11	STANDARD STRUCTURE SHEET S-40 (BARRICADES, SIGNS, AND LIGHTS)
	12	STANDARD STRUCTURE SHEET S-48-46 (THREE CABLE GUARD RAIL)
	13	STANDARD STRUCTURE SHEET S-55-49 (PRECAST CONCRETE PIPE DROP INLETS)
	14-27	CROSS-SECTIONS

STATE OF VERMONT
DEPARTMENT OF HIGHWAYS
PROPOSED IMPROVEMENT

Town of Norwich

Pin# 99R854

FED. ROAD DIVISION NO.	STATE	PROJECT NO.	YEAR	SHEET NO.	TOTAL SHEETS
	VT	593(1)	10-A	1	27

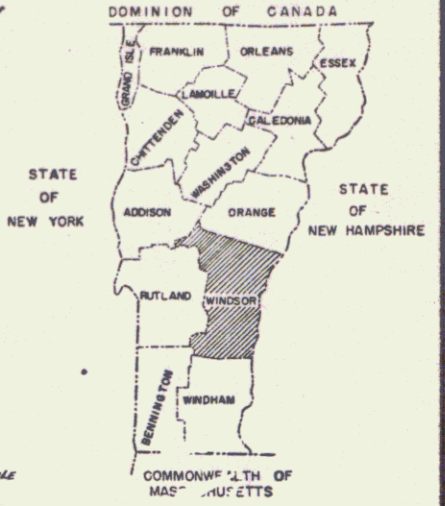

Historical
RIGHT-OF-WAY DIVISION
TOWN FILE
PERPETUAL
Rte
Town of U-10A
(To Be Returned To R.O.W. Division)

Built under different project numbers during construction of I91.

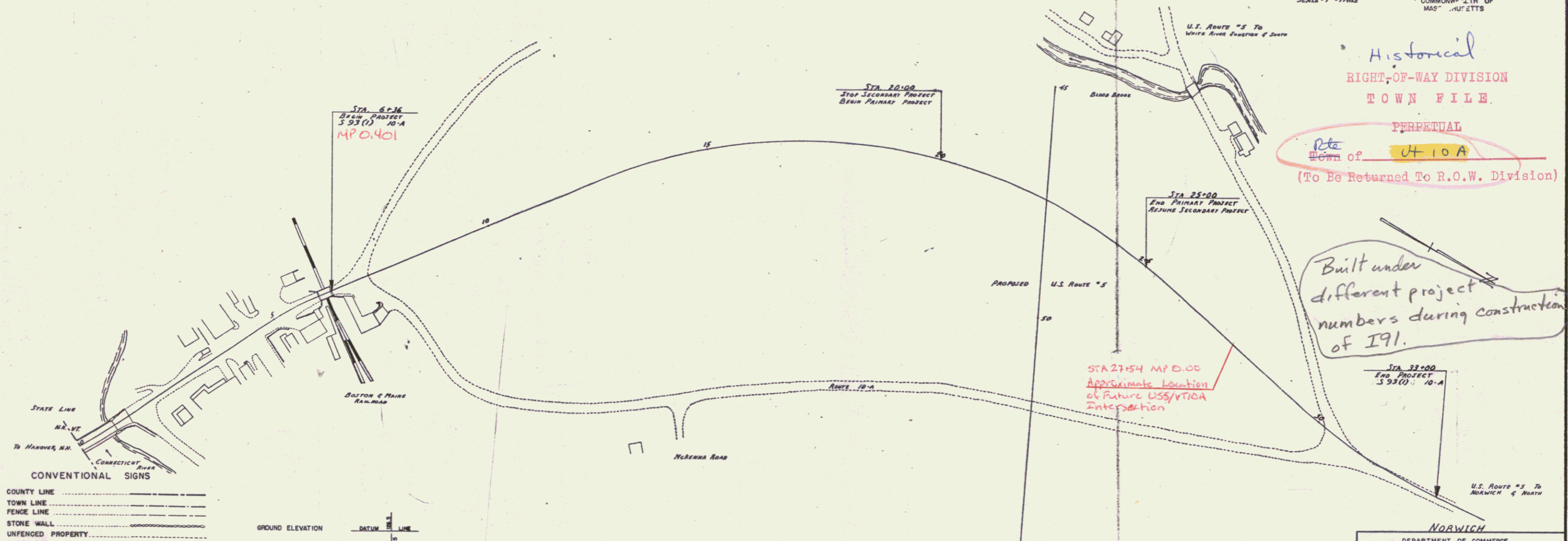

CONVENTIONAL SIGNS

COUNTY LINE	-----
TOWN LINE	-----
FENCE LINE	-----
STONE WALL	-----
UNFENCED PROPERTY	-----
GUARD RAIL	-----
TRAVELED WAY	-----
RAILROAD	-----
RETAINING WALL	-----
CENTER LINE	-----
SURVEY LINE	-----
CULVERT	-----
DROP INLET	-----
TROLLEY POLE	-----
POWER POLE	-----
TELEPHONE POLE	-----
TREES	-----
HEDGE	-----

SCALES

TITLE	1" = 200'
TYPICAL	1" = 2"
PLAN	1" = 50'
PROFILE HORIZONTAL	1" = 50'
VERTICAL	1" = 10'
CROSS-SECTIONS	1" = 5' x 10'

CURVE DATA

DEFLECTION OF ANGLEA
DEGREE OF CURVED
RADIUS OF CURVER
TANGENT DISTANCET
LENGTH OF CURVEL
EXTERNAL DISTANCEE
POINT OF INTERSECTIONP.I.
POINT OF CURVEP.C.
POINT OF TANGENTP.T.
POINT ON TANGENTP.O.T.
POINT ON SUB-TANGENTP.O.S.T.

THESE PLANS ARE SUBJECT TO SUCH REVISIONS AS MAY BE REQUIRED BY THE BUREAU OF PUBLIC ROADS OR THE COMMISSIONER OF HIGHWAYS.

CONSTRUCTION IS TO BE CARRIED ON IN ACCORDANCE WITH THE PLANS AND THE STANDARD ROAD AND BRIDGE SPECIFICATIONS OF 1948, AS APPROVED JULY 25, 1949 BY THE BUREAU OF PUBLIC ROADS, INCLUDING ALL SUBSEQUENT APPROVED REVISIONS AND SUCH REVISED SPECIFICATIONS AND SPECIAL PROVISIONS AS ARE SUBMITTED WITH THE PLANS.

DEPARTMENT OF COMMERCE
BUREAU OF PUBLIC ROADS

RECOMMENDED FOR APPROVAL

DISTRICT ENGINEER _____ DATE _____

APPROVED

DIVISION ENGINEER _____ DATE _____

PROJECT 5 NO. 93(1)

SHEET 1 OF 27 SHEETS

APPROVED CONSTRUCTION ENGINEER DATE _____	APPROVED BRIDGE ENGINEER DATE _____	APPROVED DISTRICT ENGINEER DATE _____	APPROVED HIGHWAY ENGINEER DATE _____	APPROVED CHIEF ENGINEER DATE <u>2/11/54</u>
---	---	---	--	---