

Construct Approach
 200+00 LT
 CONTROL OF SECTION OF CLD
 HIGHWAY OF TOWN STA. 189+00.
 17' LEFT OR WESTERLY AND STA.
 100.10 LEFT OR SOUTHERLY
 DISHED TO THE TOWN OF
 SPRINGFIELD, AND RECORDED IN BOOK
 5, PAGE 24, OF 1934 BY RECORDS
 OF THE TOWN OF SPRINGFIELD
 FIELD OF THE 23rd DAY
 OF SEPTEMBER 1958.

Construct Special Ditch Item 101
 276+00 RT - 278+25 RT
 276+00 LT - 277+35 LT

CONSTRUCT DRIVES
 MAIN LINE 277+00 RT
 281+00 RT
 283+42 RT
 283+40 LT
 APPROACH 3+23 RT

FED. NO.	STATE	FED. AID PROJECT	FISCAL YEAR	SHEET NO.	TOTAL SHEETS
1	VT	187-8-2	1958	24	136

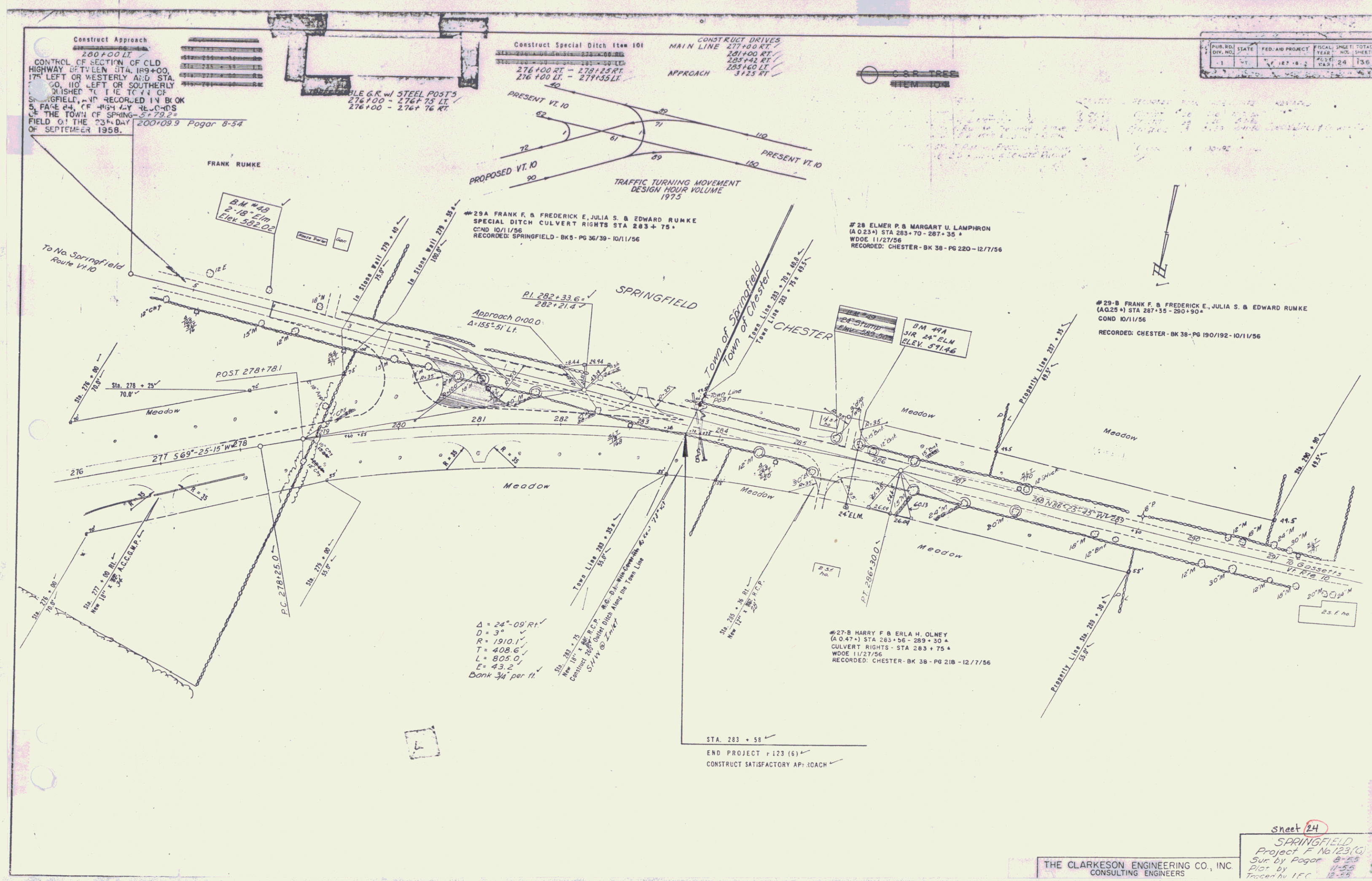

STA. 283 + 50
 END PROJECT + 123 (6)
 CONSTRUCT SATISFACTORY APPROACH

Sheet 24
 SPRINGFIELD
 Project F No. 123(6)
 Sur by Pogor 8-55
 Plot by 11-55
 Traced by 12-55

THE CLARKSON ENGINEERING CO., INC.
 CONSULTING ENGINEERS