

Three Cable Guard Rail With Steel Posts
Item 543
STA 269+00 TO STA 276+00
269+00 - 276+00 LT
273+40 - 276+00 RT
76

Construct Drive
266+60 LT
271+00 RT
273+20 RT

CONSTRUCT SPECIAL DITCH
274+25 RT - 275+25 RT
273+75 RT - 276+00 RT
274+00 LT - 276+00 LT

PUB. NO.	STATE	FED. AID PROJECT	FISCAL YEAR	SHEET NO.
1	VT	F 2816	1955	22

#26 J LESLIE & GRACE GIDDINGS
(A.4.23) STA 258+00-269+37.2
CULVERT RIGHTS STA 258+50-266+00
W.D.O.E. 11/27/56
RECORDED: SPRINGFIELD BK 58 PG 24L242 12/12/66

#27-A HARRY F & ERLA H HOLNEY
(A.4.71) STA 269+03-283+56
W.D.O.E. 11/27/56
RECORDED: SPRINGFIELD BK 56 PG 252 1/4/57

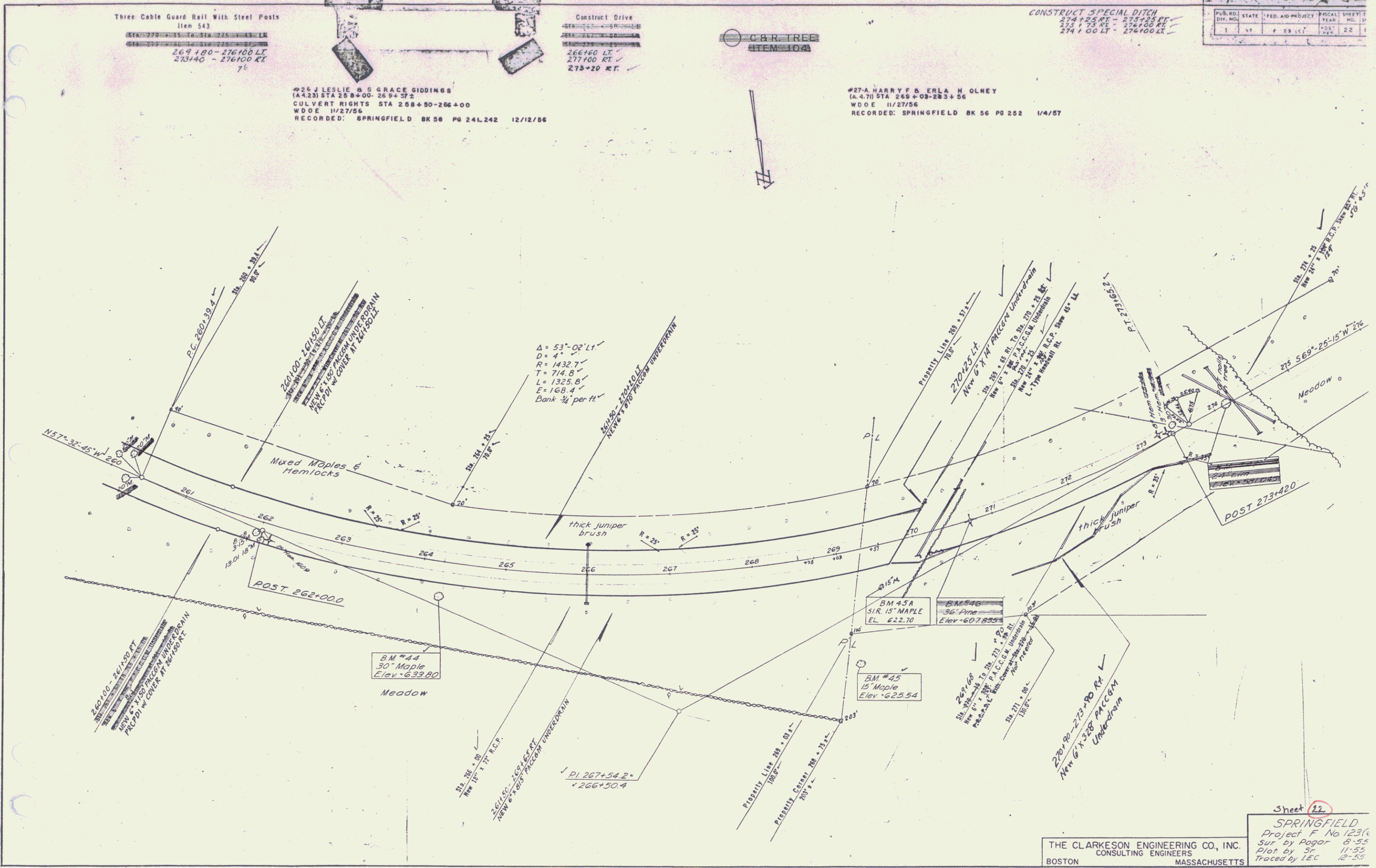

Sheet 22
SPRINGFIELD
Project F No 1236
Sup by Pogor 8-55
Plot by St. 11-55
Traced by IEC 12-55

THE CLARKESON ENGINEERING CO., INC.
CONSULTING ENGINEERS
BOSTON MASSACHUSETTS