

CONSTRUCT DRIVE
166+55 Lt

REMOVAL AND RESETTling
GUARD RAIL ITEM 02155
166+90-168+45 Lt
166+90-168+09 Rt

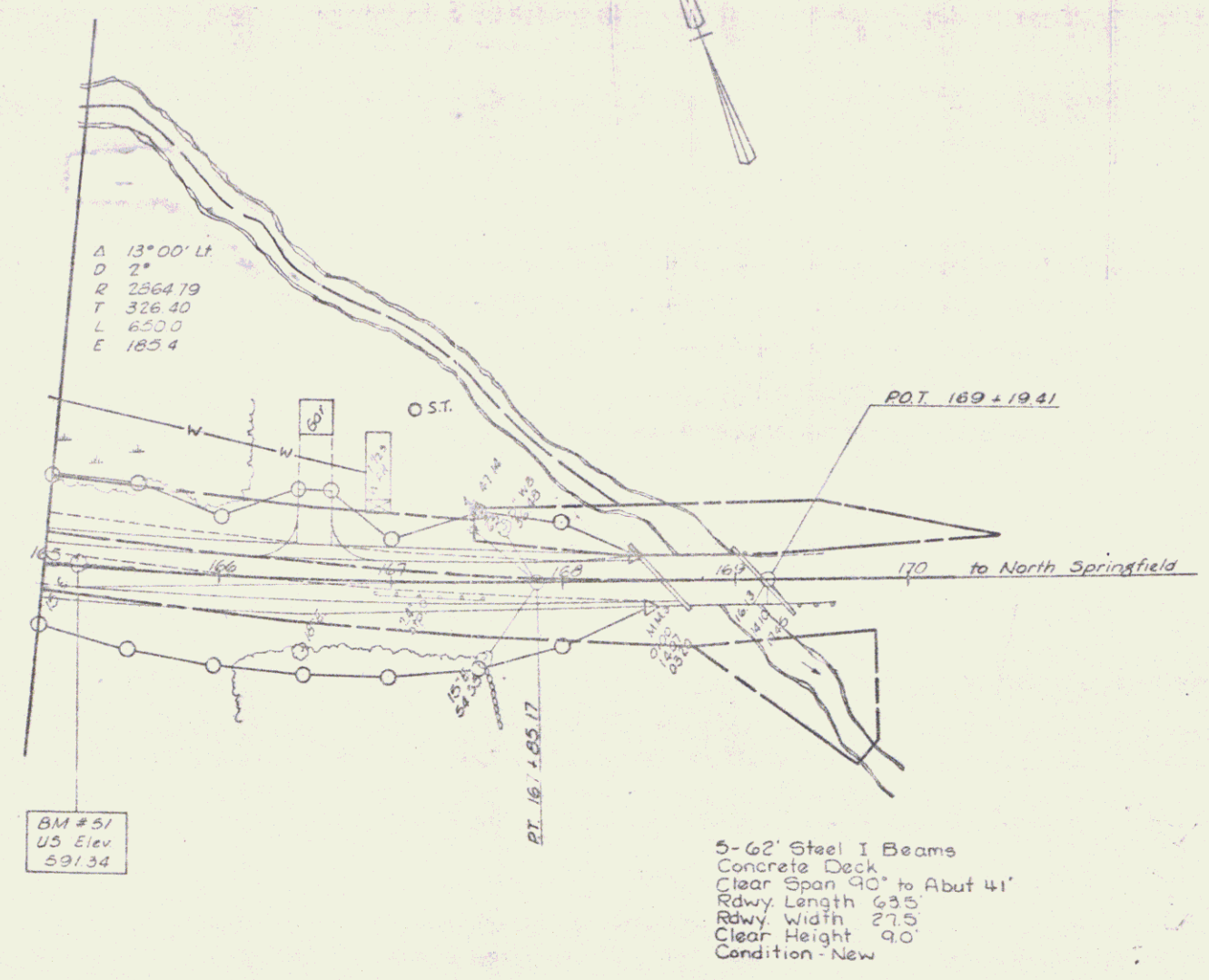

SECTION III

SURVEYED BY Fall DATE 02-74
DRAWN BY Sumner DATE 11-74
TRACED BY Jenawick DATE 11-74
CHESTER Rte 10
PROJ. H.S. NO. 016-2(8)
SHEET 14