

GUARD RAIL REQUIRED ON LEFT

Sta. 73+00 to Sta. 74+22	Length 122 ft
- 73+63 - 73+87	- 24 -
- 84+40 - 84+64	- 24 -

ON RIGHT

Sta. 73+50 to Sta. 76+22	- 72 -
- 75+10 - 76+06	- 96 -
- 78+65 - 80+05	- 140 -
- 86+00 - 87+04	- 64 -

TOTAL THIS SHEET 562

NEW CULVERTS REQUIRED

Sta. 76+05	10' Cor Iron	30 ft Concrete Headwalls	1 each (D-24)
- 79+75		Plain Concrete Culverts	52 - - -
- 84+25	16' - -	Headwalls	15 - - (D-24)

FED. ROAD DIST. NO.	STATE	FED. AID PROJ. NO.	FISCAL YEAR	SHEET NO.	TOTAL SHEETS
7	VT	7	1914	8	16

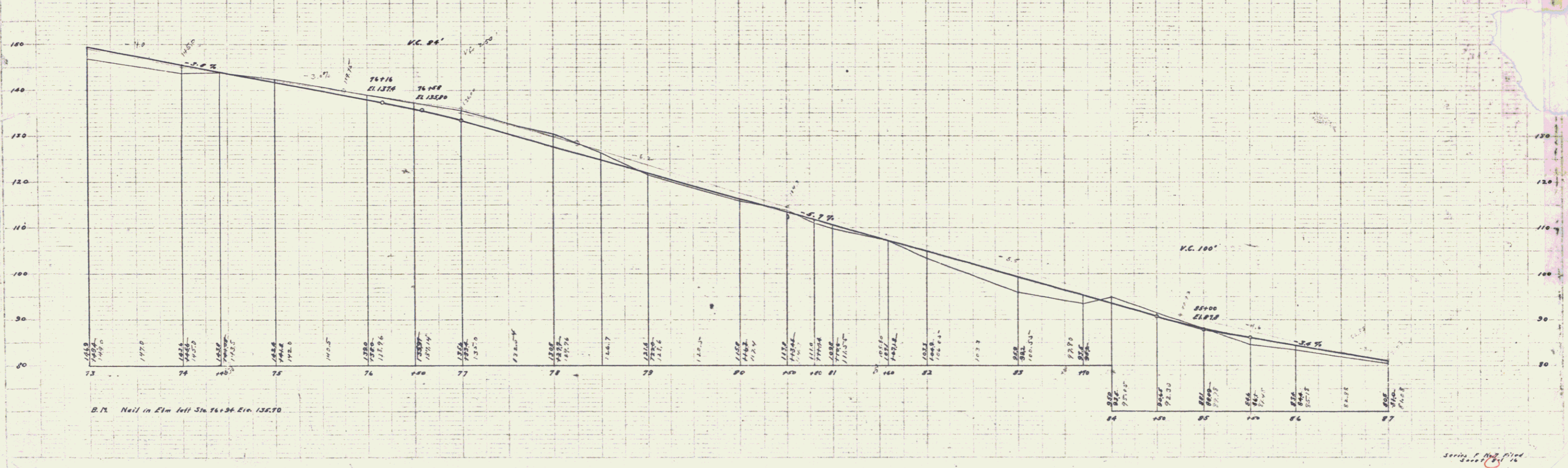
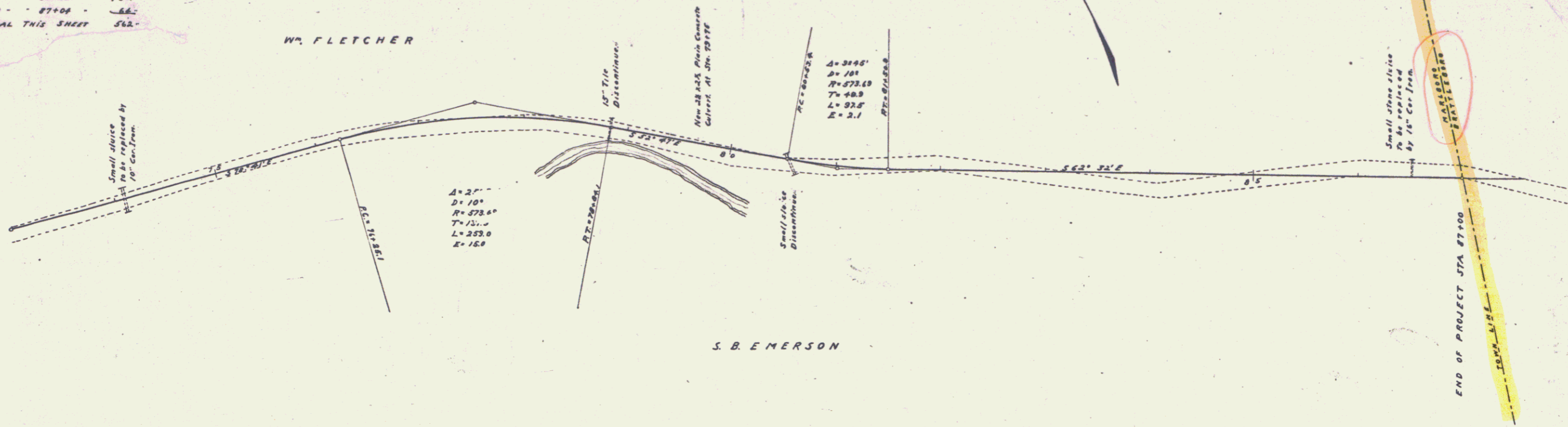

Series 7, No. 11, 1914